

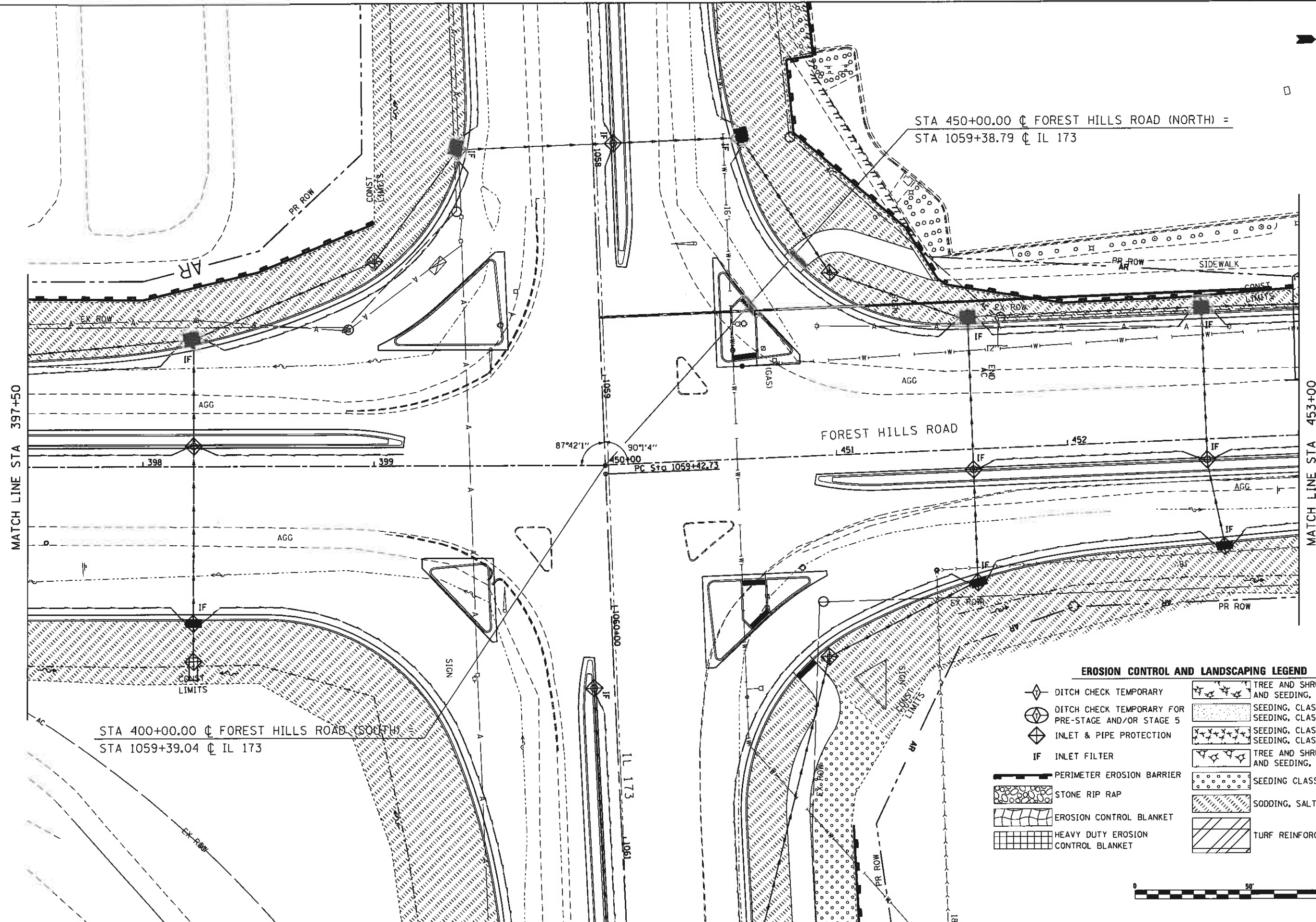

STA 450+00.00 C FOREST HILLS ROAD (NORTH) =
STA 1059+38.79 C IL 173



STA 400+00.00 C FOREST HILLS ROAD (SOUTH)
STA 1059+39.04 C IL 173

EROSION CONTROL AND LANDSCAPING LEGEND

- DITCH CHECK TEMPORARY
- DITCH CHECK TEMPORARY FOR PRE-STAGE AND/OR STAGE 5
- INLET & PIPE PROTECTION
- IF INLET FILTER
- PERIMETER EROSION BARRIER
- STONE RIP RAP
- EROSION CONTROL BLANKET
- HEAVY DUTY EROSION CONTROL BLANKET
- TREE AND SHRUB/SEEDING, CLASS 4 AND SEEDING, CLASS 5 (SPECIAL)
- SEEDING, CLASS 4 AND SEEDING, CLASS 5 (SPECIAL)
- SEEDING, CLASS 4B AND SEEDING, CLASS 5B
- TREE AND SHRUB/SEEDING, CLASS 4B AND SEEDING, CLASS 5B
- SEEDING CLASS 2A
- SODDING, SALT TOLERANT
- TURF REINFORCEMENT MAT



FILE NAME =	USER NAME = Sca10	DESIGNED - RMH	REVISED -	STATE OF ILLINOIS DEPARTMENT OF TRANSPORTATION	EROSION CONTROL AND LANDSCAPING PLANS FOREST HILLS ROAD			F.A.P. RTE. 303	SECTION 129R	COUNTY WINNEBAGO	TOTAL SHEETS 968	SHEET NO. 394
THE UPCHURCH GROUP, INC.	PLLOT SCALE = 48,0000 1/ in.	DRAWN - SAE	REVISED -		SCALE: 1"=20'	SHEET NO.	OF SHEETS	STA. 397+50	TO STA. 453+00	(ILLINOIS) FED. AID PROJECT		
	PLLOT DATE = 4/23/2013 9:23:34 AM	CHECKED - RLM	REVISED -							CONTRACT NO. 64988		
		DATE - APRIL 30, 2013	REVISED -									