

PLAN	SURVEYED	DATE
NOTE BOOK NO.	PLOTTED	BY
	CHECKED	
	RT. OF WAY CHECKED	
	CADD FILE NAME	

PROFILE	SURVEYED	DATE
NOTE BOOK NO.	PLOTTED	BY
	CHECKED	
	STRUCTURE NOTATIONS CHRD	

EX MH 179-018	EX MH 179-019
1122+36, 68.9' LT	1124+72.84, 166.2' LT
EX MH SAN 4' DIA	EX MH SAN 4' DIA
EX RIM = 823.44	EX RIM = 828.33
PR RIM = 821.90	INV IN (W) = 815.67 (STUB)
INV IN (NW) = 812.13 (STUB)	INV IN (NE) = 815.31
INV IN (NE) = 811.74	INV OUT (SW) = 815.27
INV OUT (SW) = 811.68	

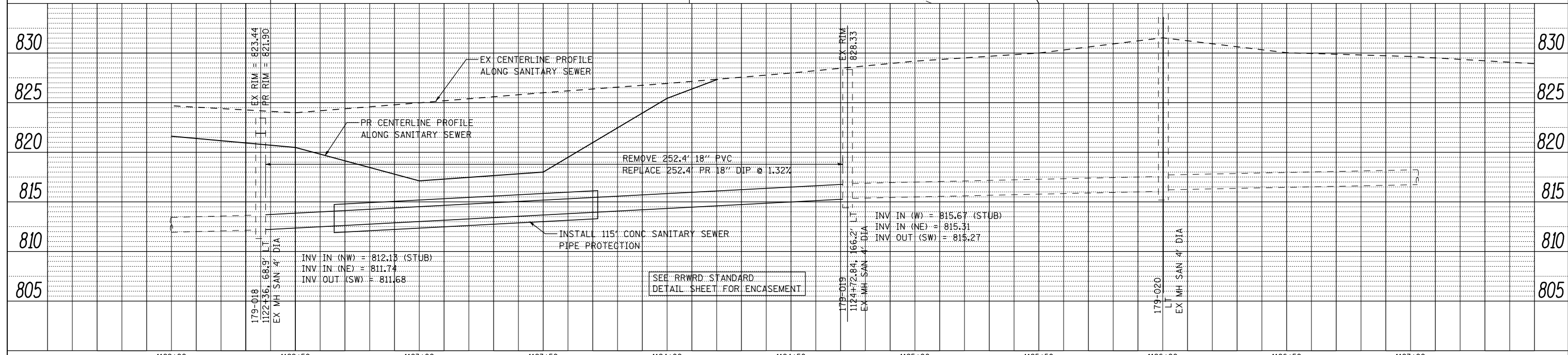
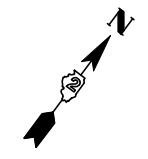
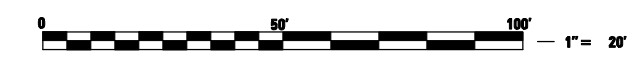
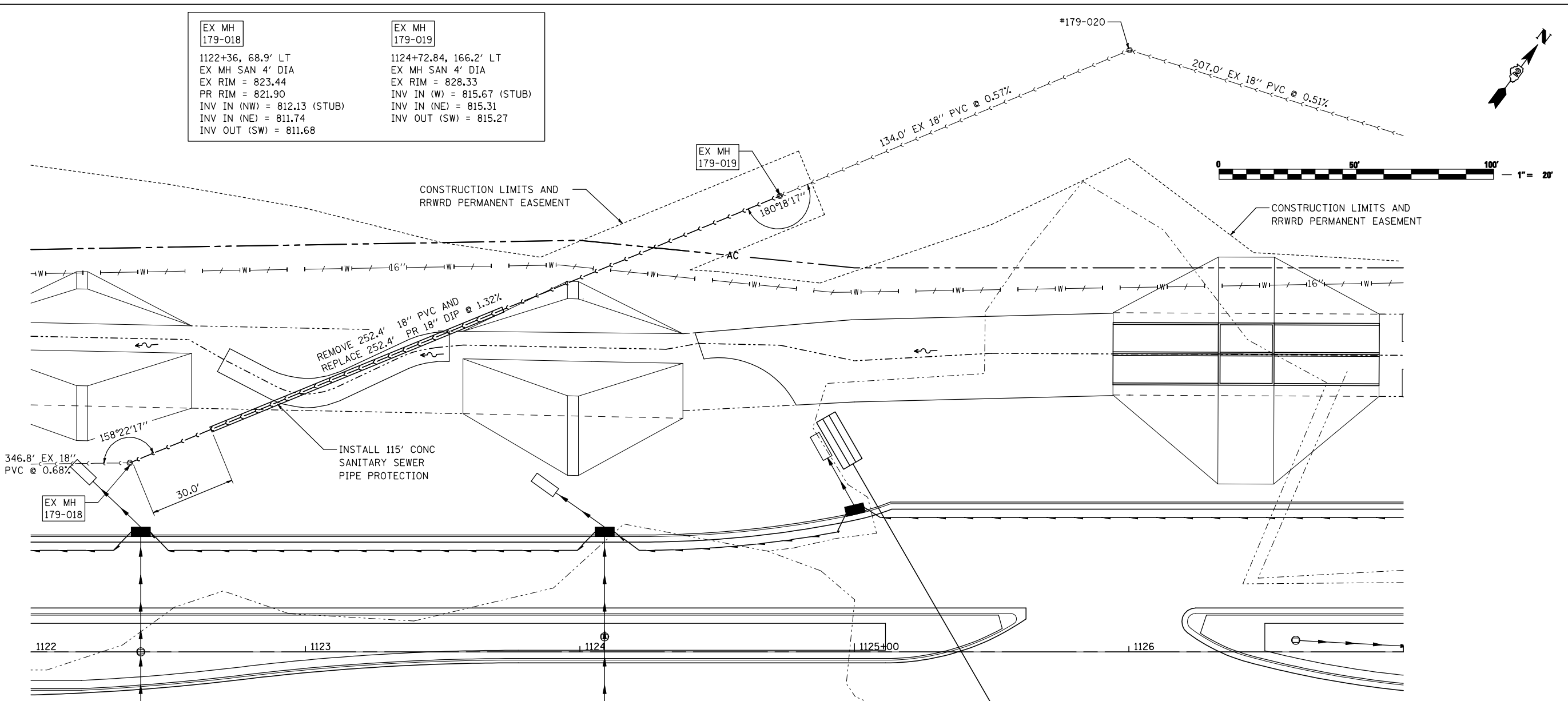

FILE NAME = ... \CADD SHEETS\Z00793SANPLN04.dgn	USER NAME = Elgin 110	DESIGNED - MW	REVISED -	STATE OF ILLINOIS DEPARTMENT OF TRANSPORTATION	SANITARY SEWER RELOCATION PLANS IL 173 FROM ALPINE ROAD TO I-90	F.A.P. RTE. 303	SECTION 129R	COUNTY WINNEBAGO	TOTAL SHEETS 968	SHEET NO. 484	
THE UPCHURCH GROUP, INC.	PLOT SCALE = 40.0000' / IN.	CHECKED - MJS	REVISED -			SCALE: 1"=20'	SHEET NO. OF SHEETS	STA. 1122+00 TO STA. 1127+00	CONTRACT NO. 64988		ILLINOIS FED. AID PROJECT
PLOT DATE = 5/7/2013 11:50:21 AM	DATE = APRIL 30, 2013	REVISED -	REVISED -								