

**NOTE:**

1. USE DISTRICT 2 STANDARDS 41.1 AND 93.4 FOR ADDITIONAL LAYOUT INFORMATION.

**LEGEND**

- ① PAVEMENT MARKING SYMBOL
- ② 4" SOLID WHITE EDGE LINE
- ③ 4" SOLID YELLOW EDGE LINE
- ④ 4" SOLID YELLOW DOUBLE
- ⑤ 6" WHITE 30' SKIP 10' DASH
- ⑥ 6" SOLID WHITE
- ⑦ 8" SOLID WHITE LANE LINE
- ⑧ 8" WHITE 4' SKIP 2' DASH
- ⑨ 8" WHITE 6' SKIP 2' DASH
- ⑩ 12" SOLID WHITE DIAGONALS (ISLANDS)
- ⑪ 12" SOLID WHITE DIAGONALS, 20' C-C
- ⑫ 12" SOLID WHITE DIAGONALS, 30' C-C
- ⑬ 12" SOLID YELLOW DIAGONALS, 30' C-C
- ⑭ 12" SOLID WHITE DIAGONALS, 75' C-C
- ⑮ 12" SOLID YELLOW DIAGONALS, 75' C-C
- ⑯ 24" SOLID WHITE STOP BAR
- ⑰ RAISED REFLECTIVE PAVEMENT MARKER

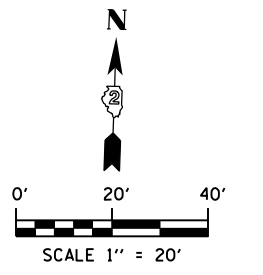
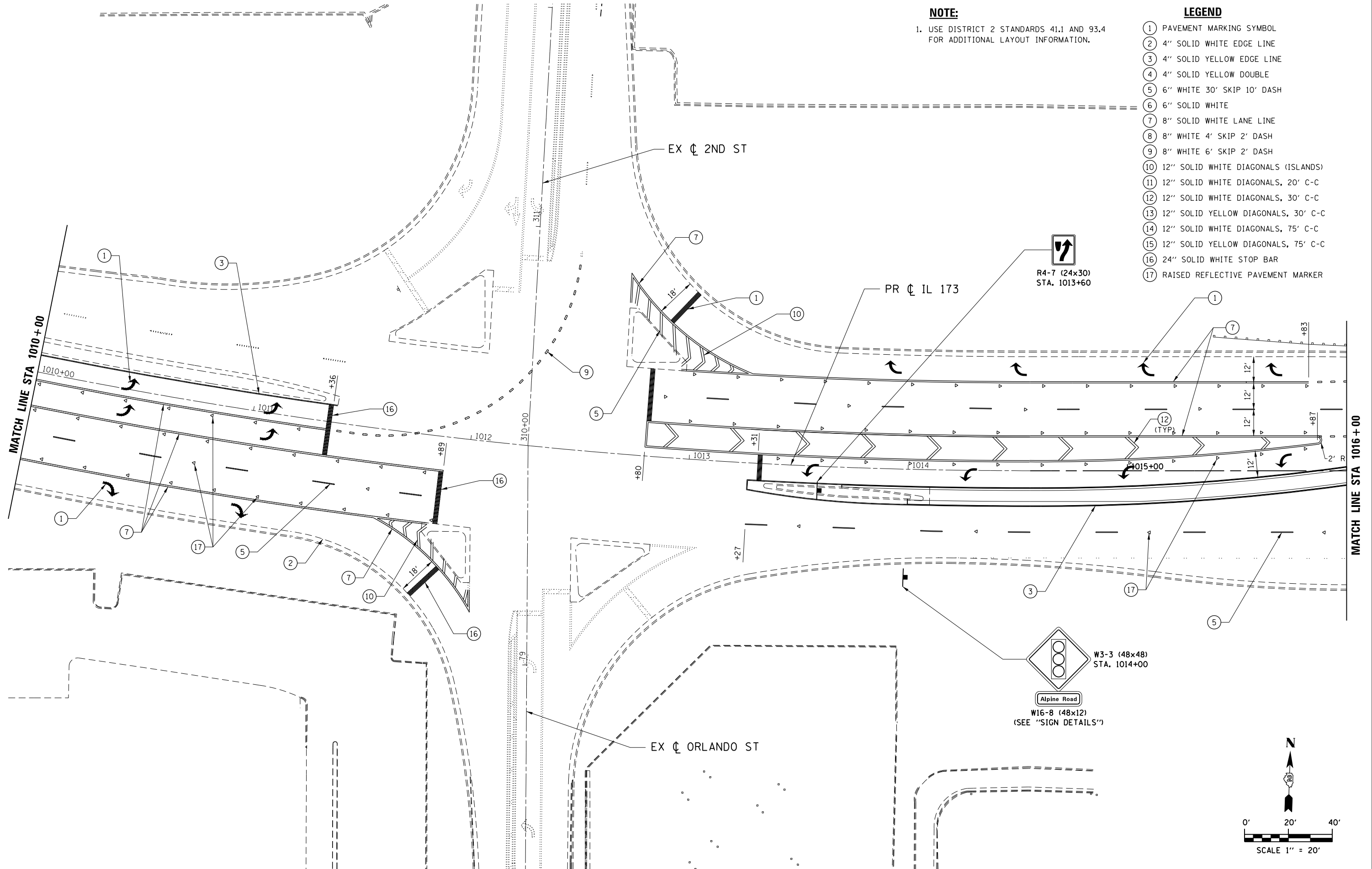

FILE NAME = Z00793PMLN-03\_IL173.dgn  
 MODEL = Default  
 PLOT DRIVER = Vb...IDOT...PDF...11x17.plt



USER NAME = rgoertz	DESIGNED - RG	REVISED -
DRAWN - TRF	CHECKED - CMS	REVISED -
PLOT SCALE = 480.0000' / ft.	DATE - APRIL 30, 2013	REVISED -
PLOT DATE = 5/3/2013		

**STATE OF ILLINOIS  
 DEPARTMENT OF TRANSPORTATION**

**PAVEMENT MARKING & SIGNING PLAN  
 IL 173**

SCALE: 1" = 20' SHEET NO. OF SHEETS STA. 1010+00 TO STA. 1016+00

F.A.P. RTE.	SECTION	COUNTY	TOTAL SHEETS	SHEET NO.
303	129R	WINNEBAGO	968	600
CONTRACT NO. 64988				
FED. ROAD DIST. NO. 2 ILLINOIS FED. AID PROJECT				