

**NOTE:**  
 1. USE DISTRICT 2 STANDARDS 41.1 AND 93.4 FOR ADDITIONAL LAYOUT INFORMATION.

- LEGEND**
- ① PAVEMENT MARKING SYMBOL
  - ② 4" SOLID WHITE EDGE LINE
  - ③ 4" SOLID YELLOW EDGE LINE
  - ④ 4" SOLID YELLOW DOUBLE
  - ⑤ 6" WHITE 30' SKIP 10' DASH
  - ⑥ 6" SOLID WHITE
  - ⑦ 8" SOLID WHITE LANE LINE
  - ⑧ 8" WHITE 4' SKIP 2' DASH
  - ⑨ 8" WHITE 6' SKIP 2' DASH
  - ⑩ 12" SOLID WHITE DIAGONALS (ISLANDS)
  - ⑪ 12" SOLID WHITE DIAGONALS, 20' C-C
  - ⑫ 12" SOLID WHITE DIAGONALS, 30' C-C
  - ⑬ 12" SOLID YELLOW DIAGONALS, 30' C-C
  - ⑭ 12" SOLID WHITE DIAGONALS, 75' C-C
  - ⑮ 12" SOLID YELLOW DIAGONALS, 75' C-C
  - ⑯ 24" SOLID WHITE STOP BAR
  - ⑰ RAISED REFLECTIVE PAVEMENT MARKER

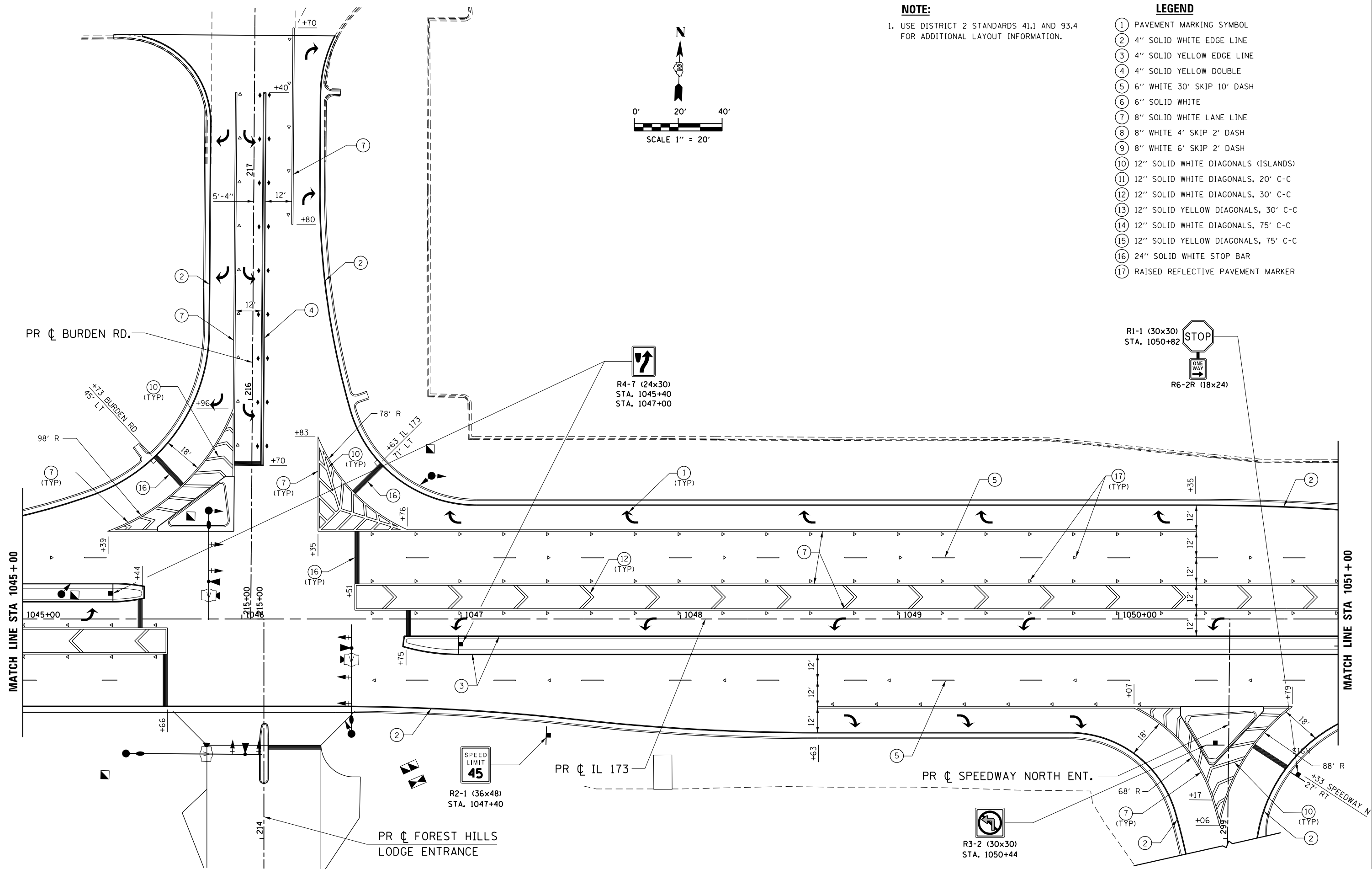

FILE NAME = Z00793PMLN-09\_IL173.dgn  
 MODEL = Default  
 PLOT DRIVER = V8...IDOT\_PDF...11x17.pltcf9



USER NAME = rgoertz	DESIGNED - RG	REVISED -
PLOT SCALE = 480.0000' / ft.	DRAWN - TRF	REVISED -
PLOT DATE = 5/3/2013	CHECKED - CMS	REVISED -
	DATE - APRIL 30, 2013	REVISED -

**STATE OF ILLINOIS**  
**DEPARTMENT OF TRANSPORTATION**

**PAVEMENT MARKING & SIGNING PLAN**  
**IL 173**

SCALE: 1" = 20"    SHEET NO.    OF    SHEETS    STA. 1045+00    TO    STA. 1051+00

F.A.P. RTE. 303	SECTION 129R	COUNTY WINNEBAGO	TOTAL SHEETS 968	SHEET NO. 606
CONTRACT NO. 64988				
FED. ROAD DIST. NO. 2 ILLINOIS FED. AID PROJECT				