

170 160 150 140 130 120 110 100 90 80 70 60 50 40 30 20 10 0 10 20 30 40 50 60 70 80 90 100 110 120 130 140 150

BY	DATE
FINAL SURVEY	SURVEYED
NOTE BOOK	PLOTTED
NO.	TEMPLATE
	AREAS
	CHECKED

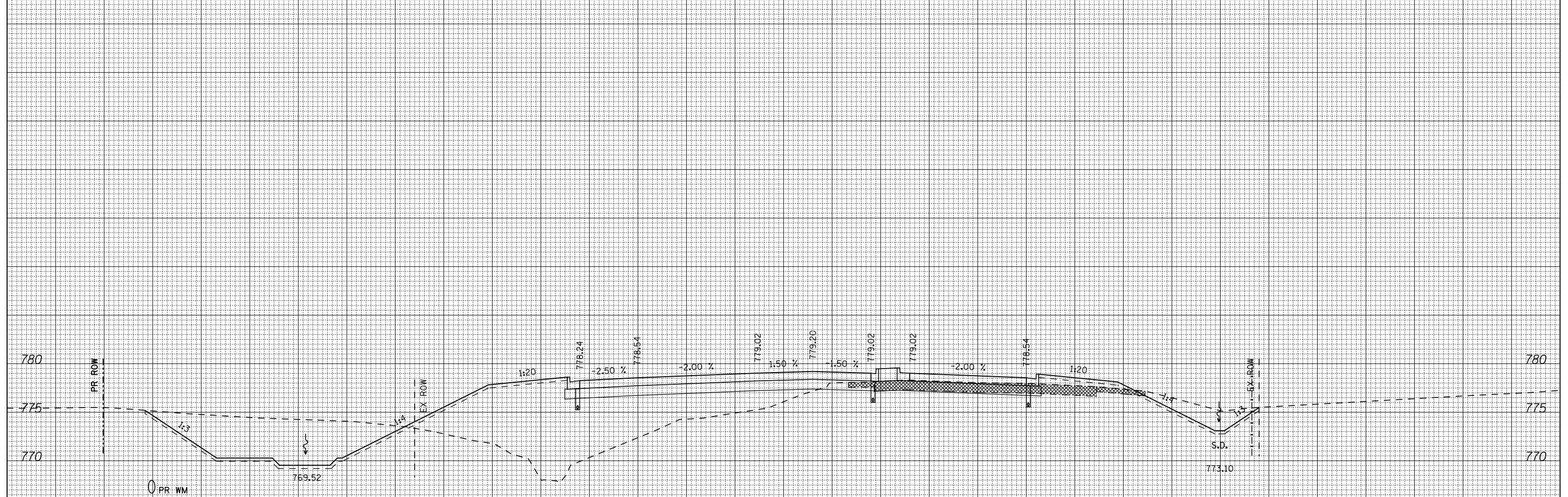

1079 + 00.00

1079 + 00.00

PreStage_1
 Channel Ex = 174.29 S.F.
 Fill = 353.51 S.F.
 T.S. Lt = 88.78 L.F.

Stage_5
 Cut = 41.93 S.F.
 Fill = 25.82 S.F.
 T.S. Rt = 46.44 L.F.

BY	DATE
ORIGINAL SURVEY	SURVEYED
NOTE BOOK	PLOTTED
NO.	TEMPLATE
	AREAS
	CHECKED

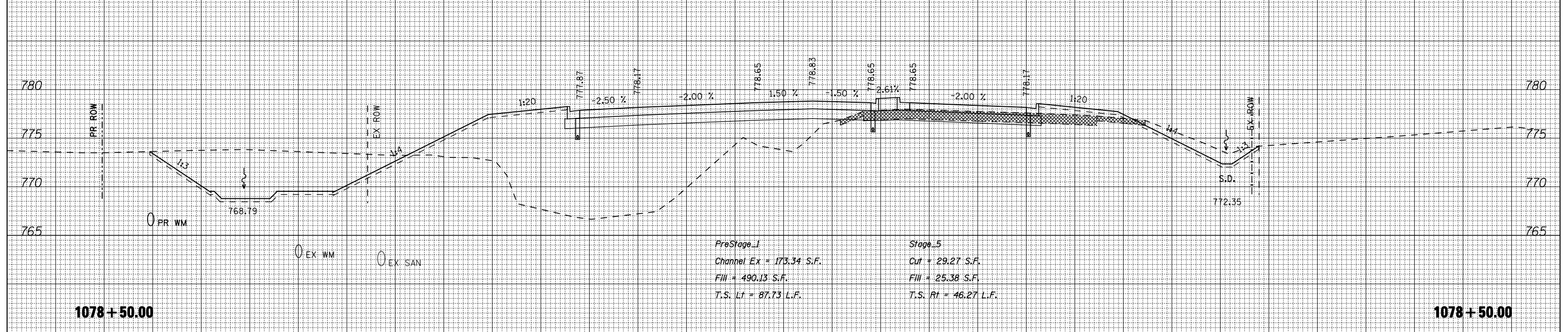

1078 + 50.00

1078 + 50.00

PreStage_1
 Channel Ex = 173.34 S.F.
 Fill = 490.13 S.F.
 T.S. Lt = 87.73 L.F.

Stage_5
 Cut = 29.27 S.F.
 Fill = 25.38 S.F.
 T.S. Rt = 46.27 L.F.

FILE NAME = ... \CADD SHEETS\Z00793XMSHT.DGN

USER NAME = Elgin 110

DESIGNED - SJF
 DRAWN - SAE
 CHECKED - RMH
 DATE - APRIL 30, 2013

REVISED -
 REVISED -
 REVISED -
 REVISED -

STATE OF ILLINOIS
 DEPARTMENT OF TRANSPORTATION

CROSS SECTIONS IL 173

SCALE: SHEET NO. OF SHEETS STA. 1078+50.00 TO STA. 1079+00.00

F.A.P. RTE.	SECTION	COUNTY	TOTAL SHEETS	SHEET NO.
303	129R	WINNEBAGO	968	820
CONTRACT NO. 64988			ILLINOIS FED. AID PROJECT	

THE UPCHURCH GROUP, INC.