

170 160 150 140 130 120 110 100 90 80 70 60 50 40 30 20 10 0 10 20 30 40 50 60 70 80 90 100 110 120 130 140 150

DATE	
BY	
SURVEYED	
PLOTTED	
TEMPLATE	
NOTE BOOK	
AREAS CHECKED	
NO.	

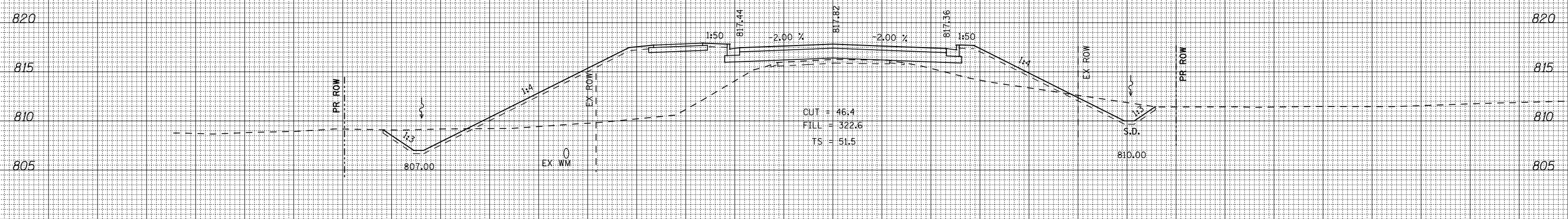

232 + 50.00

232 + 50.00

DATE	
BY	
SURVEYED	
PLOTTED	
TEMPLATE	
NOTE BOOK	
AREAS CHECKED	
NO.	

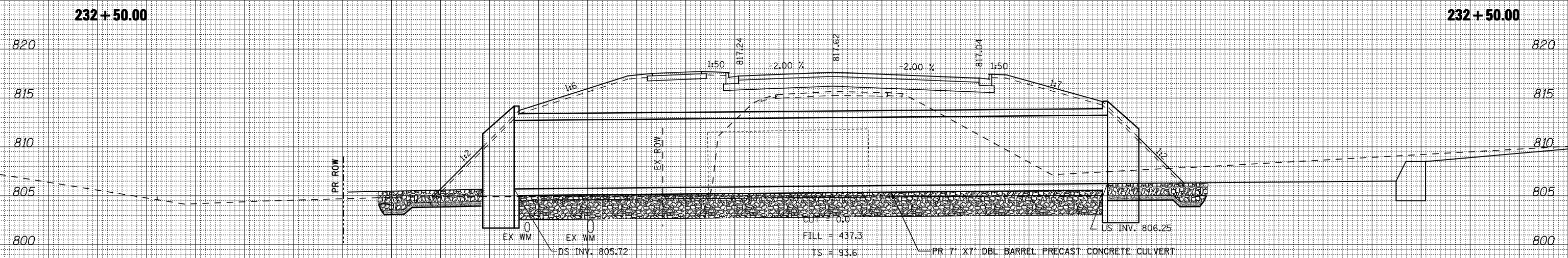

232 + 13.00

232 + 13.00

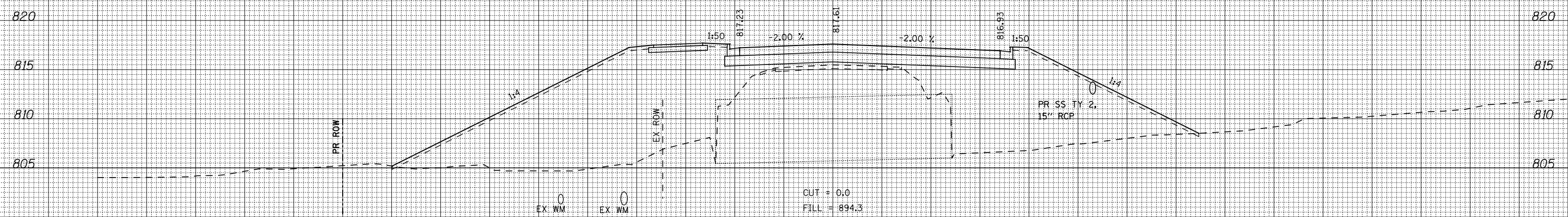

232 + 00.00

232 + 00.00

RECONSTRUCTION BEGINS STA 232+00

FILE NAME = ...\\cadd sheets\200793X595HT.dgn
 THE UPCHURCH GROUP, INC.

USER NAME = Elgin 110
 DESIGNED - RLH
 DRAWN - LMP
 CHECKED - MJS
 DATE - APRIL 30, 2013

REVISIED -
 REVISIED -
 REVISIED -
 REVISIED -

STATE OF ILLINOIS
 DEPARTMENT OF TRANSPORTATION

CROSS SECTIONS MITCHELL ROAD

SCALE: SHEET NO. OF SHEETS STA. 232+00.00 TO STA. 232+50.00

F.A.P. RTE.	SECTION	COUNTY	TOTAL SHEETS	SHEET NO.
303	129R	WINNEBAGO	968	940
			CONTRACT NO. 64988	
ILLINOIS FED. AID PROJECT				