

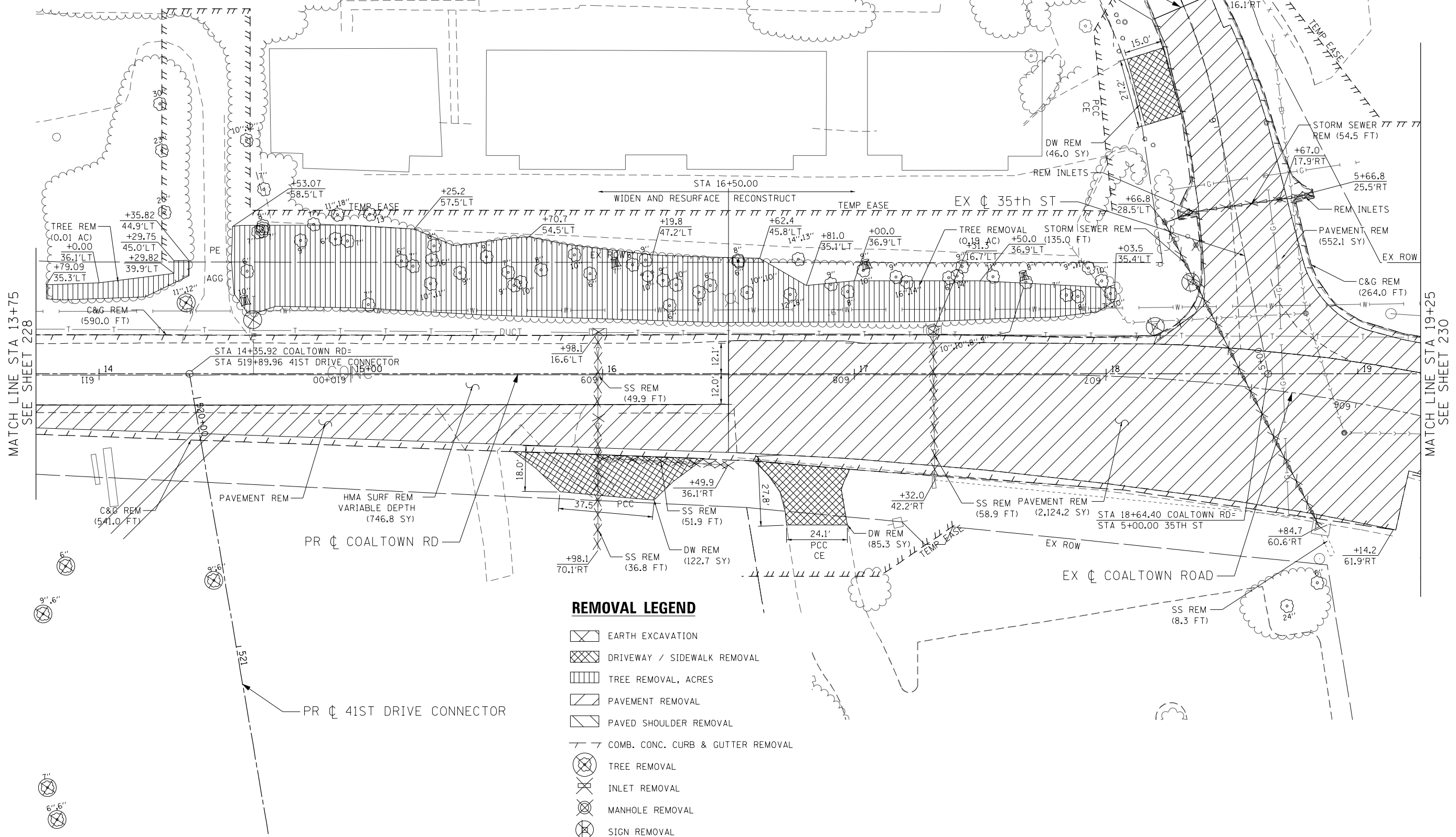

**PROJECT IMPROVEMENT ENDS  
STA 6+50.00**

SPLIT WOOD RAIL FENCE  
REMOVAL, COST SHALL  
BE INCLUDED IN CLEARING



MATCH LINE STA 13+75  
SEE SHEET 228

MATCH LINE STA 19+25  
SEE SHEET 230

**REMOVAL LEGEND**

- EARTH EXCAVATION
- DRIVEWAY / SIDEWALK REMOVAL
- TREE REMOVAL, ACRES
- PAVEMENT REMOVAL
- PAVED SHOULDER REMOVAL
- COMB. CONC. CURB & GUTTER REMOVAL
- TREE REMOVAL
- INLET REMOVAL
- MANHOLE REMOVAL
- SIGN REMOVAL
- STORM SEWER / CULVERT REMOVAL



REM-11



2600 Warrenville Road, Suite 203, Downers Grove, IL 60515  
630.705.0110 voice, 630.839.2566 fax  
www.mps-il.com  
**MILLENNIA PROFESSIONAL SERVICES**

DESIGNED - TVN	REVISED -
DRAWN - CJD	REVISED -
CHECKED - RPD	REVISED -
DATE - 3/11/2013	REVISED -

**STATE OF ILLINOIS  
DEPARTMENT OF TRANSPORTATION**

**COALTOWN ROAD  
REMOVAL PLAN**

SCALE: 1=20 SHEET NO. 2 OF 4 SHEETS STA. 13+75.00 TO STA. 19+25.00

F.A.P. RTE.	SECTION	COUNTY	TOTAL SHEETS	SHEET NO.
595	(142-11R & 142-11B)	ROCK ISLAND	507	229
CONTRACT NO. 64B84				

FED. ROAD DIST. NO. 1 ILLINOIS FED. AID PROJECT  
Pr\2011\ME11008\_PTB155-26\_IL5\_JDR.Corbac\CADD\Shets\0264B84-shr-rem11.CTRw02.dgn