





PROJECT/IMPROVEMENT ENDS  
STA 141+60.00

**LANDSCAPING LEGEND**

-  SEEDING, CLASS 2A
-  EROSION CONTROL BLANKET
-  HEAVY DUTY EROSION CONTROL BLANKET
-  SODDING, SALT TOLERANT

PR  $\oslash$  39TH STREET

EX  $\oslash$  38TH STREET

MATCH LINE STA 534+00  
SEE SHEET 276

MATCH LINE STA 539+00  
SEE SHEET 278

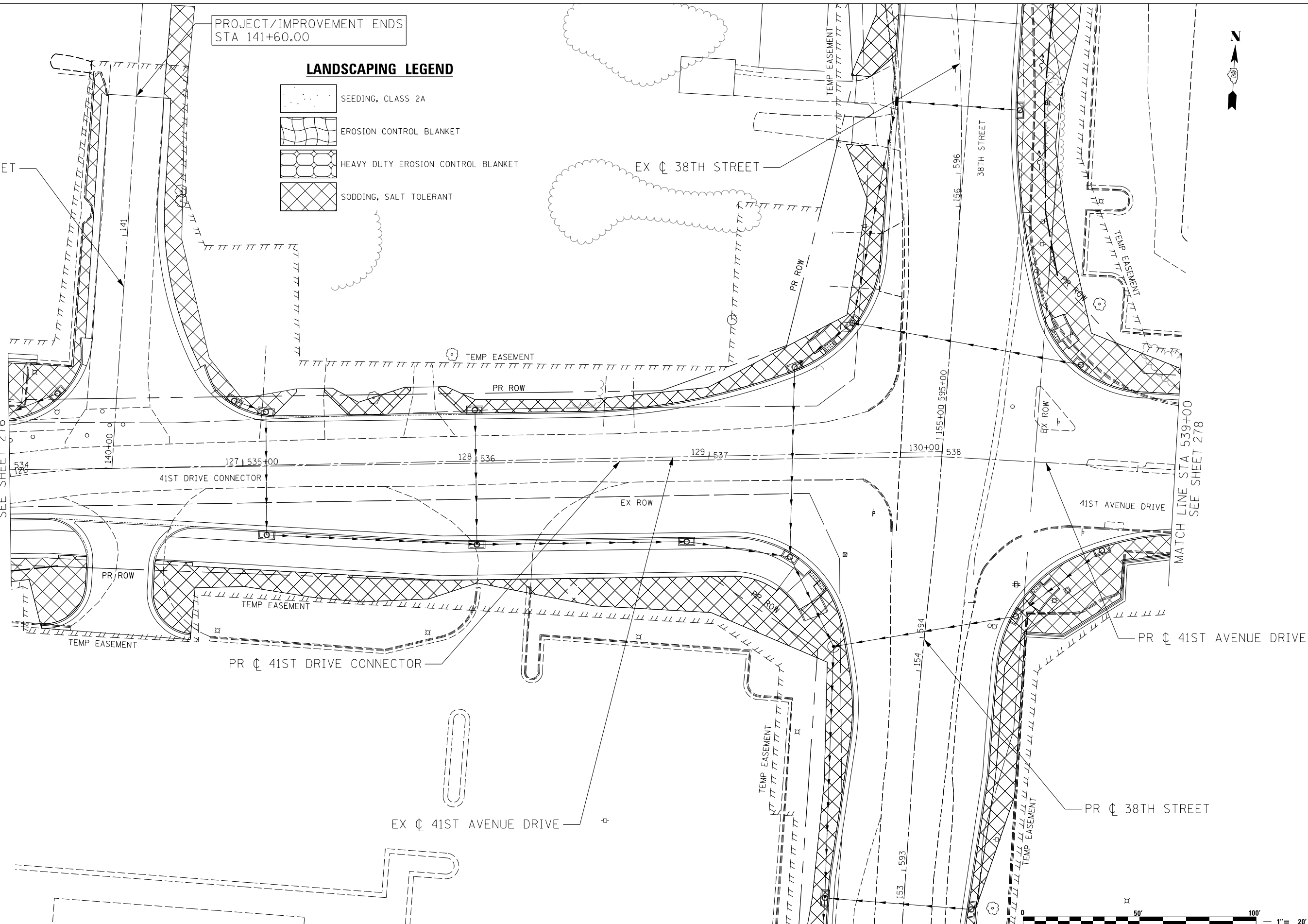

**Lin Engineering, Ltd.**  
Consulting Engineers  
Springfield, Illinois

USER NAME = Plotted by LinZl	DESIGNED - RWK	REVISED -
DRAWN - RWK	REVISIONS -	
PLOT SCALE = 40.0000' / in.	CHECKED - ST	REVISIONS -
PLOT DATE = 3/11/2013	DATE - 3/11/2013	REVISIONS -

**STATE OF ILLINOIS  
DEPARTMENT OF TRANSPORTATION**

**41ST DRIVE CONNECTOR / 41ST AVENUE DRIVE  
PERMANENT EROSION CONTROL AND LANDSCAPING PLANS**

SCALE: 1"=20' SHEET NO. 11 OF 17 SHEETS STA. 534+00 TO STA. 539+00

F.A.P. RTE.	SECTION	COUNTY	TOTAL SHEETS	SHEET NO.
595	(142-11R-1, 142-11B)	ROCK ISLAND	507	277
CONTRACT NO. 64B84				
FED. ROAD DIST. NO. 2 ILLINOIS FED. AID PROJECT				