

**ELEVATION - WEST MOMENT SLAB EXTENSION**

\*\* 3/16" x 1" Deep sawcut contraction joint in moment slab only at each parapet joint (typ.) See Note 8.

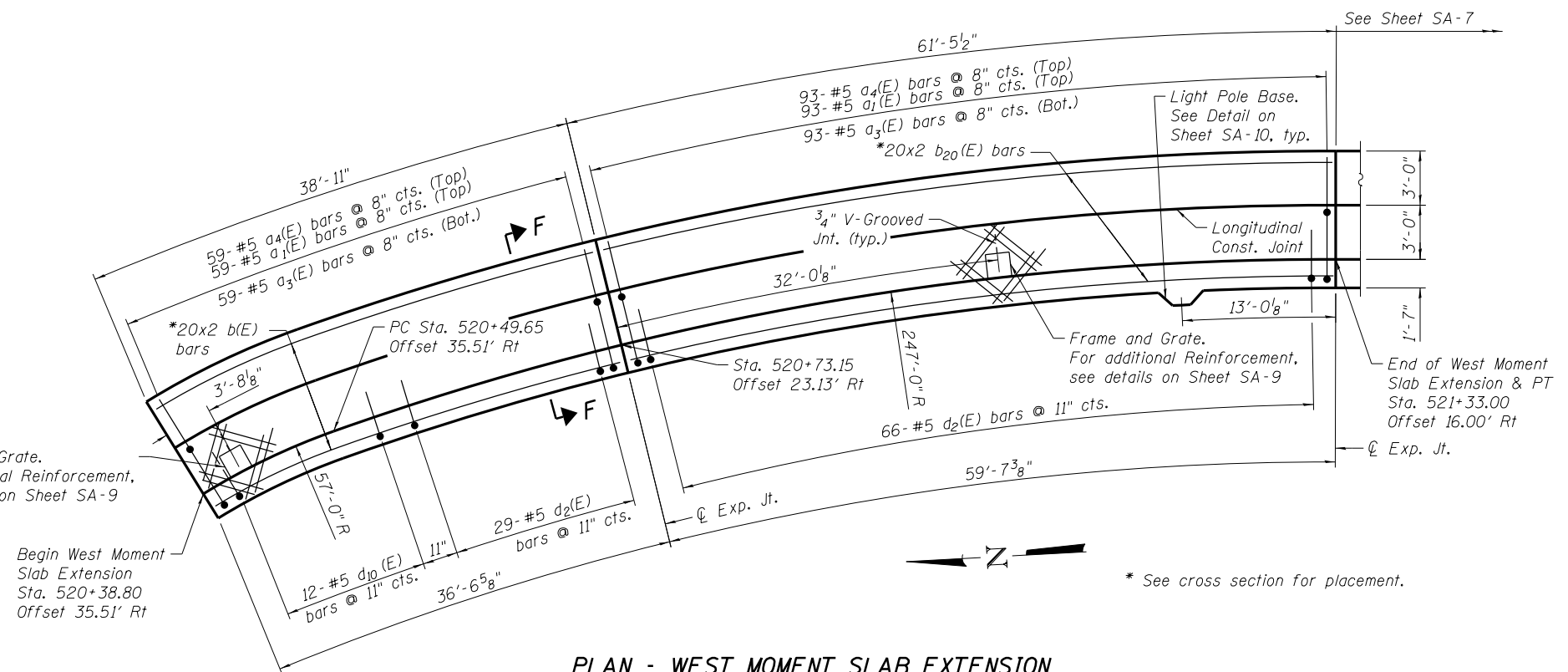

**PLAN - WEST MOMENT SLAB EXTENSION**

\* See cross section for placement.

**NOTES:**

1. Bars indicated thus 7x2-#5 etc. indicates 7 lines of bars with 2 lengths per line.
2. F.F. = Front Face & B.F. = Back Face.
3. Offsets are from  $\phi$  41st Drive Connector to front face of parapet.
4. For section F-F, see Sheet SA-9.
5. For bar bending diagrams & Bill of Materials see Sheet SA-11.
6. Bend b(E), b20(E), e(E), e5(E), e6(E), e8(E), e13(E), e17(E), e23(E), and e27(E) bars in field to match curve.
7. For parapet joint details, see Sheet SA-9.
8. For Transverse Contraction Joint details, see Sheet SA-10.
9. For Expansion Joint details, see Sheet SA-9.

**MIN. BAR LAP**

- #4 bar = 2'-11"
- #8 bar = 6'-9"

N:\PROJECTS\033333\CONTRACT\_1\Design\Structure\1\CAD\Retaining Wall\081-7002\081-7002\_06.West\_Moment\_Slab-0.dgn



USER NAME = mteng	DESIGNED - APD	REVISED -
PLOT SCALE = 1/4" = 1' / in.	CHECKED - BWS	REVISED -
PLOT DATE = 3/11/2013	DRAWN - RD	REVISED -
	CHECKED - BWS	REVISED -

**STATE OF ILLINOIS  
DEPARTMENT OF TRANSPORTATION**

**WEST MOMENT SLAB EXTENSION PLAN & ELEVATION  
STRUCTURE NO. 081-7002**

SHEET NO. SA-6 OF SA-16 SHEETS

F.A.P. RTE.	SECTION	COUNTY	TOTAL SHEETS	SHEET NO.
595	(142-1)R-1 AND 142-1HB	ROCK ISLAND	507	332
CONTRACT NO. 64B84				

ILLINOIS FED. AID PROJECT