

Note:
 All cross frames shall be installed as steel is erected and secured with erection pins and bolts in accordance with the erection plan approved by the Engineer. Individual cross frames at supports may be temporarily disconnected to install bearing anchor rods.
 All girder plates, including bearing stiffeners shall be AASHTO M 270 Grade 50.
 See sheet 28 of 55 for cross frame details and Section A-A.
 Load carrying components designated "NTR" shall conform to the Impact Testing Requirement, Zone 2.

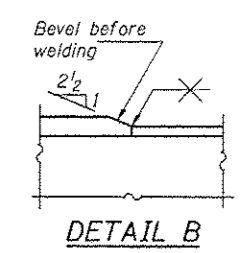
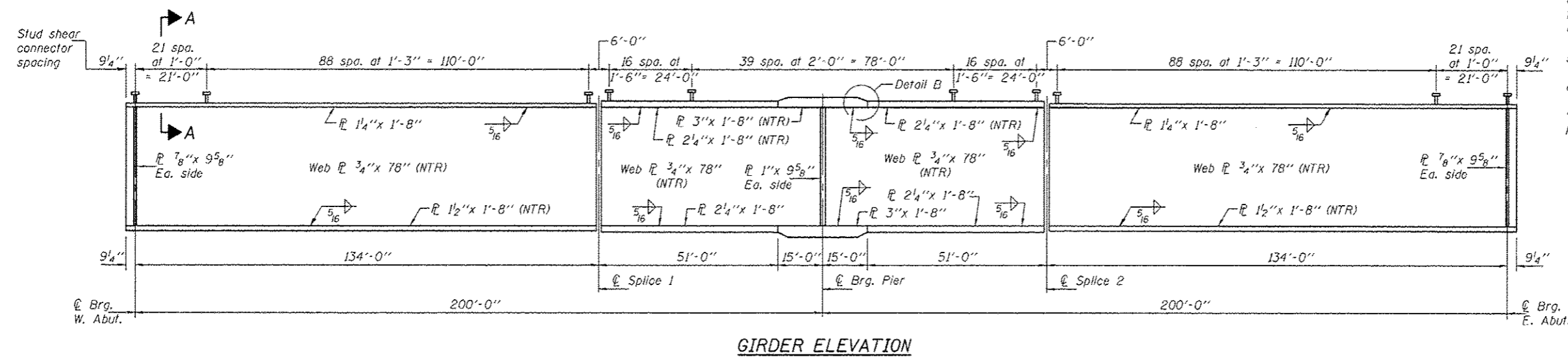

DESIGNED - Nick R. Barnett	EXAMINED - <i>John F. [Signature]</i> ACTING ENGINEER OF BRIDGE DESIGN	DATE - OCTOBER 4, 2013	STATE OF ILLINOIS DEPARTMENT OF TRANSPORTATION	STRUCTURAL STEEL STRUCTURE NO. 101-0195 (E.B.) & 101-0196 (W.B.)	F.A.P. RTE. 301	SECTION 3BR & 3BR-1	COUNTY WINNEBAGO	TOTAL SHEETS 290	SHEET NO. 126	
CHECKED - Al-Barrac R. Shebib	PASSED - <i>[Signature]</i> ACTING ENGINEER OF BRIDGES AND STRUCTURES	REVISED			CONTRACT NO. 64D19					
DRAWN - h.t. duang		REVISED			ILLINOIS FED. AID PROJECT					
CHECKED - NRB/GRA					SHEET NO. 27 OF 55 SHEETS					