

**TYPICAL SECTION - US 20 BYPASS**  
STA 912+00 TO STA 944+00

- NOTES:**
- SEE "TRAFFIC CONTROL PLAN" IN THE CONTRACT SPECIAL PROVISIONS.
  - VARIES - SOME MINOR GRADING WILL BE REQUIRED AT VARIOUS LOCATIONS.
  - LOCATIONS OF THE EX GUARDRAIL NOT SHOWN - SEE STAGING PLANS.
  - SEE "GUARDRAIL SCHEDULES" FOR PR & TEMP GUARDRAIL TYPES AND LOCATIONS.
  - SEE STAGING PLANS FOR ALL TRAFFIC CONTROL DEVICES.
  - VERTICAL PANELS (POST MOUNTED) SHALL BE USED AS SHOWN.

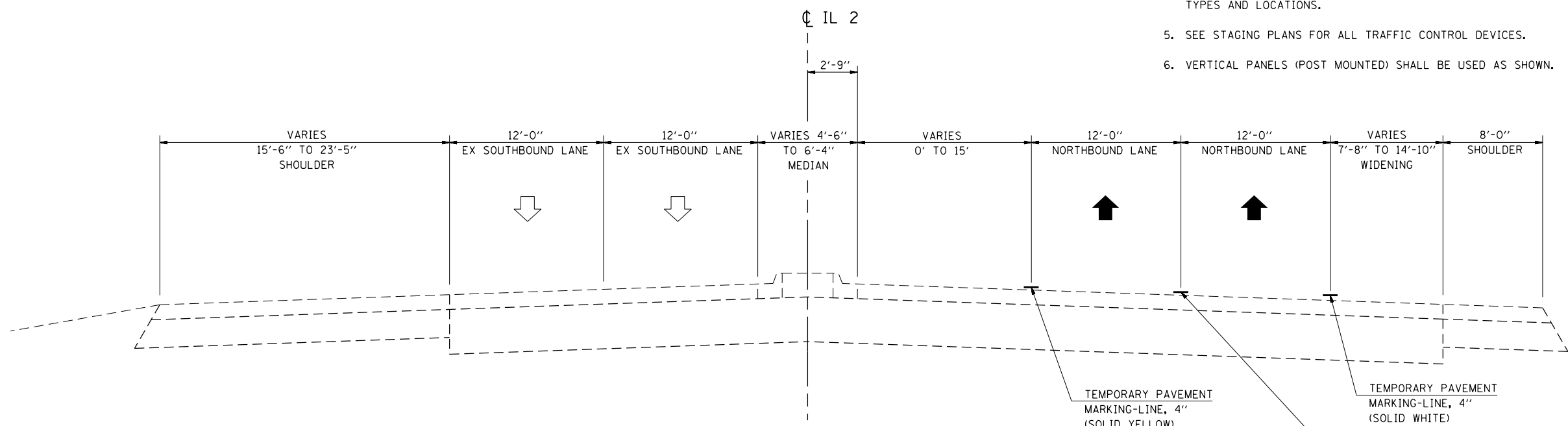

**TYPICAL SECTION - IL 2**  
STA 234+23.00 TO STA 250+64.00

FILE NAME = D264019-ahh-Staging-2-1.tgncel.dgn  
MODEL = Default  
PLOT DRIVER = V8...IDOT...PDF...1x17.pltcf9



USER NAME = rgoertz	DESIGNED - RG	REVISED -
PLOT SCALE = 10.0000' / in.	DRAWN - TRF	REVISED -
PLOT DATE = 8/16/2013	CHECKED - CMS	REVISED -
	DATE - 07/01/2013	REVISED -

**STATE OF ILLINOIS  
DEPARTMENT OF TRANSPORTATION**

STAGING PLAN STAGE 2 - TYPICAL SECTIONS			
SCALE:	SHEET NO.	OF SHEETS	STA. TO STA.

F.A.P. RTE.	SECTION	COUNTY	TOTAL SHEETS	SHEET NO.
301	3BR & 3BR-1	WINNEBAGO	290	67
CONTRACT NO. 64D19				
FED. ROAD DIST. NO. ILLINOIS FED. AID PROJECT				