

NOTE

- SEE 701400, 701411, 701416 & 704001 FOR ADDITIONAL INFORMATION

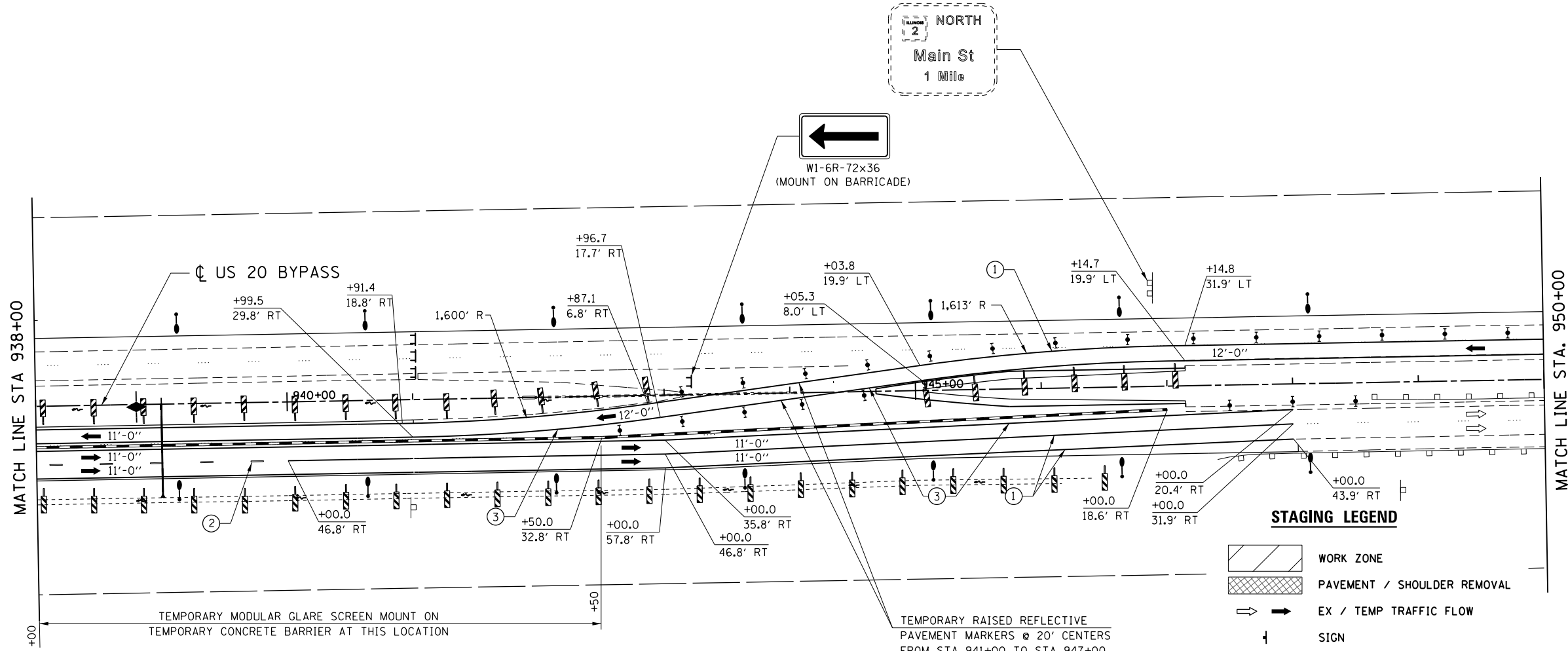
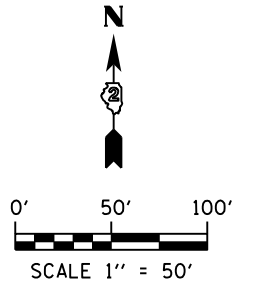

STAGING LEGEND

- WORK ZONE
- PAVEMENT / SHOULDER REMOVAL
- EX / TEMP TRAFFIC FLOW
- SIGN
- DIRECTIONAL INDICATOR BARRICADE W/ STEADY BURN MONODIRECTIONAL LIGHT
- TYPE II BARRICADE, DRUM W/ STEADY BURN MONODIRECTIONAL LIGHT
- TYPE III BARRICADE
- TEMPORARY CONCRETE BARRIER WALL
- ① SOLID WHITE, 4"
- ② SKIP DASH WHITE, 4"
- ③ SOLID YELLOW, 4"
- ④ LETTERS AND SYMBOLS
- ⑤ SOLID WHITE, 24"
- ⑥ SOLID WHITE, 8"
- ⑦ DOTTED WHITE, 8"
- ⑧ SOLID WHITE, 12"
- ⑨ SOLID YELLOW, 12"
- ⑩ LETTERS & SYMBOLS

FILE NAME = D264019-ahh-Staging-2.dwg
 MODEL = Default
 PLOT DRIVER = V8...IDOT...PDF...1x17...plc1g



USER NAME = rgoertz	DESIGNED - RG	REVISED -
DRAWN - TRF	REVISIONS -	
PLOT SCALE = 100.0000' / in.	CHECKED - CMS	REVISIONS -
PLOT DATE = 8/16/2013	DATE - 07/01/2013	REVISIONS -

**STATE OF ILLINOIS
DEPARTMENT OF TRANSPORTATION**

**STAGING PLAN
STAGE 2 - US 20 BYPASS**

SCALE: 1" = 50' SHEET NO. OF SHEETS STA. 938+00 TO STA. 950+00

F.A.P. RTE.	SECTION	COUNTY	TOTAL SHEETS	SHEET NO.
301	3BR & 3BR-1	WINNEBAGO	290	73
CONTRACT NO. 64D19				
FED. ROAD DIST. NO. ILLINOIS FED. AID PROJECT				