

TEMPORARY TRAFFIC SIGNAL LEGEND

- TEMPORARY TRAFFIC SIGNAL CONTROLLER
- TEMPORARY SERVICE INSTALLATION
- TEMPORARY SIGNAL HEAD
- TEMPORARY SIGNAL HEAD, PEDESTRIAN, BRACKET MOUNTED
- TEMPORARY WOOD POLE (CLASS 5 OR BETTER) 45 FOOT MINIMUM
- TEMPORARY SPAN WIRE, TETHER WIRE AND CABLE
- TEMPORARY PEDESTRIAN PUSHBUTTON DETECTOR
- TEMPORARY VIDEO DETECTION CAMERA
- TEMPORARY 15' MAST ARM AND 250W LUMINAIRE

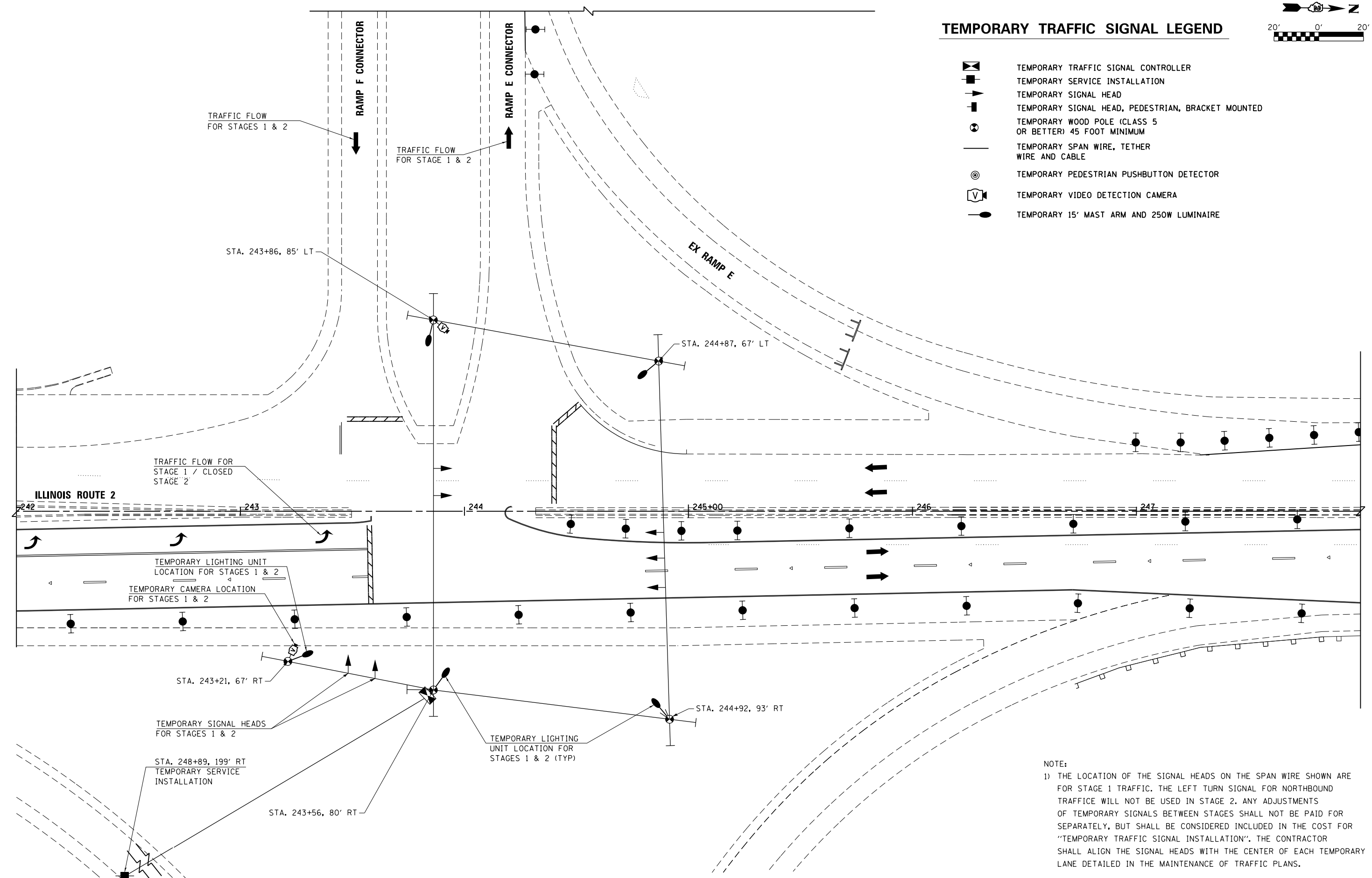

FILE NAME = D:\264019-ah-t-Traffic-Signals_04.dgn
 MODEL = Default
 PLOT DRIVER = V8...IDOT_PDF...11x17.plt



USER NAME = rgoertz	DESIGNED - RG	REVISED -
PLOT SCALE = 48.0000' / in.	DRAWN - TRF	REVISED -
PLOT DATE = 8/16/2013	CHECKED - CMS	REVISED -
	DATE - 07/01/2013	REVISED -

**STATE OF ILLINOIS
DEPARTMENT OF TRANSPORTATION**

**TEMPORARY TRAFFIC SIGNAL PLAN
STAGES 1 & 2**

SCALE:	SHEET NO.	OF SHEETS	STA.	TO STA.
--------	-----------	-----------	------	---------

F.A.P. RTE.	SECTION	COUNTY	TOTAL SHEETS	SHEET NO.
301	3BR & 3BR-1	WINNEBAGO	290	81
CONTRACT NO. 64D19				
FED. ROAD DIST. NO. ILLINOIS FED. AID PROJECT				