

**PLAN (W.B.)**

© F.A.P. Rte. 301  
(US Rte. 20)

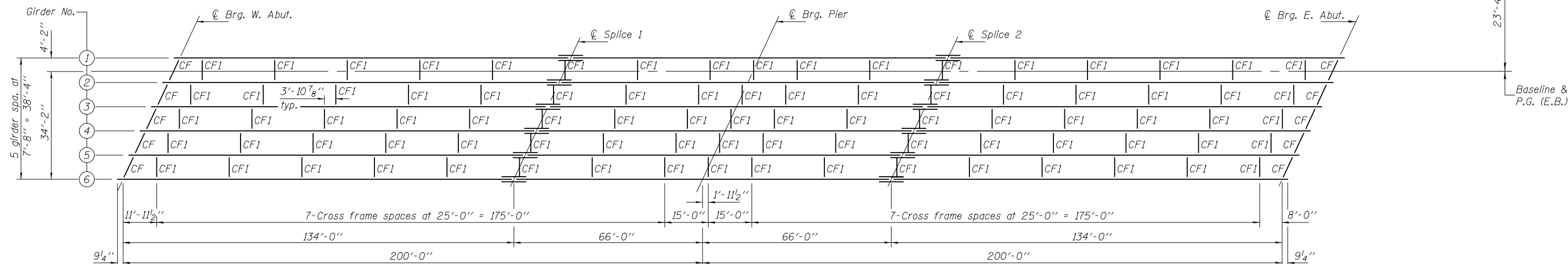

**PLAN (E.B.)**

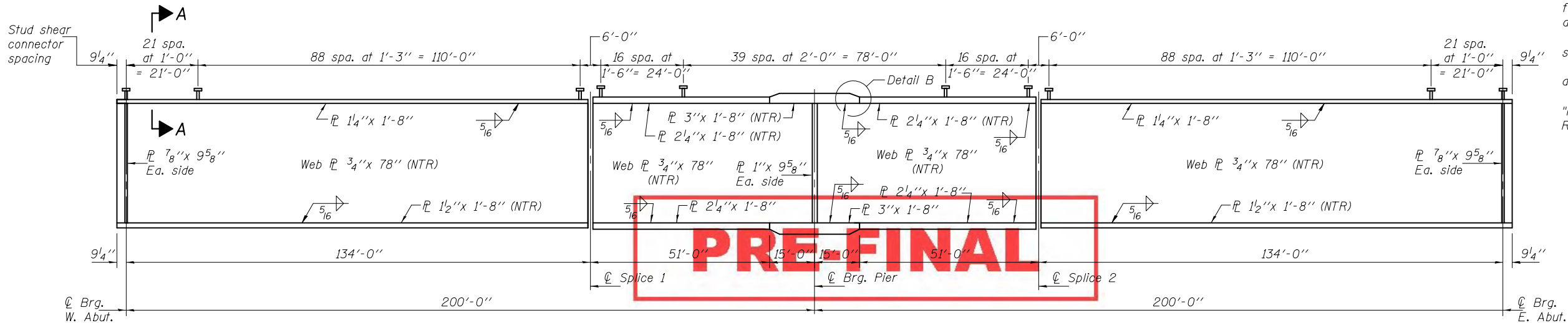

**GIRDER ELEVATION**

Note:  
All cross frames shall be installed as steel is erected and secured with erection pins and bolts in accordance with the erection plan approved by the Engineer. Individual cross frames at supports may be temporarily disconnected to install bearing anchor rods.  
All girder plates, including bearing stiffeners shall be AASHTO M 270 Grade 50.  
See sheet 28 of 55 for cross frame details and Section A-A.  
Load carrying components designated "NTR" shall conform to the Impact Testing Requirement, Zone 2.

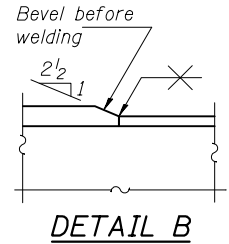

**DETAIL B**

DESIGNED -	EXAMINED - <i>Jayne F. [Signature]</i>	DATE -	<b>STATE OF ILLINOIS DEPARTMENT OF TRANSPORTATION</b>	<b>STRUCTURAL STEEL STRUCTURE NO. 101-0195 (E.B.) &amp; 101-0196 (W.B.)</b>	F.A.P. RTE. 301	SECTION 3BR & 3BR-1	COUNTY WINNEBAGO	TOTAL SHEETS	SHEET NO.	
CHECKED -	PASSED - <i>Carl [Signature]</i>	REVISED			CONTRACT NO. 64D19		ILLINOIS FED. AID PROJECT			
DRAWN - h.t. duong	ACTING ENGINEER OF BRIDGES AND STRUCTURES	REVISED			SHEET NO. 27 OF 55 SHEETS					
CHECKED -		REVISED								