

IL-84 STAGE I CONSTRUCTION

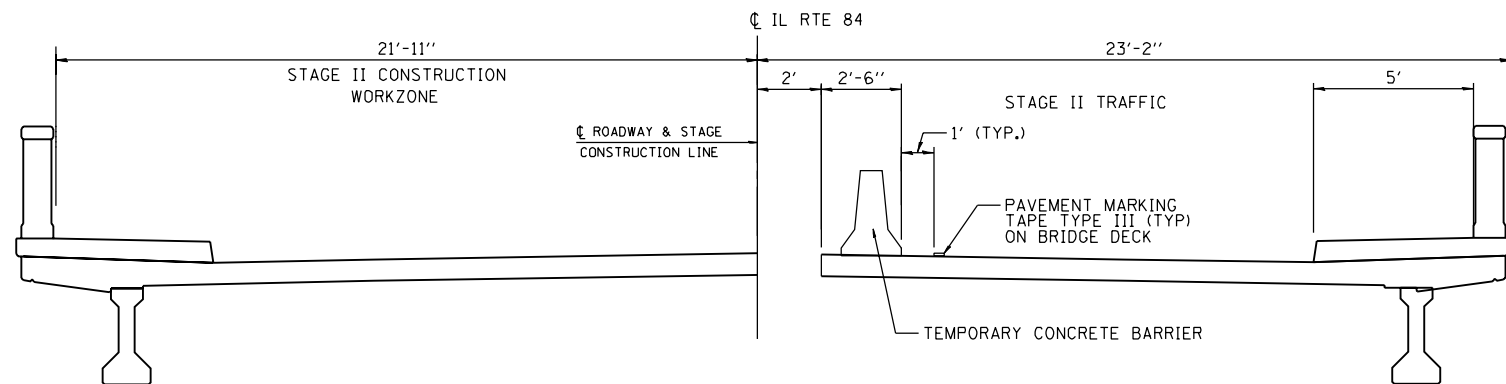

IL-84 STAGE II CONSTRUCTION

MAINTENANCE OF TRAFFIC AND CONSTRUCTION SEQUENCE DESCRIPTION

PRE-STAGE CONSTRUCTION
 INSTALL TEMPORARY PAVEMENT, LOCATE EXISTING UTILITIES ON EACH SIDE OF THE BRIDGE. RELOCATE EXISTING PUMP STATION ON WEST SIDE OF THE BRIDGE.

MAINTENANCE OF TRAFFIC
 MAINTAIN TWO-WAY TRAFFIC AT ALL TIMES. UTILIZE IDOT STANDARD 701501 & 701326 FOR LANE CLOSURE.

PEDESTRIAN TRAFFIC
 THE CONTRACTOR SHALL CLOSE SIDEWALKS AS REQUIRED TO PERFORM WORK AND ENSURE THE SAFETY OF THE PUBLIC. SIDEWALK CLOSURES SHALL COMPLY WITH STANDARD 701801. THE CONTRACTOR SHALL ENSURE THAT PEDESTRIANS HAVE A SAFE ALTERNATE ROUTE WHEN A SIDEWALK CLOSURE IS IMPLEMENTED.

STAGE I CONSTRUCTION
 REMOVE AND CONSTRUCT EAST SIDE OF THE BRIDGE, CONSTRUCT EAST HALF OF THE SOUTH APPROACH ROADWAY PAVEMENT, AND CONSTRUCT EAST HALF OF THE APPROACH SLABS. CONSTRUCT PROPOSED SIDEWALK, CURB & GUTTER AND RETAINING WALLS ON EAST SIDE OF ILLINOIS ROUTE 84, NORTH OF FULTON STREET. RECONSTRUCT FULTON STREET (EAST LEG).

MAINTENANCE OF TRAFFIC
 UTILIZE IDOT STANDARD 701321 AND THE STAGES OF CONSTRUCTION AND TRAFFIC CONTROL PLANS STAGE I AS SHOWN. CONTRACTOR MUST MAINTAIN ACCESS TO DRIVEWAYS AT ALL TIMES.

STAGE II CONSTRUCTION
 REMOVE AND CONSTRUCT WEST SIDE OF THE BRIDGE, CONSTRUCT WEST HALF OF THE SOUTH APPROACH SLAB, CONSTRUCT SIDEWALK, CURB & GUTTER AND RETAINING WALL ON WEST SIDE OF ILLINOIS ROUTE 84 SOUTH OF APPLE RIVER. CONSTRUCT WEST HALF OF THE NORTH APPROACH SLAB AND WEST HALF OF THE SOUTH APPROACH ROADWAY PAVEMENT. CONSTRUCT THE SOUTH SIDE OF FULTON ROAD PAVEMENT, CONSTRUCT SIDEWALK AND CURB & GUTTER AT SOUTHWEST CORNER OF FULTON ROAD AND ILLINOIS ROUTE 84.

MAINTENANCE OF TRAFFIC
 UTILIZE IDOT STANDARD 701316 AND 701321 AND THE STAGES OF CONSTRUCTION AND TRAFFIC CONTROL PLANS STAGE II AS SHOWN. CONTRACTOR MUST MAINTAIN ACCESS TO DRIVEWAYS AT ALL TIMES.

STAGE IIB CONSTRUCTION
 CONSTRUCT NORTH HALF OF THE FULTON ROAD PAVEMENT, THE WEST SHOULDER AND CURB & GUTTER ON ILLINOIS ROUTE 84 NORTH OF FULTON ROAD.

MAINTENANCE OF TRAFFIC
 UTILIZE IDOT STANDARD 701316 AND THE STAGES OF CONSTRUCTION AND TRAFFIC CONTROL PLANS STAGE IIB AS SHOWN.

STAGE III CONSTRUCTION
 MILL AND RESURFACE NORTH APPROACH ROADWAY PAVEMENT WITHIN PROJECT LIMITS. INSTALL PROPOSED PERMANENT PAVEMENT MARKING AND RAISED PAVEMENT REFLECTORS FOR ROADWAY AND BRIDGE.
MAINTENANCE OF TRAFFIC
 MAINTAIN TWO-WAY TRAFFIC AT ALL TIMES. UTILIZE IDOT STANDARDS 701311 AND 701501.

NOTES:
 1. THE BRIDGE WILL BE STAGE CONSTRUCTED BY PROVIDING ONE LANE OF TRAFFIC ON THE ILLINOIS ROUTE 84 BRIDGE AT ALL TIMES. MONROE STREET AND FULTON STREET (EAST LEG) AS WELL AS FRANKLIN STREET (EAST AND WEST LEGS) SHALL BE CLOSED TO FACILITATE TWO-WAY TRAFFIC ON THE BRIDGE DURING CONSTRUCTION.

FILE NAME : P:\2010\ME10010\PTB154-23.WHKS\CADD\Bases2\Z64E08-SHT.Stage00-Typ.dgn
 USER : MPM
 MILLENNIA PROFESSIONAL SERVICES



2600 Warrenville Road, Suite 203, Downers Grove, IL 60515-1761
 630.705.0110 voice, 630.839.3566 fax
 www.mps-il.com
MILLENNIA PROFESSIONAL SERVICES

DESIGNED - TVN	REVISED -
DRAWN - TVN/BB	REVISED -
CHECKED - MG	REVISED -
DATE - 7/24/2013	REVISED -

**STATE OF ILLINOIS
 DEPARTMENT OF TRANSPORTATION**

**IL ROUTE 84
 OVER APPLE RIVER**

**STAGES OF CONSTRUCTION
 TYPICAL SECTIONS**

SCALE: NTS SHEET NO. 1 OF 4 SHEETS STA. TO STA.

F.A.P. RTE.	SECTION	COUNTY	TOTAL SHEETS	SHEET NO.
308	103BR-4	JO DAVIESS	159	30
CONTRACT NO.			64E08	

FED. ROAD DIST. NO. 1 ILLINOIS FED. AID PROJECT
 P:\2010\ME10010\PTB154-23.WHKS\CADD\Bases2\Z64E08-SHT.Stage00-Typ.dgn