

Note:
Quantity of concrete in end post included with Concrete Superstructure on sheet 21 of 79.

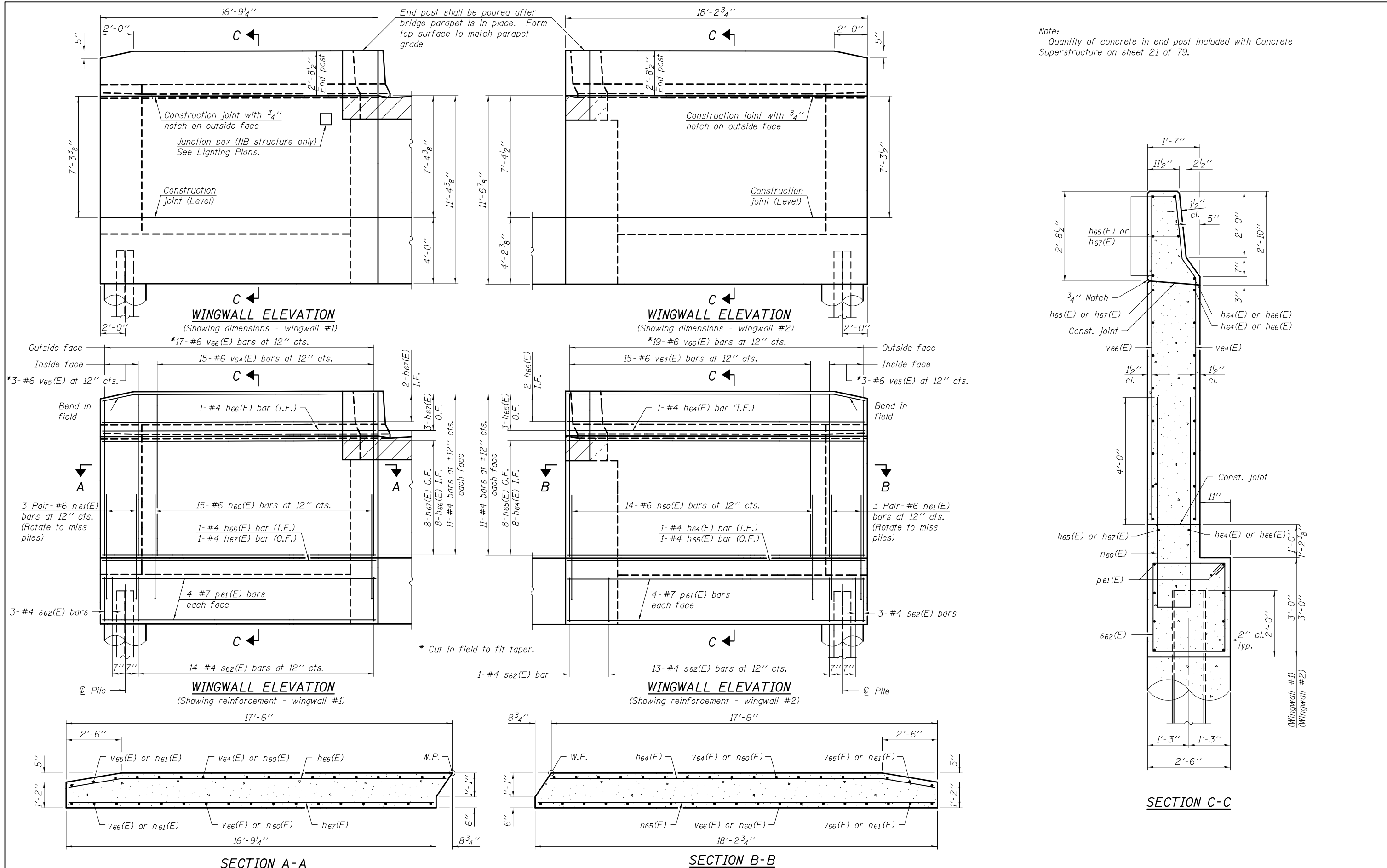

DESIGNED - JUSTIN T. BELUE	EXAMINED - <i>Joanne F. J. [Signature]</i>	DATE - OCTOBER 4, 2013	STATE OF ILLINOIS DEPARTMENT OF TRANSPORTATION	SOUTH ABUTMENT - STRUCTURE NO. 046 - 0135 (NB) NORTH ABUTMENT - STRUCTURE NO. 046 - 0136 (SB)	F.A.I. R.T.E.	SECTION	COUNTY	TOTAL SHEETS	SHEET NO.	
CHECKED - DAVID H. RICHTER	PASSED - <i>Carl [Signature]</i>	REVISED -			57	(140)BR&BR-1	KANKAKEE	183	91	
DRAWN - MICHAEL B. MOSSMAN	ACTING ENGINEER OF BRIDGES AND STRUCTURES	REVISED -			CONTRACT NO. 66750					
CHECKED - J.T.B. / D.H.R.	ACTING ENGINEER OF BRIDGES AND STRUCTURES	REVISED -			SHEET NO. 51 OF 79 SHEETS					