

Notes:
 Hatched area to be poured after superstructure false work has been removed. Quantity of concrete included with Concrete Superstructure.
 Space reinforcement in cap to miss anchor bolts.
 Pour steps monolithically with cap.
 All exposed surfaces of the backwall, bridge seats, and front face of cap shall be treated with Concrete Sealer.

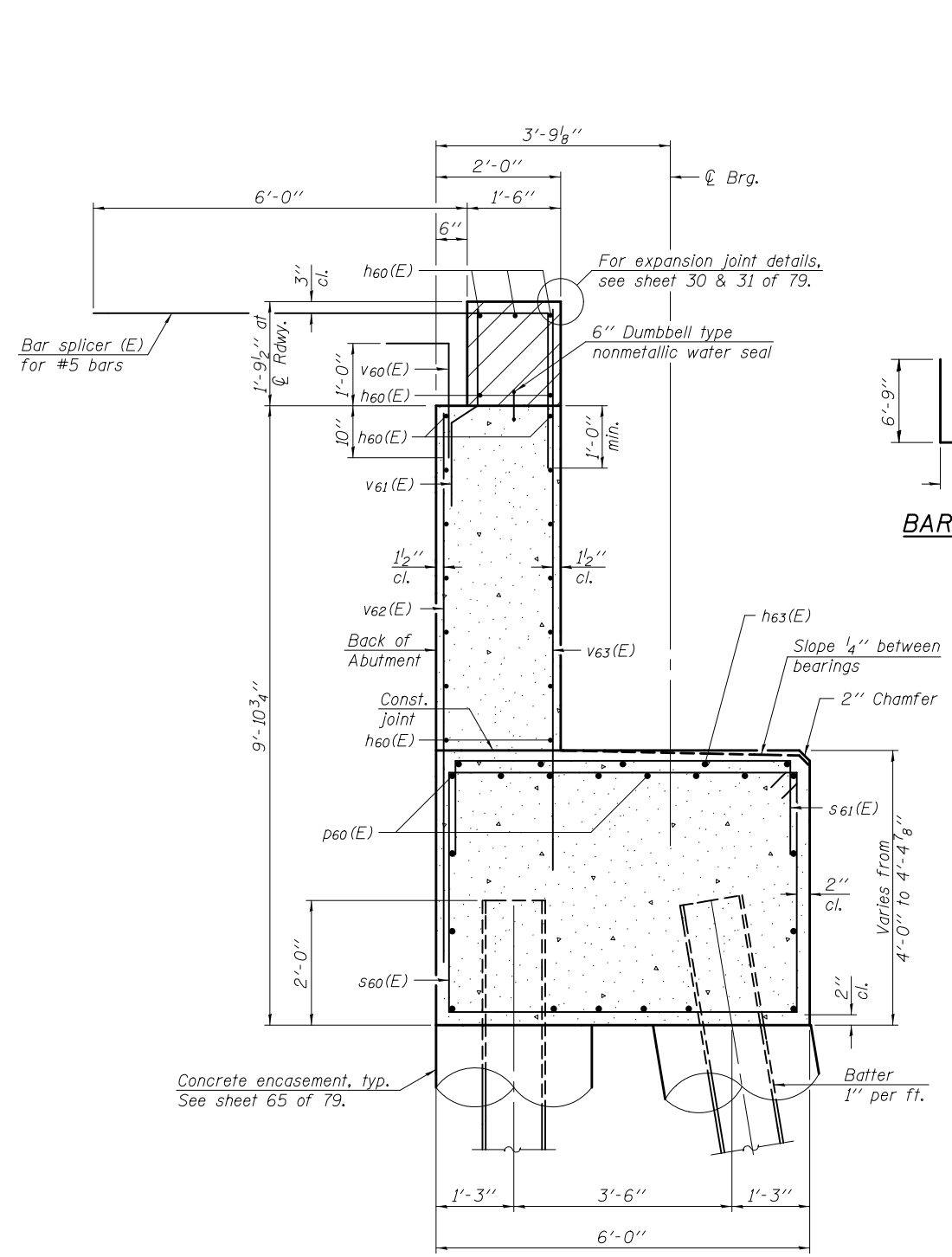

SECTION THRU ABUTMENT

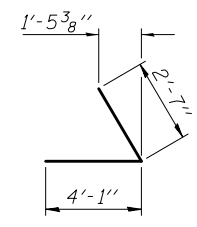

BAR h61(E)

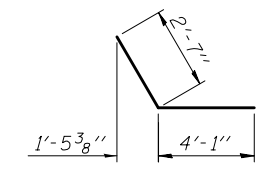

BAR h62(E)

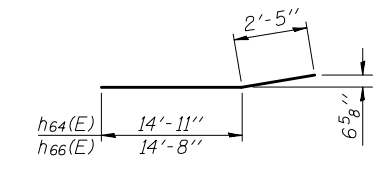

BARS h64(E) & h66(E)

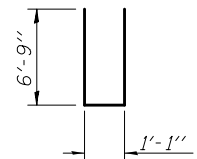

BAR n60(E)

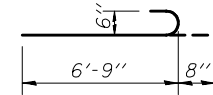

BAR n61(E)

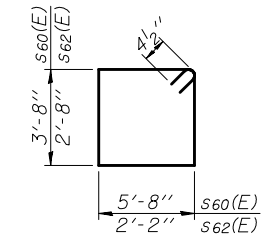

BARS s60(E) & s62(E)

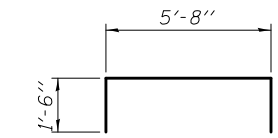

BAR s61(E)

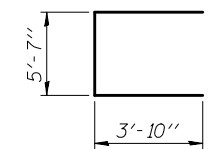

BAR u60(E)

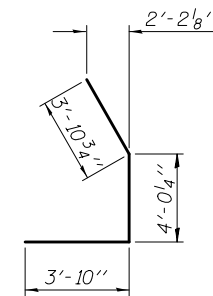

BAR u61(E)

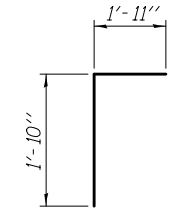

BAR v60(E)

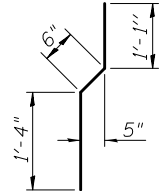

BAR v61(E)

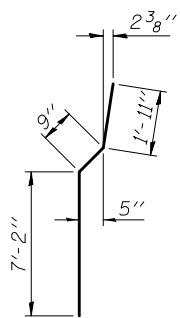

BAR v64(E)

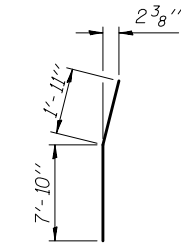

BAR v65(E)

TWO ABUTMENTS
 BILL OF MATERIAL

Bar	No.	Size	Length	Shape
h60(E)	76	#6	25'-11"	—
h61(E)	32	#5	6'-8"	↘
h62(E)	32	#5	6'-8"	↗
h63(E)	10	#4	8'-6"	—
h64(E)	20	#4	17'-4"	—
h65(E)	28	#4	17'-11"	—
h66(E)	20	#4	17'-1"	—
h67(E)	28	#4	16'-6"	—
n60(E)	58	#6	14'-7"	U
n61(E)	24	#6	7'-5"	U
p60(E)	72	#7	28'-4"	—
p61(E)	32	#7	18'-1"	—
s60(E)	120	#4	19'-5"	□
s61(E)	18	#4	8'-8"	□
s62(E)	68	#4	10'-5"	□
u60(E)	8	#6	13'-3"	—
u61(E)	8	#6	11'-9"	—
v60(E)	98	#5	3'-9"	┌
v61(E)	98	#4	2'-11"	└
v62(E)	98	#5	9'-0"	—
v63(E)	98	#5	9'-2"	—
v64(E)	60	#6	9'-10"	—
v65(E)	12	#6	9'-9"	—
v66(E)	72	#6	9'-8"	—
Structure Excavation		Cu. Yd.	157.1	
Concrete Structures		Cu. Yd.	187.0	
Reinforcement Bars, Epoxy Coated		Pound	18,430	
Concrete Encasement		Cu. Yd.	18.6	
Furnishing Steel Piles HP 14x73		Foot	1,856	
Driving Piles		Foot	1,856	
Test Pile Steel HP 14x73		Each	2	
Pile Shoes		Each	34	
Concrete Sealer		Sq. Ft.	1,446.6	

For details of Bar Splicers, see sheet 66 of 79.
 For details of piles and Concrete Encasement, see sheet 65 of 79.