

- Notes:
- ① Tilt #9 b22(E) bars as required to maintain clearance.
 - ② For Sections C-C and D-D, bar details, and Bill of Material, see sheet 5 of 5.
 - ③ a25(E), a26(E), a27(E), and a28(E) bar spacing measured along \varnothing Roadway.
 - ④ For Approach Bent and West Bridge Approach Slab details, see Bridge Plans.
 - ⑤ Flexible foam expansion joint filler according to Article 1051.09 of the Standard Specifications; full depth and full length of slab and footing. Cost included with Concrete Superstructure.

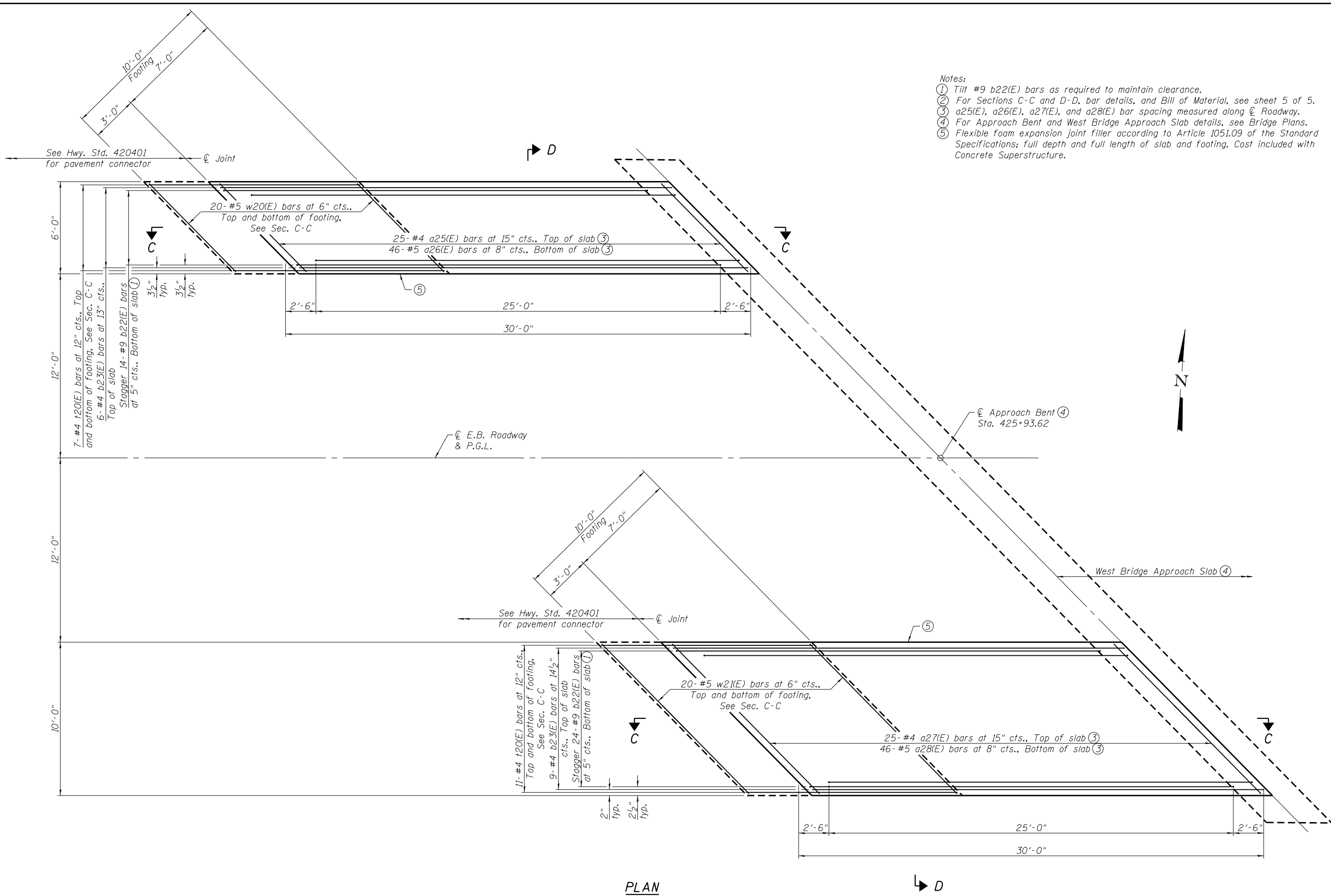

PLAN



USER NAME =	DESIGNED - JAD	REVISED -
	CHECKED - SUN	REVISED -
PLOT SCALE =	DRAWN - JAD	REVISED -
PLOT DATE =	CHECKED - SUN	REVISED -

STATE OF ILLINOIS
DEPARTMENT OF TRANSPORTATION

E.B. CONNECTOR SHOULDER DETAILS

SHEET NO. 3 OF 5 SHEETS

F.A.I. RTE.	SECTION	COUNTY	TOTAL SHEETS	SHEET NO.
80	(06-2)BR-3,4	BUREAU	133	90
CONTRACT NO. 66998				
ILLINOIS FED. AID PROJECT				