

STAGE 2 CONSTRUCTION

CONSTRUCT PERMANENT NORTHBOUND LANES FROM STA 6029+00± TO STA 6104+00±.

WORK FROM STA 6075+00± TO STA 6083+00± SHALL BE PERFORMED IN A MANNER TO INITIALLY GAP THE PRIMARY FAIRGROUND ENTRANCES AT STA 6075+00± AND STA 6082+50±. WORK ADJACENT TO THE ENTRANCES SHALL BE THE FINAL SEGMENTS CONSTRUCTED IN STAGE 2 AND SHALL BE SCHEDULED SO ONE ENTRANCE IS OPEN AT ALL TIMES. THE INDIVIDUAL ENTRANCE CLOSURES ARE LIMITED TO 7 CALENDAR DAYS EACH. BOTH ENTRANCES SHALL BE OPEN FOR THE FOLLOWING DATES: DATES TO BE PROVIDED BY IDOT.

CONSTRUCTION OF THE MEDIAN CURB IS TO BE GAPPED FOR ACCESS AT:
 STA 6047+15 TO STA 6047+65
 STA 6069+12 TO STA 6083+50
 STA 6086+25 TO STA 6086+75
 STA 6088+00 TO STA 6088+50

TEMPORARY ACCESS RAMPS SHALL BE CONSTRUCTED AS SHOWN IN DETAIL B, AT LOCATIONS SHOWN IN THE SCHEDULE.

THE CONTRACTOR WILL BE ALLOWED TO CLOSE GRANVILLE RD. FOR A MAXIMUM OF 30 CALENDAR DAYS TO RECONSTRUCT. THIS CLOSURE WILL NOT BE ALLOWED UNTIL THE END OF STAGE 2 SO THAT STAGE 3 CAN COMMENCE IMMEDIATELY.

AT THE CONTRACTOR'S OPTION AND SUBJECT TO THE ENGINEERS APPROVAL THE CONTRACTOR MAY CLOSE GRANVILLE RD. FOR CONSTRUCTION OF THE PROPOSED BOX CULVERT UNDER GRANVILLE RD. PRIOR TO THE CLOSURE FOR THE ROADWAY RECONSTRUCTION. THIS CLOSURE WILL BE LIMITED 15 CALENDAR DAYS. THE CONTRACTOR SHALL SCHEDULE OPERATIONS SO THAT THESE CLOSURES DO NOT OCCUR CONSECUTIVELY NOR WITHIN 30 CALENDAR DAYS OF EACH OTHER.

THE CONTRACTOR IS REQUIRED TO PROVIDE AND MAINTAIN TEMPORARY DRAINAGE. UNLESS OTHERWISE NOTED PROPOSED DRAINAGE ITEMS ARE TO BE USED FOR TEMPORARY DRAINAGE. ADJUSTMENT TO INLETS OR MANHOLES FROM TEMPORARY ELEVATIONS TO FINAL ELEVATIONS WILL BE INCLUDED IN THE COST OF THE PROPOSED DRAINAGE STRUCTURES.

TRAFFIC CONTROL AND PROTECTION

TRAFFIC CONTROL AND PROTECTION SHALL BE PERFORMED IN ACCORDANCE WITH THE TRAFFIC CONTROL PLAN, SECTION 701 OF THE STANDARD SPECIFICATIONS AND THE SPECIAL PROVISIONS.

TWO-WAY TRAFFIC SHALL BE ACCOMMODATED AT ALL TIMES EXCEPT DURING ISOLATED FLAGGER CONTROLLED LANE CLOSURES.

EXISTING TRAFFIC CONTROL SIGNS AND DEVICES IN CONFLICT WITH STAGE 2 CONSTRUCTION ARE TO BE REMOVED BY THE CONTRACTOR AFTER THE PROPOSED TRAFFIC CONTROL AND PROTECTION REQUIREMENTS ARE MET OR AS AUTHORIZED BY THE ENGINEER. SIGNS OR DEVICES LEFT IN PLACE AT THIS TIME ARE TO BE PROTECTED FROM DAMAGE.

THE CONTRACTOR SHALL SCHEDULE OPERATIONS TO ENSURE THAT NO DROP-OFF OF >12", WITHIN 3' OF THE TRAVEL LANE, IS PRESENT FOR 48 HOURS OR MORE.

NO DROP-OFF GREATER THAN 24" WITHIN 12' OF THE TRAVEL LANE WILL BE ALLOWED UNLESS A FLAGGER CONTROLLED LANE CLOSURE IS PROVIDED. SEGMENTS WHERE THESE CONDITIONS OCCUR DURING NON-WORKING HOURS MUST BE PROTECTED WITH TEMPORARY CONCRETE BARRIER. UNLESS AUTHORIZED BY THE ENGINEER, THE CONTRACTOR WILL ONLY BE PAID FOR TEMPORARY CONCRETE BARRIER ALONG SEGMENTS SHOWN IN THE PLANS.

VERTICAL PANELS, TYPE II BARRICADES OR DRUMS WITH WARNING LIGHTS ARE REQUIRED TO DELINEATE THE WORK AREA. THE MAXIMUM SPACING SHALL BE 100 FEET ALONG THE TANGENTS, 50 FEET ALONG THE TAPERS AND 25 FEET ALONG RADII TO SIDE ROADS AND ENTRANCES.

THE FOLLOWING TRAFFIC CONTROL STANDARDS ARE THE MINIMUM REQUIREMENTS FOR TRAFFIC CONTROL AND PROTECTION DURING THIS STAGE: 701001, 701006, 701011, 701201, 701301, 701326, 701901 & 704001.

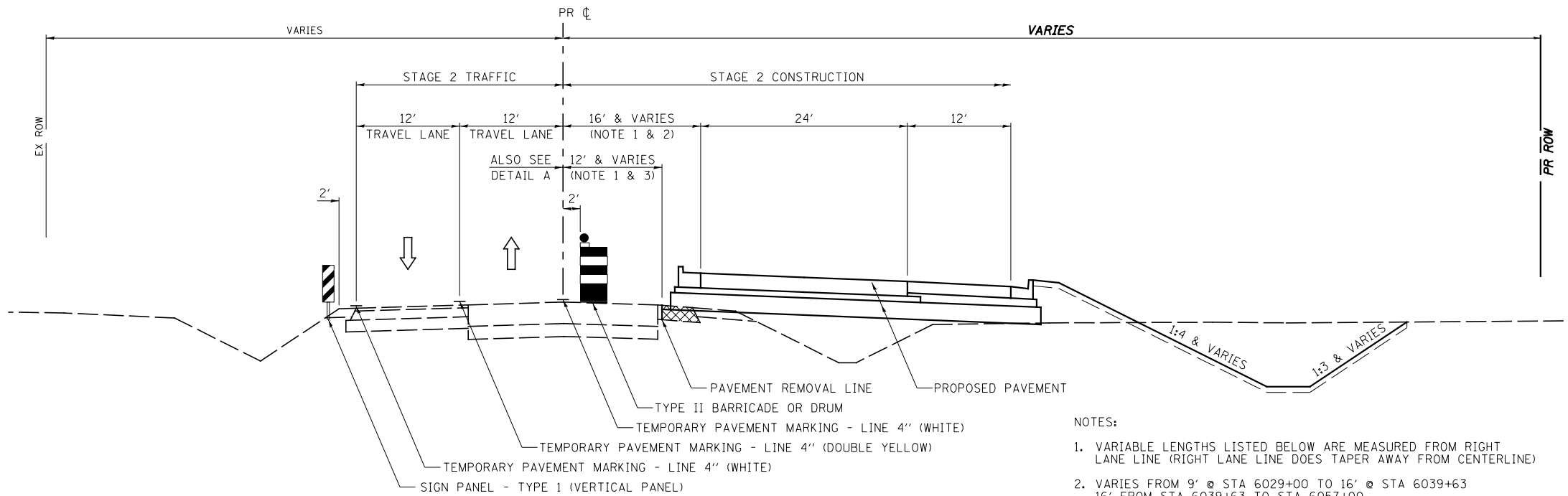

STAGE 2 TYPICAL SECTION
IL. RTE. 47

STA. 6029+00.00 TO STA. 6034+99.54
 STA. 6052+15.48 TO STA. 6056+11.57
 STA. 6067+50.45 TO STA. 6104+00.00

TEMPORARY PAVEMENT MARKING ON FINAL WEARING SURFACE SHALL BE PAVEMENT MARKING TAPE, TYPE IV

NOTES:

- VARIABLE LENGTHS LISTED BELOW ARE MEASURED FROM RIGHT LANE LINE (RIGHT LANE LINE DOES TAPER AWAY FROM CENTERLINE)
- VARIES FROM 9' @ STA 6029+00 TO 16' @ STA 6039+63
 16' FROM STA 6039+63 TO STA 6057+00
 VARIES FROM 16' @ STA 6057+00 TO 28' @ STA 6060+00
 28' FROM STA 6060+00 TO STA 6063+60
 VARIES FROM 28' @ STA 6063+60 TO 18.6' @ STA 6065+95
 18.6' FROM STA 6065+95 TO STA 6072+19
 VARIES FROM 18.6' @ STA 6072+19 TO 16' @ STA 6072+86
- 2.5' FROM STA 6029+00 TO STA 6030+19
 VARIES FROM 2.5' @ STA 6030+19 TO 5' @ STA 6030+79
 VARIES FROM 5' @ STA. 6030+79 TO 12' @ STA 6039+63
 12' FROM STA 6039+63 TO STA 6104+00
- 0' FROM STA 6029+00 TO STA 6030+19
 VARIES FROM 0' @ STA 6030+19 TO 2' @ STA 6030+79
 2' FROM STA 6030+79 TO STA 6039+85

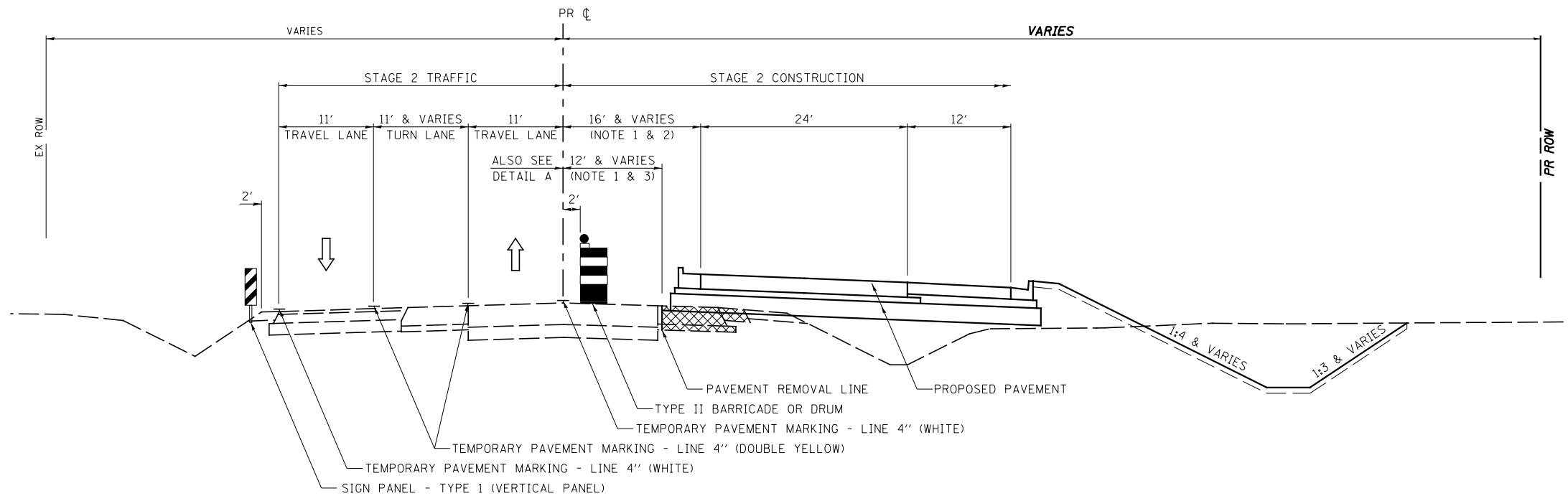

STAGE 2 TYPICAL SECTION
IL. RTE. 47

STA. 6034+99.54 TO STA. 6052+15.48
 STA. 6056+11.57 TO STA. 6067+50.45

FILE NAME =	USER NAME = bdecreane	DESIGNED - LDZ	REVISED -	STATE OF ILLINOIS DEPARTMENT OF TRANSPORTATION	IL. RTE. 47 STAGE 2 CONSTRUCTION NOTES & TYPICAL SECTIONS	F.A.P. RTE.	SECTION	COUNTY	TOTAL SHEETS	SHEET NO.
V:\3195\66883 (South Section)\CADD Sheets\0366883-sht-staging2typical-1.dgn	DRAWN - SRH/RMD	REVISIED -	326			(110)R, BR & BR-1	GRUNDY	644	151	
PLOT SCALE = 16.000' / in.	CHECKED - DJD	REVISIED -	CONTRACT NO. 66883							
PLOT DATE = 8/6/2013	DATE - 7/15/2013	REVISIED -	SCALE: N/A			SHEET NO. 1 OF 2 SHEETS	STA. N/A TO STA. N/A	ILLINOIS FED. AID PROJECT		