

MEDIAN CROSSOVER DETAIL

STA 6101+07 TO STA 6104+33

STAGE 3 CONSTRUCTION

CONSTRUCT PERMANENT SOUTHBOUND LANES, CULVERTS AND BRIDGE PORTIONS FROM STA 6029+00± TO STA 6277+00± AND CONNECTOR PAVEMENT FROM STA 6265+00± TO STA 6291+00±.

THE SEGMENT FROM STA 6040+00± TO STA 6050+00± SHALL BE CONSTRUCTED IN A MANNER TO ENSURE ACCESS TO THE SCHOOL IS OPEN AT ALL TIMES. THE CONTRACTOR SHALL SCHEDULE THE WORK OPERATIONS ALONG THIS SEGMENT IN A MANNER TO ENSURE TRAFFIC IS NOT EXPOSED TO AN EDGE OF PAVEMENT DROP-OFF DESCRIBED UNDER TRAFFIC CONTROL AND PROTECTION NOTES.

PROLOGIS PRKWAY. IS TO REMAIN OPEN AT ALL TIMES. THE CONTRACTOR SHALL SCHEDULE THE WORK OPERATIONS ALONG THIS SEGMENT IN A MANNER TO ENSURE TRAFFIC IS NOT EXPOSED TO AN EDGE OF PAVEMENT DROP-OFF DESCRIBED UNDER TRAFFIC CONTROL AND PROTECTION NOTES.

LOCAL ROAD CLOSURES INVOLVING:
NELSON RD.
AIRPORT RD.
MINOOKA RD. (WEST LEG)
SHERRILL RD. (WEST LEG)

SHALL BE SCHEDULED TO ENSURE CONSECUTIVE ROADS ARE NOT UNDER CLOSURE AT THIS TIME. EACH SIDE ROAD CLOSURE IS LIMITED TO 30 CALENDAR DAYS.

NELSON RD. IS TO BE CLOSED WHEN THE TRAFFIC IS SHIFTED TO STAGE 3 CONFIGURATION. THE RECONSTRUCTION OF NELSON RD. AND IL. RTE. 47 FROM STA 6098+00± TO STA 6099+00± SHALL BE COMPLETED WITHIN 30 CALENDAR DAYS.

INSTALL TEMPORARY LIGHTING NORTH OF SHERRILL ROAD.

AIRPORT RD. IS TO BE CONSTRUCTED IN TWO SUB-STAGES IN ORDER TO MAINTAIN ACCESS TO CHURCH AT CORNER OF AIRPORT RD. AND IL. RTE. 47. STAGE 3A RANGES FROM STA 300+00 TO STA 307+75 AND STAGE 3B RANGES FROM STA 307+75 TO STA 310+00±.

CONSTRUCTION OF THE MEDIAN CURB IS TO BE GAPPED FOR ACCESS AT:
STA 6034+00 TO STA 6034+50 STA 6112+75 TO STA 6113+25
STA 6040+25 TO STA 6040+75 STA 6114+50 TO STA 6115+00
STA 6058+00 TO STA 6060+04 STA 6138+25 TO STA 6138+75
STA 6072+50 TO STA 6073+00 STA 6171+25 TO STA 6171+75
STA 6086+25 TO STA 6086+75 STA 6173+75 TO STA 6174+25
STA 6088+00 TO STA 6088+50 STA 6178+50 TO STA 6179+00
STA 6110+75 TO STA 6111+25 STA 6183+75 TO STA 6184+25

POST STAGE 3, WHEN TRAFFIC IS IN STAGE 4 CONFIGURATION, MEDIAN GAPS FROM THE BEGINNING OF THE PROJECT TO NELSON RD. ARE TO BE COMPLETED.

POST STAGE 4, WHEN TRAFFIC IS IN FINAL CONFIGURATION, ALL REMAINING MEDIAN GAPS ARE TO BE COMPLETED.

THE CONTRACTOR IS REQUIRED TO PROVIDE AND MAINTAIN TEMPORARY DRAINAGE. UNLESS OTHERWISE NOTED PROPOSED DRAINAGE ITEMS ARE TO BE USED FOR TEMPORARY DRAINAGE. ADJUSTMENT TO INLETS OR MANHOLES FROM TEMPORARY ELEVATIONS TO FINAL ELEVATIONS WILL BE INCLUDED IN THE COST OF THE PROPOSED DRAINAGE STRUCTURES.

STAGE 3 TYPICAL SECTION

IL. RTE. 47

STA 6029+00 TO STA 6038+47
STA 6052+19 TO STA 6054+01
STA 6066+24 TO STA 6111+00

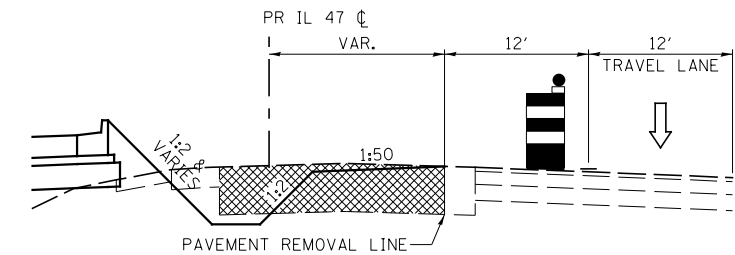

DETAIL A

STA 6099+65 TO STA 6101+07
STA 6104+33 TO STA 6111+00

TEMPORARY PAVEMENT MARKING ON FINAL WEARING SURFACE SHALL BE PAVEMENT MARKING TAPE, TYPE IV

TRAFFIC CONTROL AND PROTECTION

TRAFFIC CONTROL AND PROTECTION SHALL BE PERFORMED IN ACCORDANCE WITH THE TRAFFIC CONTROL PLAN, SECTION 701 OF THE STANDARD SPECIFICATIONS AND THE SPECIAL PROVISIONS.

TWO-WAY TRAFFIC SHALL BE ACCOMMODATED AT ALL TIMES EXCEPT DURING ISOLATED FLAGGER CONTROLLED LANE CLOSURES.

EXISTING TRAFFIC CONTROL SIGNS AND DEVICES IN CONFLICT WITH STAGE 3 CONSTRUCTION ARE TO BE REMOVED BY THE CONTRACTOR AFTER THE PROPOSED TRAFFIC CONTROL AND PROTECTION REQUIREMENTS ARE MET OR AS AUTHORIZED BY THE ENGINEER. SIGNS OR DEVICES LEFT IN PLACE AT THIS TIME ARE TO BE PROTECTED FROM DAMAGE.

NO DROP-OFF GREATER THAN 18" WITHIN 3' OF THE TRAVEL LANE OR GREATER THAN 24" WITHIN 12' OF THE TRAVEL LANE WILL BE ALLOWED UNLESS A FLAGGER CONTROLLED LANE CLOSURE IS PROVIDED. SEGMENTS WHERE THESE CONDITIONS OCCUR DURING NON-WORKING HOURS MUST BE PROTECTED WITH TEMPORARY CONCRETE BARRIER, UNLESS AUTHORIZED BY THE ENGINEER, CONTRACTOR WILL ONLY BE PAID FOR TEMPORARY CONCRETE BARRIER ALONG SEGMENTS SHOWN IN THE PLANS.

VERTICAL PANELS, TYPE II BARRICADES OR DRUMS WITH WARNING LIGHTS ARE REQUIRED TO DELINEATE THE WORK AREA. THE MAXIMUM SPACING SHALL BE 100 FEET ALONG THE TANGENTS, 50 FEET ALONG THE TAPERS AND 25 FEET ALONG RADII TO SIDE ROADS AND ENTRANCES.

THE FOLLOWING TRAFFIC CONTROL STANDARDS ARE THE MINIMUM REQUIREMENTS FOR TRAFFIC CONTROL AND PROTECTION DURING THIS STAGE: 701001, 701006, 701011, 701201, 701301, 701326, 701901 & 704001.

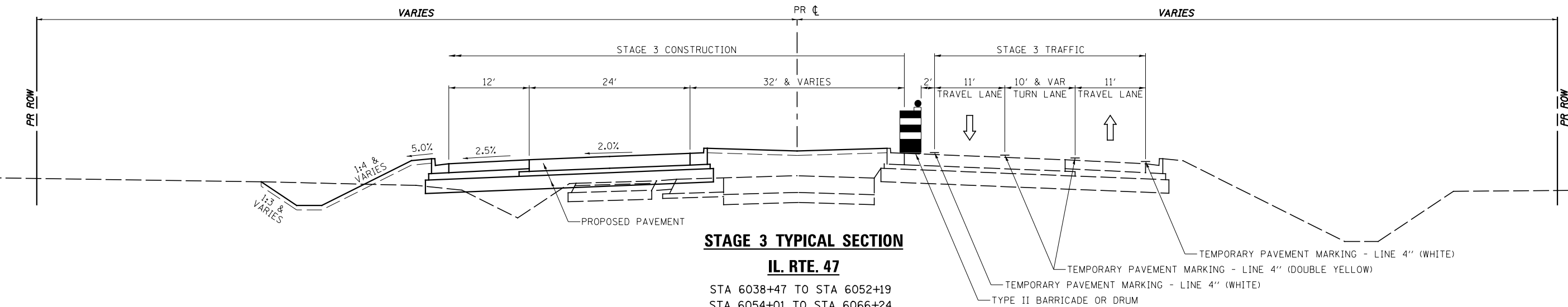

STAGE 3 TYPICAL SECTION

IL. RTE. 47

STA 6038+47 TO STA 6052+19
STA 6054+01 TO STA 6066+24

FILE NAME = V:\3195\66883 (South Section)\CADD Sheets\0366883-sht-staging3typical-1.dgn	USER NAME = bdecreane	DESIGNED - LDZ	REVISED -	<p align="center">STATE OF ILLINOIS DEPARTMENT OF TRANSPORTATION</p> <p align="center">IL. RTE. 47 & PROLOGIS PRKWAY. STAGE 3 CONSTRUCTION NOTES & TYPICAL SECTIONS</p> <p>SCALE: N/A SHEET NO. 1 OF 3 SHEETS STA. N/A TO STA. N/A</p>	F.A.P. RTE. 326	SECTION (110)R, BR & BR-1	COUNTY GRUNDY	TOTAL SHEETS 644	SHEET NO. 158
PLOT SCALE = 16.000' / 1"	CHECKED - DJD	REVISIED -	REVISIED -		CONTRACT NO. 66883				
PLOT DATE = 8/6/2013	DATE - 7/15/2013	REVISIED -	REVISIED -		ILLINOIS FED. AID PROJECT				