

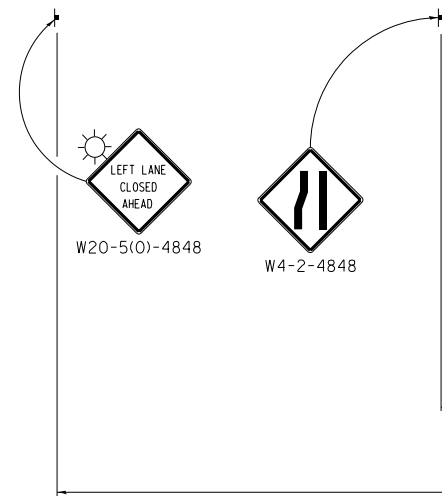

**LEGEND**

- DIRECTION INDICATOR BARRICADE WITH STEADY BURN MONDIRECTIONAL LIGHT
- TYPE II BARRICADE, DRUM OR VERTICAL BARRICADE WITH STEADY BURN BI-DIRECTIONAL LIGHT
- TYPE III BARRICADE WITH FLASHING LIGHT (2-EA.)
- DOUBLE VERTICAL PANEL
- WORK AREA
- ARROW BOARD
- CONSTRUCTION SIGN
- DIRECTION OF TRAFFIC
- TEMPORARY CONCRETE BARRIER
- IMPACT ATTENUATOR (TEMPORARY)
- FLASHING MONO-DIRECTIONAL LIGHT

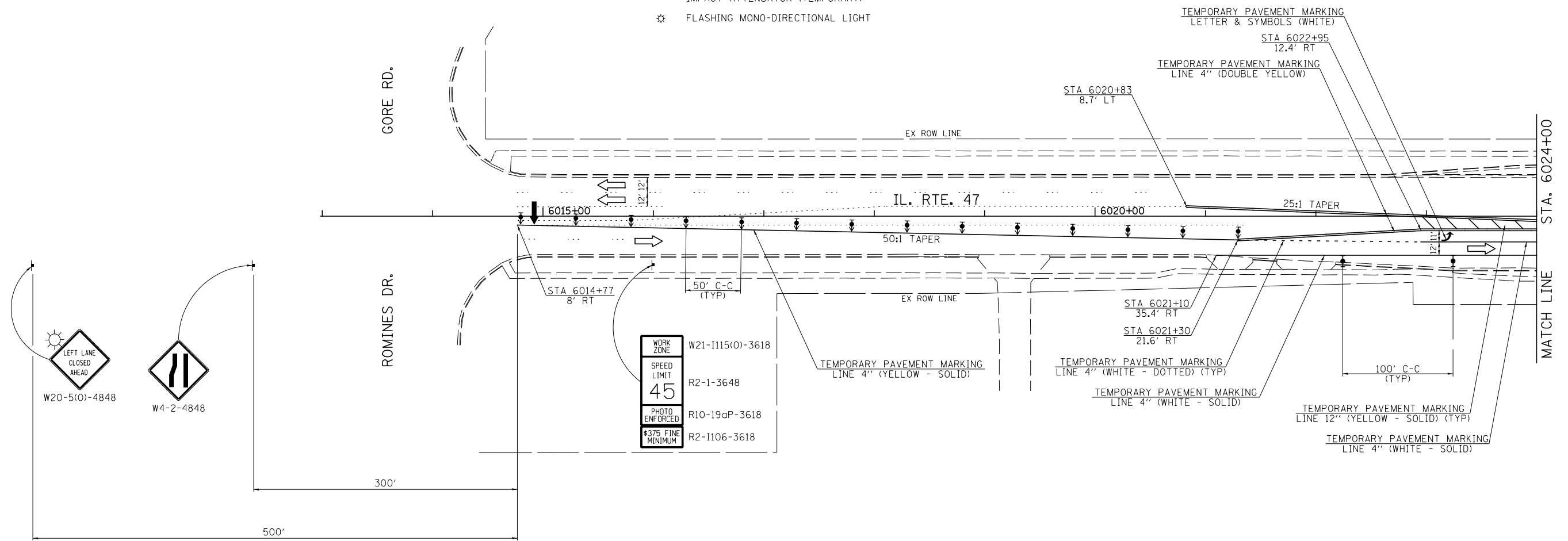

WORK ZONE	W21-I115(0)-3618
SPEED LIMIT	R2-1-3648
45	
PHOTO ENFORCED	R10-19aP-3618
\$375 FINE MINIMUM	R2-I106-3618

FILE NAME =	USER NAME = bdecreene	DESIGNED - LDZ	REVISED -
V:\3195\66883 (South Section)\CADD Sheets\366883-sht-staging3-0.dgn		DRAWN - SRH/RMD	REVISED -
	PLOT SCALE = 100.0000' / in.	CHECKED - DJD	REVISED -
SHT_DOUBLE PLAN	PLOT DATE = 8/6/2013	DATE - 7/15/2013	REVISED -

**STATE OF ILLINOIS  
DEPARTMENT OF TRANSPORTATION**

**IL. RTE. 47 STAGE 3 CONSTRUCTION & TRAFFIC CONTROL**

SCALE: 1"=50'      SHEET 1 OF 10 SHEETS      STA. 6013+00 TO STA. 6024+00

F.A.P. RTE.	SECTION	COUNTY	TOTAL SHEETS	SHEET NO.
326	(110)R, BR & BR-1	GRUNDY	644	162
CONTRACT NO. 66883				
ILLINOIS FED. AID PROJECT				