

DATE	
BY	
PLAN	SURVEYED
	PLOTTED
	NOTE BOOK
	NO.

DATE	
BY	
PROFILE	SURVEYED
	PLOTTED
	GRADES CHECKED
	STRUCTURE NOTATIONS CHECKED
	NO.

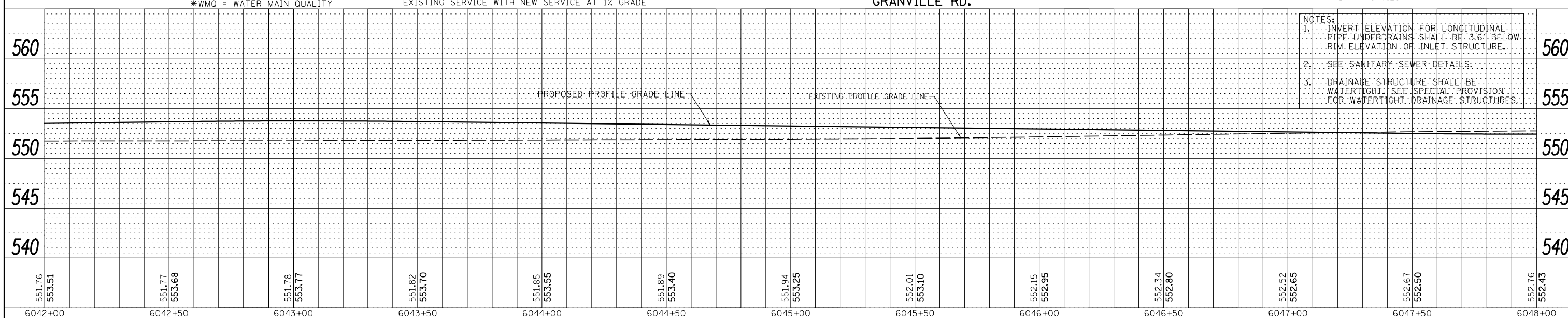
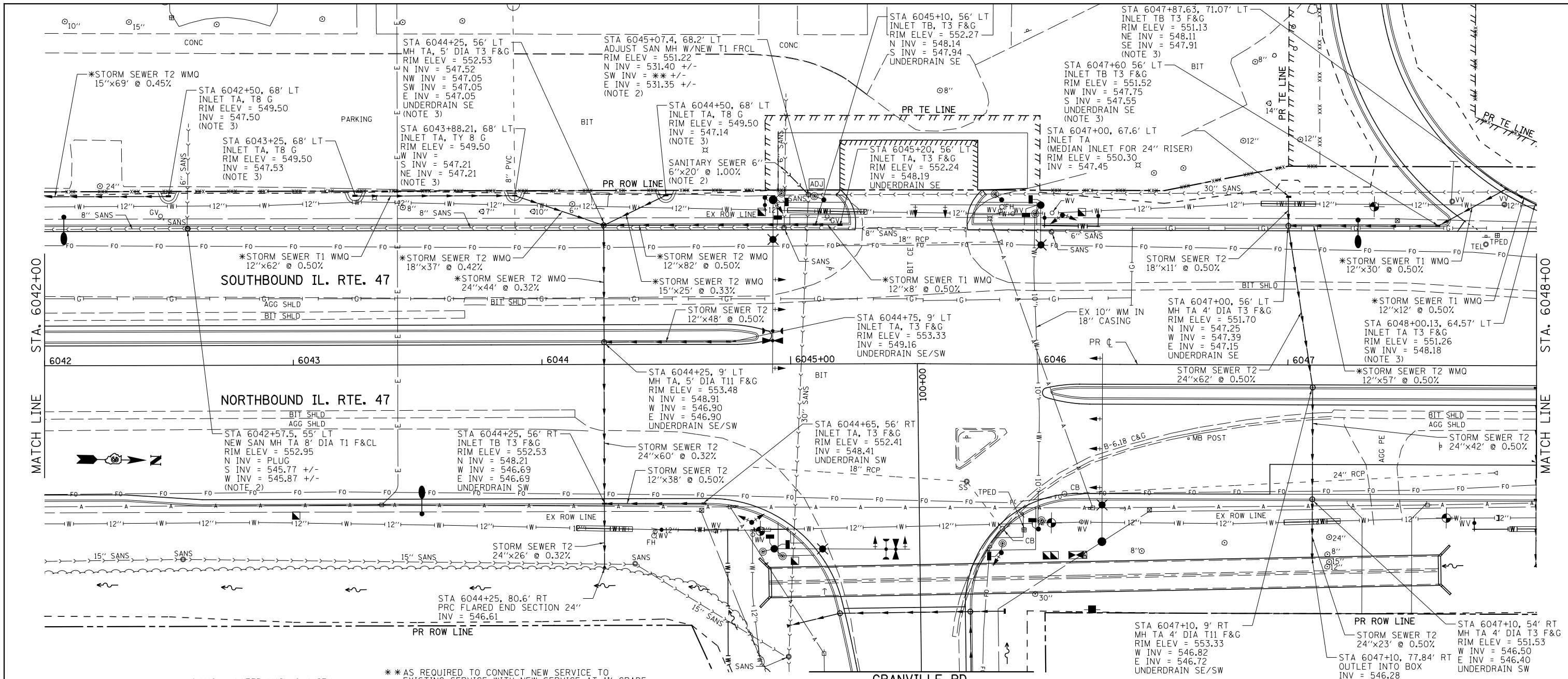

- NOTES:
1. INVERT ELEVATION FOR LONGITUDINAL PIPE UNDERDRAINS SHALL BE 3.6' BELOW RIM ELEVATION OF INLET STRUCTURE.
 2. SEE SANITARY SEWER DETAILS.
 3. DRAINAGE STRUCTURE SHALL BE WATERTIGHT; SEE SPECIAL PROVISION FOR WATERTIGHT DRAINAGE STRUCTURES.

551.76	553.51	551.77	553.68	551.78	553.77	551.82	553.70	551.85	553.55	551.89	553.40	551.94	553.25	552.01	553.10	552.15	552.95	552.34	552.80	552.52	552.65	552.67	552.50	552.76	552.43	
6042+00	6042+50	6043+00	6043+50	6044+00	6044+50	6045+00	6045+50	6046+00	6046+50	6047+00	6047+50	6048+00														

FILE NAME = V:\3195\66883 (South Section)\CADD Sheets\3366883-sh-t-drain-4.dgn
 SHT_PLNPRF

USER NAME = bdecreane
 DESIGNED - LRS
 DRAWN - SRH/RMD
 CHECKED - DJD
 DATE - 7/15/2013

REVISED -
 REVISED -
 REVISED -
 REVISED -

**STATE OF ILLINOIS
 DEPARTMENT OF TRANSPORTATION**

**IL. RTE. 47
 STORM SEWER AND UTILITIES PLAN & PROFILE**
 SCALE: H=20 V=5 SHEET 4 OF 35 SHEETS STA. 6042+00 TO STA. 6048+00

F.A.P. RTE. SECTION COUNTY TOTAL SHEETS SHEET NO.
 326 (110)R, BR & BR-1 GRUNDY 644 202
 CONTRACT NO. 66883
 ILLINOIS FED. AID PROJECT