

DATE	
BY	
PLAN	SURVEYED
	NOTED
	CHECKED
	ALIGNED
	DESIGNED
	FILE NAME

DATE	
BY	
PROFILE	SURVEYED
	NOTED
	CHECKED
	GRADES
	STRUCTURE
	NOTATIONS
	CHP/D

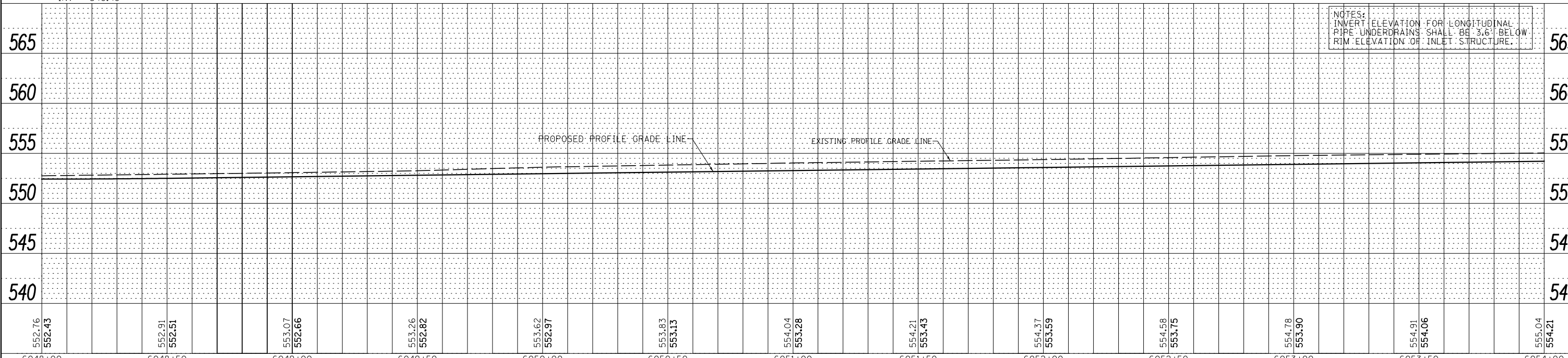
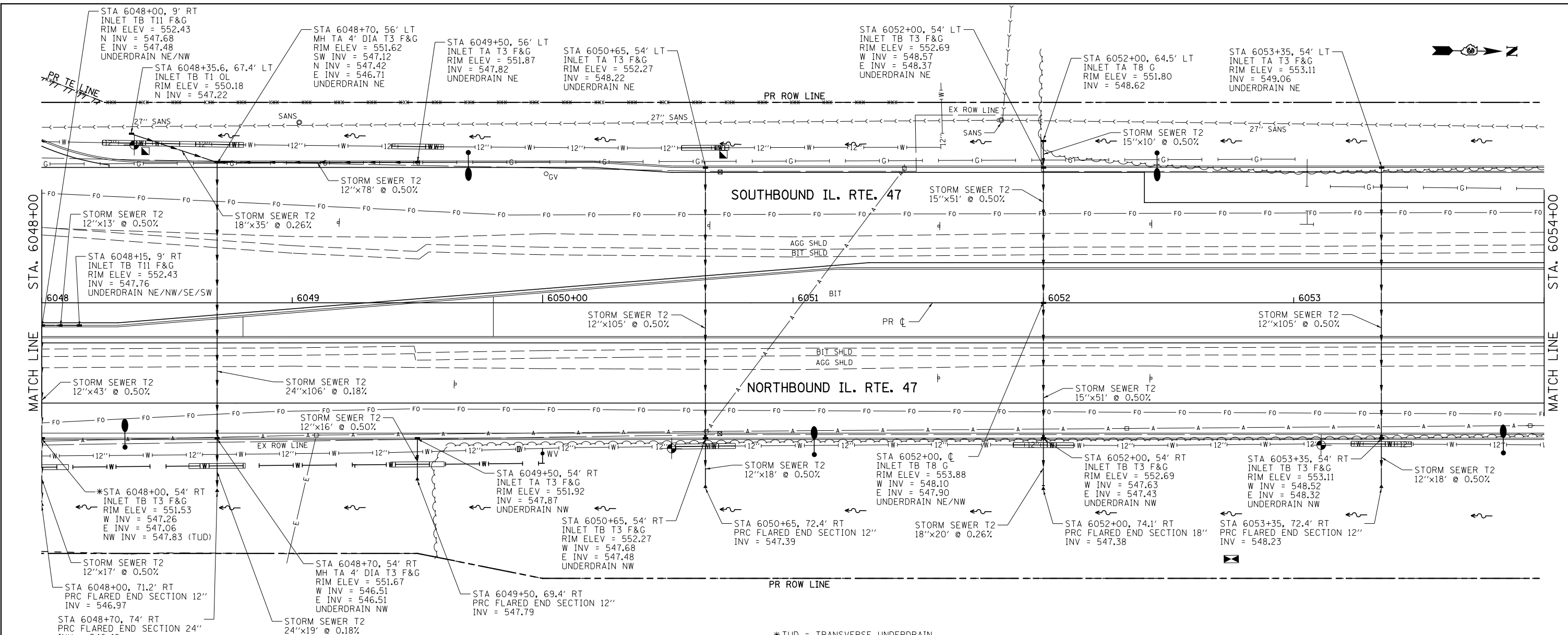

NOTES:  
 INVERT ELEVATION FOR LONGITUDINAL  
 PIPE UNDERDRAINS SHALL BE 3.6' BELOW  
 RIM ELEVATION OF INLET STRUCTURE.

552.76	552.43	552.91	552.51	553.07	552.66	553.26	552.82	553.62	552.97	553.83	553.13	554.04	553.28	554.21	553.43	554.37	553.59	554.58	553.75	554.78	553.90	554.91	554.06	555.04	554.21	
6048+00	6048+50	6049+00	6049+50	6050+00	6050+50	6051+00	6051+50	6052+00	6052+50	6053+00	6053+50	6054+00														

FILE NAME =	USER NAME = bdecreane	DESIGNED - LRS	REVISED -
V:\3195\66883 (South Section)\CADD Sheets\0366883-shd-drain-5.dgn		DRAWN - SRH/RMD	REVISED -
SHT_PLNPROF		CHECKED - DJD	REVISED -
		DATE - 7/15/2013	REVISED -

**STATE OF ILLINOIS**  
**DEPARTMENT OF TRANSPORTATION**

**IL. RTE. 47**  
**STORM SEWER AND UTILITIES PLAN & PROFILE**

F.A.P. RTE.	SECTION	COUNTY	TOTAL SHEETS	SHEET NO.
326	(110)R, BR & BR-1	GRUNDY	644	203

SCALE: H=20 V=5 SHEET 5 OF 35 SHEETS STA. 6048+00 TO STA. 6054+00 CONTRACT NO. 66883 ILLINOIS FED. AID PROJECT