

Benchmark: Tag bolt on FH located in front of Grundy County Farm Bureau, Elev. 551.80

Existing Structure: None. Traffic to be detoured during construction.

INDEX OF SHEETS

1. General Plan & Elevation
2. Culvert Details
3. Soil Borings

DESIGN SPECIFICATIONS
2012 AASHTO LRFD Bridge Design Specifications, 6th Edition

LOADING HL-93
Allow 50#/sq. ft. for future wearing surface.

DESIGN STRESSES

FIELD UNITS

$f'_c = 3,500$ psi
 $f_y = 60,000$ psi (Reinforcement)

PRECAST UNITS

$f'_c = 5,000$ psi
 $f_y = 60,000$ psi (Reinforcement)
 $f_y = 65,000$ psi (Welded Wire Fabric)

GENERAL NOTES

Layout of the slope protection system may be varied to suit ground conditions in the field as directed by the Engineer. The last section of precast culvert on each end shall have reinforcing bars extending from the precast culvert to be incorporated into the cast-in-place end sections as shown on sheet 2. Precast concrete box culverts shall conform to the design requirements of ASTM C1577. See Box Culvert Backfilling Detail within roadway detail sheets for limits of Granular Culvert Backfill.

STATION 6040+40.23
BUILT BY
STATE OF ILLINOIS
F.A.P. RTE. 326
SEC. (110)R, BR & BR-1
LOADING HL-93
STRUCTURE NO. 032-2543

NAME PLATE
See Std. 515001

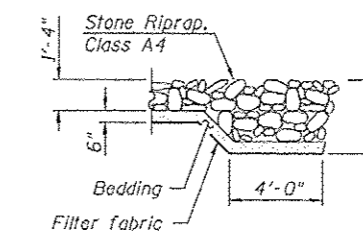

SECTION A-A

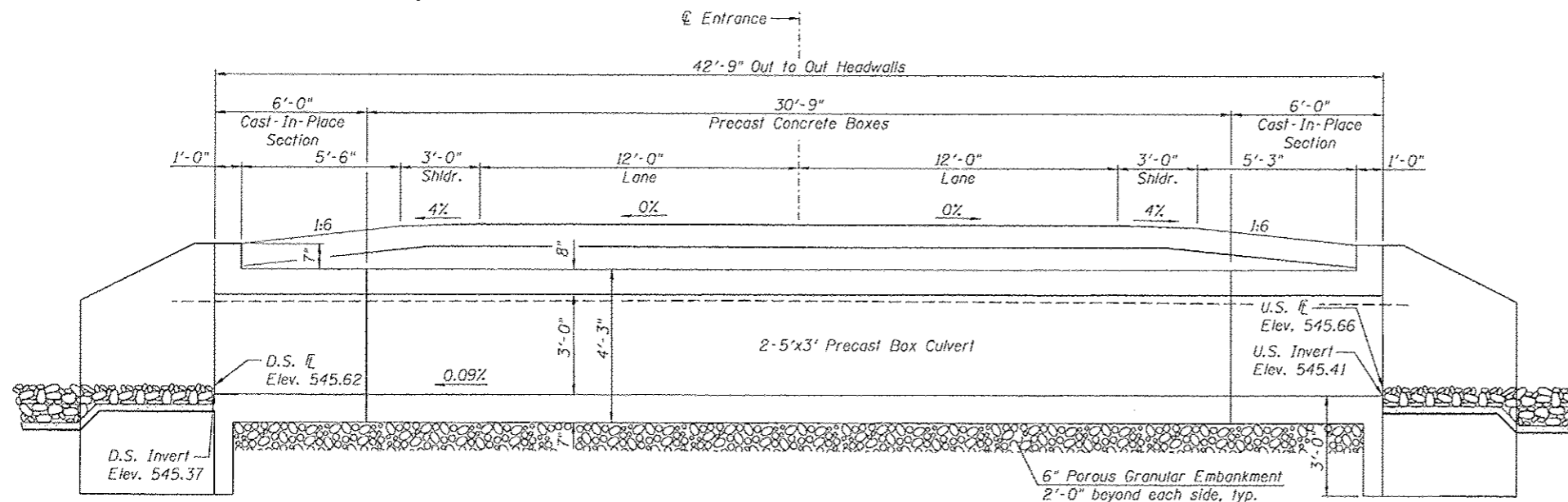

LONGITUDINAL SECTION

(Dimension's at Rt L's to Entrance, unless noted otherwise)
(Looking West)

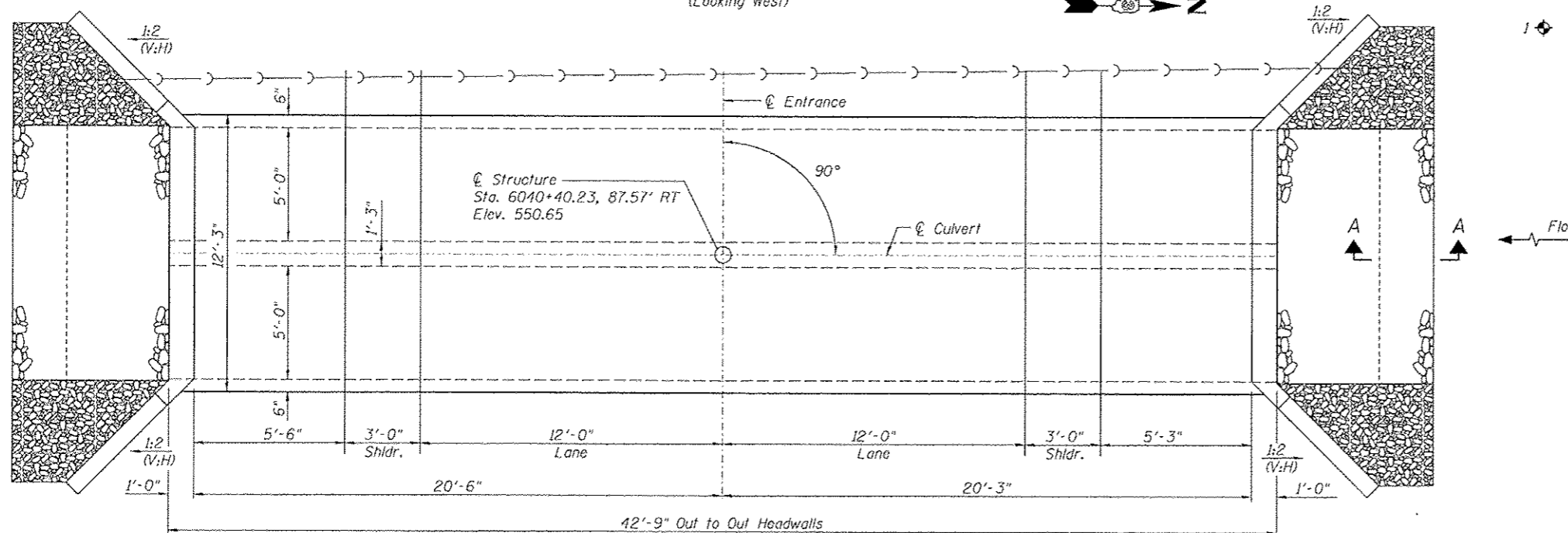

PLAN

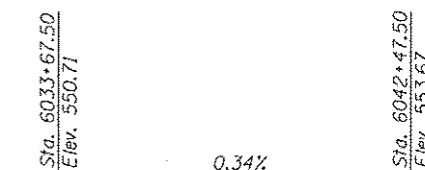

PROFILE GRADE

(Along IL. Rte. 47 P.G.)

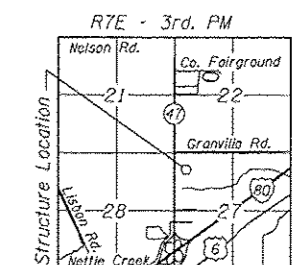

LOCATION SKETCH

TOTAL BILL OF MATERIAL

ITEM	UNIT	TOTAL
Porous Granular Embankment	Cu. Yd.	12.9
Stone Riprap, Class A4	Sq. Yd.	31
Filter Fabric	Sq. Yd.	31
Reinforcement Bars	Pound	2480
Name Plates	Each	1
Concrete Box Culverts	Cu. Yd.	14.2
Precast Concrete Box Culverts 5'x3'	Foot	61.5

DESIGN SCOUR ELEVATION TABLE

Design Scour Elevation (ft.)	U.S. Invert	D.S. Invert
	542.41	542.37



Vincent P. Tabor 7/15/2013
Date

Vincent P. Tabor
Licensed Structural Engineer
State of Illinois No. 081-007047
Expires 11/30/2014

GENERAL PLAN & ELEVATION

ENTRANCE OVER DRAINAGE DITCH

F.A.P. RTE. 326-SEC (110)R,
BR & BR-1

GRUNDY COUNTY

STATION 6040+40.23

STRUCTURE NO. 032-2543

REVISED -	USER NAME -	DESIGNED - PSS	LIN ENGINEERING LTD. Consulting Engineers Springfield, Illinois	STATE OF ILLINOIS DEPARTMENT OF TRANSPORTATION	GENERAL PLAN & ELEVATION STRUCTURE NO. 032-2543	F.A.P. RTE. 326	SECTION (110)R, BR & BR-1	COUNTY GRUNDY	TOTAL SHEETS 644	SHEET NO. 312		
REVISED -	FILE NAME -	CHECKED - VPT				SHEET NO. 1 OF 3 SHEETS		CONTRACT NO. 66883		ILLINOIS FED. AID PROJECT		
REVISED -	PLOT SCALE -	DRAWN - AJF										
REVISED -	PLOT DATE -	CHECKED - VPT										