

F.A.I. RTE.	SECTION	COUNTY	TOTAL SHEETS	SHEET NO.
55	(53-5B-1)I-3	LIVINGSTON	15	1
		ILLINOIS	CONTRACT NO. 66D16	

STATE OF ILLINOIS
DEPARTMENT OF TRANSPORTATION
DIVISION OF HIGHWAYS

PROPOSED
HIGHWAY PLANS

F.A.I. ROUTE 55 (I-55)

SECTION (53-5B-1)I-3
BRIDGE REPAIR
STRUCTURE NO. 053-0129 (NB)
OVER THE VERMILION RIVER
WEST OF PONTIAC
LIVINGSTON COUNTY

C-93-001-14

INDEX OF SHEETS

1. COVER SHEET
2. GENERAL NOTES
3. SUMMARY OF QUANTITIES
4. TYPICAL SECTIONS
5. TRAFFIC CONTROL AND PROTECTION, STANDARD 701400 (SPECIAL)
6. TRAFFIC CONTROL AND PROTECTION, STANDARD 701402 (SPECIAL)
7. TYPICAL PAVEMENT MARKINGS
8. SITE CLEAN UP FOR STRUCTURE NO. 053-0129 (NB)
- 9 - 15. STRUCTURE PLANS FOR STRUCTURE NO. 053-0129 (NB)

STANDARDS

- 000001-06 STANDARD SYMBOLS, ABBREVIATIONS AND PATTERNS
- 001001-02 AREAS OF REINFORCEMENT BARS
- 001006 DECIMAL OF AN INCH AND OF A FOOT
- 701101-03 OFF-ROAD OPERATIONS MULTILANE, 15' (4.5 m) TO 24" (600 mm) FROM PAVEMENT EDGE
- 701106-02 OFF-ROAD OPERATIONS, MULTILANE, MORE THAN 15' (4.5 m) AWAY
- 701901-03 TRAFFIC CONTROL DEVICES
- 704001-07 TEMPORARY CONCRETE BARRIER
- 701400-06
- 701402-09

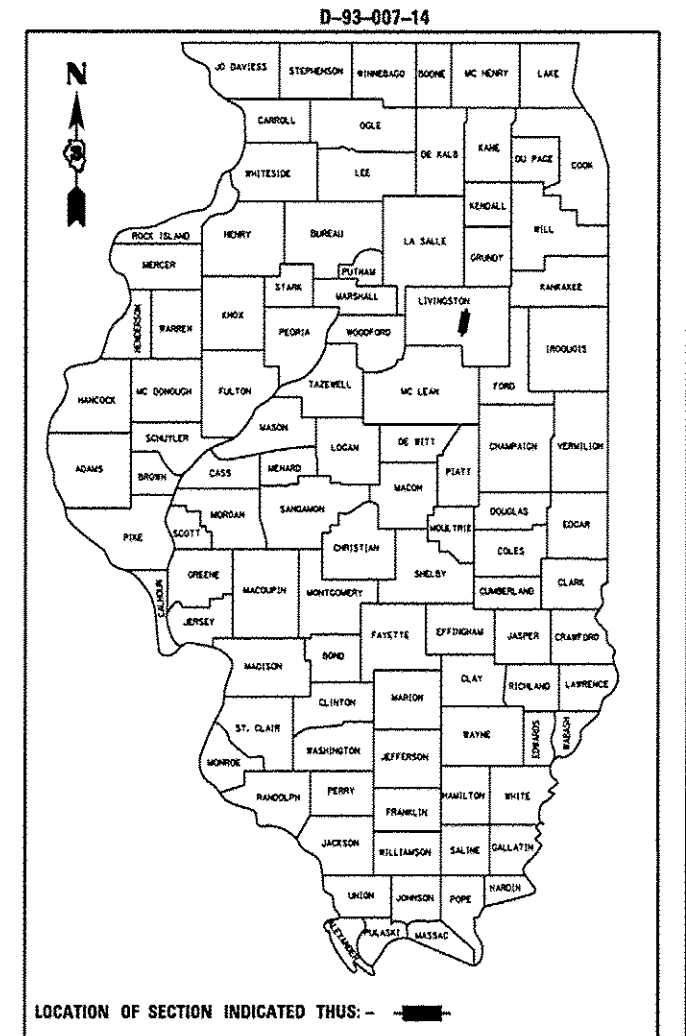

RURAL

INTERSTATE	
FAI 55 (I-55)	
2011	
ADT	18700
P.V.	71.79%
S.U.	4.41%
M.U.	23.80%

STATE OF ILLINOIS
DEPARTMENT OF TRANSPORTATION
DIVISION OF HIGHWAYS

SUBMITTED Sept. 3rd 2013
Paul A. [Signature]
DEPUTY DIRECTOR OF HIGHWAYS, REGION ENGINEER

October 4 2013
John D. Baranzelli, P.E.
ENGINEER OF DESIGN AND ENVIRONMENT

October 4 2013
Onor Osman, P.E.
DIRECTOR OF HIGHWAYS, CHIEF ENGINEER

PRINTED BY THE AUTHORITY
OF THE STATE OF ILLINOIS

PROJECT LOCATION
STRUCTURE NO. 053-0129 (NB)
STA. 188 + 20.13

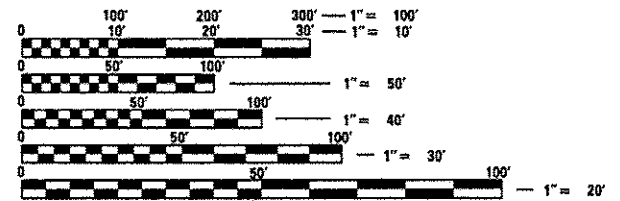

FULL SIZE PLANS HAVE BEEN PREPARED USING STANDARD ENGINEERING SCALES. REDUCED SIZED PLANS WILL NOT CONFORM TO STANDARD SCALES. IN MAKING MEASUREMENTS ON REDUCED PLANS, THE ABOVE SCALES MAY BE USED.

J.U.L.I.E.
JOINT UTILITY LOCATION INFORMATION FOR EXCAVATION
1-800-892-0123
OR 811

PROJECT ENGINEER: JOE KANNEL
UNIT CHIEFS: RON WOODSHANK
TOWNSHIP: PONTIAC

CONTRACT NO. 66D16

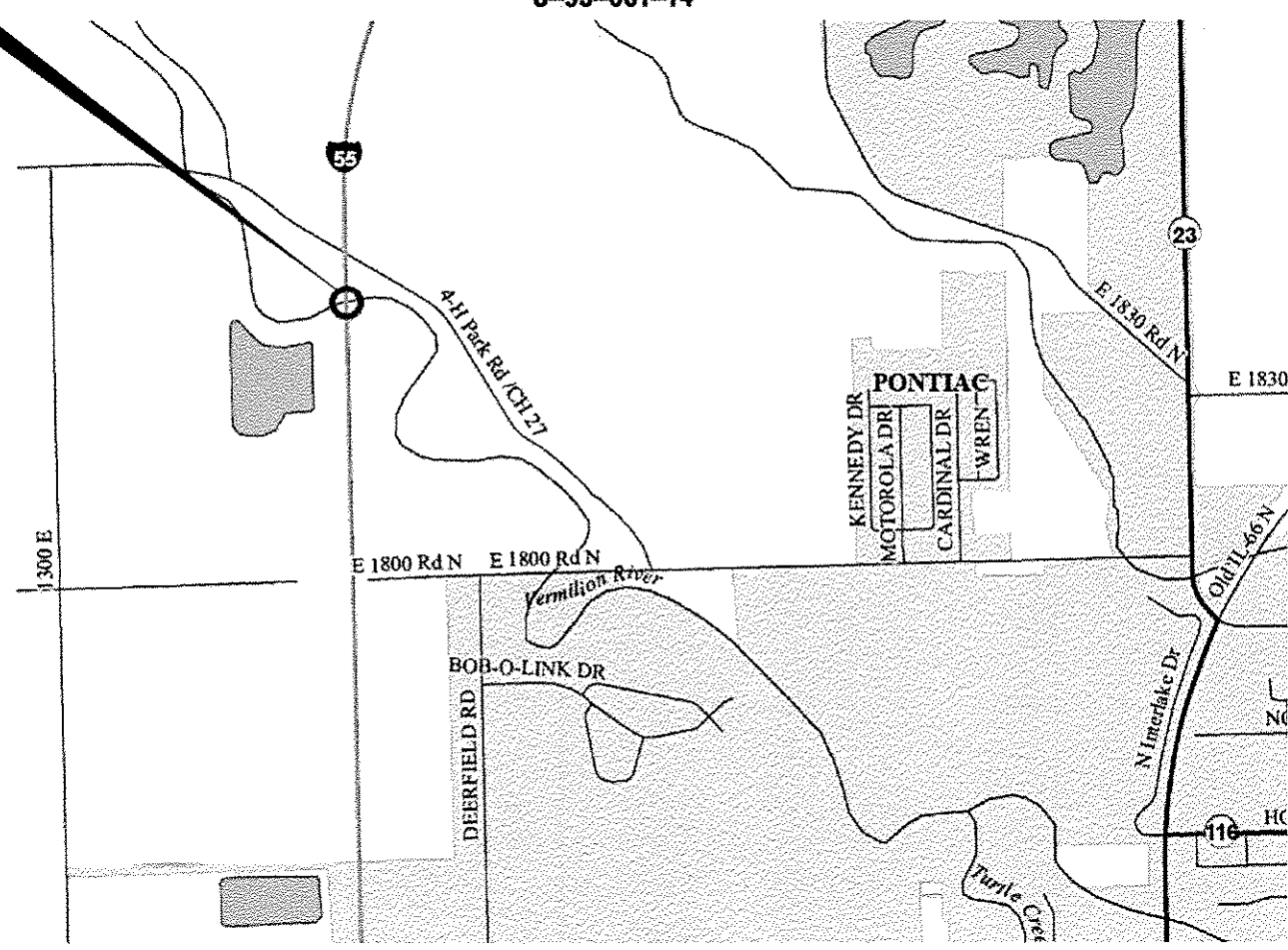

LOCATION MAP
NOT TO SCALE
POINT LOCATION