





LEGEND

-  HMA SURFACE REMOVAL BUTT JOINT
-  PAVEMENT REMOVAL
-  HMA SURFACE REMOVAL, 3/4"
-  APPROACH SLAB REMOVAL
-  TREE REMOVAL

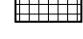

NOTES

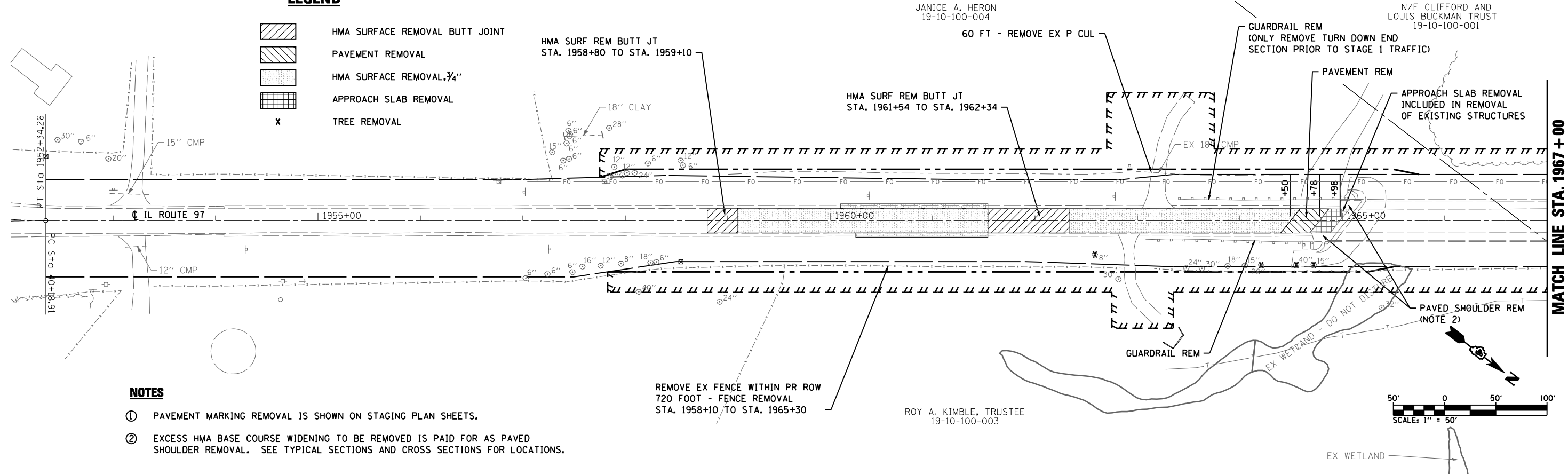
- ① PAVEMENT MARKING REMOVAL IS SHOWN ON STAGING PLAN SHEETS.
- ② EXCESS HMA BASE COURSE WIDENING TO BE REMOVED IS PAID FOR AS PAVED SHOULDER REMOVAL. SEE TYPICAL SECTIONS AND CROSS SECTIONS FOR LOCATIONS.

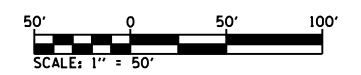
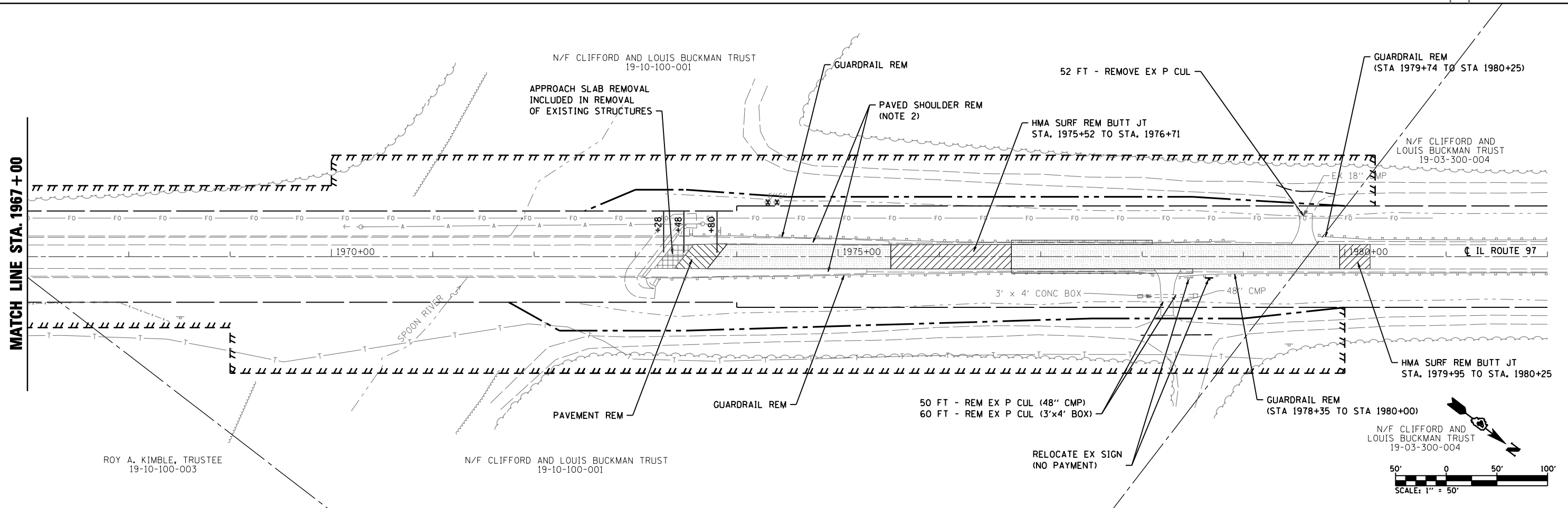
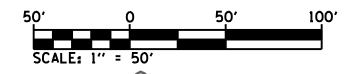

FILE NAME = D468759.sht-removal.dgn	USER NAME = default PLOT TIME = 8:52:34 AM PLOT SCALE = 100.0000' / IN. PLOT DATE = 8/9/2013	DESIGNED - RGV DRAWN - RGV CHECKED - BPS DATE -	REVISED - REVISED - REVISED - REVISED -	STATE OF ILLINOIS DEPARTMENT OF TRANSPORTATION	REMOVAL PLAN SHEET SCALE: 1"=50' SHEET 1 OF 1 SHEETS STA. 1953+00 TO STA. 1982+00	F.A.P. RTE. 626 SECTION (44-B-1) BR COUNTY KNOX TOTAL SHEETS 122 SHEET NO. 29 CONTRACT NO. 68759 ILLINOIS FED. AID PROJECT
--	---	--	--	---	---	--