

STAGES IA & IIA FAI-74 WESTBOUND

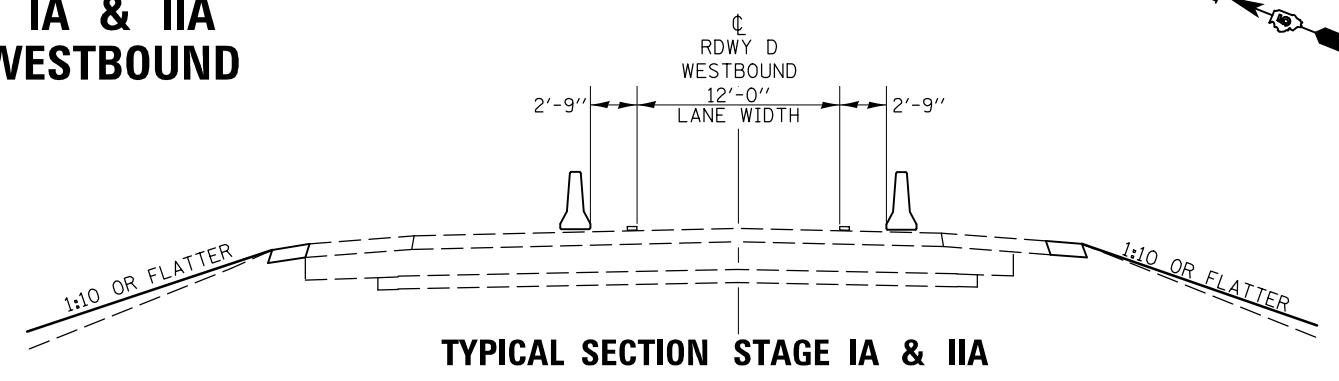

TYPICAL SECTION STAGE IA & IIA

SEE STANDARD 701411
FOR FURTHER DETAILS

SEE TRAFFIC CONTROL FOR RAMP
CLOSURE DETAILS

SEE STANDARDS 701402 AND
701400 FOR FURTHER DETAILS

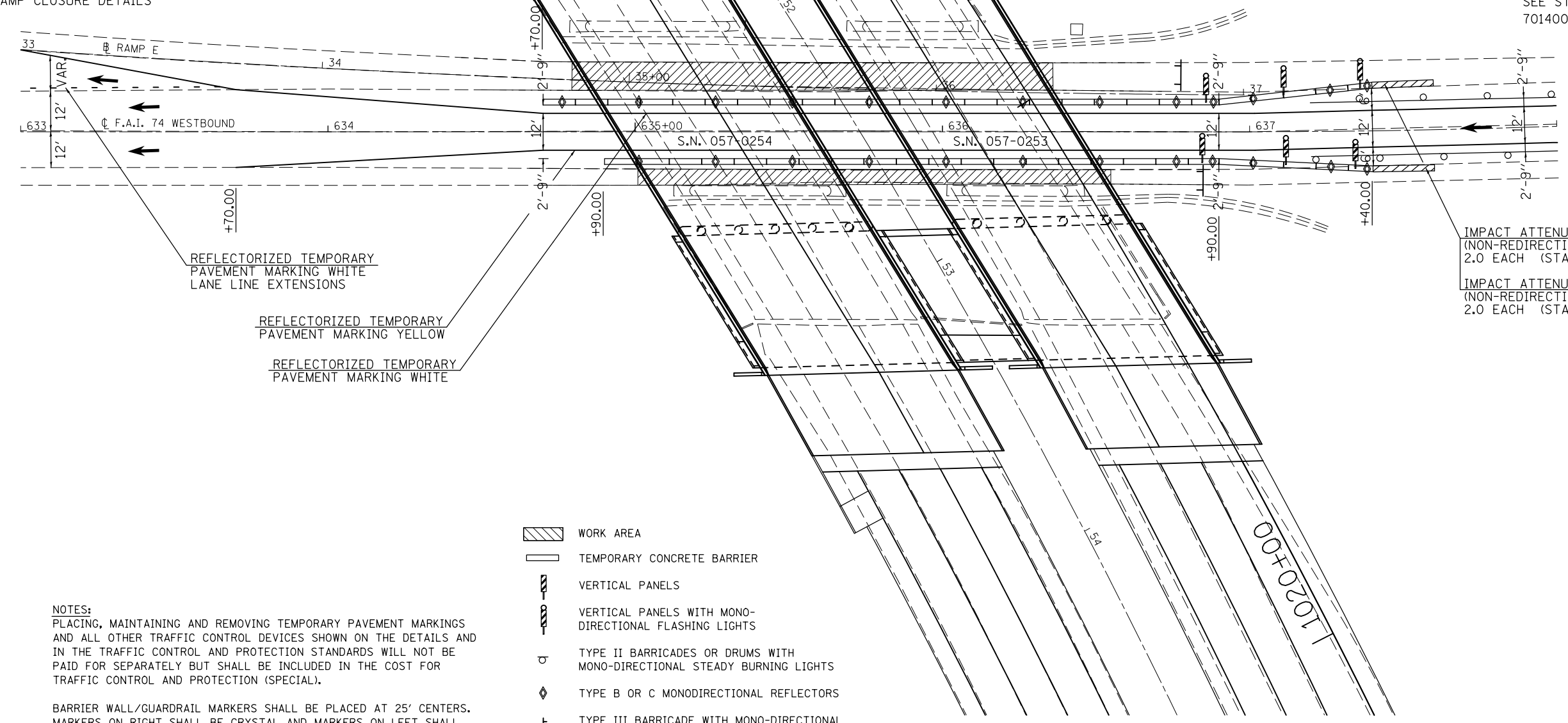

REFLECTORIZED TEMPORARY
PAVEMENT MARKING WHITE
LANE LINE EXTENSIONS

REFLECTORIZED TEMPORARY
PAVEMENT MARKING YELLOW

REFLECTORIZED TEMPORARY
PAVEMENT MARKING WHITE

IMPACT ATTENUATORS, TEMPORARY
(NON-REDIRECTIVE), TEST LEVEL 3
2.0 EACH (STAGE IA)

IMPACT ATTENUATORS, TEMPORARY
(NON-REDIRECTIVE), TEST LEVEL 3
2.0 EACH (STAGE IIA)

PLAN SHEET LOCATION

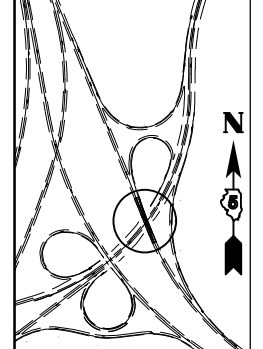

NOTES:
PLACING, MAINTAINING AND REMOVING TEMPORARY PAVEMENT MARKINGS
AND ALL OTHER TRAFFIC CONTROL DEVICES SHOWN ON THE DETAILS AND
IN THE TRAFFIC CONTROL AND PROTECTION STANDARDS WILL NOT BE
PAID FOR SEPARATELY BUT SHALL BE INCLUDED IN THE COST FOR
TRAFFIC CONTROL AND PROTECTION (SPECIAL).

BARRIER WALL/GUARDRAIL MARKERS SHALL BE PLACED AT 25' CENTERS.
MARKERS ON RIGHT SHALL BE CRYSTAL AND MARKERS ON LEFT SHALL
BE AMBER.

- WORK AREA
- TEMPORARY CONCRETE BARRIER
- VERTICAL PANELS
- VERTICAL PANELS WITH MONO-DIRECTIONAL FLASHING LIGHTS
- TYPE II BARRICADES OR DRUMS WITH MONO-DIRECTIONAL STEADY BURNING LIGHTS
- TYPE B OR C MONODIRECTIONAL REFLECTORS
- TYPE III BARRICADE WITH MONO-DIRECTIONAL FLASHING LIGHTS

FILE NAME =
c:\pwork\work\pwork\detersbj\d0157116\0570570-sht-plan.dgn

USER NAME = detersbj
DRAWN -
PLOT SCALE = 40.0000' / in.
PLOT DATE = 8/13/2013

DESIGNED -
CHECKED -
DATE -

REVISED -
REVISED -
REVISED -
REVISED -

**STATE OF ILLINOIS
DEPARTMENT OF TRANSPORTATION**

**TRAFFIC CONTROL AND PROTECTION STAGES IA & IIA
FAI-74 WESTBOUND**

SCALE: SHEET 1 OF 1 SHEETS STA. 633+00.00 TO STA. 638+00.00

F.A.I. RTE.	SECTION	COUNTY	TOTAL SHEETS	SHEET NO.
74	57-20(HB,HB-1)BR-1	MCLEAN	440	113
CONTRACT NO. 70570				
ILLINOIS FED. AID PROJECT				