

STAGE IB FAI-74 EASTBOUND

RDWY A
EASTBOUND

TYPICAL SECTION STAGE IB

REFLECTORIZED TEMPORARY
PAVEMENT MARKING WHITE

REFLECTORIZED TEMPORARY
PAVEMENT MARKING WHITE
SKIP-DASH

REFLECTORIZED TEMPORARY
PAVEMENT MARKING YELLOW

PLACE AT OUTSIDE
EDGE OF SHOULDER

SEE STANDARDS 701402 AND
701400 FOR FURTHER DETAILS

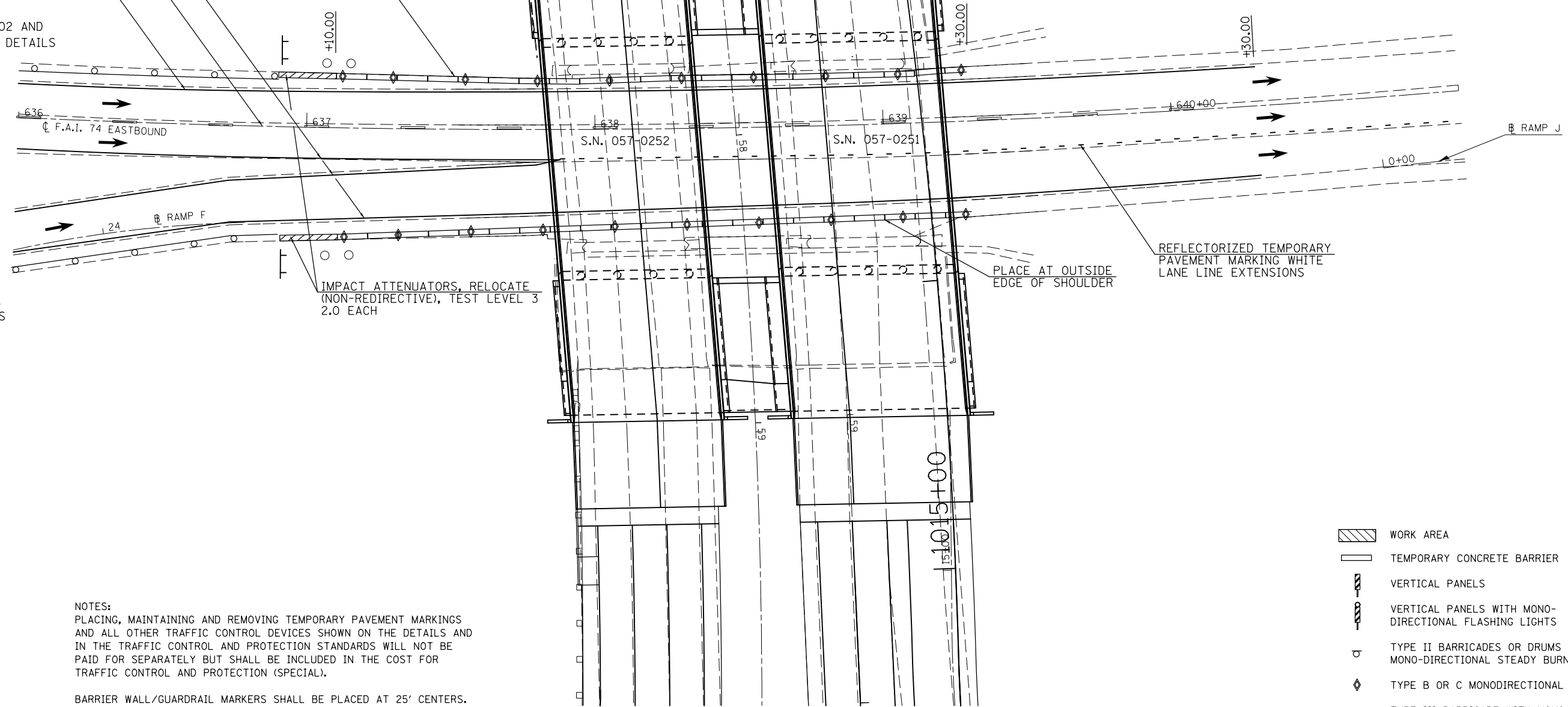

SEE STANDARD 701411
FOR FURTHER DETAILS

IMPACT ATTENUATORS, RELOCATE
(NON-REDIRECTIVE), TEST LEVEL 3
2.0 EACH

PLACE AT OUTSIDE
EDGE OF SHOULDER

REFLECTORIZED TEMPORARY
PAVEMENT MARKING WHITE
LANE LINE EXTENSIONS

PLAN SHEET LOCATION

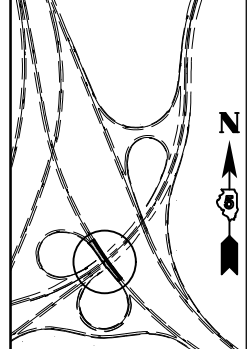

NOTES:
PLACING, MAINTAINING AND REMOVING TEMPORARY PAVEMENT MARKINGS
AND ALL OTHER TRAFFIC CONTROL DEVICES SHOWN ON THE DETAILS AND
IN THE TRAFFIC CONTROL AND PROTECTION STANDARDS WILL NOT BE
PAID FOR SEPARATELY BUT SHALL BE INCLUDED IN THE COST FOR
TRAFFIC CONTROL AND PROTECTION (SPECIAL).

BARRIER WALL/GUARDRAIL MARKERS SHALL BE PLACED AT 25' CENTERS.
MARKERS ON RIGHT SHALL BE CRYSTAL AND MARKERS ON LEFT SHALL
BE AMBER.

- WORK AREA
- TEMPORARY CONCRETE BARRIER
- VERTICAL PANELS
- VERTICAL PANELS WITH MONO-DIRECTIONAL FLASHING LIGHTS
- TYPE II BARRICADES OR DRUMS WITH MONO-DIRECTIONAL STEADY BURNING LIGHTS
- TYPE B OR C MONODIRECTIONAL REFLECTORS
- TYPE III BARRICADE WITH MONO-DIRECTIONAL FLASHING LIGHTS

FILE NAME =	USER NAME = detersbj	DESIGNED -	REVISED -
ei:\pw\work\p\idot\detersbj\d0157116\0570570-sht-plan.dgn		DRAWN -	REVISED -
PLOT SCALE = 48.0000' / in.		CHECKED -	REVISED -
PLOT DATE = 8/13/2013		DATE -	REVISED -

STATE OF ILLINOIS
DEPARTMENT OF TRANSPORTATION

TRAFFIC CONTROL AND PROTECTION STAGE IB
FAI-74 EASTBOUND

SCALE: SHEET 1 OF 1 SHEETS STA. 636+00.00 TO STA. 641+00.00

F.A.I. RTE.	SECTION	COUNTY	TOTAL SHEETS	SHEET NO.
74	57-20(HB,HB-1)BR-1	MCLEAN	440	116
CONTRACT NO. 70570				
ILLINOIS FED. AID PROJECT				