

| | | | | |
|---------------------|---------|---------------------------|--------------|-----------|
| F.A.P. RTE. | SECTION | COUNTY | TOTAL SHEETS | SHEET NO. |
| 668 | 28R-1 | SANGAMON | 354 | 147 |
| STA. | | TO STA. | | |
| FED. ROAD DIST. NO. | | ILLINOIS FED. AID PROJECT | | |
| CONTRACT NO. 72501 | | | | |

GENERAL NOTES:

1. MAINTAIN THE PROFILE AND CROSS SECTION OF DIRKSEN PARKWAY THROUGH THE INTERSECTION.
2. TRANSITION THE APPROACH PAVEMENTS OF NORTH GRAND AVE. WITHIN THE RADIUS RETURNS TO THE ELEVATIONS AS SHOWN ON THIS SHEET.
3. SEE DRAINAGE PLANS FOR STATION, OFFSET, AND ELEVATION INFORMATION FOR PROPOSED CURB AND GUTTER SECTIONS BEYOND PROPOSED SIDEWALK. ALL CURB AND GUTTER POINTS ARE CALLED OUT TO THE TOP OF FACE OF CURB.

E.O.P. ELEVATIONS ON CURVE

| NUMBER | DIRKSEN PARKWAY | | | NORTH GRAND AVENUE | | | ELEVATION |
|--------|-----------------|--------|-------|--------------------|--------|-------|-----------|
| | STATION | OFFSET | SIDE | STATION | OFFSET | SIDE | |
| A1 | 6+568.467 | 11.311 | RIGHT | 1+011.789 | 17.739 | LEFT | 179.818 |
| A2 | 6+564.034 | 12.299 | RIGHT | 1+012.658 | 13.281 | LEFT | 179.857 |
| A3 | 6+560.322 | 14.912 | RIGHT | 1+015.171 | 9.500 | LEFT | 179.970 |
| A4 | 6+557.896 | 18.748 | RIGHT | 1+018.941 | 6.973 | LEFT | 180.160 |
| A5 | 6+557.129 | 23.218 | RIGHT | 1+023.389 | 6.086 | LEFT | 180.273 |
| B1 | 6+544.943 | 22.894 | RIGHT | 1+022.739 | 6.086 | RIGHT | 180.253 |
| B2 | 6+543.943 | 18.483 | RIGHT | 1+018.303 | 6.968 | RIGHT | 180.089 |
| B3 | 6+541.334 | 14.792 | RIGHT | 1+014.543 | 9.478 | RIGHT | 180.005 |
| B4 | 6+537.514 | 12.378 | RIGHT | 1+012.029 | 13.232 | RIGHT | 180.080 |
| B5 | 6+533.540 | 11.606 | RIGHT | 1+011.150 | 17.183 | RIGHT | 180.147 |
| C1 | | | | 1+011.464 | 0.0 | | 180.013 |
| C2 | | | | 1+015.248 | 0.0 | | 180.048 |
| C3 | | | | 1+019.032 | 0.0 | | 180.232 |
| C4 | | | | 1+022.816 | 0.0 | | 180.346 |
| C5 | | | | 1+023.320 | 0.0 | | 180.354 |

NOTES.

1. POINT NO. 1 & NO. 5 ON CURVE ARE THE END POINTS OF CURVE.
2. STATION EQUATION: STATION 6+030.021 BK = STATION 6+027.285 AH

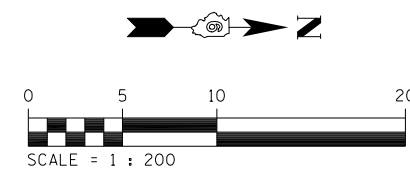
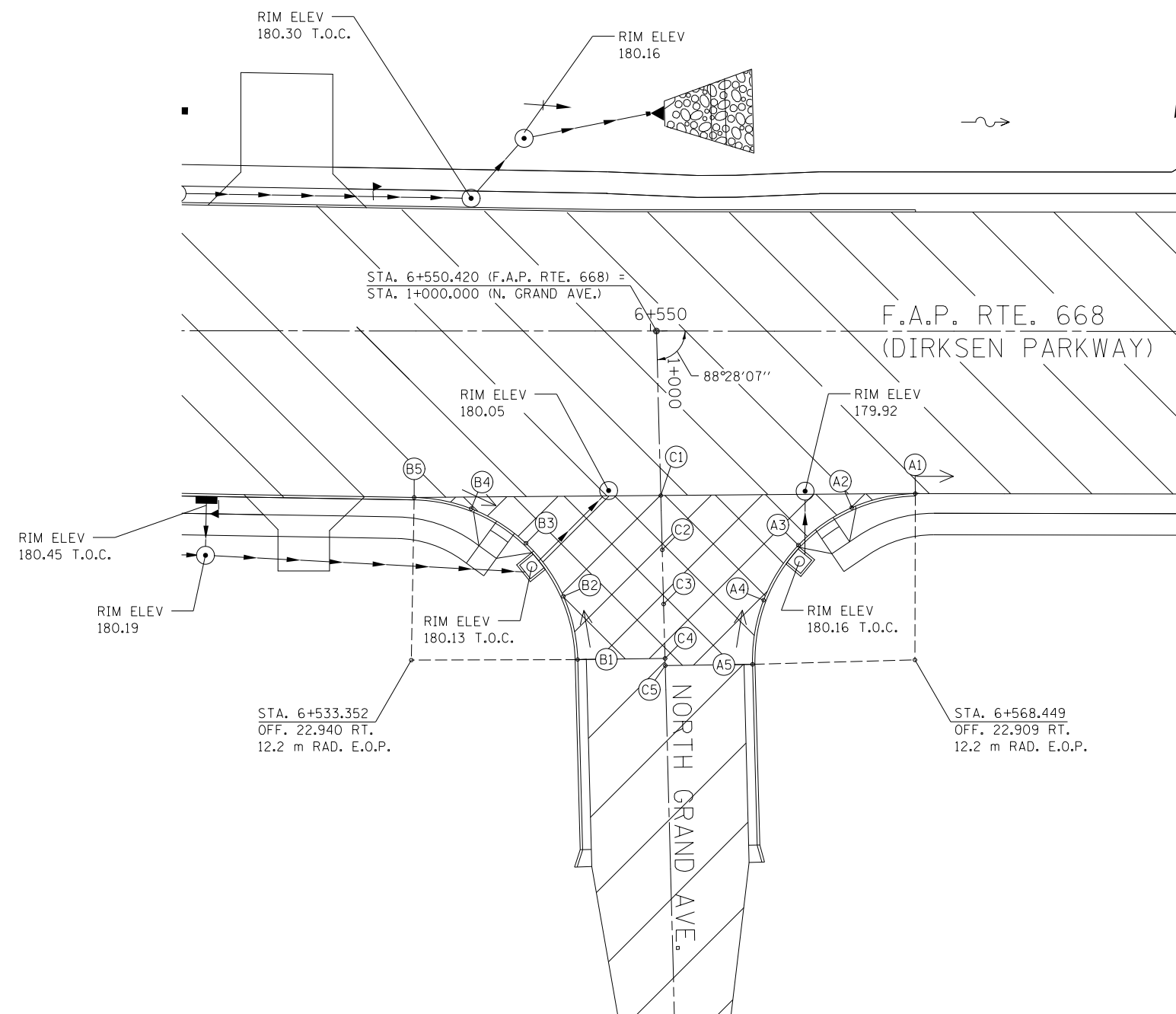
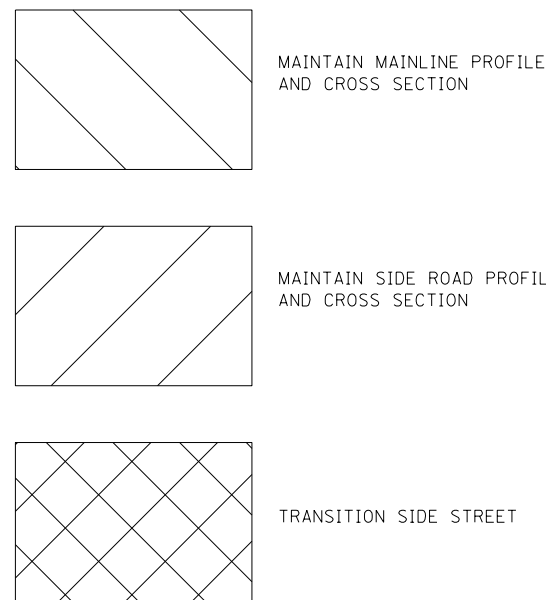

| REVISIONS | |
|-----------|------|
| NAME | DATE |
| | |
| | |
| | |
| | |
| | |
| | |
| | |

ILLINOIS DEPARTMENT OF TRANSPORTATION
 INTERSECTION DETAILS
 NORTH GRAND AVENUE
 F.A. ROUTE 668 (DIRKSEN PARKWAY)
 SECTION 281-2
 SANGAMON COUNTY
 DRAWN BY: RK
 CHECKED BY: SEW
 DATE: 06/2013