

EXISTING CONTROLLER

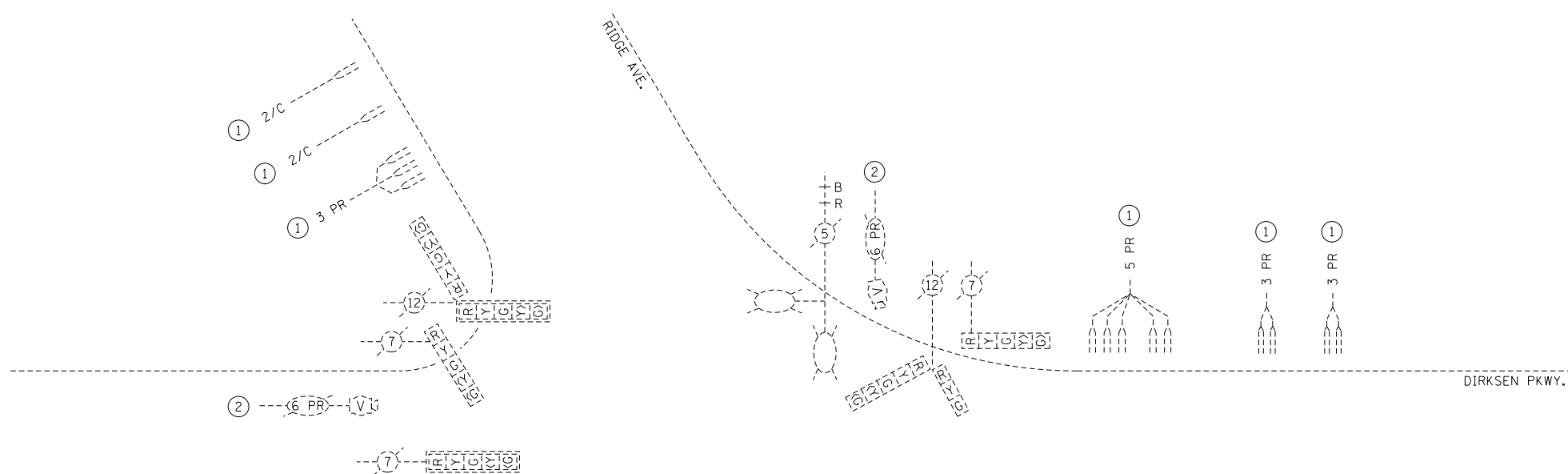

- ① CABLE REMOVED FROM CONDUIT RUNS UNDER ROADWAY AND TO CONTROLLER ABANDONED IN OTHER CONDUITS.
- ② CABLE REMOVED FROM CAMERA TO CONTROLLER.

REMOVE EXISTING TRAFFIC SIGNAL EQUIPMENT CONSISTS OF:  
 4 EACH VIDEO CAMERAS  
 1 EACH VIDEO DETECTION PROCESSOR  
 2 EACH TRAFFIC SIGNAL FACE - 5 SECTION  
 REMOVED ITEMS TO BE DELIVERED TO CITY OF SPRINGFIELD, CWLP, 1600 GROTH ST.

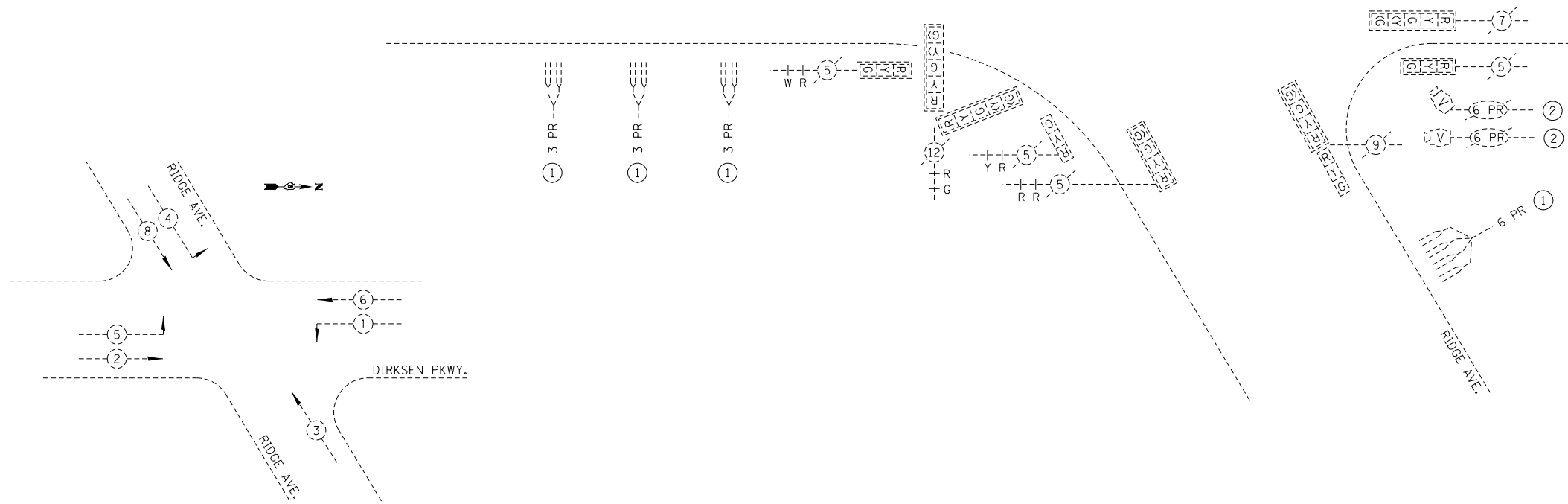

PHASE DESIGNATION DIAGRAM

NOT TO SCALE

FILE NAME = ...ridge cable 1.dgn	USER NAME = Plotted by Scott	DESIGNED -	REVISED -	<b>STATE OF ILLINOIS DEPARTMENT OF TRANSPORTATION</b>	<b>EXISTING CABLE PLAN DIRKSEN PKWY. &amp; RIDGE AVE.</b>				F.A.P. RTE.	SECTION	COUNTY	TOTAL SHEETS	SHEET NO.
	PLOT SCALE = 83.2827' / in.	DRAWN -	REVISED -		668	28R-1	SANGAMON	354	159				
	PLOT DATE =	CHECKED -	REVISED -		SCALE: SHEET OF SHEETS STA. TO STA.				CONTRACT NO. 72501				
		DATE -	REVISED -		ILLINOIS FED. AID PROJECT								