

DATE	
BY	
FINAL SURVEY	SURVEYED
NOTE BOOK	PLOTTED
NO.	TEMPLATE
	AREAS CHECKED
	AREAS CHECKED

DATE	
BY	
ORIGINAL SURVEY	SURVEYED
NOTE BOOK	PLOTTED
NO.	TEMPLATE
	AREAS CHECKED
	AREAS CHECKED

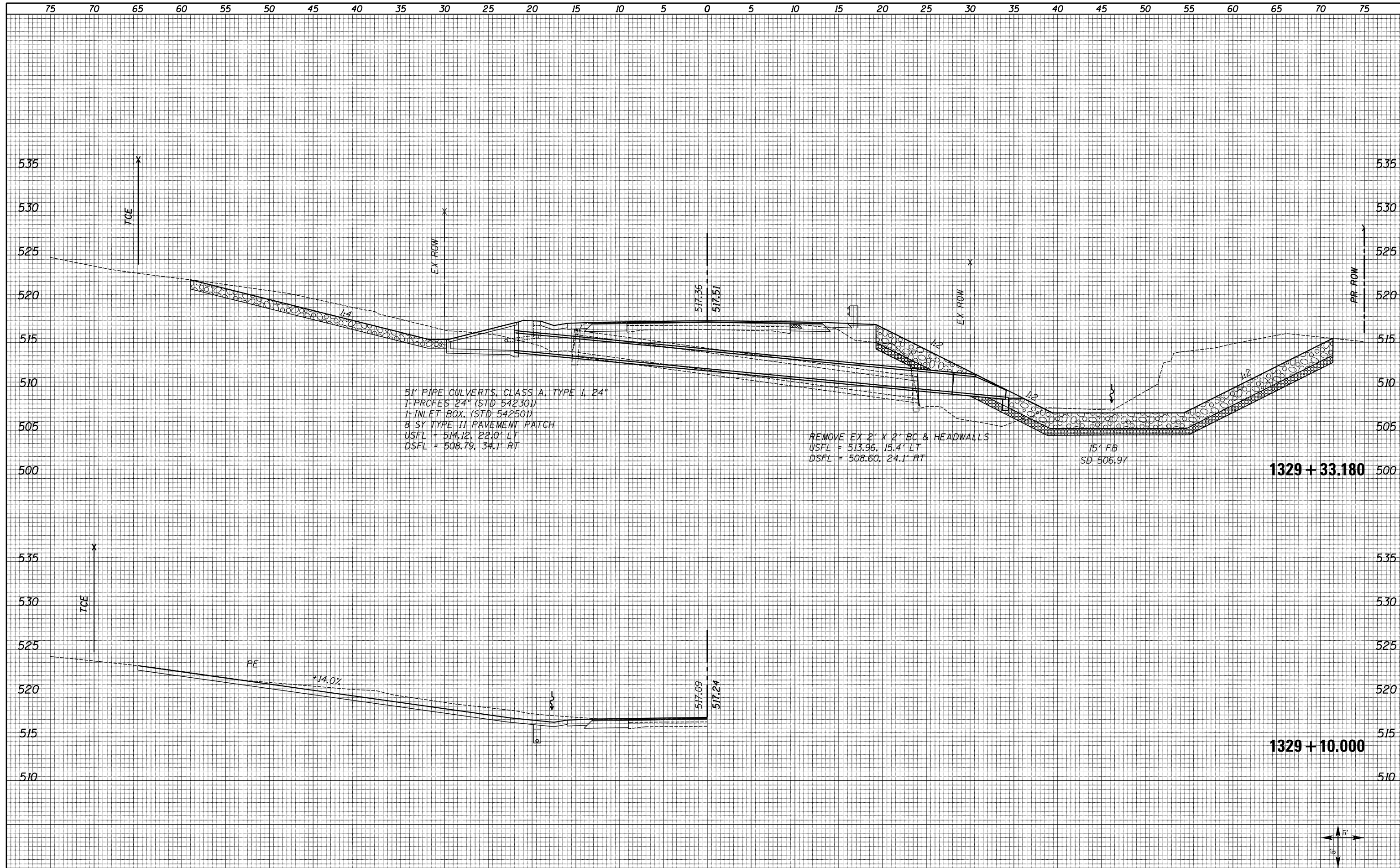

FILE NAME = XS_SHEETS-NEW.dgn	USER NAME = notel	DESIGNED -	REVISD -	<b>STATE OF ILLINOIS</b> <b>DEPARTMENT OF TRANSPORTATION</b>	<b>FAS 1597 (IL 96)</b> <b>CROSS SECTIONS</b>	F.A.S. RTE. 1597	SECTION 14 (W, RS-7)	COUNTY ADAMS/PIKE	TOTAL SHEETS 152	SHEET NO. 86	
	PLOT SCALE = 10.0000' / in.	CHECKED -	REVISD -			SCALE: SHOWN	SHEET NO. 11	OF 72 SHEETS	STA. 1329+10.000	STA. 1329+33.180	CONTRACT NO. 72781
	PLOT DATE = 8/16/2013	DATE -	REVISD -			ILLINOIS FED. AID PROJECT					