

DATE	
BY	
FINAL SURVEY	SURVEYED
NOTE BOOK	PLOTTED
NO.	TEMPLATE
	AREAS
	CHECKED

DATE	
BY	
ORIGINAL SURVEY	SURVEYED
NOTE BOOK	PLOTTED
NO.	TEMPLATE
	AREAS
	CHECKED

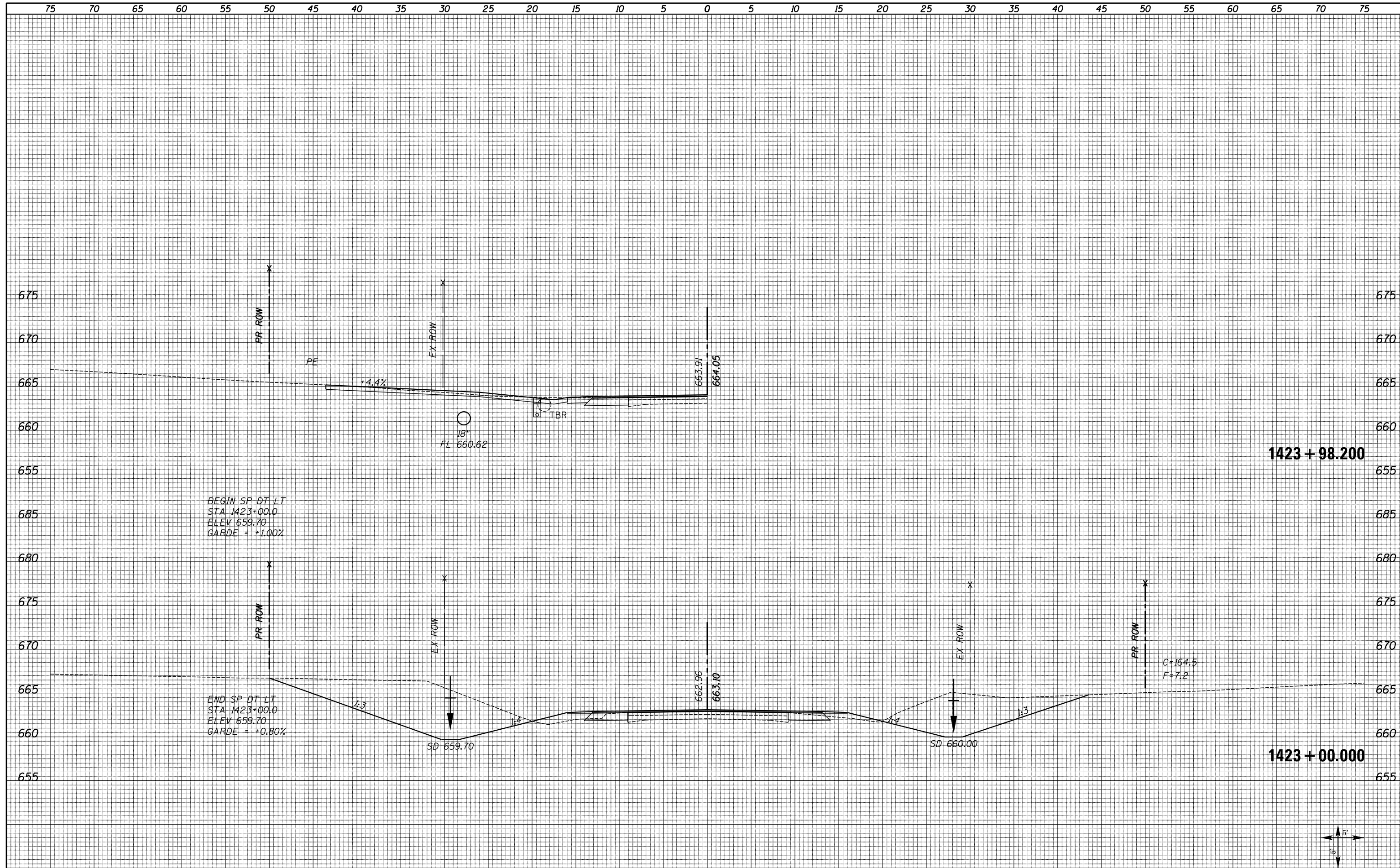

BEGIN SP DT LT  
 STA 1423+00.0  
 ELEV 659.70  
 GARDE = +1.00%

END SP DT LT  
 STA 1423+00.0  
 ELEV 659.70  
 GARDE = +0.80%

FILE NAME = XS\_SHEETS-NEW.dgn

USER NAME = notel	DESIGNED -	REVISED -
	DRAWN -	REVISED -
PLOT SCALE = 10.0000' / 1"	CHECKED -	REVISED -
PLOT DATE = 8/16/2013	DATE -	REVISED -

**STATE OF ILLINOIS  
 DEPARTMENT OF TRANSPORTATION**

**FAS 1597 (IL 96)  
 CROSS SECTIONS**

SCALE: SHOWN    SHEET NO. 66 OF 72 SHEETS    STA. 1423+00.000    STA. 1423+98.200

F.A.S. RTE.	SECTION	COUNTY	TOTAL SHEETS	SHEET NO.
1597	14 (W, RS-7)	ADAMS/PIKE	152	141
				CONTRACT NO. 72781
ILLINOIS FED. AID PROJECT				

