

EXIST. CURVE REV. MECH. RD.
 PI STA. = 88+60.93
 $\Delta = 80^\circ 06' 14''$ (LT)
 D = 7° 40' 00"
 R = 747.34'
 T = 628.25'
 L = 1,044.84'
 E = 228.99'
 e = 8.0%
 T.R. = 39.00'
 S.E. RUN = 208.00'
 P.C. STA. = 82+32.68
 P.T. STA. = 92+77.52

PAVEMENT MARKING LEGEND

- ① PR PREFORMED PLASTIC PAVEMENT MARKING, TYPE B (INLAID), LINE 5" (30' SKIP, 10' DASH)
- ② PR URETHANE PAVEMENT MARKING, LINE 5" (SOLID YELLOW)
- ③ PR URETHANE PAVEMENT MARKING, LINE 5" (SOLID WHITE)
- ④ PR URETHANE PAVEMENT MARKING, LINE 6" (SOLID WHITE)
- ⑤ PR URETHANE PAVEMENT MARKING, LINE 6" (6' SKIP, 2' DASH)
- ⑥ PR PREFORMED PLASTIC PAVEMENT MARKING, TYPE B (INLAID), LINE 8" (SOLID WHITE)
- ⑦ PR PREFORMED PLASTIC PAVEMENT MARKING, TYPE B (INLAID), LINE 12" (SOLID WHITE)
- ⑧ PR PREFORMED PLASTIC PAVEMENT MARKING, TYPE B (INLAID), LINE 24" (SOLID WHITE)
- ⑨ PR PREFORMED PLASTIC PAVEMENT MARKING, TYPE B (INLAID), LETTERS & SYMBOLS (SOLID WHITE)
- ▽ PR RAISED REFLECTIVE PAVEMENT MARKER, ONE-WAY, WHITE
- ◀ PR RAISED REFLECTIVE PAVEMENT MARKER, ONE-WAY, AMBER

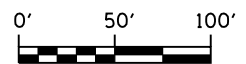
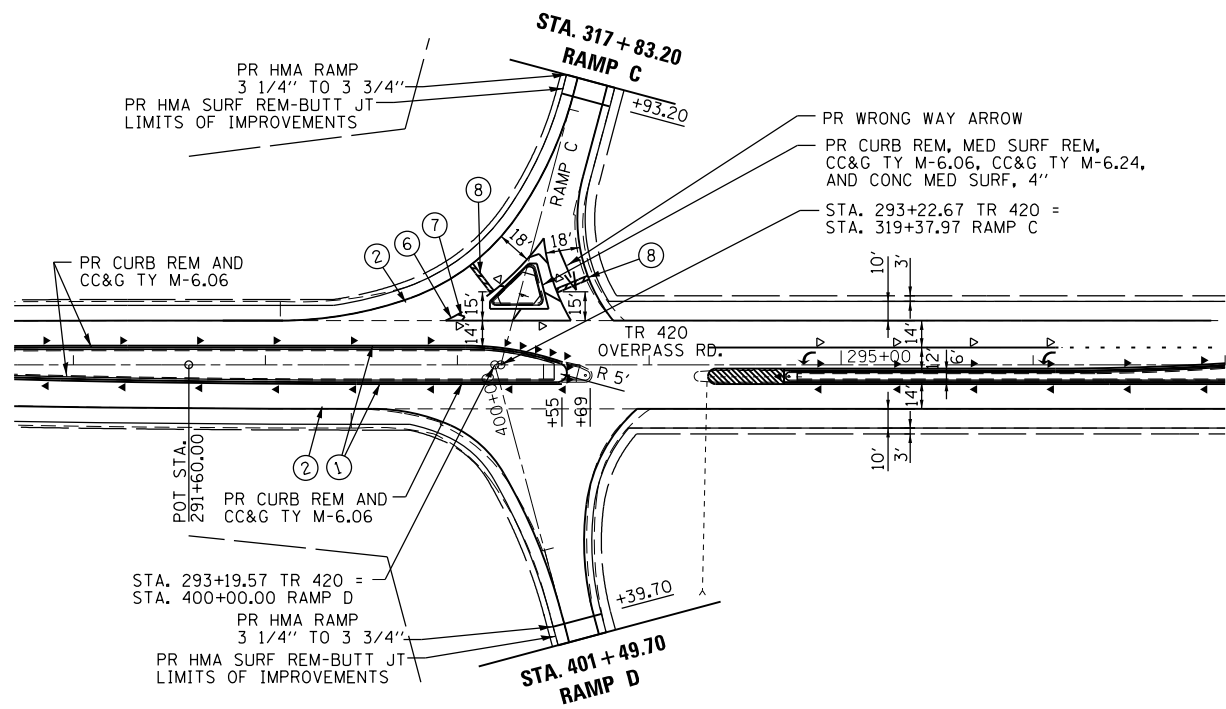
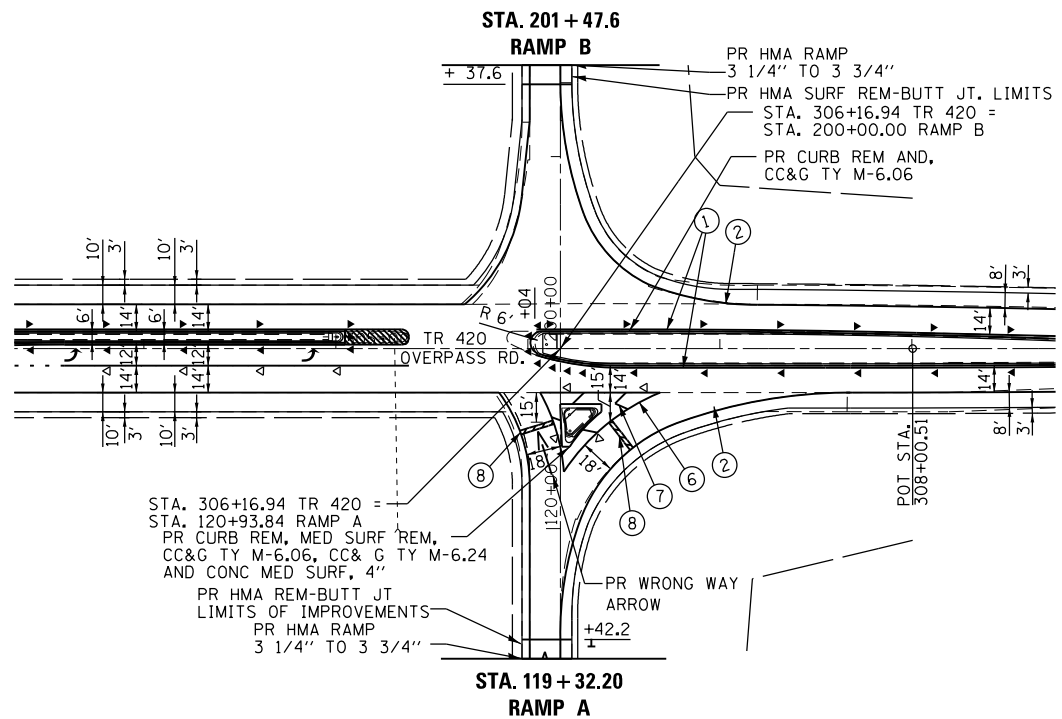
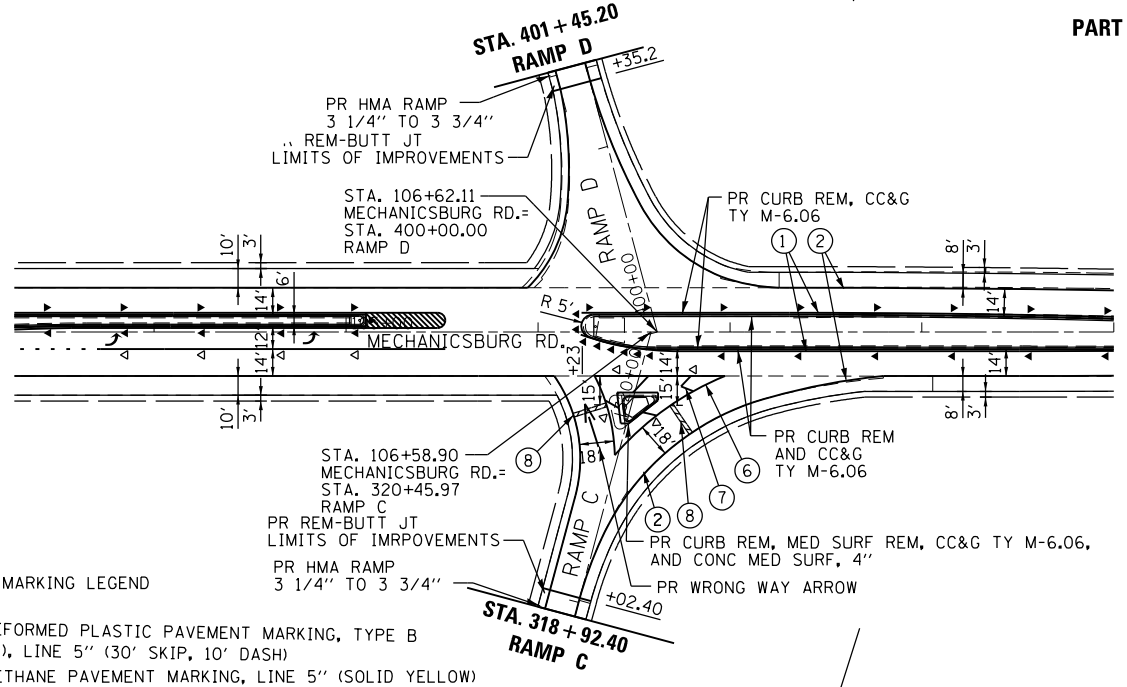

USER NAME = sparksgw	DESIGNED - BTM	REVISED -
DRAWN - BTM	REVISED -	
PLOT SCALE = 100.0000' / in.	CHECKED - JSA	REVISED -
PLOT DATE = Sep-06-2013 09:12:18AM	DATE - 12/19/12	REVISED -

STATE OF ILLINOIS
 DEPARTMENT OF TRANSPORTATION

PLAN SHEETS				
SCALE:	SHEET NO.	OF SHEETS	STA.	TO STA.

F.A.I. RTE.	SECTION	COUNTY	TOTAL SHEETS	SHEET NO.
1772	*	SANGAMON	194	85
* (84-10-1RS-3,84-10-2RS-4)BR, I			CONTRACT NO. 72C90	
ILLINOIS FED. AID PROJECT				