

EXISTING SN 093-0016  
 SINGLE SPAN RC THRU GIRDER AND  
 DECK SUPERSTRUCTURE ON RC  
 CLOSED ABUTMENTS  
 24'-2" O-O  
 53'-0" BK-BK ABUTMENTS  
 REMOVAL OF EXISTING STRUCTURES = 1 EACH

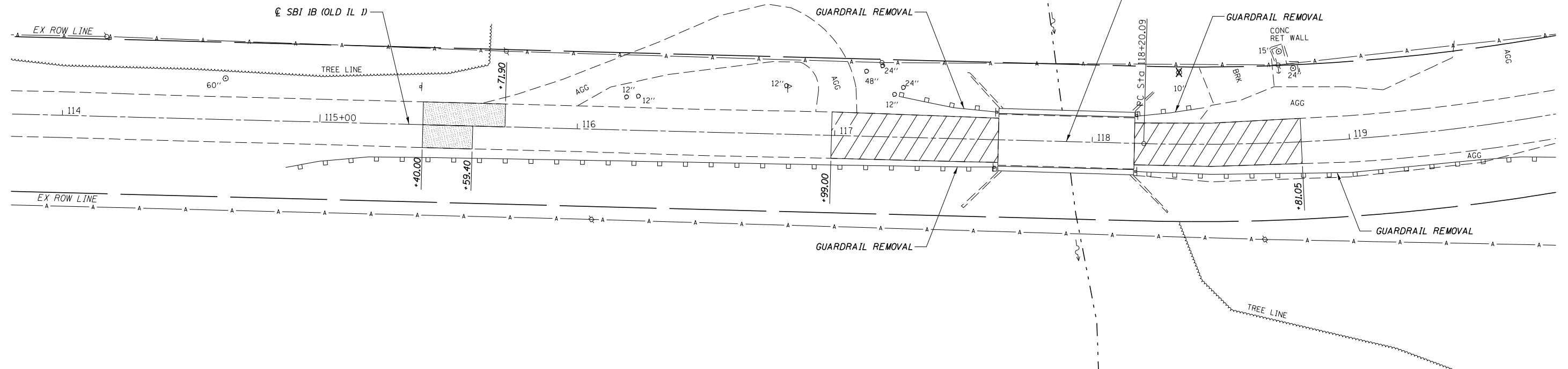

**LEGEND**

- HMA SURFACE REMOVAL
- PAVEMENT REMOVAL
- TREE REMOVAL

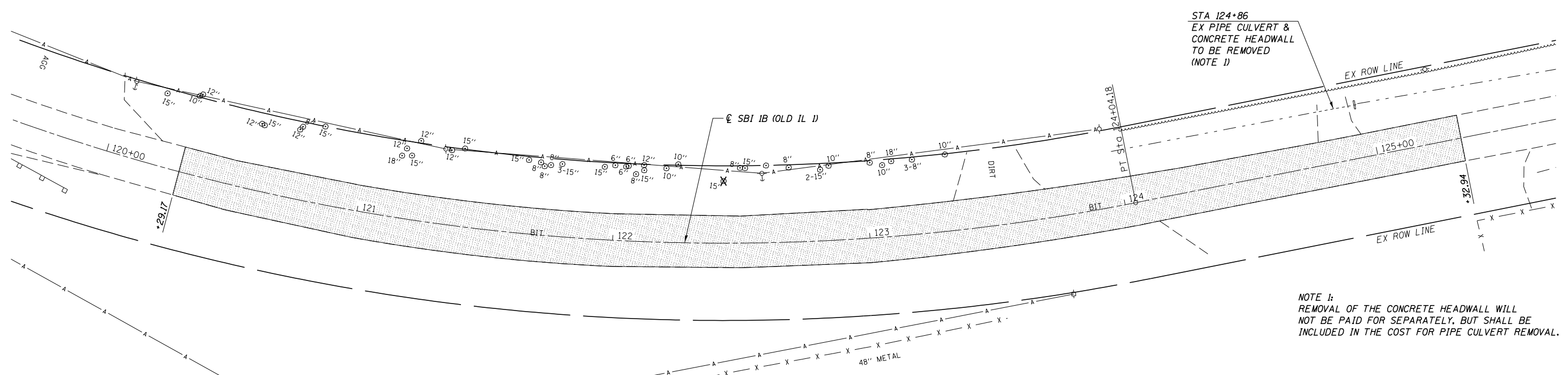

NOTE 1:  
 REMOVAL OF THE CONCRETE HEADWALL WILL  
 NOT BE PAID FOR SEPARATELY, BUT SHALL BE  
 INCLUDED IN THE COST FOR PIPE CULVERT REMOVAL.



JOB = 2223.5  
 FILE NAME = 0774217-shr-rem.dgn  
 PLOT SCALE = 40.0000' / 1" =  
 PLOT DATE = 7/29/2013

DESIGNED - NAK  
 DRAWN - TJD  
 CHECKED - NAK  
 DATE - 4/8/2011

REVISED -  
 REVISED -  
 REVISED -  
 REVISED -

STATE OF ILLINOIS  
 DEPARTMENT OF TRANSPORTATION

REMOVAL PLAN

SCALE: SHEET NO. OF SHEETS STA. 114+00.00 TO STA. 125+32.94

SBI RTE.	SECTION	COUNTY	TOTAL SHEETS	SHEET NO.
1B	(12A)B-1	WABASH	52	17
		CONTRACT NO. 74217		
		FED. ROAD DIST. NO. ILLINOIS FED. AID PROJECT		