

**TYPICAL EDGE LINES & LANE LINES**

**PAVEMENT MARKING MATERIALS**

1. THERMO PLASTIC PAVEMENT MARKING LINE SHALL BE USED FOR THE EDGE LINES, GORE LINES, AND DIAGONAL LINES ON BITUMINOUS PAVEMENT ONLY.
2. PREFORMED PLASTIC TYPE B PAVEMENT MARKING LINE; INLaid OR GROOVED IN SHALL BE USED FOR ALL LANE LINES ON HMA PAVEMENT PROJECTS.
3. POLYUREA PAVEMENT MARKING SHALL BE USED FOR ALL MARKINGS ON PCC PROJECTS.

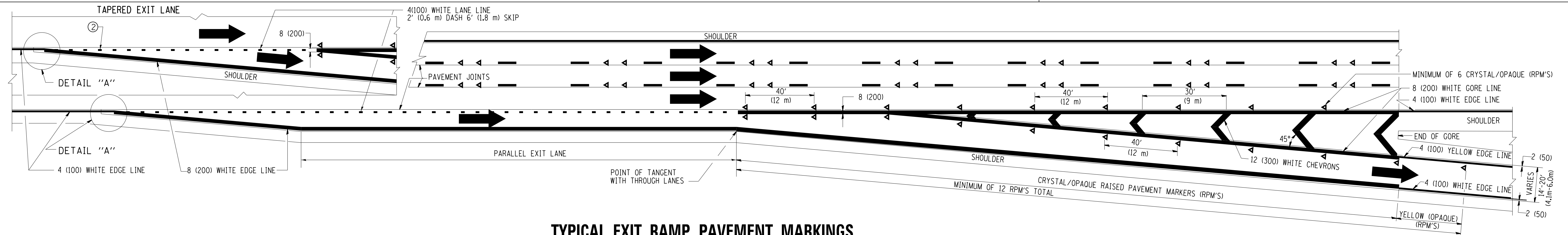

**TYPICAL EXIT RAMP PAVEMENT MARKINGS**

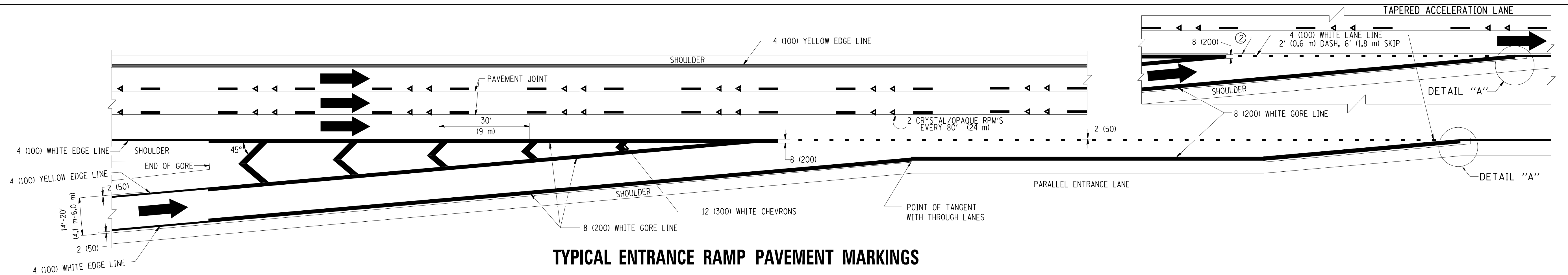

**TYPICAL ENTRANCE RAMP PAVEMENT MARKINGS**

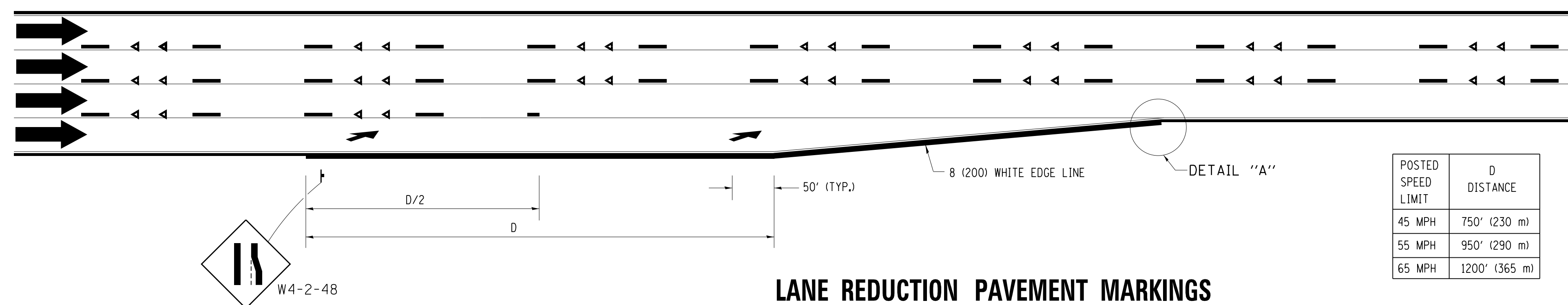

**LANE REDUCTION PAVEMENT MARKINGS**

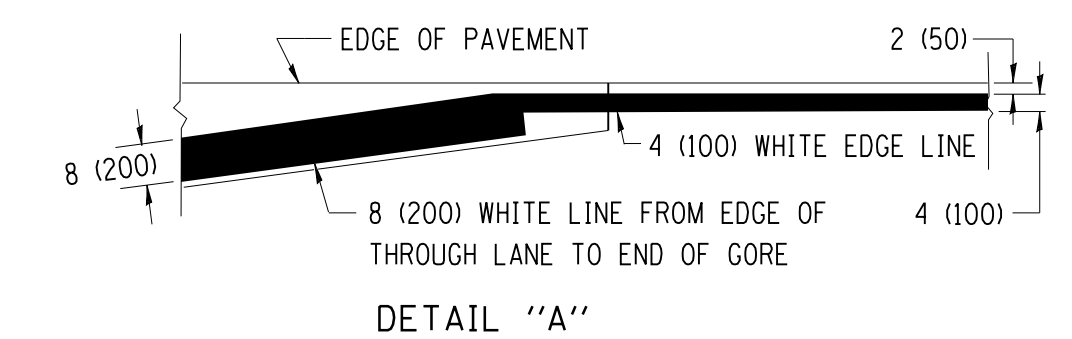

**NOTES:**

- ① THE DIAGONAL LINES SHALL BE SPACED AT 40' (12 m) C-C ACROSS ALL STRUCTURES WHICH ARE 500' (150 m) OR LESS IN LENGTH. THE DIAGONAL LINES ARE NOT REQUIRED ON SHOULDERS WHICH ARE 6' (1.8 m) OR LESS IN WIDTH.
- ② 4" (2' DASH, 6' SKIP) MARKING ON TAPERED ENTRANCE AND EXIT RAMP SHALL BE OMITTED ON TANGENT SECTIONS.

FILE NAME =  
 USER NAME = footemj  
 DRAWN -  
 CHECKED -  
 DATE - 01-90  
 PLOT SCALE = 50.000' / in.  
 PLOT DATE = 7/8/2013

DESIGNED - D.W.S.  
 REVISIONS:  
 REVISED - J.A.F. 02-06  
 REVISED - S.P.B. 01-07  
 REVISED - S.P.B. 01-10  
 REVISED - M.D. 05-13

**STATE OF ILLINOIS  
 DEPARTMENT OF TRANSPORTATION**

POSTED SPEED LIMIT	D DISTANCE
45 MPH	750' (230 m)
55 MPH	950' (290 m)
65 MPH	1200' (365 m)

**MULTI-LANE FREEWAY  
 PAVEMENT MARKING DETAILS**  
 SCALE: NONE  
 SHEET NO. 1 OF 2 SHEETS  
 STA. TO STA.

F.A. RTE.	SECTION	COUNTY	TOTAL SHEETS	SHEET NO.
	TC-12			
FED. ROAD DIST. NO. 1 ILLINOIS FED. AID PROJECT			CONTRACT NO.	