

CONSTRUCTION PLANS

FOR

METROPOLIS MUNICIPAL AIRPORT

METROPOLIS, MASSAC COUNTY, ILLINOIS

CONSTRUCT PARTIAL PARALLEL TAXIWAY TO RUNWAY END 36 PHASE 1-GRADING AND DRAINAGE

SCOPE OF WORK

THIS PROJECT CONSISTS OF THE CONSTRUCTION OF A PARTIAL PARALLEL TAXIWAY FROM THE EXISTING TAXIWAY "A" TO RUNWAY END 36. ASSOCIATED WORK ITEMS CONSIST OF UNCLASSIFIED EXCAVATION, CLEARING AND GRUBBING, DRAINAGE INSTALLATION, SEEDING AND MULCHING.

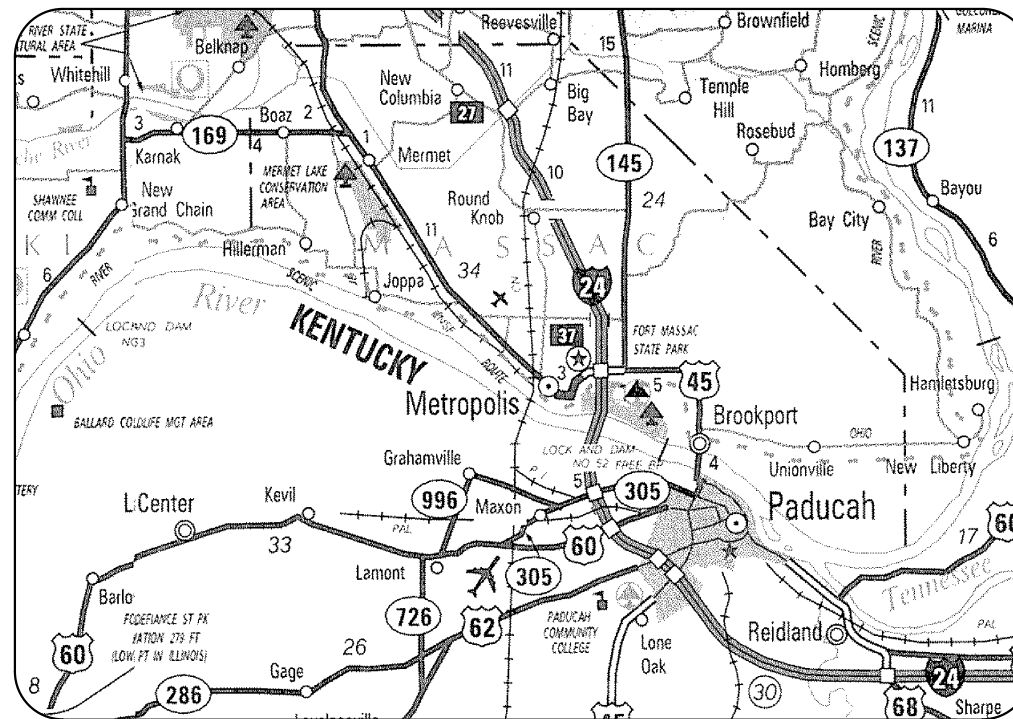

LOCATION

ILL. PROJ.: M30-4207
 S.B.G. PROJ.: 3-17-0067-B10
 LATITUDE: 37° 11' 00"
 LONGITUDE: 88° 45' 02"
 ELEVATION: 384.0' M.S.L.
 DATE: SEPT. 06, 2013



HANSON
 Hanson Professional Services Inc.
CIVIL ENGINEER

Submitted by: *Jeffrey S. Litherland* ENG'R
 Date Submitted: SEPT. 6, 2013
 Lic. Exp. Date: NOVEMBER 30, 2013

CITY OF METROPOLIS

Approved: *Bill McDaniel* MAYOR
 Date: 9/17/13
 Approved: *Jan L. Stevens* CITY CLERK
 Date: 9-17-2013

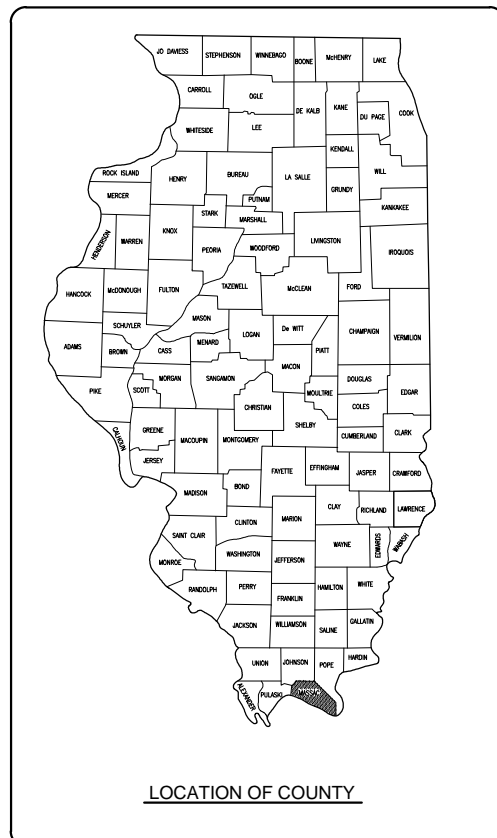

SEP 17, 2013 4:14 PM SCHUB01446
 p:\s\sp\306\hanson\dom\hanson\Projects\Documents\12\jobs\12A0078D\CAD\Airport\Sheet\c9b85-c9b85-34b

REVISION	DATE

**METROPOLIS MUNICIPAL AIRPORT
METROPOLIS, ILLINOIS**

S.B.G. PROJ.: 3-17-0067-B10
ILL. PROJ.: M30-4207

Hanson Project No.	12A0078
Filename	G-B81-2013-08-02
Scale	NOT TO SCALE
Date	08/02/2013
LAYOUT	JSL 06/03/13
DRAWN	CWS 06/03/13
REVIEWED	JSL 08/02/13

HANSON
 Hanson Professional Services Inc. 2013
 Hanson Professional Services Inc.
 1525 South Sixth Street
 Springfield, Illinois 62703-2886
 Ph: (217) 788-2450 Fax: (217) 788-2503
 www.hanson-inc.com
 Offices Nationwide

CONSTRUCT PARTIAL
 PARALLEL TAXIWAY
 COVER SHEET
 1
 1 of 19 sheets

SUMMARY OF QUANTITIES

ITEM NO.	DESCRIPTION	UNIT	TOTAL QUANTITIES	AS BUILT QUANTITIES
AR150510	FIELD OFFICE	L.S.	1	
AR150540	HAUL ROUTE	L.S.	1	
AR151450	CLEARING AND GRUBBING	ACRE	1.4	
AR152510	UNCLASSIFIED EXCAVATION	C.Y.	9774	
AR156510	SILT FENCE	L.F.	800	
AR156511	DITCH CHECKS	EACH	9	
AR156521	HEADWALL PROTECTION	EACH	2	
AR156544	RIPRAP GRADATION NO. 4	S.Y.	167	
AR701518	18" RCP, CLASS IV	L.F.	72	
AR701524	24" RCP, CLASS IV	L.F.	104	
AR752418	PRECAST REINFORCED CONC. FES 18"	EACH	2	
AR752424	PRECAST REINFORCED CONC. FES 24"	EACH	2	
AR901510	SEEDING	ACRE	8.6	
AR901520	TEMPORARY SEEDING	ACRE	8.6	
AR908510	MULCHING	ACRE	8.6	

INDEX TO SHEETS

SHEET NO.	DESCRIPTION
1	COVER SHEET
2	SUMMARY OF QUANTITIES AND INDEX TO SHEETS
3	PROPOSED SAFETY PLAN
4	PROPOSED CLEARING PLAN
5	PROPOSED CONSTRUCTION PLAN STA. 93+96 TO 104+00
6	PROPOSED CONSTRUCTION PLAN 104+00 TO 111+34
7	PROPOSED STORMWATER POLLUTION PREVENTION PLAN
8	EROSION CONTROL DETAILS
9	PLAN AND PROFILE TWY A STA. 93+96 TO 104+00
10	PLAN AND PROFILE TWY A STA. 104+50 TO 110+45
11	PLAN AND PROFILE CONNECTOR 4
12	CROSS SECTIONS STA. 93+50 TO 95+00
13	CROSS SECTIONS STA. 95+20 TO 97+50
14	CROSS SECTIONS STA. 98+00 TO 100+50
15	CROSS SECTIONS STA. 101+00 TO 103+00
16	CROSS SECTIONS STA. 104+00 TO 106+50
17	CROSS SECTIONS STA. 107+00 TO 109+50
18	CROSS SECTIONS STA. 110+00 TO 111+00
19	CROSS SECTIONS STA. 11+50 TO 12+75

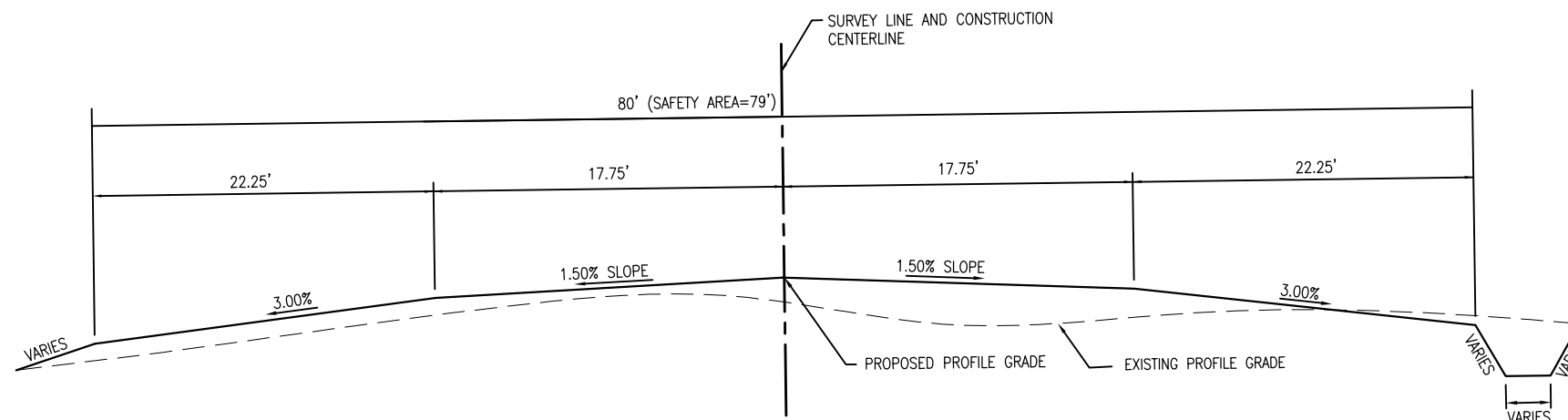

TYPICAL SECTION - TAXIWAY "A"
NOT TO SCALE

REVISION	DATE

METROPOLIS MUNICIPAL AIRPORT
METROPOLIS, ILLINOIS

IL PROJ.: M30-4207 S.B.G. PROJ.: 3-17-0067-B10

Hanson Project No.	12A0078
Filename	G-B62-26A44dwg
Scale	NOT TO SCALE
Date	08/02/2013
LAYOUT	RAW 06/03/13
DRAWN	CWS 06/03/13
REVIEWED	JSL 09/04/13

HANSON
 © Copyright Hanson Professional Services Inc. 2013
Hanson Professional Services Inc.
 1525 South Sixth Street
 Springfield, Illinois 62703-2886
 Ph: (217) 788-2450 Fax: (217) 788-2503
 www.hanson-inc.com
 Offices Nationwide

CONSTRUCT PARTIAL
PARALLEL TAXIWAY

SUMMARY OF QUANTITIES
AND INDEX TO SHEETS

SEP 17 2013 4:18 PM SCHUB01446
 pw:\sps-svc306\hanson.com\hanson_projects\Documents\12\12A0078\12A0078D\CAD\Drawings\Sheet\06085-26x34b

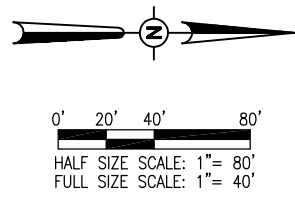
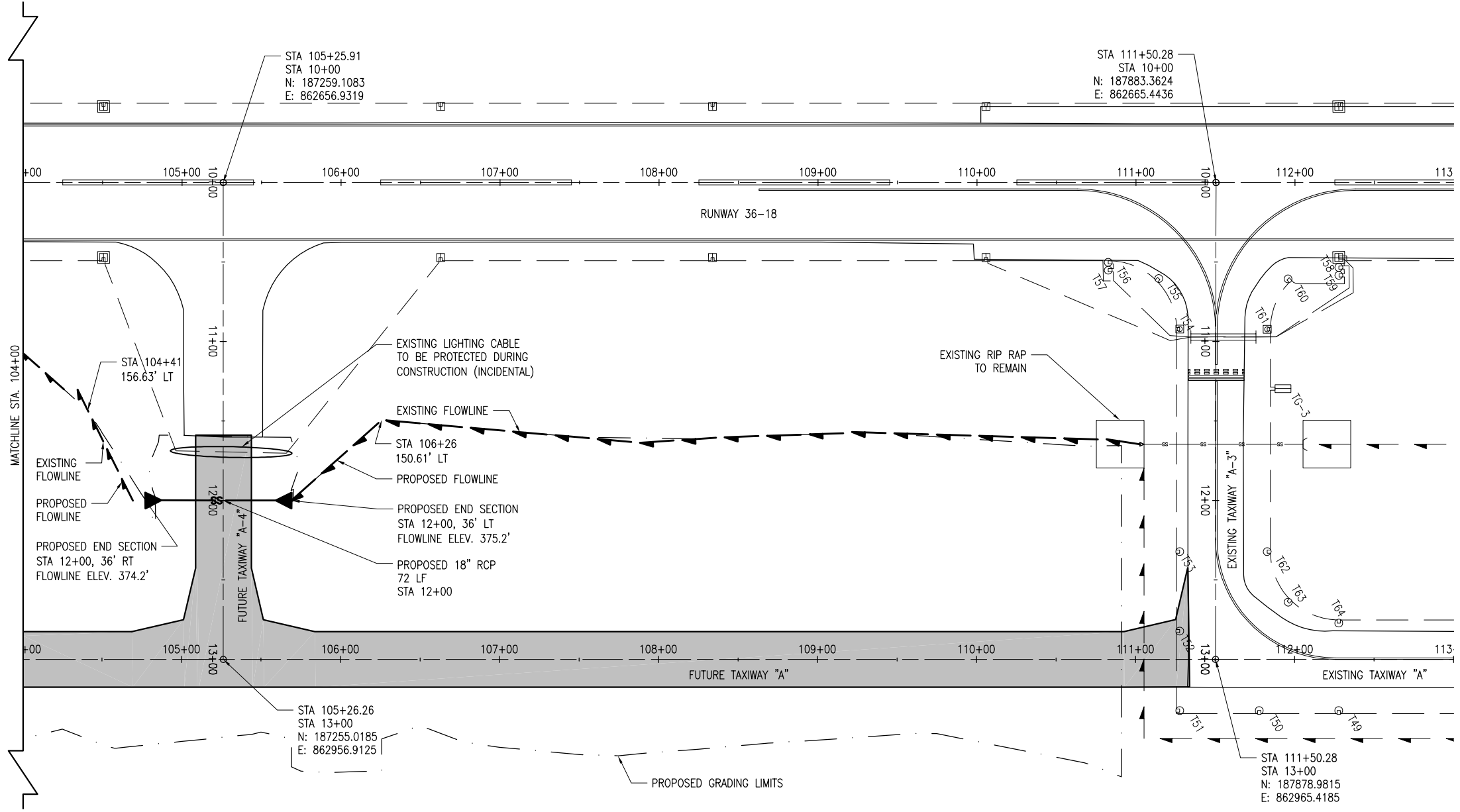

LEGEND

	EXISTING IMPROVEMENTS
	FUTURE IMPROVEMENTS
	EXISTING ELECTRICAL DUCT
	EXISTING ELECTRICAL CABLES
	PROPOSED DRAINAGE PIPE
	PROPOSED FLOWLINE
	PROPOSED GRADING LIMITS
	EXISTING DRAINAGE DITCH
	EXISTING STAKE MOUNTED RUNWAY LIGHT
	EXISTING BASE MOUNTED RUNWAY LIGHT
	EXISTING STAKE MOUNTED TAXIWAY LIGHT
	EXISTING BASE MOUNTED TAXIWAY LIGHT
	EXISTING TAXI GUIDANCE SIGN
	EXISTING HEADWALL
	EXISTING END SECTIONS
	EXISTING STAKE MOUNTED THRESHOLD LIGHT

DATE	REVISION

**METROPOLIS MUNICIPAL AIRPORT
METROPOLIS, ILLINOIS**

IL PROJ.: M30-4207 S.B.G. PROJ.: 3-17-0067-B10

Hanson Project No.	12A0078
Filename	G-BB-2-2438.dwg
Scale	1:40
Date	08/02/2013
LAYOUT	JRH 06/30/13
DRAWN	JRH 06/30/13
REVIEWED	JSL 09/04/13

HANSON
Professional Services Inc. 2013
1525 South Sixth Street
Springfield, Illinois 62703-2986
Ph: (217) 788-2450 Fax: (217) 788-2503
www.hanson-inc.com
Offices Nationwide

**CONSTRUCT PARTIAL
PARALLEL TAXIWAY**

PROPOSED CONSTRUCTION
PLANS STA. 104+00 TO
111+34

SEP 17 2013 4:28 PM SCHUB01446
pw:\sps-svc306.hanson.com\hanson_projects\Documents\12A0078\12A0078D\CAD\Borner\Borner.dwg

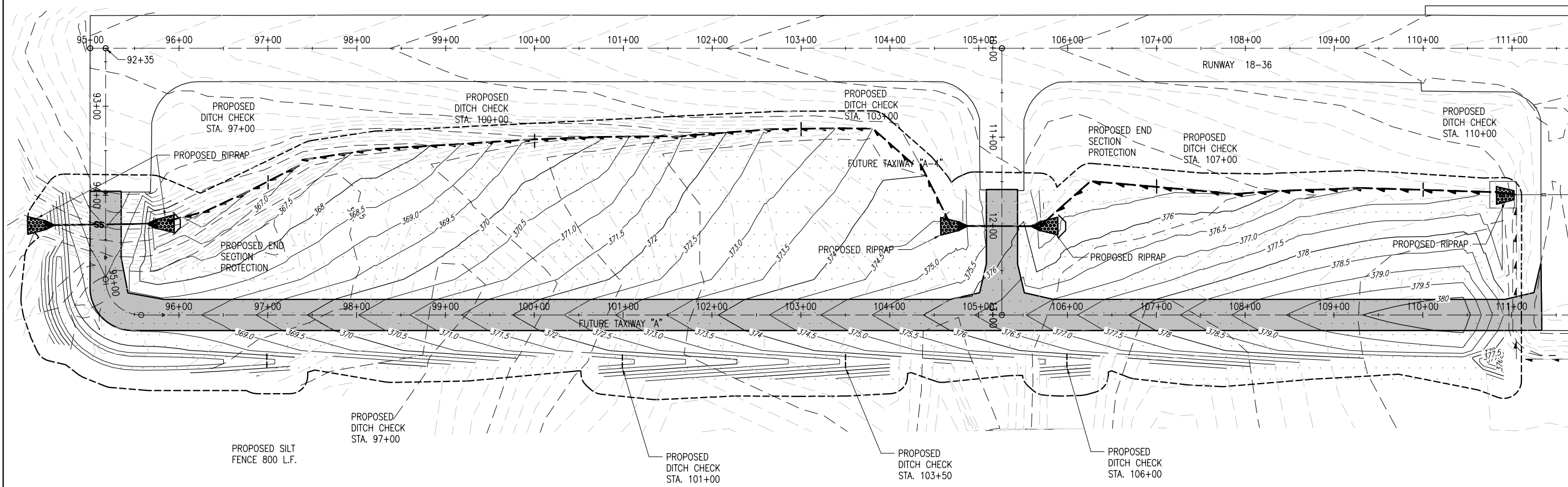

901 SEEDING NOTES

THE PROPOSED SEEDING SHALL BE ACCOMPLISHED IN ACCORDANCE WITH ITEM 901 "SEEDING" AS STATED ON PAGE 319 OF THE STANDARD SPECIFICATIONS FOR CONSTRUCTION OF AIRPORTS, ADOPTED APRIL 1, 2012.

ALL AREAS LOCATED WITHIN THE PROPOSED SEEDING LIMITS WILL BE SEEDDED IN ACCORDANCE WITH THE ABOVE NOTED SPECIFICATION. ALL AREAS OUTSIDE THE DESIGNATED SEEDING LIMITS WILL ALSO BE SEEDDED BUT AT THE CONTRACTOR'S OWN EXPENSE.

ALL MATERIALS AND/OR DEBRIS RESULTING FROM THE SEEDING OPERATIONS WILL BE REMOVED FROM THE PAVEMENT AND MISCELLANEOUS STRUCTURES PRIOR TO OPENING THE RUNWAY.

DATE SEEDING COMPLETED _____

THE PROPOSED SEEDING WILL BE PAID FOR UNDER ITEMS:
AR901510 SEEDING _____ PER ACRES

EROSION CONTROL NOTES

- ALL PROPOSED EROSION CONTROL MEASURES SHALL BE COMPLETED AS DETAILED ON THIS EROSION CONTROL PLAN AND IN ACCORDANCE WITH THE SPECIFICATIONS. EROSION CONTROL MEASURES ARE GOVERNED BY THE ILLINOIS ENVIRONMENTAL PROTECTION AGENCY'S STANDARDS AND SPECIFICATIONS FOR SOIL EROSIONS AND SEDIMENT CONTROL.
- FILTER FENCE FOR STRUCTURE PROTECTION AS SHOWN ON THIS SHEET.
- FILTER FENCE IS INCLUDED AS PART OF HEADWALL PROTECTION PAY ITEM.
- INSPECTION OF THE HEADWALL PROTECTION SHALL BE FREQUENT AND REPAIR/REPLACEMENT SHALL BE MADE PROMPTLY AS NEEDED.
- EROSION CONTROL FENCE, HEADWALL PROTECTION AND DITCH CHECKS SHALL BE REMOVED WHEN THEY HAVE SERVED THEIR USEFULNESS SO AS NOT TO BLOCK OR IMPEDE STORM WATER DRAINAGE AND GRASS HAS BEEN ESTABLISHED.
- COST OF REMOVAL AND REPLACEMENT SHALL BE INCLUDED IN THE UNIT PRICE FOR ITEM:
AR156510 SILT FENCE
AR156511 DITCH CHECK

908 MULCHING NOTES

THE PROPOSED MULCHING SHALL BE ACCOMPLISHED IN ACCORDANCE WITH ITEM 908 "MULCHING" AS STATED ON PAGE 330 OF THE STANDARD SPECIFICATIONS FOR CONSTRUCTION OF AIRPORTS, ADOPTED APRIL 1, 2012.

THIS ITEM SHALL CONSIST OF THE FURNISHING, TRANSPORTING, AND PLACING MULCH OVER THE SEEDED AREA. DISTURBED AREAS OUTSIDE THE GRADING LIMITS SHALL ALSO BE MULCHED AND PARTICIPATION WILL BE THE SAME AS FOR SEEDDED AREAS.

908-2.1 MULCH MATERIAL: THE CONTRACTOR MAY EITHER FURNISH STRAW OR HYDROMULCH AS THE TYPE OF MULCH MATERIAL TO BE USED ON THIS PROJECT.

908-3.1 MULCHING: THE HYDRAULIC MULCH SHALL BE APPLIED AS A SLURRY OF 2,500 POUNDS OF MULCH AND NOT LESS THAN 2,500 GALLONS OF WATER PER ACRE.

908-3.4 STRUCTURE CLEANING: AFTER THE PROPOSED MULCH HAS BEEN APPLIED, THE CONTRACTOR WILL CLEAN THE MULCH OFF ALL STRUCTURES (DRAINAGE, ELECTRICAL, LIGHTS, ETC.).

DATE MULCHING COMPLETED _____

THE PROPOSED MULCHING WILL BE PAID FOR UNDER ITEMS:
AR908510 MULCHING _____ PER ACRES

TEMPORARY SEEDING DATA

THE SEEDING LIMITS ARE SHOWN ON THIS SHEET. ALL AREAS WITHIN THESE LIMITS SHALL BE SEEDDED IN ACCORDANCE WITH THE SPECIFIED FORMULA AND RATES OF APPLICATION, IF REQUIRED.

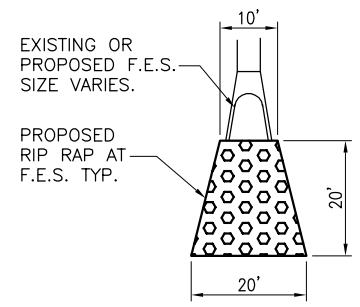

RIP RAP DETAIL
"NOT TO SCALE"

LEGEND

- EXISTING IMPROVEMENTS
- FUTURE IMPROVEMENTS
- PROPOSED SEEDING/MULCHING
- PROPOSED CONSTRUCTION LIMITS
- EXISTING DRAINAGE PIPE
- EXISTING DRAINAGE DITCH
- EXISTING HEADWALL
- EXISTING END SECTION
- PROPOSED DRAINAGE DITCH
- PROPOSED DITCH CHECK
- PROPOSED END SECTION PROTECTION
- PROPOSED SILT FENCE
- PROPOSED DRAINAGE PIPE
- PROPOSED RIP RAP

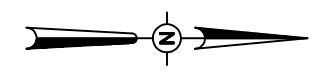

0' 30' 60' 120'
HALF SIZE SCALE: 1" = 120'
FULL SIZE SCALE: 1" = 60'

REVISION	DATE

**METROPOLIS MUNICIPAL AIRPORT
METROPOLIS, ILLINOIS**

IL PROJ.: M30-4207 S.B.G. PROJ.: 3-17-0067-B10

Hanson Project No.	12A0078
Filename	G-BB2-23MPR00.dwg
Scale	AS SHOWN
Date	08/02/2013
LAYOUT	RAW 06/03/13
DRAWN	JRH 06/20/13
REVIEWED	JSL 09/04/13

HANSON
Professional Services Inc. 2013
1525 South Sixth Street
Springfield, Illinois 62703-2986
Ph: (217) 788-2450 Fax: (217) 788-2503
www.hanson-inc.com
Offices Nationwide

**CONSTRUCT PARTIAL
PARALLEL TAXIWAY**

**PROPOSED STORMWATER
POLLUTION PREVENTION
PLAN**

SEP 17 2013 4:26 PM SCHUB01446
pw:\sps-svr306\hanson.com\Projects\Documents\12A0078\12A0078D\CAD\Borner\Borner.dwg\4886-58782546

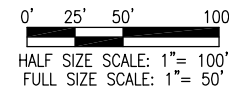

LEGEND
 [Dashed line] EXISTING PAVEMENT
 [Solid line] PROPOSED IMPROVEMENTS

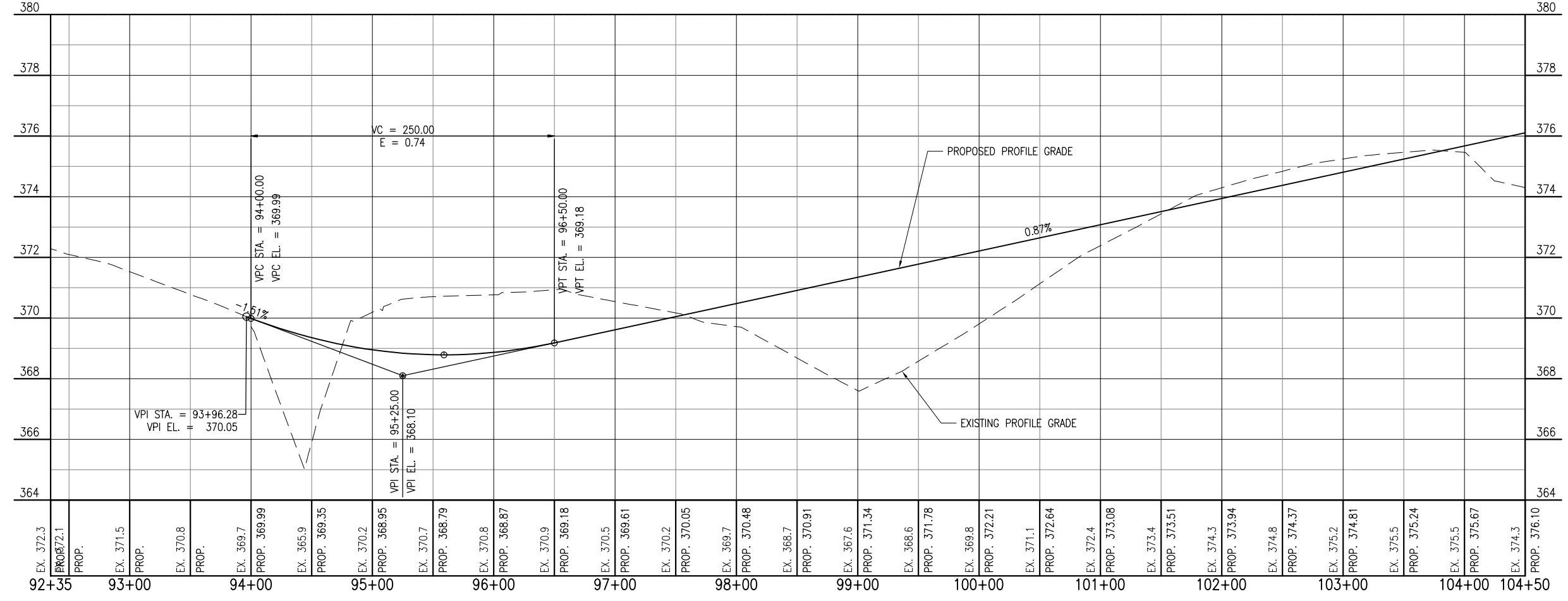
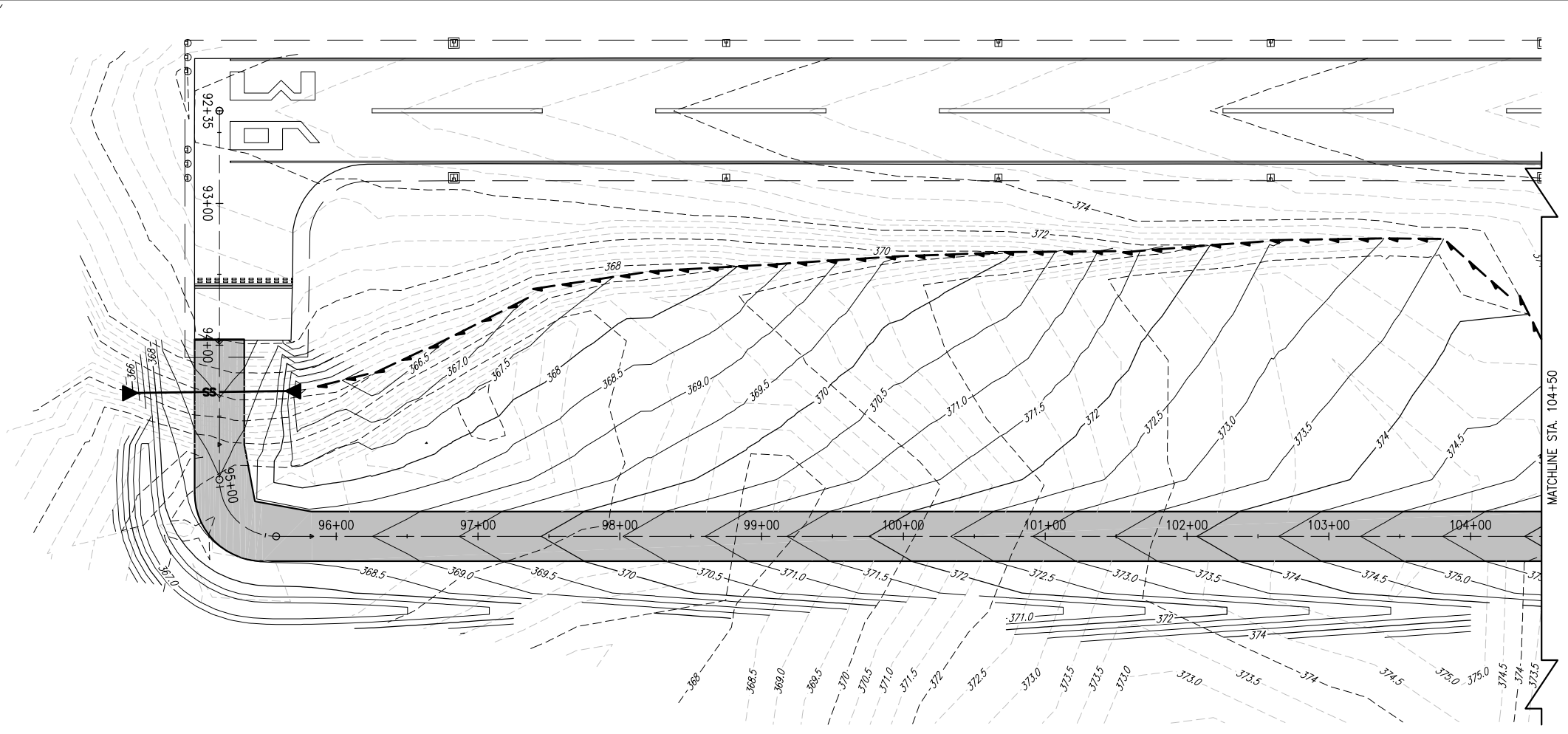

EX. 372.3	PROP. 372.1	EX. 371.5	EX. 370.8	EX. 369.7	EX. 369.9	EX. 370.2	EX. 370.7	EX. 370.8	EX. 370.9	EX. 370.5	EX. 370.2	EX. 369.7	EX. 368.7	EX. 367.6	EX. 368.6	EX. 369.8	EX. 371.1	EX. 372.4	EX. 373.4	EX. 374.3	EX. 374.8	EX. 375.2	EX. 375.5	EX. 375.5	EX. 375.5	EX. 375.67	EX. 374.3
92+35	93+00	94+00	95+00	96+00	97+00	98+00	99+00	100+00	101+00	102+00	103+00	104+00	104+50														

SEP 17, 2013 4:52 PM SCHUB01446
 pw:\sps-sv306\hanson.com\hanson_projects\Documents\12\10078\12A0078D\CAD\Drawings\Sheet\2685-P823.3b

DATE	REVISION

**METROPOLIS MUNICIPAL AIRPORT
 METROPOLIS, ILLINOIS**
 IL PROJ.: M30-4207 S.B.G. PROJ.: 3-17-0067-B10

Hanson Project No.	12A0078
Filename	G-BG-2685-P823.3b
Scale	AS SHOWN
Date	08/02/2013
LAYOUT	JRH 06/18/13
DRAWN	JRH 06/18/13
REVIEWED	JSL 09/04/13

HANSON
 © Copyright Hanson Professional Services Inc. 2013
Hanson Professional Services Inc.
 1525 South Sixth Street
 Springfield, Illinois 62703-2986
 Ph: (217) 788-2450 Fax: (217) 788-2503
 www.hanson-inc.com
 Offices Nationwide

**CONSTRUCT PARTIAL
 PARALLEL TAXIWAY**
 PLAN AND PROFILE TWY
 A-SHEET 1

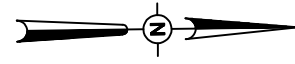

0' 25' 50' 100'
 HALF SIZE SCALE: 1" = 100'
 FULL SIZE SCALE: 1" = 50'

LEGEND
 [Line symbol] EXISTING PAVEMENT
 [Shaded area symbol] PROPOSED IMPROVEMENTS

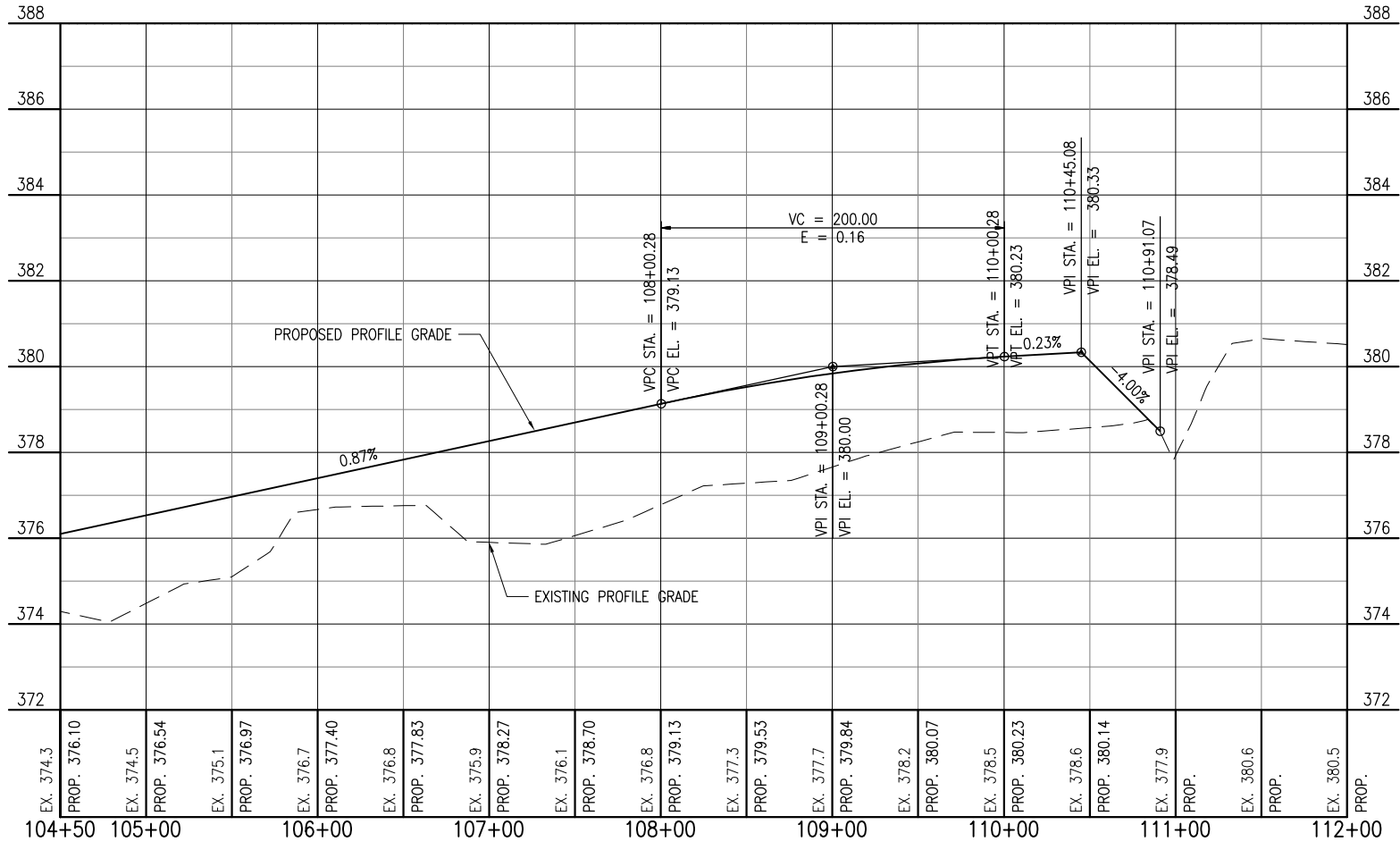
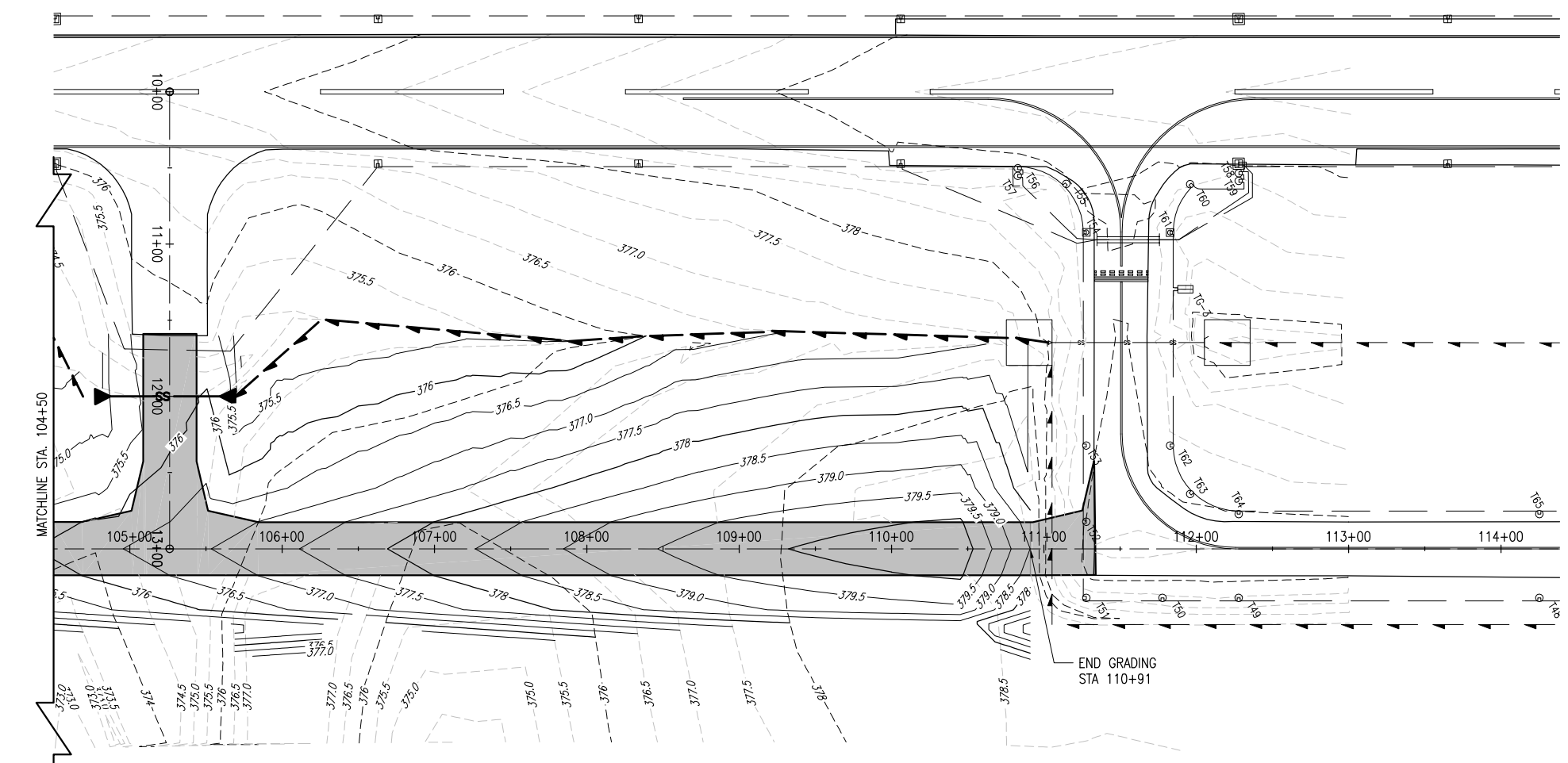

REVISION	DATE

**METROPOLIS MUNICIPAL AIRPORT
 METROPOLIS, ILLINOIS**
 I.L. PROJ.: M30-4207 S.B.G. PROJ.: 3-17-0067-B10

Hanson Project No.	12A0078
Filename	G-BG+2P\MP005.dwg
Scale	AS SHOWN
Date	08/02/2013
LAYOUT	JRH 06/18/13
DRAWN	JRH 06/18/13
REVIEWED	JSL 09/04/13

HANSON
 © Copyright Hanson Professional Services Inc. 2013
Hanson Professional Services Inc.
 1525 South Sixth Street
 Springfield, Illinois 62703-2986
 Ph: (217) 788-2450 Fax: (217) 788-2503
 www.hanson-inc.com
 Offices Nationwide

**CONSTRUCT PARTIAL
 PARALLEL TAXIWAY**
 PLAN AND PROFILE TWY
 A-SHEET 2

SEP 17 2013 4:32 PM SCHUB01446
 pw:\jpi-svr306\hanson.dom\hanson_projects\Documents\120078\12007801\CAD\Drawings\Sheet\6685-42x34b

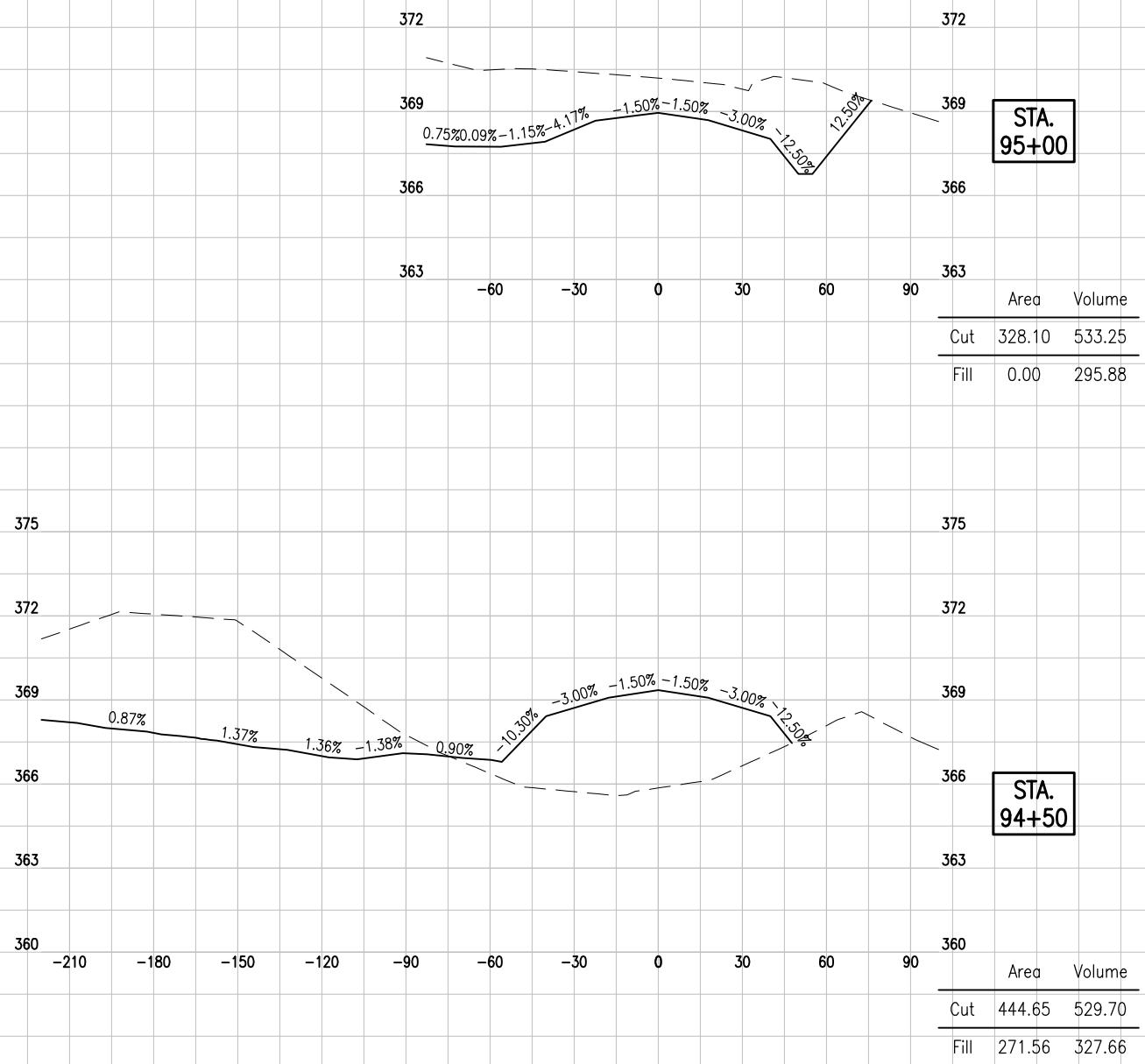
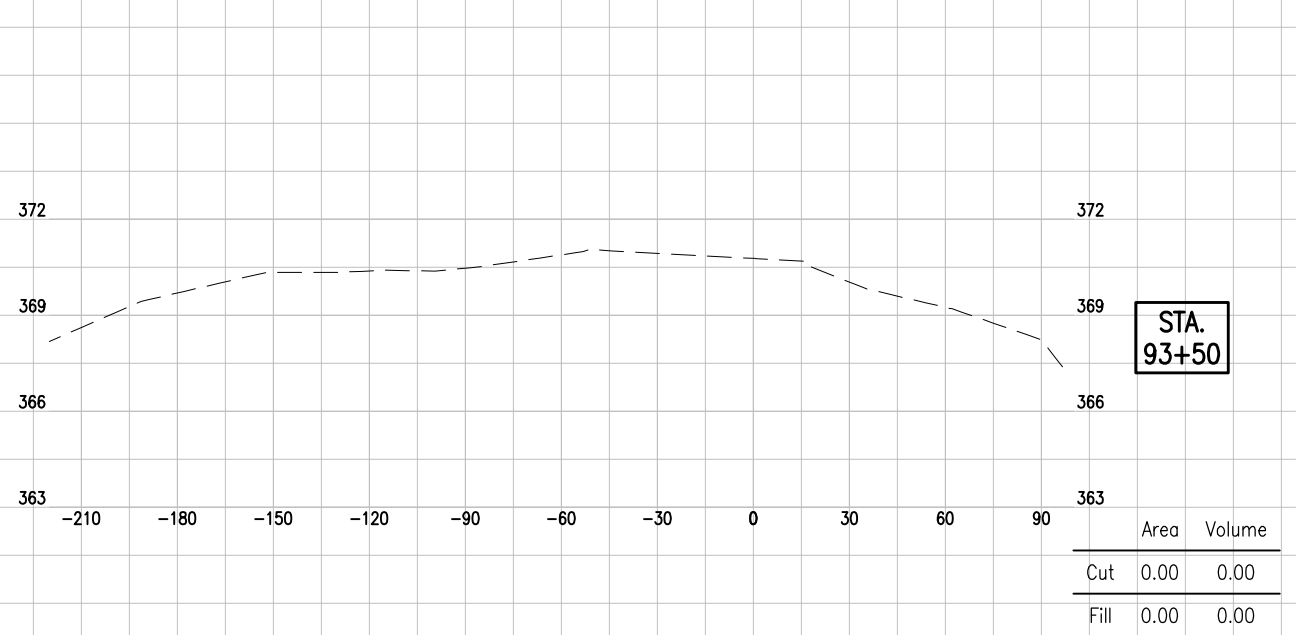
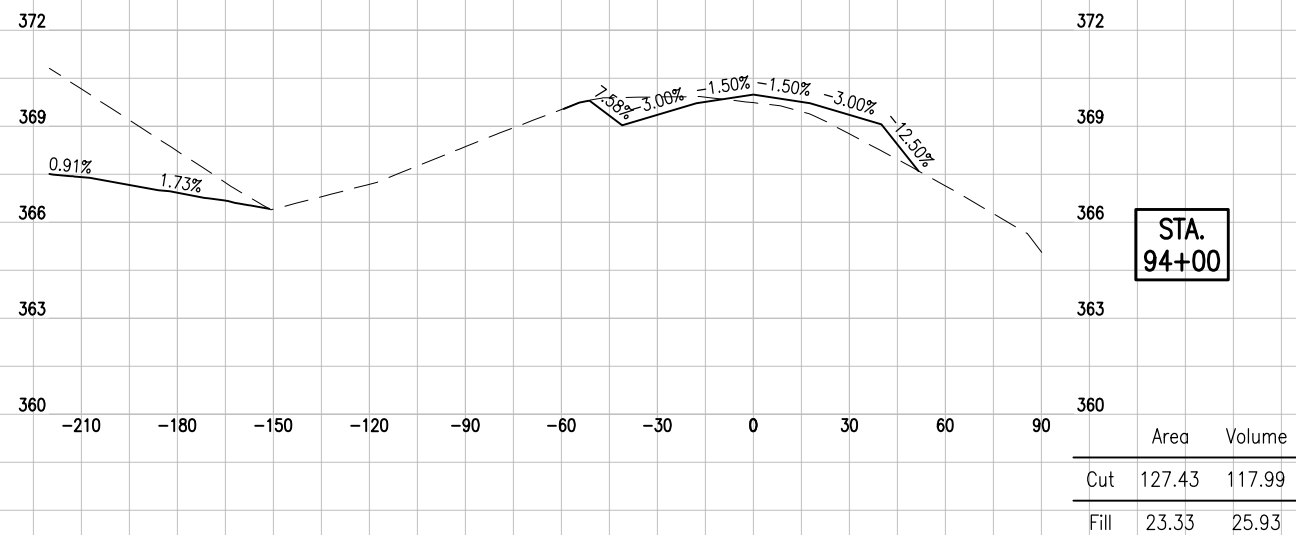

REVISION	DATE

**METROPOLIS MUNICIPAL AIRPORT
 METROPOLIS, ILLINOIS**

IL. PROJ.: M30-4207 S.B.G. PROJ.: 3-17-0067-B10

Hanson Project No.	120078
Filename	G-B1+2x34b.dwg
Scale	NOT TO SCALE
Date	08/02/2013
LAYOUT	JRH 06/20/13
DRAWN	JRH 06/20/13
REVIEWED	JSL 09/04/13

HANSON
 © Copyright Hanson Professional Services Inc. 2013
Hanson Professional Services Inc.
 1525 South Sixth Street
 Springfield, Illinois 62703-2986
 Ph: (217) 788-2450 Fax: (217) 788-2503
 www.hanson-inc.com
 Offices Nationwide

**CONSTRUCT PARTIAL
 PARALLEL TAXIWAY**

CROSS SECTIONS STA.
 93+50 TO 95+00

SEP 17, 2013 4:34 PM SCHUB01446
 pw:\jpi-svc\306\hanson\dom\hanson_projects\Documents\12\jobs\12\120078\12007801\CAD\Drawings\Sheet\6685x22x34b

MP005

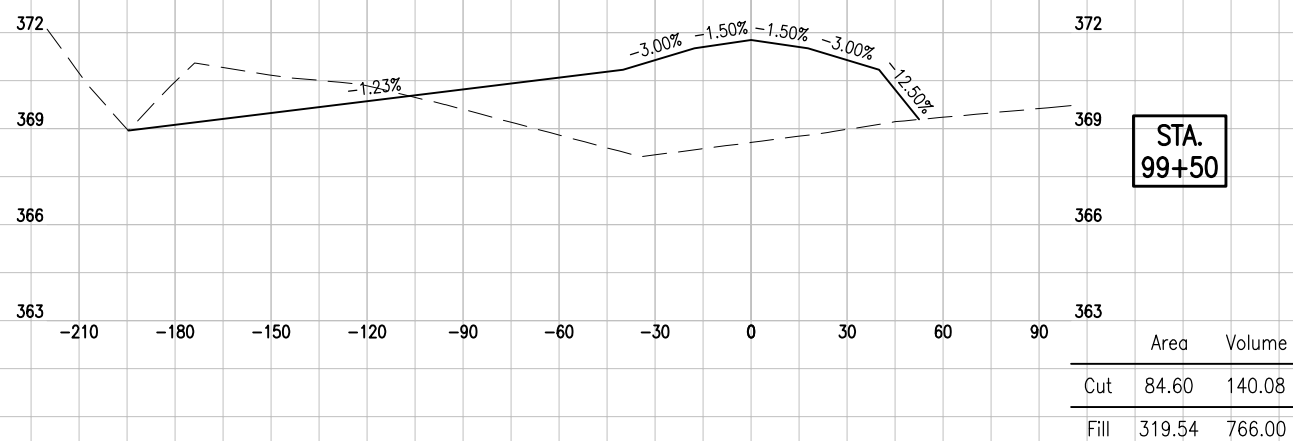
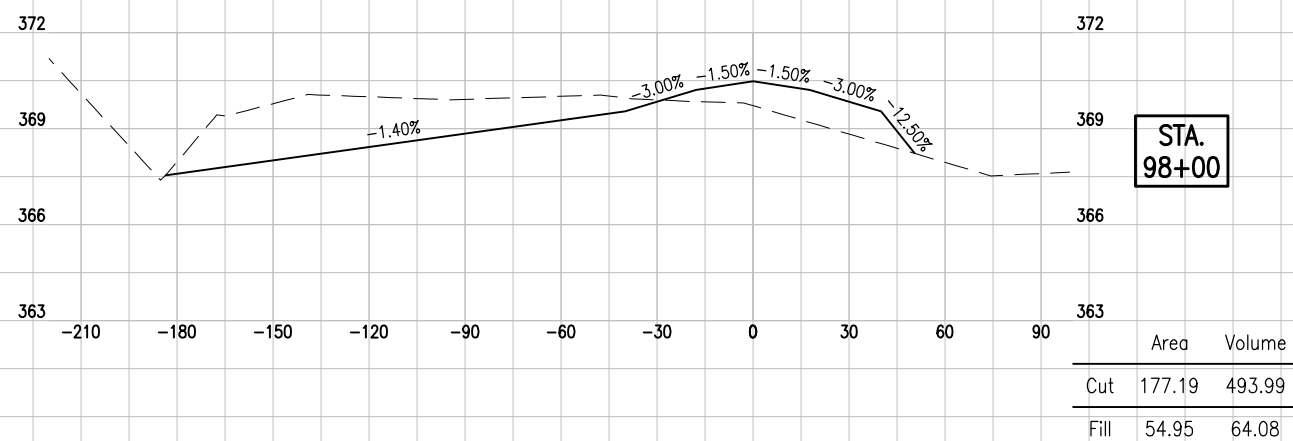
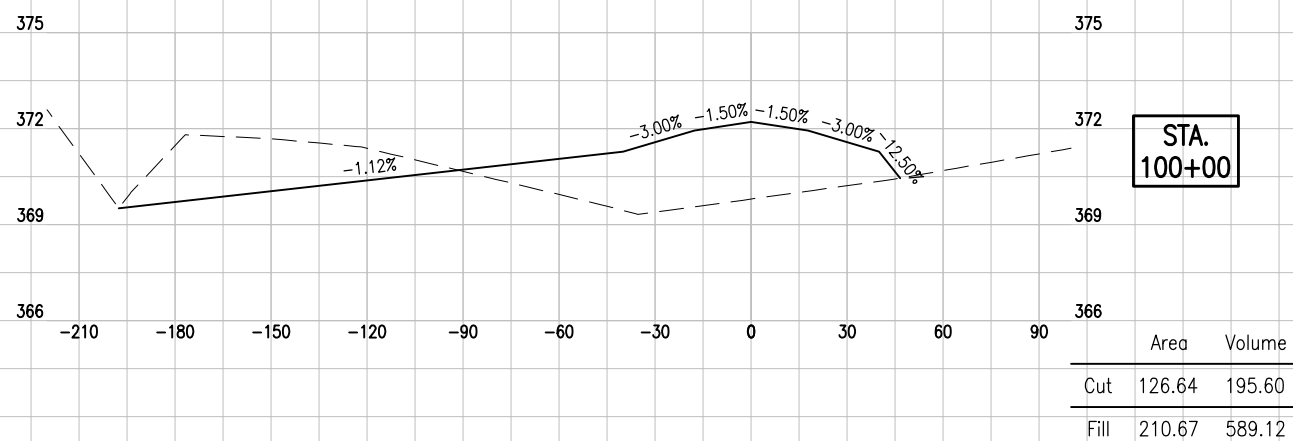
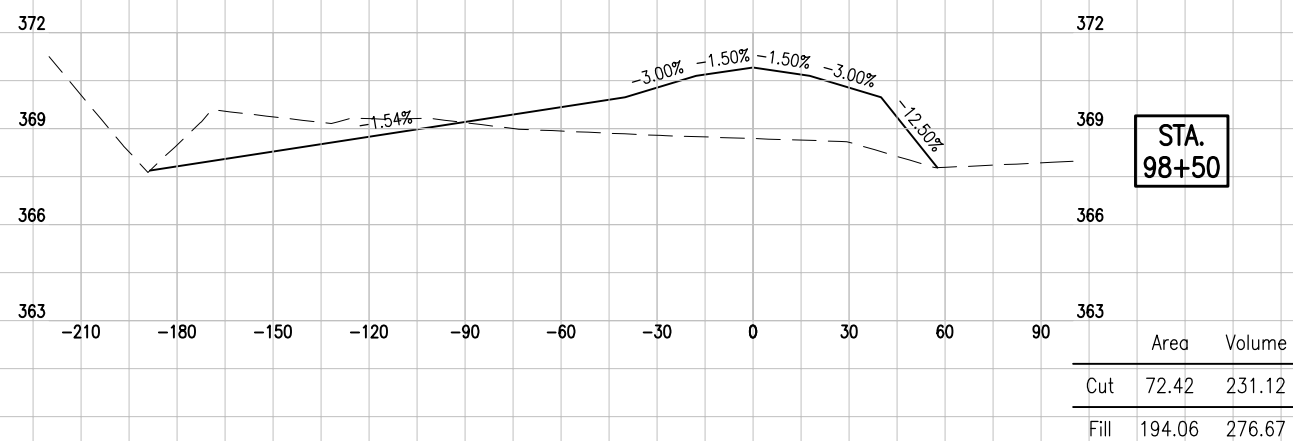
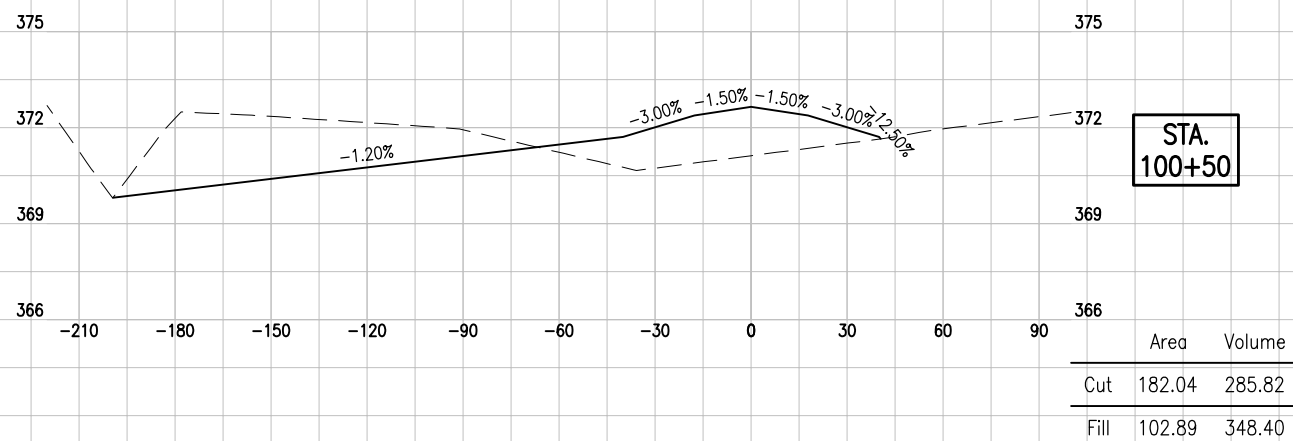
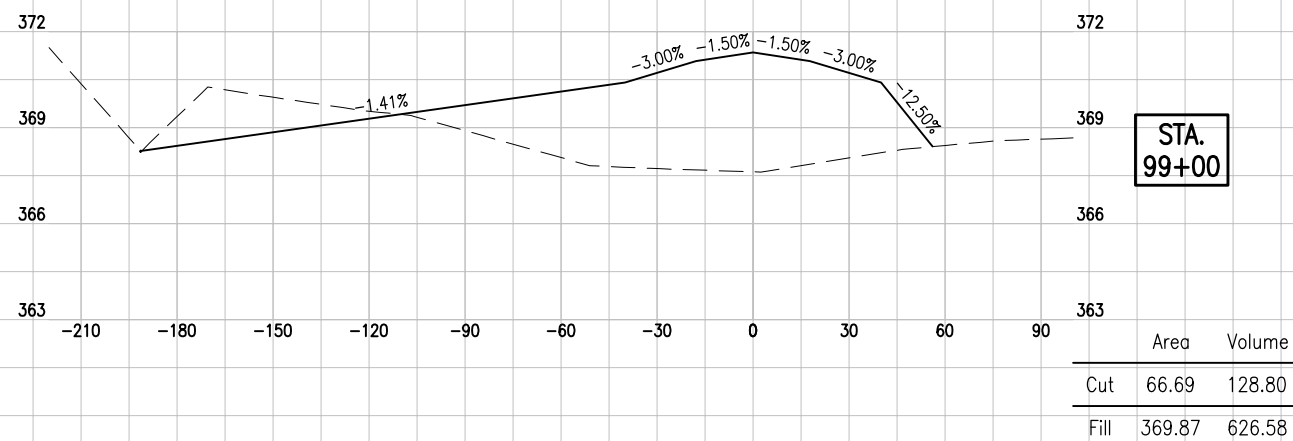

DATE	REVISION

**METROPOLIS MUNICIPAL AIRPORT
 METROPOLIS, ILLINOIS**

IL PROJ.: M30-4207 S.B.G. PROJ.: 3-17-0067-B10

Hanson Project No.	12A0078
Filename	G-B1+28x34b.dwg
Scale	NOT TO SCALE
Date	08/02/2013
LAYOUT	JRH 06/20/13
DRAWN	JRH 06/20/13
REVIEWED	JSL 09/04/13

HANSON
 © Copyright Hanson Professional Services Inc. 2013
Hanson Professional Services Inc.
 1525 South Sixth Street
 Springfield, Illinois 62703-2986
 Ph: (217) 788-2450 Fax: (217) 788-2503
 www.hanson-inc.com
 Offices Nationwide

**CONSTRUCT PARTIAL
 PARALLEL TAXIWAY**

CROSS SECTIONS STA.
 98+00 TO 100+50

SEP 17, 2013 4:36 PM SCHUB01446
 pw:\jpi-sv306\hanson.dom\hanson_projects\Documents\12\jobs\12\A0078\12A0078D\CAD\Drawings\Sheet\26685-2223-34b

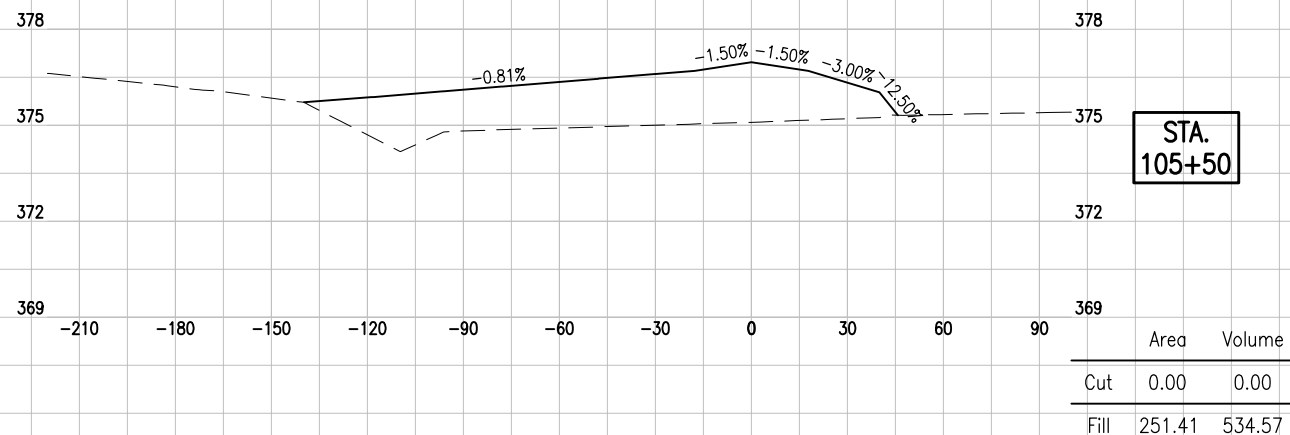
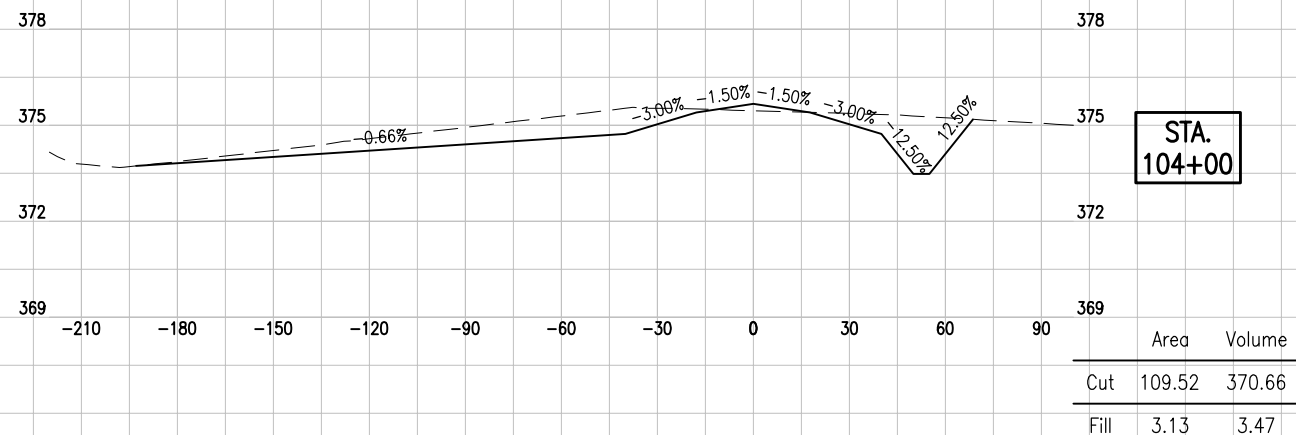
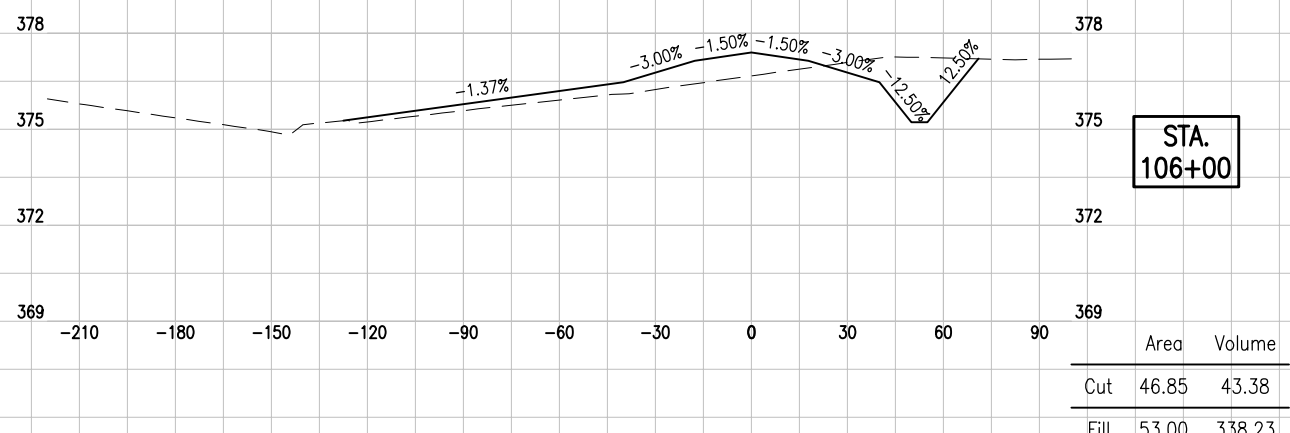
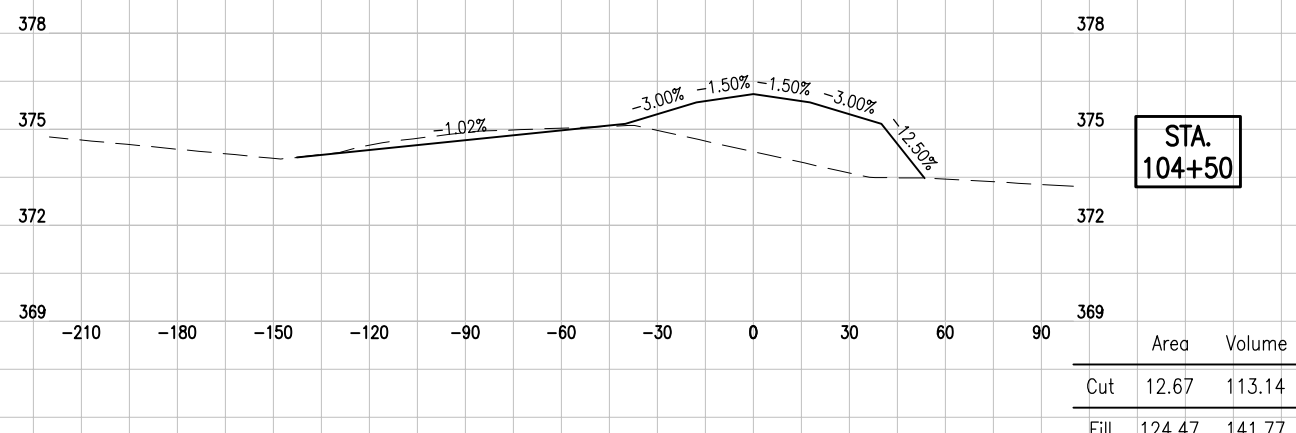
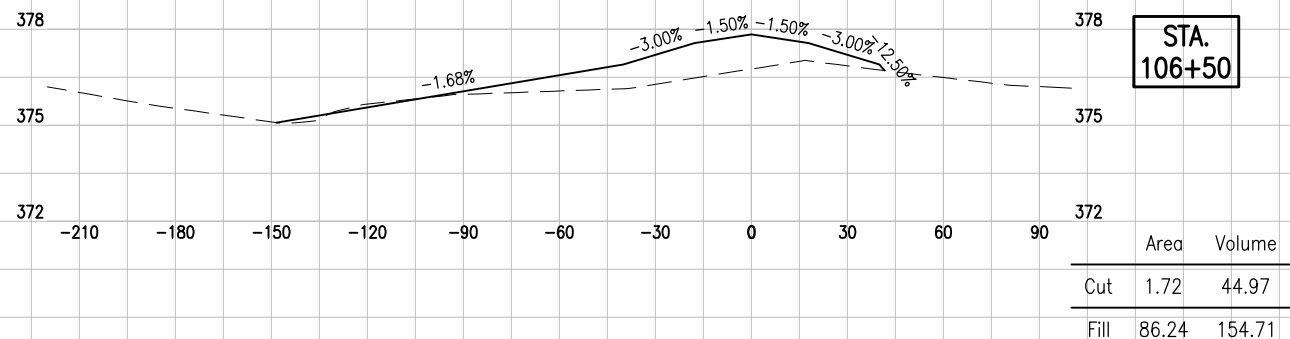
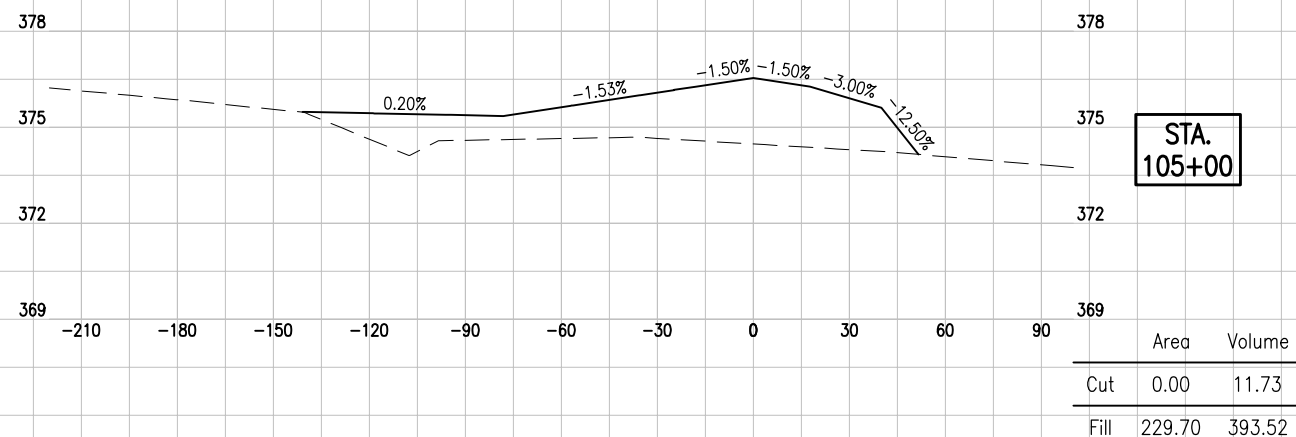

REVISION	DATE

**METROPOLIS MUNICIPAL AIRPORT
 METROPOLIS, ILLINOIS**

IL PROJ. M30-4207 S.B.G. PROJ.: 3-17-0067-B10

Hanson Project No.	12A0078
Filename	G-B1+28x34gwg
Scale	NOT TO SCALE
Date	08/02/2013
LAYOUT	JRH 06/20/13
DRAWN	JRH 06/20/13
REVIEWED	JSL 09/04/13

HANSON
 © Copyright Hanson Professional Services Inc. 2013
 Hanson Professional Services Inc.
 1525 South Sixth Street
 Springfield, Illinois 62703-2986
 Ph: (217) 788-2450 Fax: (217) 788-2503
 www.hanson-inc.com
 Offices Nationwide

**CONSTRUCT PARTIAL
 PARALLEL TAXIWAY**

CROSS SECTIONS STA.
 104+00 TO 106+50

