

GENERAL NOTES

PLAN DIMENSIONS AND DETAILS RELATIVE TO EXISTING PLANS ARE SUBJECT TO NOMINAL CONSTRUCTION VARIATIONS. THE CONTRACTOR SHALL FIELD VERIFY EXISTING DIMENSIONS AND DETAILS AFFECTING NEW CONSTRUCTION AND MAKE NECESSARY APPROVED ADJUSTMENTS PRIOR TO CONSTRUCTION OR ORDERING OF MATERIALS. SUCH VARIATIONS SHALL NOT BE CAUSE FOR ADDITIONAL COMPENSATION FOR A CHANGE IN SCOPE OF WORK; HOWEVER, THE CONTRACTOR WILL BE PAID FOR THE QUANTITY ACTUALLY FURNISHED AT THE UNIT PRICE BID FOR THE WORK.

EXISTING REINFORCEMENT BARS EXTENDING INTO THE REMOVAL AREA SHALL BE CLEANED, STRAIGHTENED AND INCORPORATED INTO THE NEW CONSTRUCTION. ANY REINFORCEMENT BARS THAT ARE DAMAGED DURING CONCRETE REMOVAL OPERATIONS, SHALL BE REPLACED WITH AN APPROVED BAR SPLICER OR ANCHORAGE SYSTEM. COST INCLUDED WITH CONCRETE REMOVAL.

STRAIGHTENED AND INCORPORATED INTO THE NEW CONSTRUCTION. ANY REINFORCEMENT BARS THAT ARE DAMAGED DURING CONCRETE REMOVAL OPERATIONS SHALL BE REPLACED WITH AN APPROVED BAR SPLICER OR ANCHORAGE SYSTEM. COST INCLUDED WITH CONCRETE REMOVAL.

ALL STRUCTURAL STEEL FOR EXPANSIONS JOINTS SHALL BE AASHTO M 270 GRADE 36.

REINFORCEMENT BARS DESIGNATED (E) SHALL BE EPOXY COATED.

PROTECTIVE COAT SHALL BE APPLIED TO ALL NEW CONCRETE SURFACES.

EXISTING NAME PLATES SHALL BE REMOVED, CLEANED AND INCORPORATED INTO THE NEW CONSTRUCTION. COST INCLUDED WITH RELOCATING NAME PLATES.

ANY REFERENCE TO A STANDARD IN THESE PLANS SHALL BE INTERPRETED TO MEAN THE EDITION AS INDICATED BY THE SUBNUMBER SHOWN IN THE LIST OF STANDARDS OR THE COPY INCLUDED IN THESE PLANS.

THE FOLLOWING RATES OF APPLICATION HAVE BEEN USED IN CALCULATING PLAN QUANTITIES:

BITUMINOUS MATERIALS (TACK COAT)	0.05	LBS / SQ FT
BITUMINOUS MATERIALS (FOG COAT)	0.025	LBS / SQ FT
HMA RESURFACING	112	LBS / SQ YD / IN

TOTAL BILL OF MATERIAL FOR TWO STRUCTURES

ITEM	UNIT	SUPER	SUB	TOTAL
REINFORCEMENT BARS, EPOXY COATED	POUND	1240		1240
BAR SPLICER	EACH	16		16
CONCRETE REMOVAL	CU YD	8		8
CONCRETE SUPERSTRUCTURE	CU YD	7.6		7.6
PRECAST PRESTRESSED CONCRETE I-BEAM REPAIR	SQ FT	137		137
FIBER WRAP	SQ FT	667		667
ACRYLIC COATING	SQ YD	1415		1415
PREFORMED JOINT STRIP SEAL	FOOT	142		142
PROTECTIVE COAT	SQ YD	32		32
RELOCATING NAME PLATES	EACH	2		2
BRIDGE DECK SCARIFICATION 3"	SQ YD	1992		1992
BITUMINOUS MATERIALS (TACK COAT)	POUND	1344		1344
POLYMERIZED HOT-MIX ASPHALT BINDER COURSE, IL 9.5, N90	TON	168		168
POLYMERIZED HOT-MIX ASPHALT SURFACE CSE. IL 9.5, MIX D, N90	TON	168		168
REMOVING AND RE-ERECTING EXISTING RAILING	FOOT	240		240
DECK SLAB REPAIR (FULL DEPTH, TYPE I)	SQ YD	25		25
DECK SLAB REPAIR (FULL DEPTH, TYPE II)	SQ YD	25		25

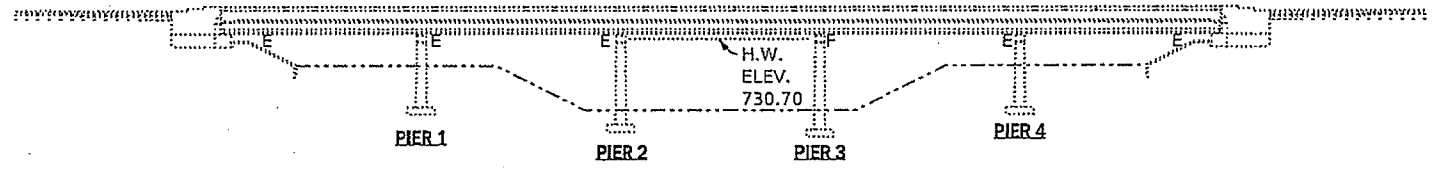

ELEVATION

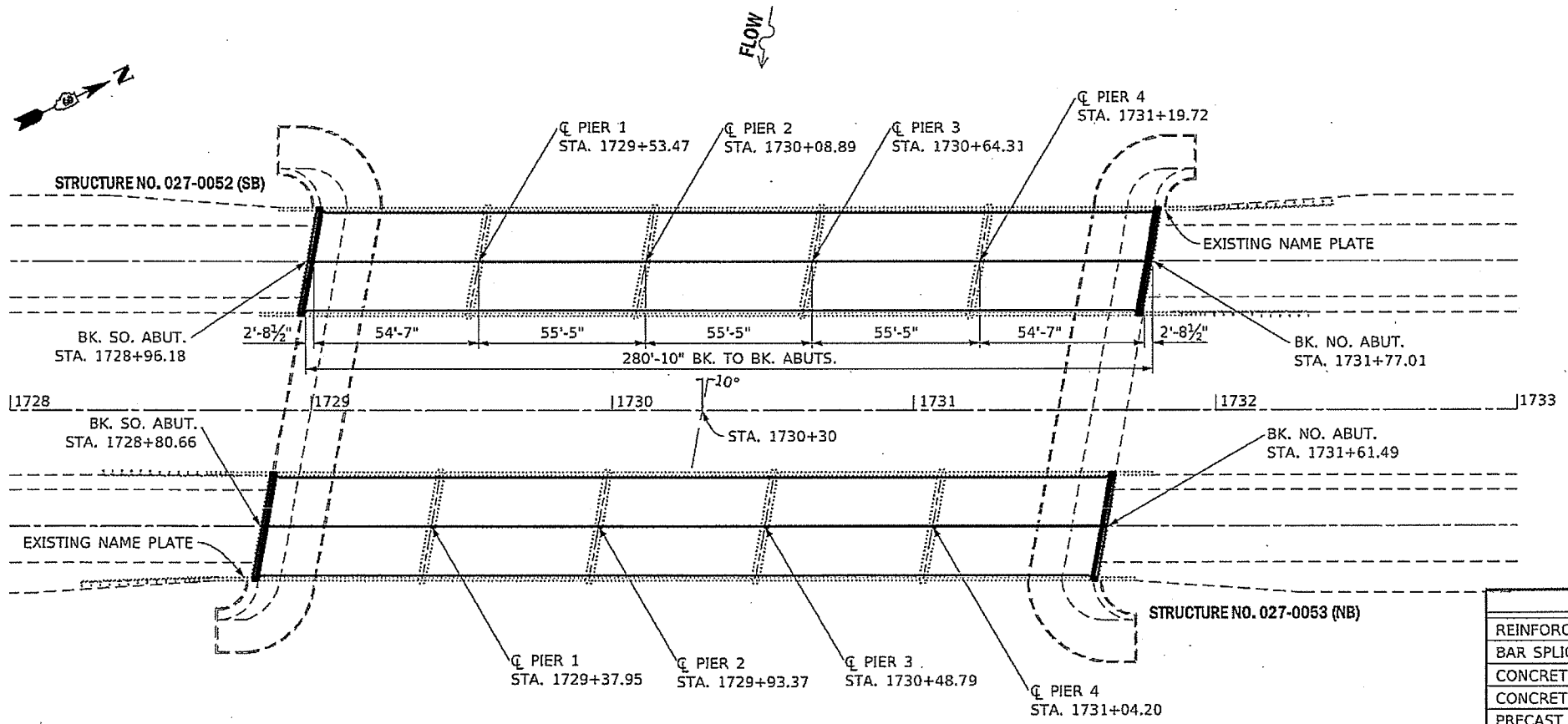

PLAN

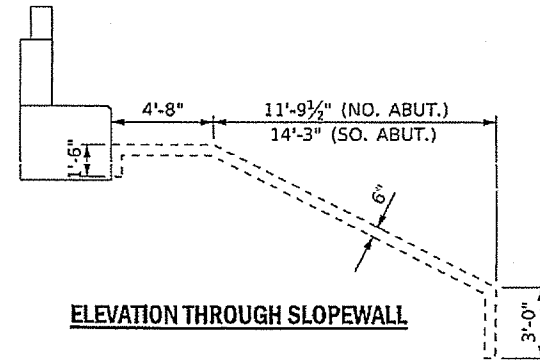

ELEVATION THROUGH SLOEWALL

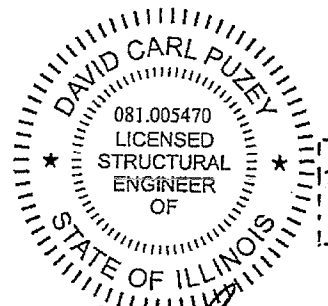

Estimated quantity. Size and location of patch to be determined by the Engineer in the field.

Dr. Carl Puzey 10/1/19
Expires 10/30/20

FILE NAME =	USER NAME = woodshank	DESIGNED - RW	REVISED - RW 6/4/2019
PROJECT ROOM =	PROJECT =	CHECKED - EP	REVISED - VHV 10/1/19
PLOT SCALE = 1/8" = 1'-0"	PLOT DATE = 8/21/2019	DATE = 3/13/2019	REVISED -

STATE OF ILLINOIS
DEPARTMENT OF TRANSPORTATION

EXISTING GENERAL PLAN AND ELEVATION
SN 027-0052 (SB) & SN 027-0053 (NB)

F.A.I. RTE.	SECTION	COUNTY	TOTAL SHEETS	SHEET NO.
57	(27-38)BRR	FORD	26	11
CONTRACT NO. 66K27				