

STATE OF ILLINOIS
DEPARTMENT OF TRANSPORTATION

F.A.P. RTE.	SECTION	COUNTY	TOTAL SHEETS	SHEET NO.
853		FRANKLIN	17	1
		ILLINOIS	CONTRACT NO. 78A88	

* D9 WETLAND MAINTENANCE 2024-1

D-99-068-24

FOR INDEX OF SHEETS, SEE SHEET NO. 3

PROPOSED HIGHWAY PLANS

TOWNSHIP
NORTHERN

FAP ROUTE 853 (IL 14)
SECTION D9 WETLAND MAINTENANCE 2024-1
SUGAR CAMP CREEK WETLAND MITIGATION SITE
FRANKLIN COUNTY



LOCATION OF SECTION INDICATED THUS: - ■ -

C-99-117-24

COORDINATE SYSTEM
EPSG: 102671 - NAD 1983
State Plane Illinois East FIPS 1201

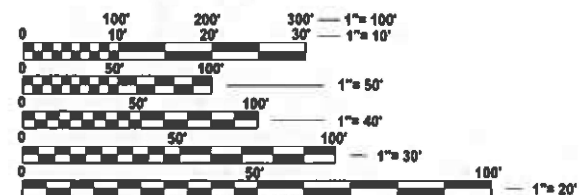

FULL SIZE PLANS HAVE BEEN PREPARED USING STANDARD ENGINEERING SCALES. REDUCED SIZED PLANS WILL NOT CONFORM TO STANDARD SCALES. IN MAKING MEASUREMENTS ON REDUCED PLANS, THE ABOVE SCALES MAY BE USED.

J.U.L.I.E.
JOINT UTILITY LOCATION INFORMATION FOR EXCAVATION
1-800-892-0123
OR 811

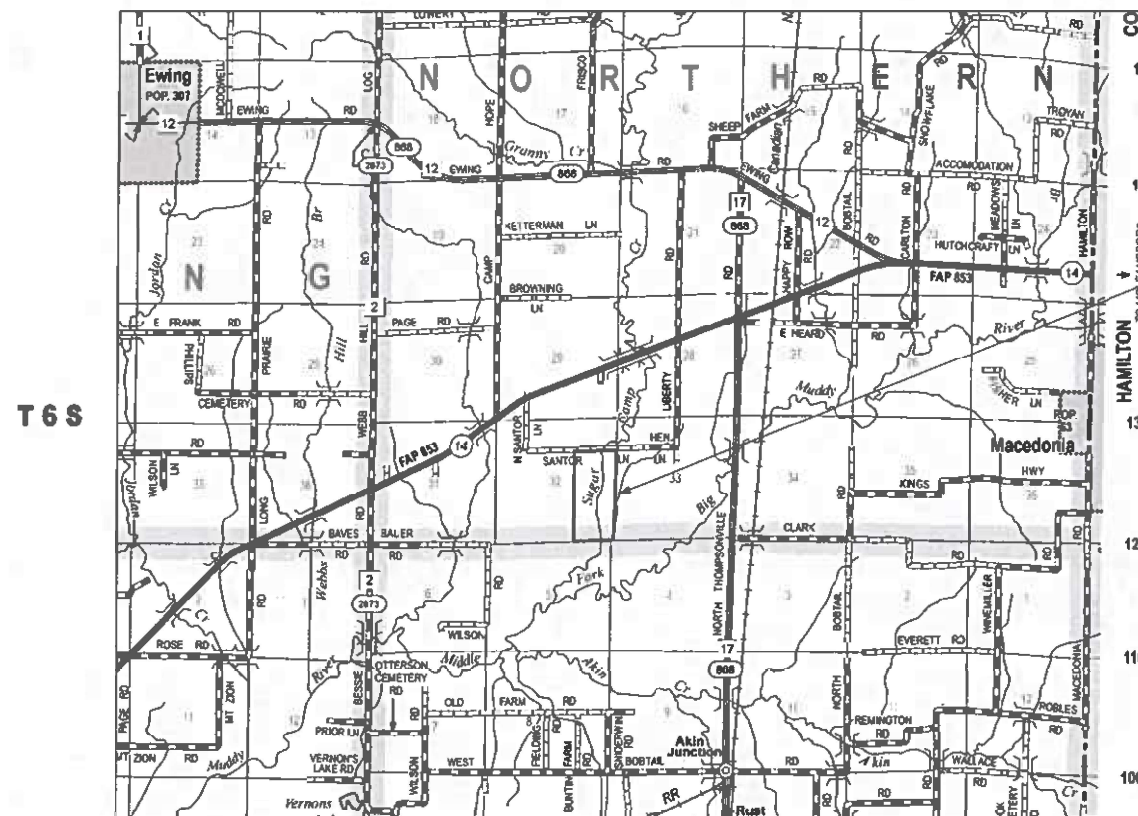

PROJECT LOCATION
SE 1/4 OF THE NE 1/4 OF SECTION 32
AND THE EAST 1/2 OF THE SE 1/4
OF SECTION 32

PROJECT ENGINEER NATHAN TAYLOR

CONTRACT NO. 78A88

SIZE OF PROJECT AREA: 126 AC +/-

STATE OF ILLINOIS
DEPARTMENT OF TRANSPORTATION

SUBMITTED August 23 20 24
Kirk H. Brown REGIONAL ENGINEER

October 4, 2024
[Signature] ENGINEER OF DESIGN AND ENVIRONMENT

October 4, 2024
[Signature] DIRECTOR OF HIGHWAYS PROJECT IMPLEMENTATION 13

PRINTED BY THE AUTHORITY
OF THE STATE OF ILLINOIS

MODEL Signature Sheet - [Sheet]
FILE NAME: C:\low\work\mains\mains\1000898\0578A88-ShA-Cover_Sig.dgn

USER NAME	= Nathan.Taylor	DESIGNED	-	REVISED	-
		DRAWN	-	REVISED	-
		CHECKED	-	REVISED	-
PLOT DATE	= 8/19/2024	DATE	-	REVISED	-

**STATE OF ILLINOIS
DEPARTMENT OF TRANSPORTATION**

SIGNATURE SHEET

SCALE: SHEET OF 17 SHEETS STA. TO STA.

F.A.P RTE	SECTION	COUNTY	TOTAL SHEETS	SHEET NO.
853		FRANKLIN	17	2
ILLINOIS FED. AID PROJECT CONTRACT NO. 78A88				

* D9 WETLAND MAINTENANCE 2024-1

Prepared By: *Susan Re*
DISTRICT STUDIES & PLANS ENGINEER

Examined By: *Nancy Lee*
DISTRICT LAND ACQUISITION ENGINEER

Examined By: *Carly Nelson*
DISTRICT PROGRAM DEVELOPMENT ENGINEER

Examined By: *[Signature]*
DISTRICT OPERATIONS ENGINEER

Examined By: *Daphne [Signature]*
DISTRICT PROJECT IMPLEMENTATION ENGINEER

Examined By: *Brian [Signature]*
DISTRICT CONSTRUCTION ENGINEER

Examined By: *Aam [Signature]*
DISTRICT MATERIALS ENGINEER

GENERAL NOTES

1 TREES SHALL BE PRESERVED THROUGHOUT THE SITE AS DIRECTED BY THE ENGINEER. THE CONTRACTOR SHALL NOTIFY THE ENGINEER 21 DAYS IN ADVANCE OF MOWING AND WEED SPRAYING OPERATIONS.

2 **COMMITMENTS:** NONE

INDEX OF SHEETS

SHEET NO	DESCRIPTION
1	COVER SHEET
2	SIGNATURE SHEET
3	INDEX OF SHEETS, HIGHWAY STANDARDS, GENERAL NOTES, LIST OF COMMITMENTS
4	SUMMARY OF QUANTITIES
5-8	SCHEDULE OF QUANTITIES
9-17	PLAN SHEETS

HIGHWAY STANDARDS

000001-08 STANDARD SYMBOLS, ABBREVIATIONS AND PATTERNS
 001006 DECIMAL OF AN INCH AND OF A FOOT
 701001-02 OFF-ROAD OPERATIONS, 2L, 2W, MORE THAN 15 FT AWAY

REV - MS

MODEL: Index of Sheets [Sheet]
 FILE NAME: c:\pw\work\pwr\stcl\stcl\comd\1000888\09\00000-SHB-Index_GenNotes.dgn

USER NAME = Nathan.Taylor	DESIGNED -	REVISED -	STATE OF ILLINOIS DEPARTMENT OF TRANSPORTATION	INDEX OF SHEETS, HIGHWAY STANDARDS, GENERAL NOTES, LIST OF COMMITMENTS	F.A.P. RTE.	SECTION	COUNTY	TOTAL SHEETS	SHEET NO.	
	DRAWN -	REVISED -			853	*	FRANKLIN	17	3	
	CHECKED -	REVISED -			CONTRACT NO. 78A88					
PLOT DATE = 8/20/2024	DATE -	REVISED -			SCALE:	SHEET OF 17 SHEETS	STA. TO STA.	ILLINOIS FED. AID PROJECT		

* D9 WETLAND MAINTENANCE 2024-1

SUMMARY OF QUANTITIES

COUNTY:	FRANKLIN CO
ROUTE:	FAP 853
FUNDING:	100% STATE
LOCATION:	RURAL
TOTAL QUANTITY	ROADWAY 0044

CODE NUMBER	ITEM DESCRIPTION	UNIT	TOTAL QUANTITY	ROADWAY 0044
25000750	MOWING	ACRE	69.5	69.5
67100100	MOBILIZATION	L SUM	1	1
K0012950	HERBICIDE SPRAYING	ACRE	23.4	23.4
K0029632	WEED CONTROL, NON-SELECTIVE AND NON-RESIDUAL	GALLON	63.6	63.6
X2503318	INTERSEEDING, CLASS 4B (MODIFIED)	ACRE	69.5	69.5

MODEL: SQQ (Sheet)
 FILE NAME: c:\pw\work\pw\franklin\franklin\1000888\078A88-ShtC-SQO.dgn

REV - MS

USER NAME = Nathan.Taylor	DESIGNED -	REVISED -	STATE OF ILLINOIS DEPARTMENT OF TRANSPORTATION	SUMMARY OF QUANTITIES	F.A.P. RTE.	SECTION	COUNTY	TOTAL SHEETS	SHEET NO.	
	DRAWN -	REVISED -			853	*	FRANKLIN	17	4	
	CHECKED -	REVISED -			CONTRACT NO. 78A88					
PLOT DATE = 8/18/2024	DATE -	REVISED -			SCALE:	SHEET	OF 17 SHEETS	STA.	TO STA.	ILLINOIS FED. AID PROJECT

* D9 WETLAND MAINTENANCE 2024-1

HERBICIDE AND SEEDING SCHEDULE

SECTION	PHRAGMITES AREA NUMBER	ESTIMATED ACRES (FOR INFORMATION ONLY)	WEED CONTROL, NON-SELECTIVE AND NON RESIDUAL	MOWING	INTERSEEDING, CLASS 4B (MODIFIED)
			GALLON	ACRE	ACRE
EAST OF CREEK	0	0.09	0.2	0.1	0.1
EAST OF CREEK	1	2.96	3.7	3.0	3
EAST OF CREEK	2	0.12	0.2	0.2	0.2
EAST OF CREEK	3	0.14	0.2	0.2	0.2
EAST OF CREEK	4	1.27	1.6	1.3	1.3
EAST OF CREEK	5	0.70	0.9	0.7	0.7
EAST OF CREEK	6	0.03	0.1	0.1	0.1
EAST OF CREEK	7	0.01	0.1	0.1	0.1
EAST OF CREEK	8	0.01	0.1	0.1	0.1
EAST OF CREEK	9	0.01	0.1	0.1	0.1
EAST OF CREEK	10	0.03	0.1	0.1	0.1
EAST OF CREEK	11	0.17	0.3	0.2	0.2
EAST OF CREEK	12	0.00	0.1	0.1	0.1
EAST OF CREEK	13	0.05	0.1	0.1	0.1
EAST OF CREEK	14	0.02	0.1	0.1	0.1
EAST OF CREEK	15	0.00	0.1	0.1	0.1
EAST OF CREEK	16	0.07	0.1	0.1	0.1
EAST OF CREEK	17	0.11	0.2	0.2	0.2
EAST OF CREEK	18	0.02	0.1	0.1	0.1
EAST OF CREEK	19	0.67	0.9	0.7	0.7
EAST OF CREEK	20	0.15	0.2	0.2	0.2
EAST OF CREEK	21	0.40	0.6	0.5	0.5
EAST OF CREEK	22	0.46	0.6	0.5	0.5
SUBTOTAL			10.7	8.9	8.9

MODEL: Schedule of Quantities-1 (Sheet)
FILE NAME: c:\p\work\wetland\taylor\mcd1000888\078A88-SHE-Schedules.dgn

USER NAME = Nathan.Taylor	DESIGNED -	REVISED -	STATE OF ILLINOIS DEPARTMENT OF TRANSPORTATION	SCHEDULE OF QUANTITIES				F.A.P RTE.	SECTION	COUNTY	TOTAL SHEETS	SHEET NO.	
	DRAWN -	REVISED -		SCALE:	SHEET	OF 17	SHEETS	STA.	TO STA.	*	FRANKLIN	17	5
	CHECKED -	REVISED -		CONTRACT NO. 78A88									
PLOT DATE = 8/18/2024	DATE -	REVISED -		ILLINOIS FED. AID PROJECT									

HERBICIDE AND SEEDING SCHEDULE

SECTION	PHRAGMITES AREA NUMBER	ESTIMATED ACRES (FOR INFORMATION ONLY)	WEED CONTROL, NON-SELECTIVE AND NON RESIDUAL	MOWING	INTERSEEDING, CLASS 4B (MODIFIED)
			GALLON	ACRE	ACRE
WEST OF CREEK	0	0.06	0.1	0.1	0.1
WEST OF CREEK	1	0.83	1.1	0.9	0.9
WEST OF CREEK	2	0.07	0.1	0.1	0.1
WEST OF CREEK	3	0.01	0.1	0.1	0.1
WEST OF CREEK	4	0.16	0.2	0.2	0.2
WEST OF CREEK	5	0.20	0.3	0.3	0.3
WEST OF CREEK	6	0.07	0.1	0.1	0.1
WEST OF CREEK	7	0.89	1.2	0.9	0.9
WEST OF CREEK	8	0.02	0.1	0.1	0.1
WEST OF CREEK	9	0.07	0.1	0.1	0.1
WEST OF CREEK	10	0.15	0.2	0.2	0.2
WEST OF CREEK	11	0.04	0.1	0.1	0.1
WEST OF CREEK	12	0.05	0.1	0.1	0.1
WEST OF CREEK	13	0.04	0.1	0.1	0.1
WEST OF CREEK	14	0.00	0.1	0.1	0.1
WEST OF CREEK	15	0.03	0.1	0.1	0.1
WEST OF CREEK	16	0.07	0.1	0.1	0.1
WEST OF CREEK	17	0.03	0.1	0.1	0.1
WEST OF CREEK	18	0.01	0.1	0.1	0.1
WEST OF CREEK	19	0.04	0.1	0.1	0.1
WEST OF CREEK	20	0.02	0.1	0.1	0.1
WEST OF CREEK	21	0.02	0.1	0.1	0.1
WEST OF CREEK	22	1.25	1.6	1.3	1.3
		SUBTOTAL	6.3	5.5	5.5

MODEL: Schedule of Quantities-2 (Sheet)
FILE NAME: c:\p\work\wetland\taylor\mcd1000888\078A88-SHE-Schedules.dgn

USER NAME = Nathan.Taylor	DESIGNED -	REVISED -	STATE OF ILLINOIS DEPARTMENT OF TRANSPORTATION	SCHEDULE OF QUANTITIES				F.A.P RTE.	SECTION	COUNTY	TOTAL SHEETS	SHEET NO.
	DRAWN -	REVISED -						853	*	FRANKLIN	17	6
	CHECKED -	REVISED -						CONTRACT NO. 78A88				
PLOT DATE = 8/18/2024	DATE -	REVISED -						SCALE:	SHEET	OF 17 SHEETS	STA.	TO STA.

HERBICIDE AND SEEDING SCHEDULE

SECTION	PHRAGMITES AREA NUMBER	ESTIMATED ACRES (FOR INFORMATION ONLY)	WEED CONTROL, NON-SELECTIVE AND NON	MOWING	INTERSEEDING, CLASS 4B (MODIFIED)
			RESIDUAL	ACRE	ACRE
			GALLON		
WEST OF CREEK	23	0.03	0.1	0.1	0.1
WEST OF CREEK	24	0.05	0.1	0.1	0.1
WEST OF CREEK	25	0.03	0.1	0.1	0.1
WEST OF CREEK	26	0.09	0.2	0.1	0.1
WEST OF CREEK	27	0.02	0.1	0.1	0.1
WEST OF CREEK	28	0.02	0.1	0.1	0.1
WEST OF CREEK	29	0.10	0.2	0.1	0.1
WEST OF CREEK	30	0.02	0.1	0.1	0.1
WEST OF CREEK	31	0.00	0.1	0.1	0.1
WEST OF CREEK	32	0.00	0.1	0.1	0.1
WEST OF CREEK	33	0.07	0.1	0.1	0.1
WEST OF CREEK	34	0.19	0.3	0.2	0.2
WEST OF CREEK	35	0.24	0.4	0.3	0.3
WEST OF CREEK	36	0.06	0.1	0.1	0.1
WEST OF CREEK	37	0.01	0.1	0.1	0.1
WEST OF CREEK	38	0.02	0.1	0.1	0.1
WEST OF CREEK	39	0.04	0.1	0.1	0.1
WEST OF CREEK	40	0.29	0.4	0.3	0.3
WEST OF CREEK	41	0.42	0.6	0.5	0.5
WEST OF CREEK	42	0.01	0.1	0.1	0.1
WEST OF CREEK	43	0.08	0.2	0.1	0.1
WEST OF CREEK	44	0.01	0.1	0.1	0.1
WEST OF CREEK	45	0.07	0.1	0.1	0.1
WEST OF CREEK	46	0.17	0.3	0.2	0.2
		SUBTOTAL	4.2	3.4	3.4
		YEARLY TOTAL	21.2	17.8	17.8
		TOTAL	63.6	53.4	53.4

MODEL: Schedule of Quantities-3 (Sheet)
FILE NAME: c:\p\work\wetland\taylor\mcd1000888\078A88-SHE-Schedule.dgn

USER NAME = Nathan.Taylor	DESIGNED -	REVISED -	STATE OF ILLINOIS DEPARTMENT OF TRANSPORTATION	SCHEDULE OF QUANTITIES				F.A.P RTE.	SECTION	COUNTY	TOTAL SHEETS	SHEET NO.	
	DRAWN -	REVISED -		SCALE:	SHEET	OF 17	SHEETS	STA.	TO STA.	*	FRANKLIN	17	7
	CHECKED -	REVISED -		CONTRACT NO. 78A88									
PLOT DATE = 8/18/2024	DATE -	REVISED -		ILLINOIS FED. AID PROJECT									

HERBICIDE SCHEDULE

SECTION	LESPEDEZA AREA NUMBER	ESTIMATED ACRES (FOR INFORMATION ONLY)	HERBICIDE SPRAYING
			ACRE
WEST OF CREEK	1	5.50	5.5
WEST OF CREEK	2	2.29	2.29
WEST OF CREEK	3	3.91	3.91
YEARLY SUBTOTAL			11.7
TOTAL			23.4

SEEDING SCHEDULE

SECTION	ESTIMATED ACRES (FOR INFORMATION ONLY)	INTERSEEDING, CLASS 4B (MODIFIED)	MOWING
		ACRE	ACRE
EMERGENT WETLAND AREA 1	1.99	1.99	1.99
EMERGENT WETLAND AREA 2	1.37	1.37	1.37
EMERGENT WETLAND AREA 3	0.50	0.5	0.5
EMERGENT WETLAND AREA 4	11.40	11.4	11.4
EMERGENT WETLAND AREA 5	0.80	0.8	0.8
TOTAL		16.1	16.1

MODEL: Schedule of Quantities-4 (Sheet)
FILE NAME: c:\p\work\wlad\atl\mcd\1008888\888\78A88-SHE-Schedules.dgn

USER NAME = Nathan.Taylor	DESIGNED -	REVISED -	STATE OF ILLINOIS DEPARTMENT OF TRANSPORTATION	SCHEDULE OF QUANTITIES	F.A.P. RTE.	SECTION	COUNTY	TOTAL SHEETS	SHEET NO.	
	DRAWN -	REVISED -			853	*	FRANKLIN	17	8	
	CHECKED -	REVISED -			CONTRACT NO. 78A88					
PLOT DATE = 8/18/2024	DATE -	REVISED -			SCALE:	SHEET OF 17 SHEETS	STA. TO STA.	ILLINOIS FED. AID PROJECT		

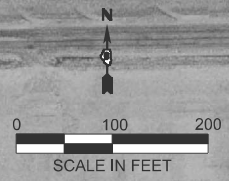

MODEL: Lespedeza [Sheet]
 FILE NAME: c:\p\work\pwr\to\l\m\m\1000898\078A88-Plans.dgn

USER NAME = Nathan.Taylor	DESIGNED -	REVISED -
	DRAWN -	REVISED -
	CHECKED -	REVISED -
PLOT DATE = 8/19/2024	DATE -	REVISED -

**STATE OF ILLINOIS
 DEPARTMENT OF TRANSPORTATION**

LESPEDEZA CUNEATA PLAN VIEW

F.A.P. RTE.	SECTION	COUNTY	TOTAL SHEETS	SHEET NO.
853	*	FRANKLIN	17	9
CONTRACT NO. 78A88				

SCALE: SHEET OF 17 SHEETS STA. TO STA.



0 100 200
SCALE IN FEET



AREA 3

MODEL: Lespedeza-2 (Sheet)
FILE NAME: c:\p\work\wvictor\taylor\mcd1000898\078A88-Plans.dgn

USER NAME = Nathan.Taylor	DESIGNED -	REVISED -
	DRAWN -	REVISED -
	CHECKED -	REVISED -
PLOT DATE = 8/19/2024	DATE -	REVISED -

**STATE OF ILLINOIS
DEPARTMENT OF TRANSPORTATION**

LESPEDEZA CUNEATA PLAN VIEW

SCALE: SHEET OF 17 SHEETS STA. TO STA.

F.A.P. RTE.	SECTION	COUNTY	TOTAL SHEETS	SHEET NO.
853	*	FRANKLIN	17	10
CONTRACT NO. 78A88				

ILLINOIS FED. AID PROJECT
* D9 WETLAND MAINTENANCE 2024-1

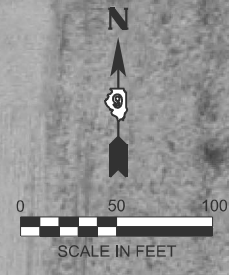

MODEL: Sheet1 [Sheet]
FILE NAME: c:\p\work\wv\td\11\mxd\1000898\0778A88-Plans.dgn

USER NAME = Nathan.Taylor	DESIGNED -	REVISED -
	DRAWN -	REVISED -
	CHECKED -	REVISED -
PLOT DATE = 8/19/2024	DATE -	REVISED -

**STATE OF ILLINOIS
DEPARTMENT OF TRANSPORTATION**

PHRAGMITES PLAN VIEW

SCALE: SHEET OF 17 SHEETS STA. TO STA.

F.A.P. RTE. 853	SECTION *	COUNTY FRANKLIN	TOTAL SHEETS 17	SHEET NO. 11
CONTRACT NO. 78A88				

ILLINOIS FED. AID PROJECT
* D9 WETLAND MAINTENANCE 2024-1



MODEL: Sheet2 [Sheet]
 FILE NAME: c:\p\work\wv\franklin\taylor\mxd\10008988\d978A88-Plans.dgn

USER NAME = Nathan.Taylor	DESIGNED -	REVISED -
	DRAWN -	REVISED -
	CHECKED -	REVISED -
PLOT DATE = 8/19/2024	DATE -	REVISED -

**STATE OF ILLINOIS
DEPARTMENT OF TRANSPORTATION**

PHRAGMITES PLAN VIEW

SCALE: SHEET OF 17 SHEETS STA. TO STA.

F.A.P. RTE.	SECTION	COUNTY	TOTAL SHEETS	SHEET NO.
853	*	FRANKLIN	17	12
CONTRACT NO. 78A88				
ILLINOIS FED. AID PROJECT				

MODEL: I:\unfiled-2 [Sheet]
 FILE NAME: c:\p\work\wv\wv\wv\mxd\10008989\078A89-Plans.dgn

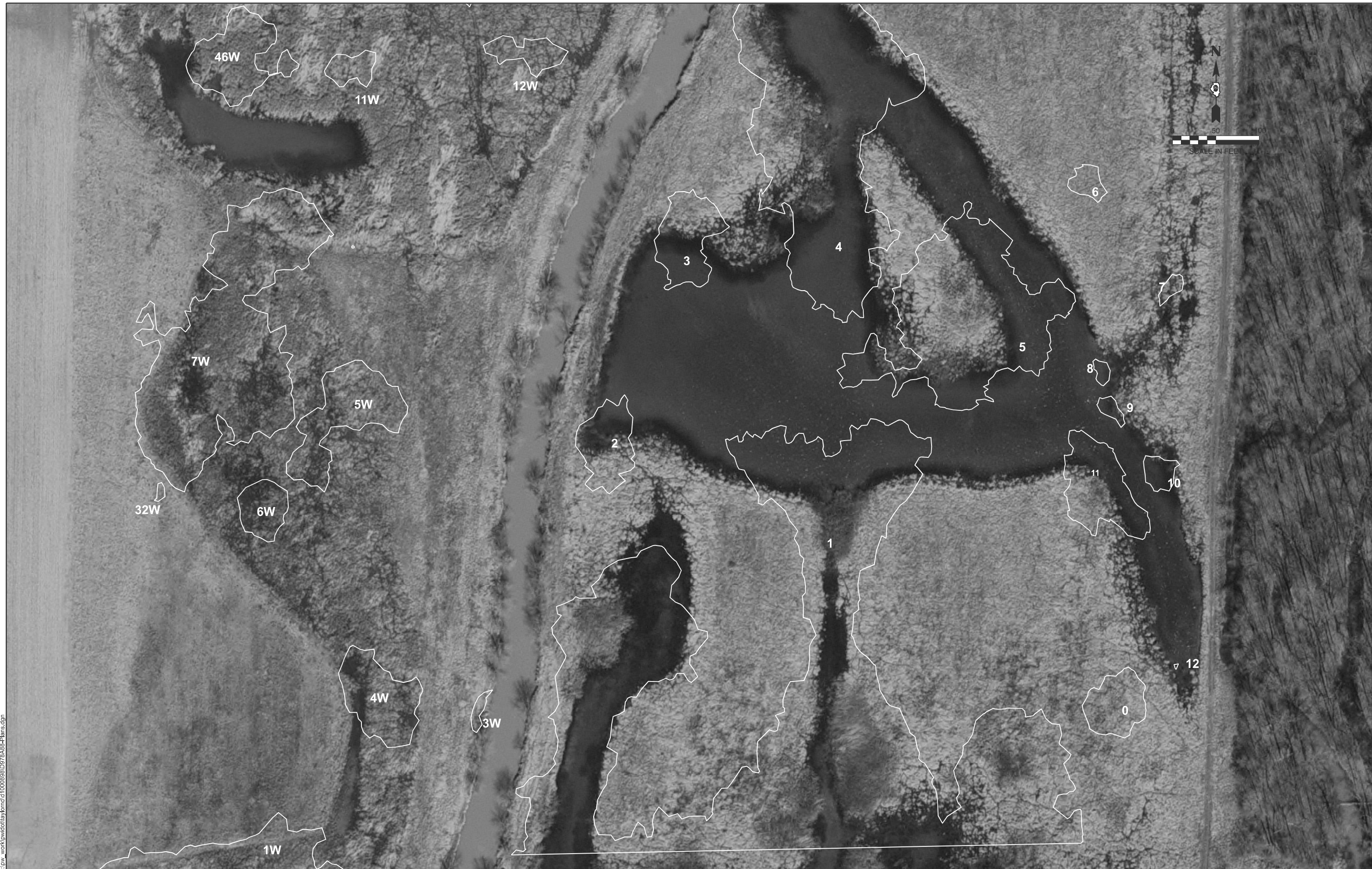

USER NAME = Nathan.Taylor	DESIGNED -	REVISED -
	DRAWN -	REVISED -
	CHECKED -	REVISED -
PLOT DATE = 8/18/2024	DATE -	REVISED -

**STATE OF ILLINOIS
 DEPARTMENT OF TRANSPORTATION**

PHRAGMITES PLAN VIEW			
SCALE:	SHEET	OF 17 SHEETS	STA. TO STA.

F.A.P. RTE.	SECTION	COUNTY	TOTAL SHEETS	SHEET NO.
853	*	FRANKLIN	17	13
CONTRACT NO. 78A88				
ILLINOIS FED. AID PROJECT				



MODEL: Sheet4 [Sheet]
FILE NAME: c:\p\work\proj\proj\mxd\10008980\0778A88-Plans.dgn

USER NAME = Nathan.Taylor	DESIGNED -	REVISED -
	DRAWN -	REVISED -
	CHECKED -	REVISED -
PLOT DATE = 8/19/2024	DATE -	REVISED -

**STATE OF ILLINOIS
DEPARTMENT OF TRANSPORTATION**

PHRAGMITES PLAN VIEW

F.A.P. RTE.	SECTION	COUNTY	TOTAL SHEETS	SHEET NO.
853	*	FRANKLIN	17	14
CONTRACT NO. 78A88				

SCALE: SHEET OF 17 SHEETS STA. TO STA.

ILLINOIS FED. AID PROJECT
* D9 WETLAND MAINTENANCE 2024-1

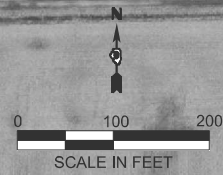

MODEL: Emergent Wetland [Sheet]
 FILE NAME: c:\p\work\wv\ct\l\l\m\m\1000888\078A88-Plans.dgn

USER NAME = Nathan.Taylor	DESIGNED -	REVISED -
	DRAWN -	REVISED -
	CHECKED -	REVISED -
PLOT DATE = 8/18/2024	DATE -	REVISED -

**STATE OF ILLINOIS
DEPARTMENT OF TRANSPORTATION**

EMERGENT WETLAND

SCALE: SHEET OF 17 SHEETS STA. TO STA.

F.A.P. RTE.	SECTION	COUNTY	TOTAL SHEETS	SHEET NO.
853	*	FRANKLIN	17	15
CONTRACT NO. 78A88				

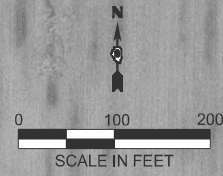

MODEL: Emergent Wetlands-1 (Sheet)
 FILE NAME: c:\p\work\pw\chil\l\lay\mcd\1000888\078A88-Plans.dgn

USER NAME = Nathan.Taylor	DESIGNED -	REVISED -
	DRAWN -	REVISED -
	CHECKED -	REVISED -
PLOT DATE = 8/18/2024	DATE -	REVISED -

**STATE OF ILLINOIS
 DEPARTMENT OF TRANSPORTATION**

EMERGENT WETLAND

SCALE: SHEET OF 17 SHEETS STA. TO STA.

F.A.P. RTE.	SECTION	COUNTY	TOTAL SHEETS	SHEET NO.
853	*	FRANKLIN	17	16
CONTRACT NO. 78A88				
ILLINOIS FED. AID PROJECT				

* D9 WETLAND MAINTENANCE 2024-1

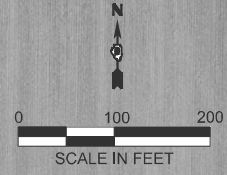

AREA 4

AREA 5

AREA 4

MODEL: Emergent Wetland (Sheet)
FILE NAME: c:\p\work\wv\10101\lay\mxd\100898\853\78A88-Plans.dgn

USER NAME	= Nathan.Taylor	DESIGNED	-	REVISED	-
		DRAWN	-	REVISED	-
		CHECKED	-	REVISED	-
PLOT DATE	= 8/18/2024	DATE	-	REVISED	-

**STATE OF ILLINOIS
DEPARTMENT OF TRANSPORTATION**

EMERGENT WETLAND

SCALE: SHEET OF 17 SHEETS STA. TO STA.

F.A.P RTE.	SECTION	COUNTY	TOTAL SHEETS	SHEET NO.
853	*	FRANKLIN	17	17
CONTRACT NO. 78A88				

ILLINOIS FED. AID PROJECT
* D9 WETLAND MAINTENANCE 2024-1