

EXISTING BRIDGE DESCRIPTION
 THE BRIDGE CONSIST OF A 3 SPAN CONTINUOUS WIDE FLANGE BEAM STRUCTURE WITH
 2 SPANS AT 45'-2" AND 1 AT 59'-2" ON OPEN R.C. ABUTMENTS AND R.C. PIERS. THE
 7" THICK CONCRETE DECK HAS A 2" THICK BITUMINOUS CONCRETE OVERLAY.

NO.	SECTION	COUNT	DATE	BY
542	*	COOK	271	223
STA.	TO STA.			
PUB. ROAD DIST. NO.		ALIGNED	PUB. ROAD PROJECT	
* 531(I & 2)R5-1(89) & 1989-107BR				
SHEET 1 OF 6				

INDEX OF SHEETS

- 1) PLAN AND ELEVATION
- 2) GENERAL NOTES AND SUMMARY OF QUANTITIES
- 3) DECK DETAILS
- 4) DELAMTECT AND BOTTOM DECK SURVEY
- 5) JOINT RECONSTRUCTION DETAILS
- 6) STAGING CROSS SECTION

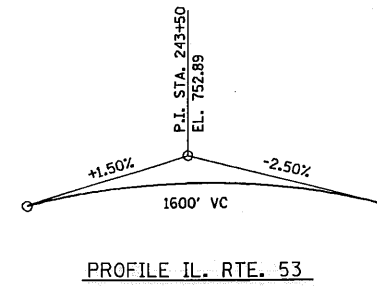
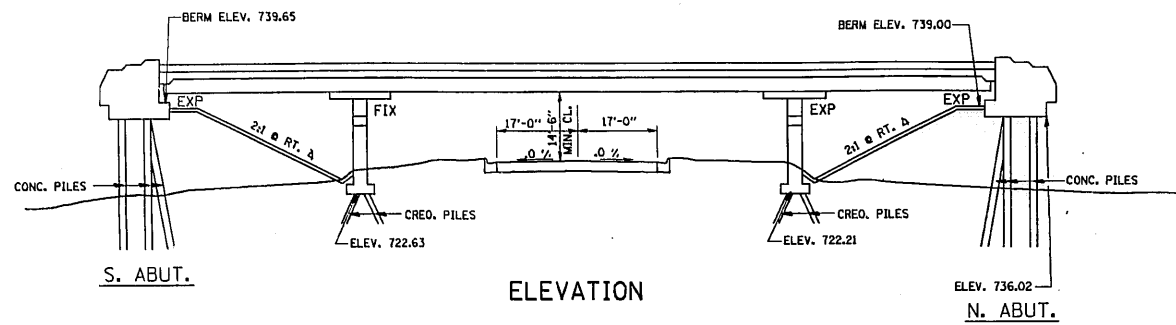

IL. 53 HORIZ. CURVE DATA

P.I. STA= 236+37.28	E= 1677.02
Δ= 77° 11' 38"	P.C. STA= 188+48.07
D= 0° 57' 17.8"	P.T. STA= 269+31.79
R= 6000'	
T= 4789.21'	
L= 8083.72'	

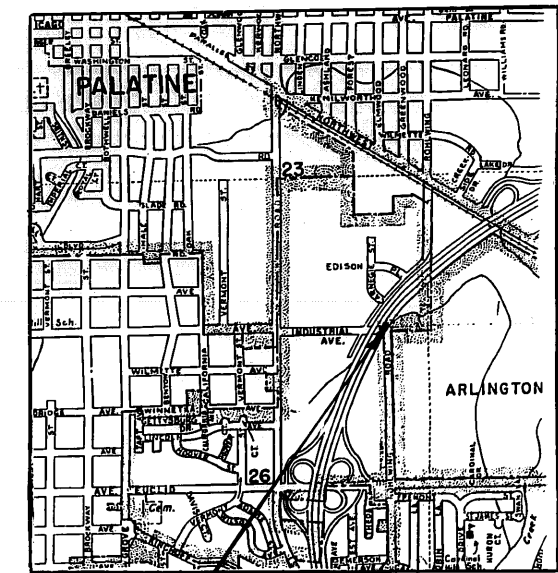
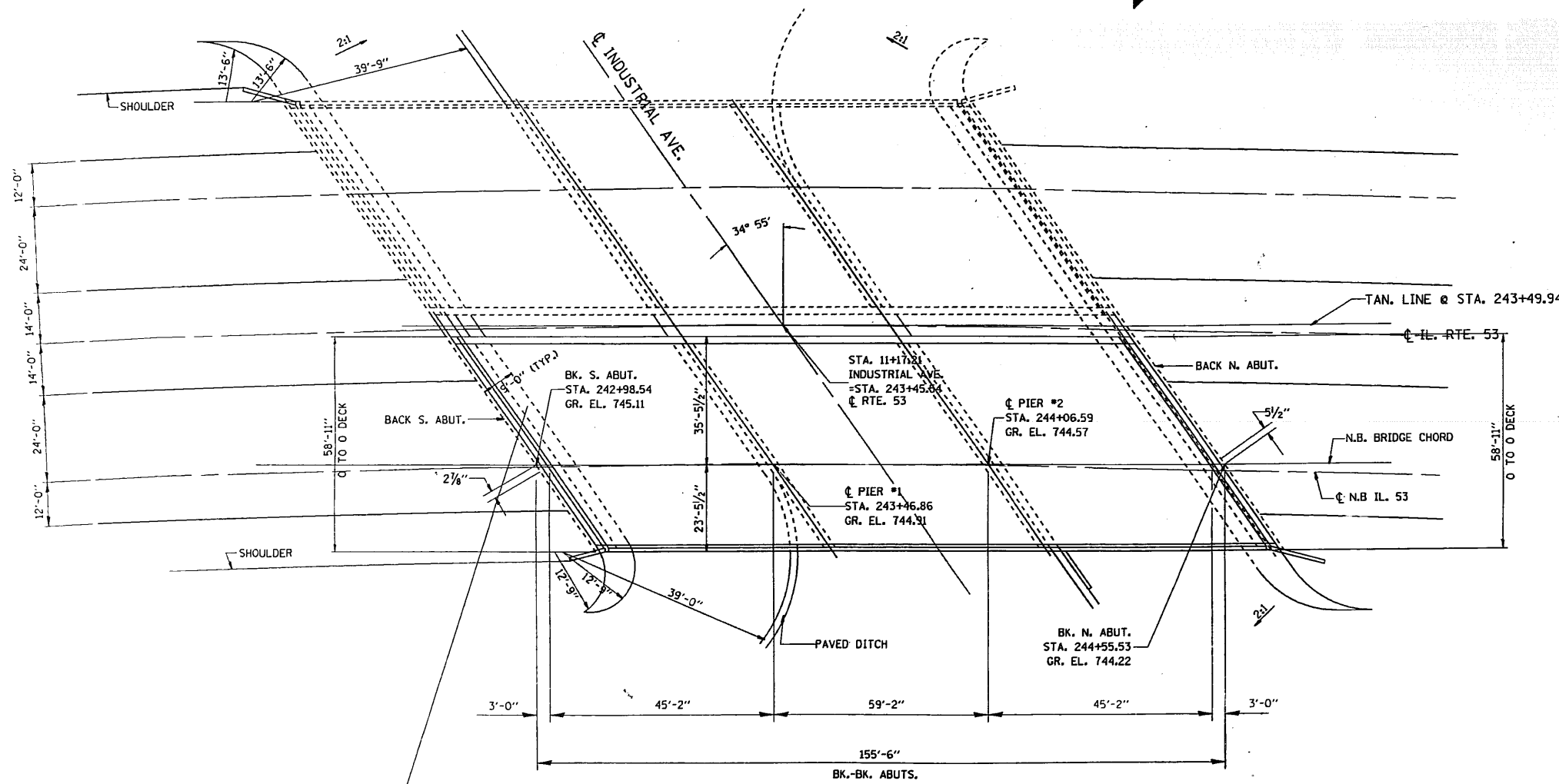

STRUCTURE NO. 016-0375
 NORTHBOUND

ILLINOIS DEPARTMENT OF TRANSPORTATION
 IL. RTE. 53 @ INDUSTRIAL AVE. N.B.
 BRIDGE REHABILITATION
 STRUCTURE NO. 016-0375
 PLAN & ELEVATION

REVISIONS	
NAME	DATE

SCALE: VERT. NONE
 HORIZ. 1"=40'

DATE 10/23/90

DRAWN BY
 CHECKED BY

STRUCTURE NO. 016-0375
 NORTHBOUND

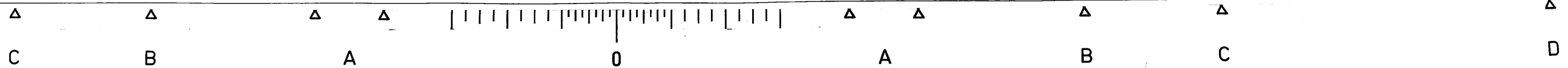

F.A.P. RTE.	SECTION	COUNTY	TOTAL SHEETS	SHEET NO.
342	*	COOK	271	224
STA.		TO STA.		
FED. ROAD DIST. NO. 7		ILLINOIS	FED. AID PROJECT:	

* 531(142)R9-1(89) & 1989-107 BR
SHEET 2 OF 6

NOTES:

1. ~~The zinc-silicate and vinyl paint system shall be used for shop and field painting of Structural Steel except where otherwise noted. The color of the vinyl finish coat shall be Munsell No. 7.5G 4/B.~~

2. All structural steel shall be AASHTO M 222 except expansion joint plates and attached bars which shall be AASHTO M 183.

2A Deck Repair Method II shall be used for this structure (See Spec. Prov.)

3. Expansion joint plates and attached bars shall be shop painted with the zinc-silicate primer.

4. ~~AASHTO M 222 structural steel shall not be painted except, that for a distance of three times the depth of the beams or girders (but not exceeding 10 feet) each way from deck joints, the AASHTO M 222 structural steel shall be cleaned and given one coat of the zinc-silicate primer and a dark maroon vinyl finish coat. The color of the finish coats shall be Munsell No. 2.5 YR 3/4 reddish brown. Both coats may be applied in the shop with spot painting only in the field.~~

5. The structural steel bearing plates of the Elastomeric Bearing Assembly shall conform to the requirements of AASHTO M 223 Grade 50 (AASHTO M 222).

6. Reinforcement bars shall conform to the requirements of AASHTO M-31, M-42 or M-53 Grade 60.

7. Plan dimensions and details relative to existing structure have been taken from existing plans and are subject to nominal construction variations. It shall be the Contractor's responsibility to verify such dimensions and details in the field and make necessary approved adjustments prior to construction or ordering of materials. Such variations shall not be cause for additional compensation for a change in the scope of the work, however, the Contractor will be paid for the quantity actually furnished at the unit price bid for the work.

8. ~~All accessible end areas of steel beams, exposed top of steel beams, end diaphragms, and bearings designated by the Engineer for painting shall be cleaned by Method 1. The three coat lead and chromate free alkyd paint system shall be applied over all cleaned areas, except the exposed top of steel beams to be embedded in concrete shall receive only one coat of the primer of this system. The color of the final finish coat shall be INTERSTATE GREEN. This work will be paid for in accordance with Article 109.04 of the Standard Specifications.~~

TOTAL BILL OF MATERIALS



ITEM	UNIT	TOTAL
BITUMINOUS CONCRETE REMOVAL (DECK)	SQ. YD.	935
CONCRETE BRIDGE DECK SCARIFICATION, 1/2"	SQ. YD.	935
DECK SLAB REPAIR (PARTIAL DEPTH)	SQ. YD.	11
DECK SLAB REPAIR (FULL DEPTH)	SQ. YD.	15
CONCRETE REMOVAL, SPECIAL	CU. YD.	184
HANDRAIL REMOVAL	LIN. FT.	304
NEOPRENE JOINT, 2"	LIN. FT.	152
REINFORCEMENT BARS, EPOXY COATED	POUND	28660
CLASS X CONCRETE SUPERSTRUCTURE	CU. YD.	20.8
MICROSILICIA CONCRETE BRIDGE DECK OVERLAY 2 1/2"	SQ. YD.	935
PROTECTIVE COAT	SQ. YD.	395
PROTECTIVE SHIELD	SQ. YD.	365
CONCRETE PARAPET RETROFIT	LIN. FT.	304
FURNISHING AND ERECTING STRUCTURAL STEEL	POUND	0
SAWING P.C. CONCRETE PAVEMENT, 3/4"	LIN. FT.	3970

REVISIONS	
NAME	DATE

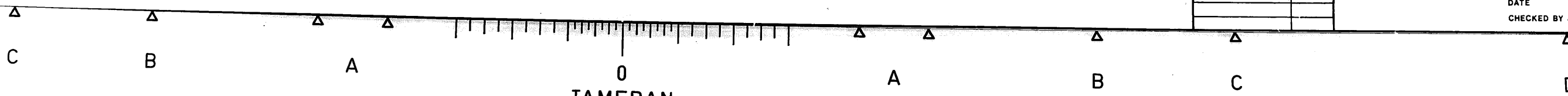
DEPARTMENT OF TRANSPORTATION
IL. RTE. 53 @ INDUSTRIAL AVE.
(NORTHBOUND LANES)
GENERAL NOTES
AND
BILL OF MATERIALS
S.N. 016-0375
DATE
CHECKED BY R.V.



LEGEND

-  DECK SLAB REPAIR (PARTIAL DEPTH) SEE DELAMTEC SHEET No.4
-  DECK SLAB REPAIR (FULL DEPTH) SEE BOTTOM DECK SURVEY SHEET No.4
-  CONCRETE TO BE REMOVED

P. A. P. NO.	SECTION	COUNTY	TOTAL SHEETS	SHEET NO.
342	*	COOK	271	225
STA.	TO STA.			
FED. ROAD DIST. NO.		ILLINOIS	FED. AID PROJECT	
* 531(1) & 21RS-1(89) & 1989-107BR				
SHEET 3 OF 6				

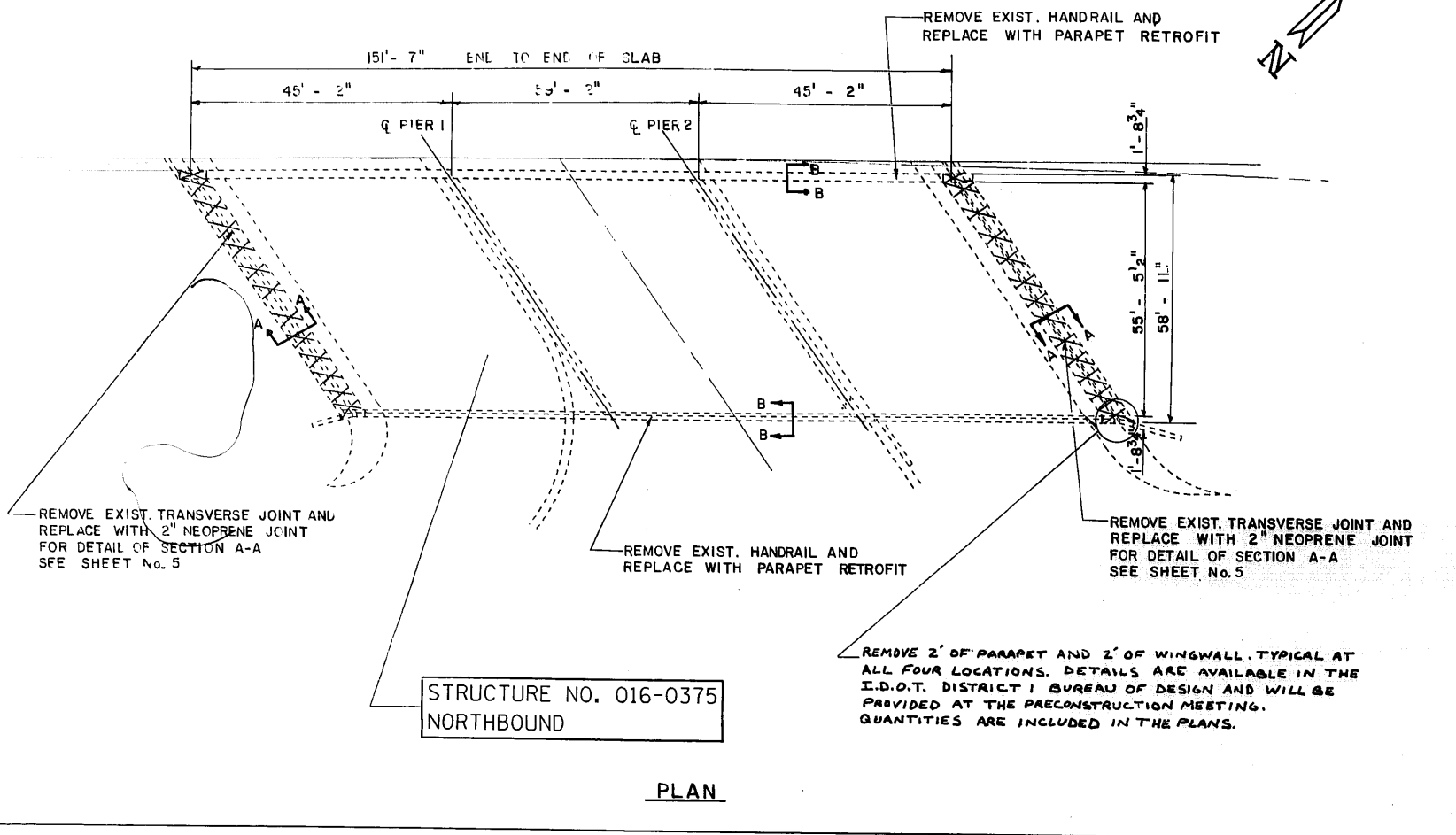

PLAN

BILL OF MATERIALS		UNIT	QUANTITIES
ITEM			TOTAL
BITUMINOUS CONCRETE REMOVAL (DECK)		SQ. YD.	935
CONCRETE BRIDGE DECK SCARIFICATION, 1/2"		SQ. YD.	935
DECK SLAB REPAIR (PARTIAL DEPTH)		SQ. YD.	25
DECK SLAB REPAIR (FULL DEPTH)		SQ. YD.	30
MICROSILICIA CONCRETE BRIDGE DECK OVERLAY, 2 1/2"		SQ. YD.	935
PROTECTIVE COAT		SQ. YD.	395
PROTECTIVE SHIELD		SQ. YD.	365
PARAPET RETROFIT		LIN. FT.	304
HANDRAIL REMOVAL		LIN. FT.	304

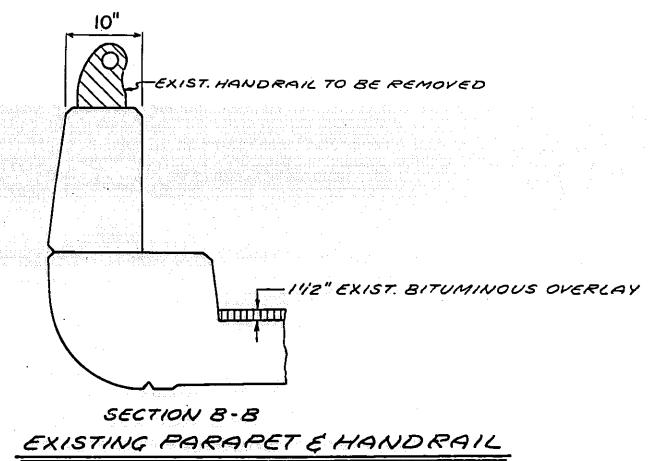

**SECTION B-B
EXISTING PARAPET & HANDRAIL**

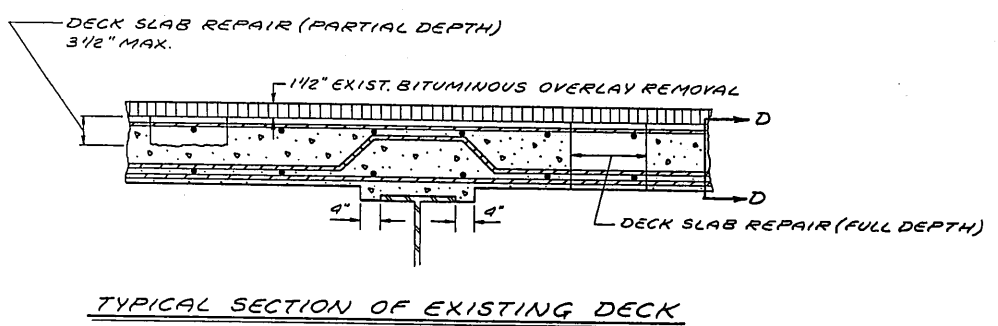

TYPICAL SECTION OF EXISTING DECK

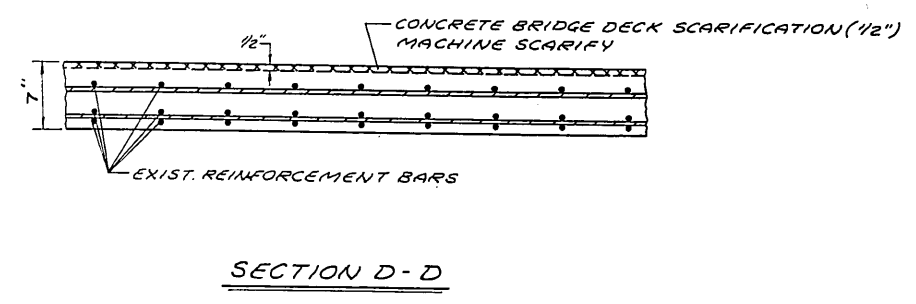

SECTION D-D

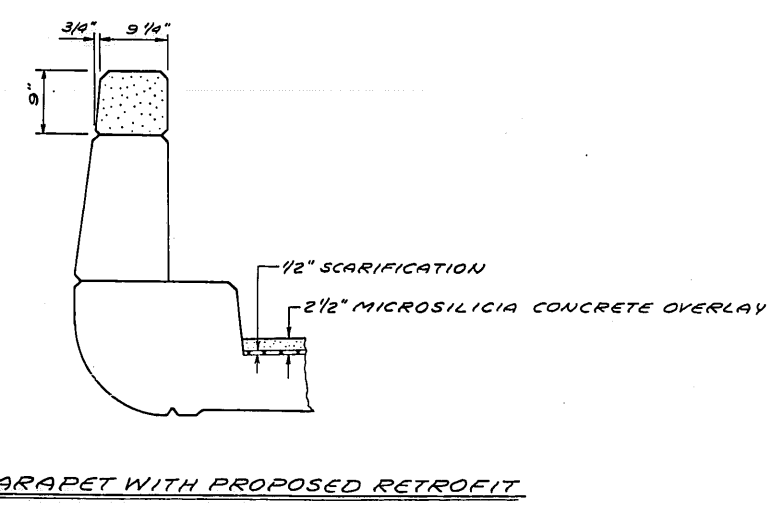

PARAPET WITH PROPOSED RETROFIT

REVISIONS	
NAME	DATE

ILLINOIS DEPARTMENT OF TRANSPORTATION
 IL. RTE. 53 @ INDUSTRIAL AVE. N.B.
 BRIDGE REHABILITATION
 STRUCTURE NO. 016-0375
 DECK DETAILS
 SCALE: VERT. _____
 HORIZ. _____
 DATE 10/23/90
 DRAWN BY _____
 CHECKED BY _____

FED. AID DIST. NO.	SECTION	COUNTY	TOTAL SHEETS	SHEET NO.
342	*	COOK	271	226
STA.		TO STA.		
FED. ROAD DIST. NO. 7		ILLINOIS		FED. AID PROJECT

* 531(1 & 2)RS-1(89) & 1989-107 BR
SHEET 4 OF 6

SCALE: HORIZONTAL 1" = 10'
VERTICAL 1" = 10'

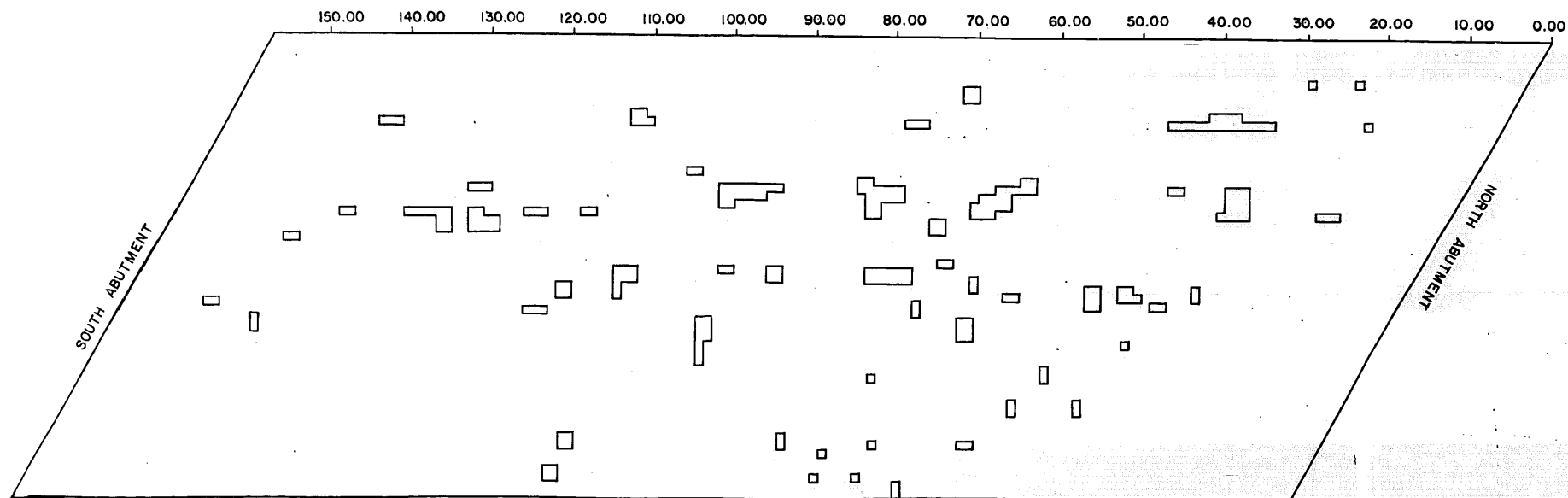

BRIDGE: 016 0375
DATE: 5/24/90
OPERATOR: MATECHICK SKEW 54-35'
COMMENTS: 53 NB/INDUSTRIAL

ROADWAY AREA: 935 SY
DELAMINATED AREA: 25 SY
% DELAMINATED: 3 %

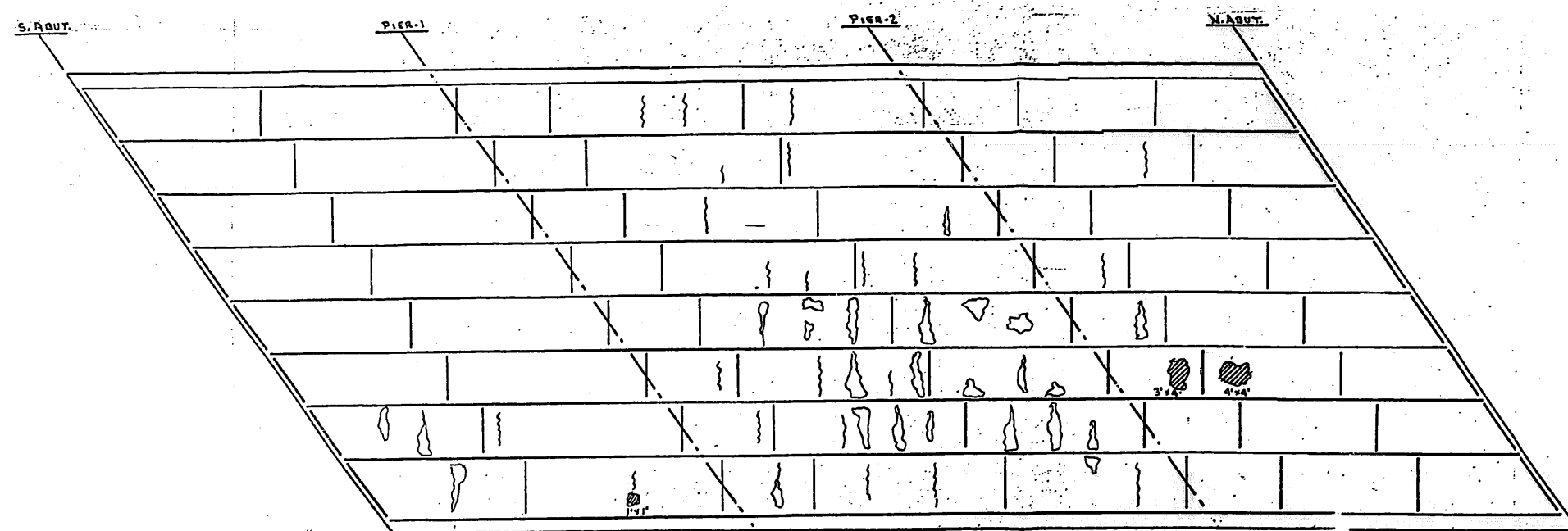

NOTE:
 - SPALL AREAS = 29 Sq. FT.
 - LEACHING AREAS
 - LEACHING CRACKS

BRIDGE: ILL 53 N.B./INDUSTRIAL AVE
BRIDGE No. 016-0375 '224
BOTTOM DECK SURVEY
FIELD DATA N.M. DATE 3/4/90
DRAWN BY N.M. DATE 3/13/90

REVISIONS	
NAME	DATE

DEPARTMENT OF TRANSPORTATION
IL. RTE. 53 @ INDUSTRIAL AVE. N.B.
BRIDGE REHABILITATION
STRUCTURE NO. 016-0375
DELAMTECT AND BOTTOM DECK SURVEY

DATE
CHECKED BY

NOTES EXISTING REINFORCEMENT BARS IN THE REMOVAL AREAS SHALL BE CLEANED BEFORE PLACEMENT OF NEW CLASS X CONCRETE. (COST TO BE INCIDENTAL TO "CLASS X CONCRETE")
 REMOVAL OF EXISTING STRUCTURAL STEEL SHALL BE INCIDENTAL TO "CONCRETE REMOVAL SPECIAL".

* THE ARRANGEMENT BELOW OF SLIDING PLATE IS FOR THE NORTH ABUTMENT ONLY. FOR SOUTH ABUTMENT THE SLIDING PLATE IS WELDED TO ANGLES ON THE ABUTMENT.

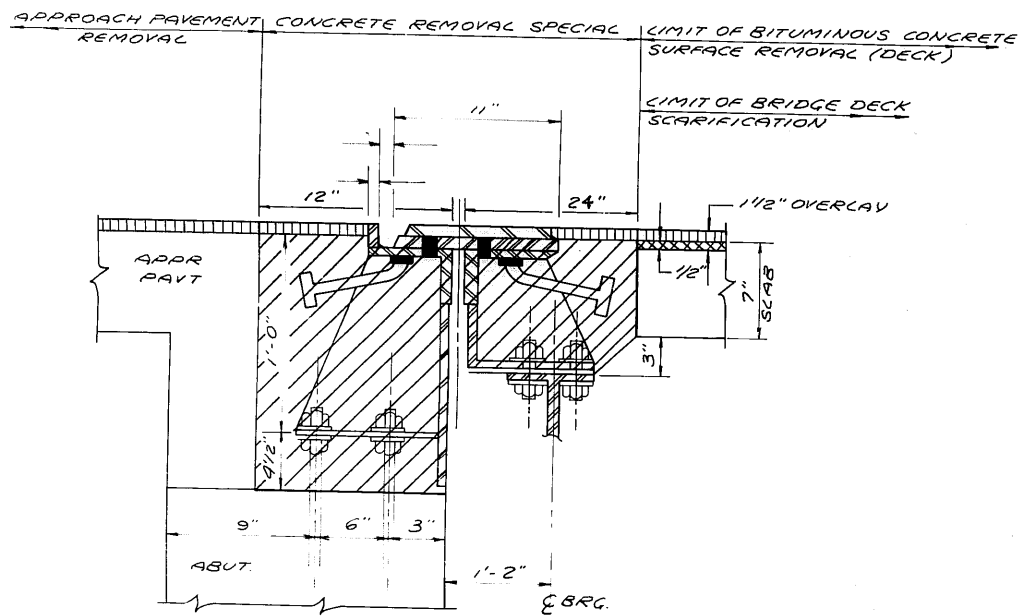

SECTION A-A
 SECTION THRU EXISTING JOINT AT NORTH ABUTMENT

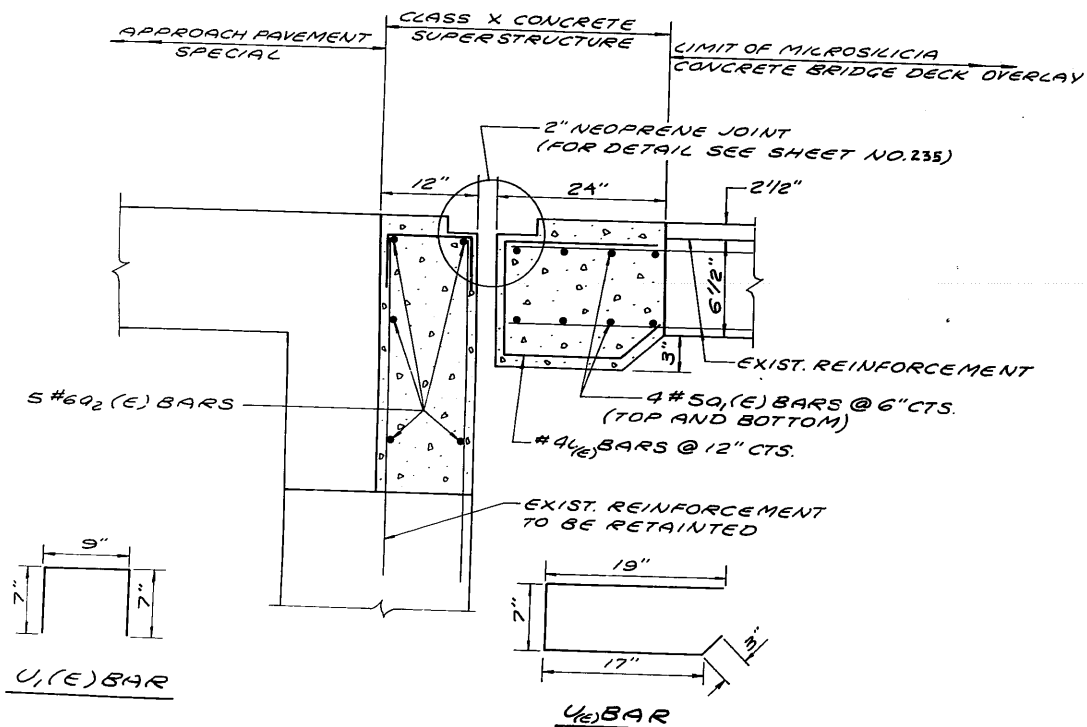

SECTION A-A
 SECTION THRU PROPOSED JOINT AT N. AND S. ABUTMENT

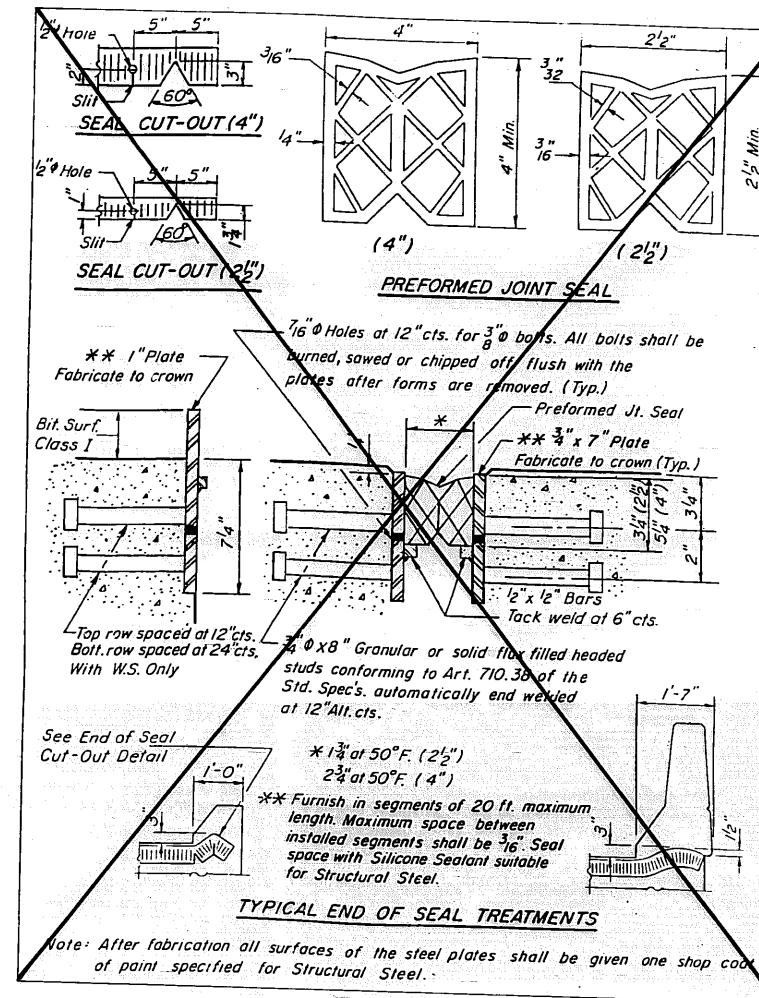

Note: After fabrication all surfaces of the steel plates shall be given one shop coat of paint specified for Structural Steel.

SECTION	COUNTY	TOTAL SHEETS	SHEET NO.
342 *	COOK	271	227

* 53(122)RS-1(B9) 4/1989-107 BR
 SHEET 5 OF 6
 BAR LIST (TWO ABUT.)

BAR NO.	SIZE	LENGTH	SHAPE
Q ₁ (E)	32 #5	33'-8"	
U ₁ (E)	130 #4	3'-10"	
Q ₂ (E)	20 #6	33'-8"	
U ₁ (E)	130 #4	1'-11"	

(E) DENOTES EPOXY COATED

BILL OF MATERIALS (TWO ABUTMENTS)

ITEM	UNIT	QUANTITY
CONCRETE REMOVAL, SPECIAL	CU. YD.	184
REINFORCEMENT BARS (EPOXY COATED)	POUND	2866.0
CLASS X CONCRETE SUPERSTRUCTURE	CU. YD.	20.8
SAWING P.C. CONCRETE, PAVEMENT, 3/4"	LIN. FT.	3970
FURNISHING AND ERECTING STRUCTURAL STEEL	POUND	0
NEOPRENE JOINT, 2"	LIN. FT.	152.0
PROTECTIVE COAT	SQ. YD.	570

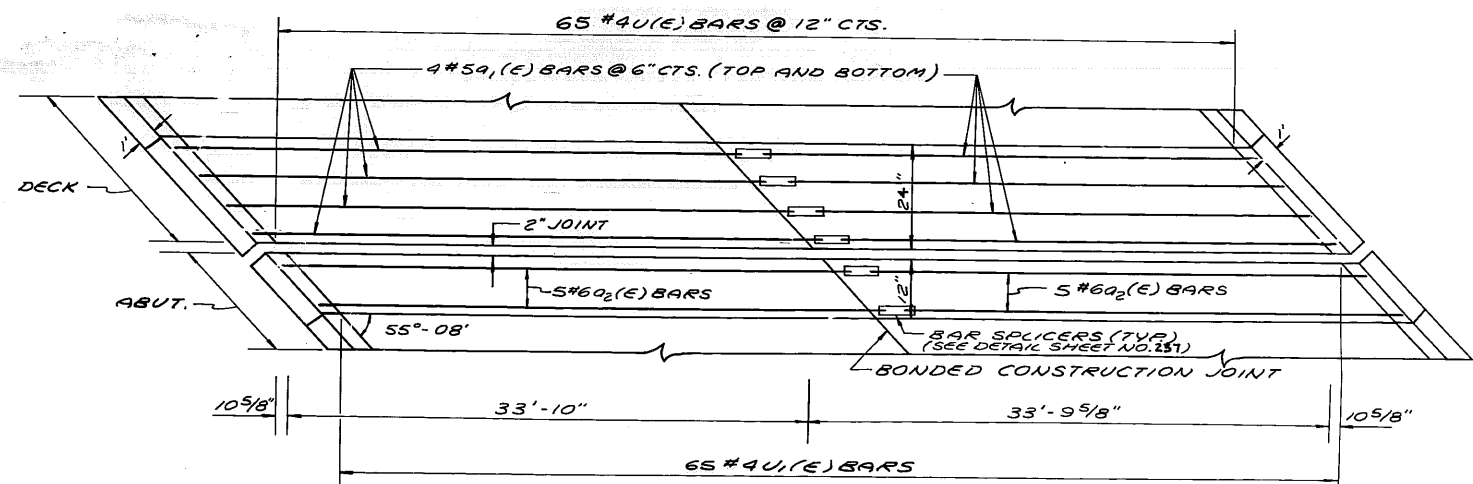

PLAN OF PROPOSED JOINT AT N. AND S. ABUTMENT

REVISIONS	
NAME	DATE

ILLINOIS DEPARTMENT OF TRANSPORTATION
 IL. RTE. 53 @ INDUSTRIAL AVE.
 (NORTHBOUND LANES)
 STRUCTURE NO. 016-0375
 JOINT RECONSTRUCTION DETAILS

SCALE: VERT. NONE
 HORIZ. DRAWN BY J.R.C.
 DATE CHECKED BY R.V.

F&D NO.	SECTION	COUNTY	TOTAL SHEETS	SHEET NO.
342	*	COOK	271	228
STA.		TO STA.		
FED. ROAD DIST. NO. 7	ILLINOIS	FED. AID PROJECT		
* 531 (1/2) RS-(89) & 1989-107 BR				
SHEET 6 OF 6				

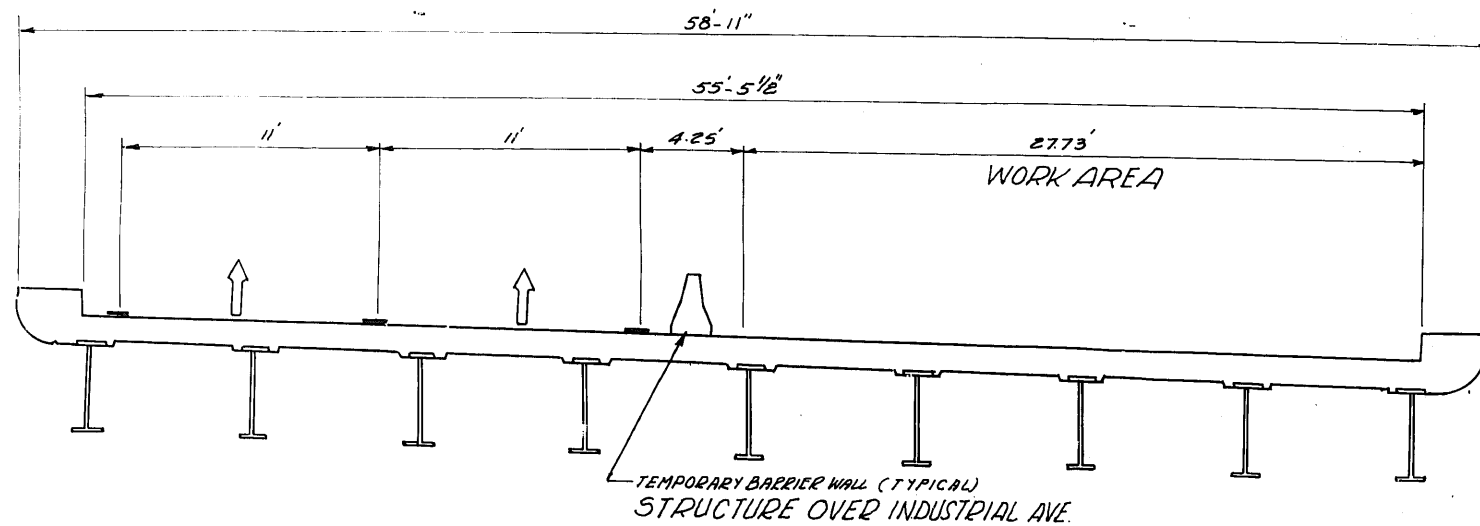

STAGE - II

- STAGE II
- 1.) PLACE ALL TRAFFIC CONTROL AND REROUTE TRAFFIC TO *OUTSIDE* LANES
 - 2.) REMOVE EXISTING BRIDGE DECK BITUMINOUS OVERLAY 1 1/2"
 - 3.) SCARIFY BRIDGE DECK SLAB 1/2"
 - 4.) REMOVE EXISTING HANDRAIL AND REPLACE WITH A CONCRETE PARAPET RETROFIT
 - 5.) CONSTRUCT PARTIAL AND FULL DEPTH DECK SLAB REPAIRS
 - 6.) REMOVE EXISTING TRANSVERSE JOINTS
 - 7.) INSTALL PROPOSED PREFORMED JOINT SEAL OR NEOPRENE JOINTS
 - 8.) PLACE PROPOSED MICROSILICIA CONCRETE BRIDGE DECK OVERLAY 2 1/2"

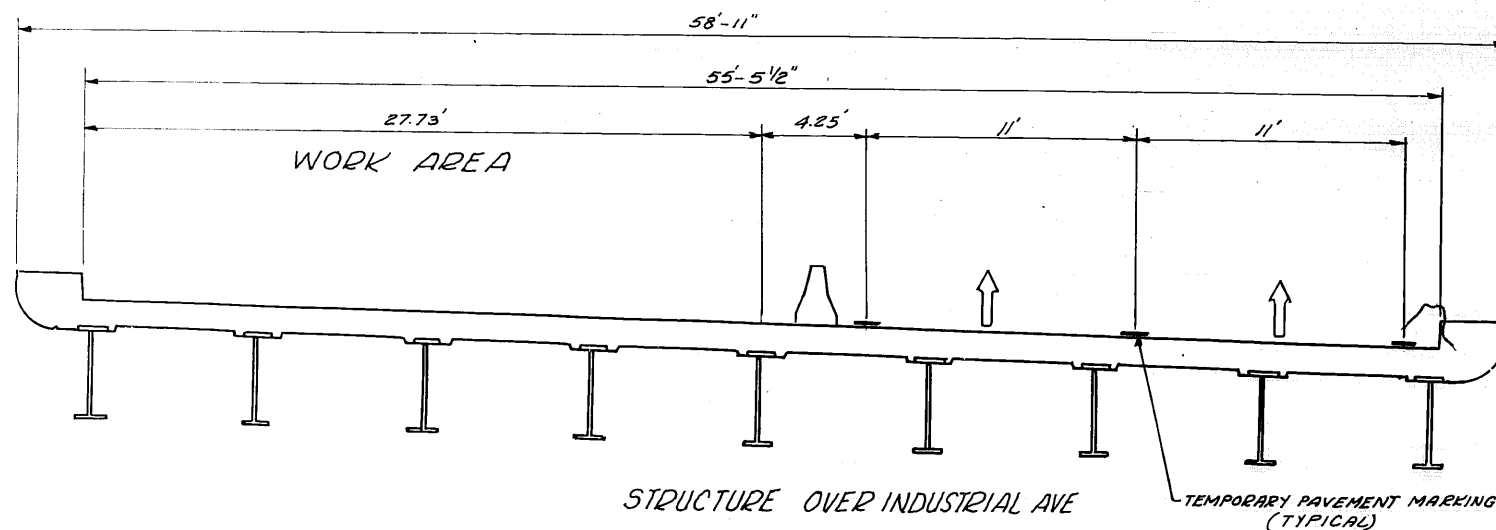

STAGE - III

- STAGE III
- 1.) RELOCATE ALL TRAFFIC CONTROL AND REROUTE TRAFFIC TO *INSIDE* LANES
 - 2.) REMOVE EXISTING BRIDGE DECK BITUMINOUS OVERLAY 1 1/2"
 - 3.) SCARIFY BRIDGE DECK SLAB 1/2"
 - 4.) REMOVE EXISTING HANDRAIL AND REPLACE WITH A CONCRETE PARAPET RETROFIT.
 - 5.) CONSTRUCT PARTIAL AND FULL DEPTH DECK SLAB REPAIRS
 - 6.) REMOVE EXISTING TRANSVERSE JOINTS
 - 7.) INSTALL PROPOSED PREFORMED JOINT SEAL OR NEOPRENE JOINTS
 - 8.) PLACE PROPOSED MICROSILICIA CONCRETE BRIDGE DECK OVERLAY 2 1/2"

REVISIONS	
NAME	DATE

ILLINOIS DEPARTMENT OF TRANSPORTATION
ILLINOIS ROUTE-53
(NORTHBOUND)
TYPICAL STAGING CROSS SECTION
STRUCTURE OVER INDUSTRIAL AVE.
STRUCTURE NO. 016-0375

SCALE: VERT.
HORIZ.
DATE

DRAWN BY: DGM
CHECKED BY: RY

EXISTING BRIDGE DESCRIPTION

THE BRIDGE CONSIST OF A 3 SPAN CONTINUOUS WIDE FLANGE BEAM STRUCTURE WITH 2 SPANS AT 45'-2" AND 1 AT 59'-2" ON OPEN R.C. ABUTMENTS AND R.C. PIERS. THE 7" THICK CONCRETE DECK HAS A 2" THICK BITUMINOUS CONCRETE OVERLAY.

P.A.P. NO.	SECTION	COUNTY	TOTAL SHEETS	SHEET NO.
342	*	COOK	271	229
STA.	TO STA.			
FED. ROAD DIST. NO.	ILLINOIS	FED. AID PROJECT		

* 531 (1 & 2)RS-1(89) & 1989-107BR
SHEET 1 OF 6

INDEX OF SHEETS

- 1) PLAN AND ELEVATION
- 2) GENERAL NOTES AND SUMMARY OF QUANTITIES
- 3) DECK DETAILS
- 4) DELAMTECT AND BOTTOM DECK SURVEY
- 5) JOINT RECONSTRUCTION DETAIL
- 6) STAGING CROSS SECTION DETAIL

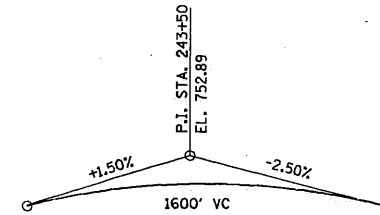
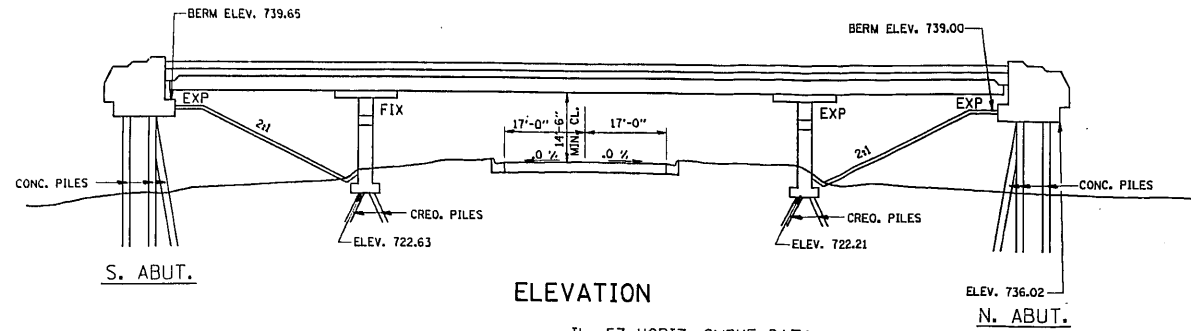

PROFILE IL. RTE. 53

IL. 53 HORIZ. CURVE DATA

P.I. STA= 236+37.28 E= 1677.02
 $\Delta = 77^\circ 11' 38''$ P.C. STA= 188+48.07
 $D = 0^\circ 57' 17.8''$ P.T. STA= 269+31.79
 $R = 6000'$
 $T = 4789.21'$
 $L = 8083.72'$

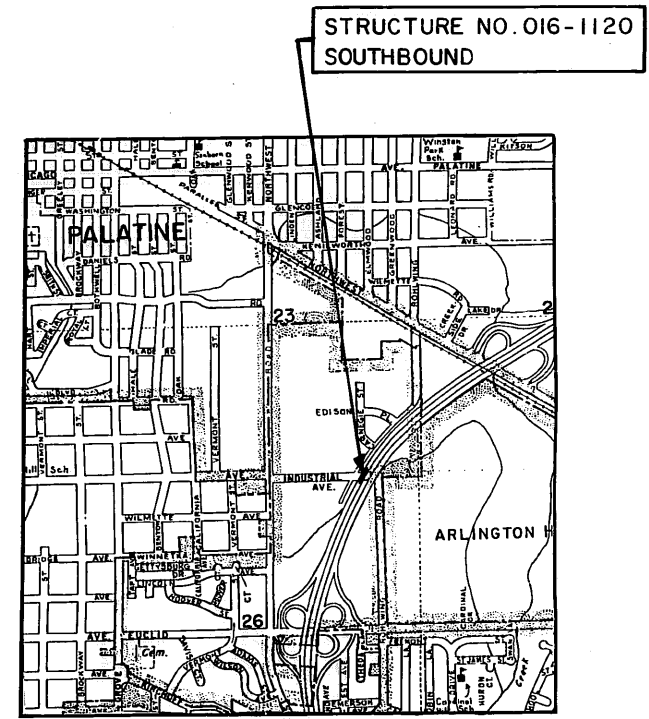
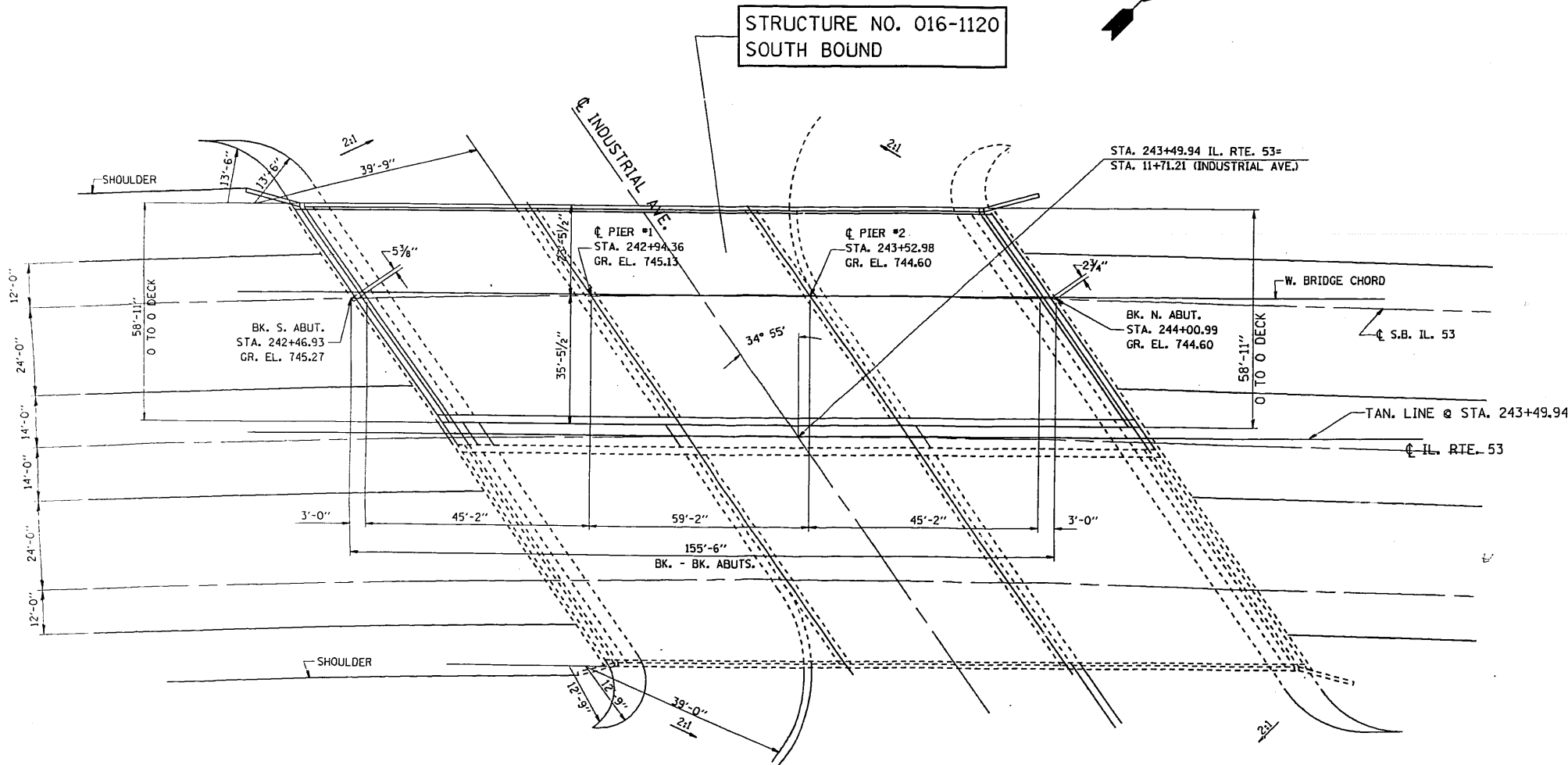

REVISIONS	
NAME	DATE

ILLINOIS DEPARTMENT OF TRANSPORTATION
 IL. RTE. 53 @ INDUSTRIAL AVE. S.B.
 BRIDGE REHABILITATION
 STRUCTURE NO. 016-1120
 PLAN & ELEVATION

* 531 (162) RS-1 (89) & 1989-107 BR
SHEET 2 OF 6

NOTES:

1. ~~The Zinc-silicate and vinyl paint system shall be used for shop and field painting of Structural Steel except where otherwise noted. The color of the vinyl finish coat shall be Munsell No. 7.5G 4/6.~~
2. All structural steel shall be AASHTO M 222 except expansion joint plates and attached bars which shall be AASHTO M 183.
- 2A. *Deck Repair Method II shall be used for this structure (See Spec Prov.)*
3. Expansion joint plates and attached bars shall be shop painted with the zinc-silicate primer.
4. ~~AASHTO M 222 structural steel shall not be painted except, that for a distance of three times the depth of the beams or girders (but not exceeding 10 feet) each way from deck joints, the AASHTO M 222 structural steel shall be cleaned and given one coat of the zinc-silicate primer and a dark maroon vinyl finish coat. The color of the finish coats shall be Munsell No. 2.5 YR 3/4 reddish brown. Both coats may be applied in the shop with spot painting only in the field.~~
5. The structural steel bearing plates of the Elastomeric Bearing Assembly shall conform to the requirements of AASHTO M 223 Grade 50 (AASHTO M 222).
6. Reinforcement bars shall conform to the requirements of AASHTO M-31, M-42 or M-53 Grade 60.
7. Plan dimensions and details relative to existing structure have been taken from existing plans and are subject to nominal construction variations. It shall be the Contractor's responsibility to verify such dimensions and details in the field and make necessary approved adjustments prior to construction or ordering of materials. Such variations shall not be cause for additional compensation for a change in the scope of the work, however, the Contractor will be paid for the quantity actually furnished at the unit price bid for the work.
8. ~~All accessible end areas of steel beams, exposed top of steel beams, end diaphragms, and bearings designated by the Engineer for painting shall be cleaned by Method I. The three coat lead and chromate free alkyd paint system shall be applied over all cleaned areas, except the exposed top of steel beams to be embedded in concrete shall receive only one coat of the primer of this system. The color of the final finish coat shall be INTERSTATE GREEN. This work will be paid for in accordance with Article 109.04 of the Standard Specifications.~~

TOTAL BILL OF MATERIALS

ITEM	UNIT	TOTAL
BITUMINOUS CONCRETE REMOVAL (DECK)	SQ. YD.	935
CONCRETE BRIDGE DECK SCARIFICATION, 1/2"	SQ. YD.	935
DECK SLAB REPAIR (PARTIAL DEPTH)	SQ. YD.	25
DECK SLAB REPAIR (FULL DEPTH)	SQ. YD.	30
CONCRETE REMOVAL, SPECIAL	CU. YD.	18.4
HANDRAIL REMOVAL	LIN. FT.	304
NEOPRENE JOINT, 2"	LIN. FT.	152
REINFORCEMENT BARS, EPOXY COATED	POUND	2866
CLASS X CONCRETE SUPERSTRUCTURE	CU. YD.	208
MICROSILICIA CONCRETE BRIDGE DECK OVERLAY 2 1/2"	SQ. YD.	935
PROTECTIVE COAT	SQ. YD.	570
PROTECTIVE SHIELD	SQ. YD.	365
CONCRETE PARAPET RETROFIT	LIN. FT.	304
FURNISHING AND ERECTING STRUCTURAL STEEL	POUND	0
SAWING RC CONCRETE PAVEMENT, 3/4"	LIN. FT.	397

REVISIONS	
NAME	DATE

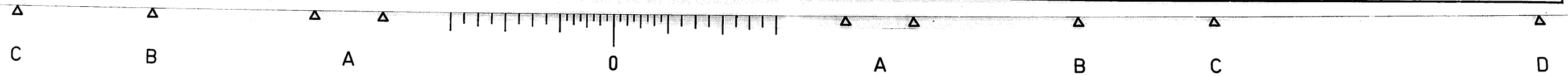

DEPARTMENT OF TRANSPORTATION
 ILL. RTE. 53 @ INDUSTRIAL AVE.
 (SOUTHBOUND LANES)
 GENERAL NOTES
 AND
 BILL OF MATERIALS
 S.N. 016-1120
 DATE
 CHECKED BY R.V.



F.A.P. NO.	SECTION	COUNTY	TOTAL SHEETS	SHEET NO.
342	*	COOK	271	231
STA.		TO STA.		
FED. ROAD DIST. NO.		ILLINOIS	FED. AID PROJECT	

* 531 (1 & 2)RS-1(89) & 1989-107BR
SHEET 3 OF 6

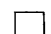
LEGEND

-  DECK SLAB REPAIR (PARTIAL DEPTH) SEE DELAMTEC SHEET No. 4
-  DECK SLAB REPAIR (FULL DEPTH) SEE BOTTOM DECK SURVEY SHEET No. 4
-  CONCRETE TO BE REMOVED

REMOVE 2' OF PARAPET AND 2' OF WINGWALL. TYPICAL AT ALL FOUR LOCATIONS. DETAILS ARE AVAILABLE IN THE I.D.O.T. DISTRICT 1 BUREAU OF DESIGN AND WILL BE PROVIDED AT THE PRECONSTRUCTION MEETING. QUANTITIES ARE INCLUDED IN THE PLANS.

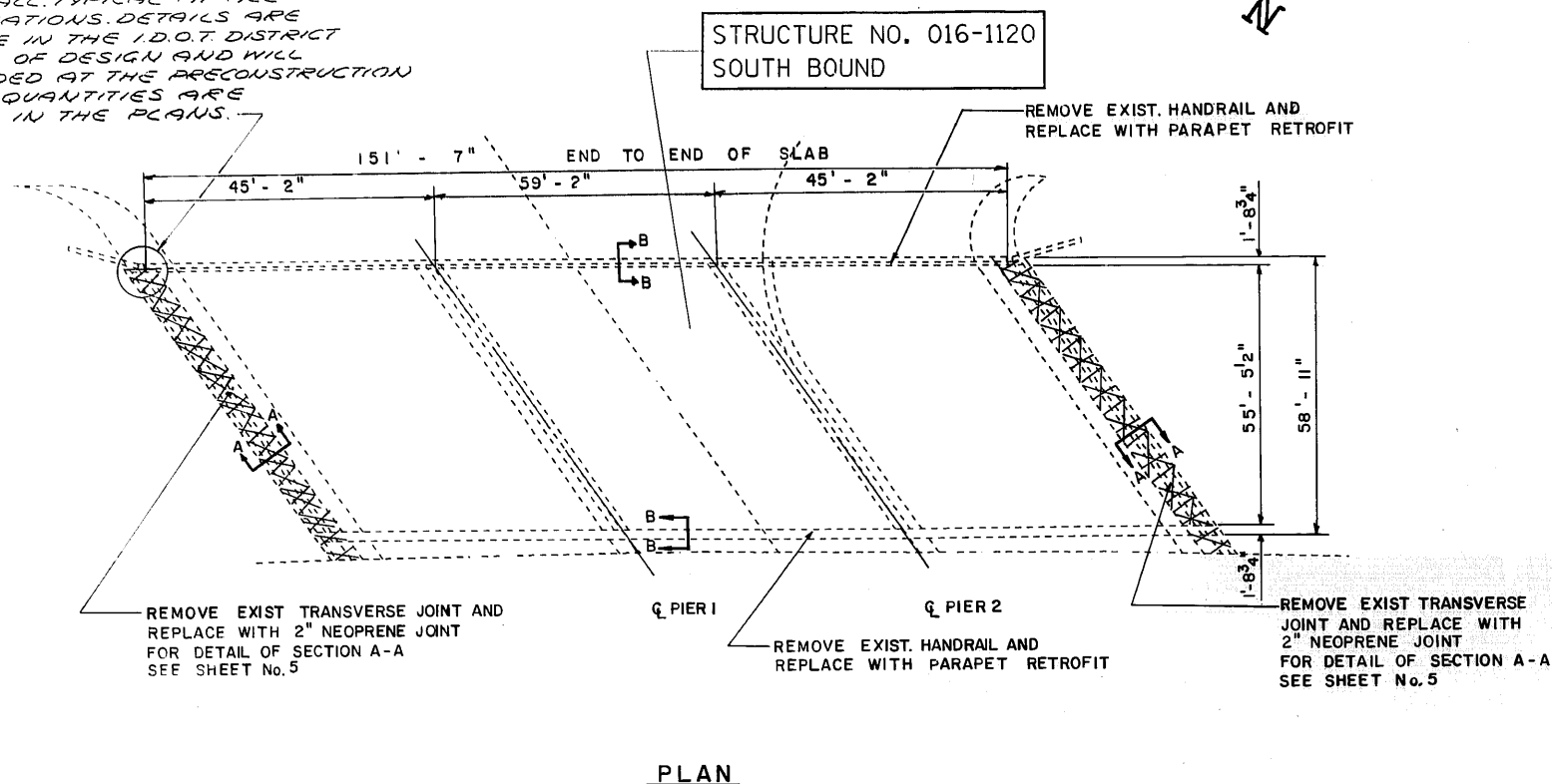

BILL OF MATERIALS		QUANTITIES	
ITEM	UNIT	TOTAL	
BITUMINOUS CONCRETE REMOVAL (DECK)	SQ. YD.	935	
CONCRETE BRIDGE DECK SCARIFICATION, 1/2"	SQ. YD.	935	
DECK SLAB REPAIR (PARTIAL DEPTH)	SQ. YD.	11	
DECK SLAB REPAIR (FULL DEPTH)	SQ. YD.	15	
MICROSILICIA CONCRETE BRIDGE DECK OVERLAY, 2 1/2"	SQ. YD.	935	
PROTECTIVE COAT	SQ. YD.	395	
PROTECTIVE SHIELD	SQ. YD.	365	
PARAPET RETROFIT	LIN. FT.	304	
HANDRAIL REMOVAL	LIN. FT.	304	

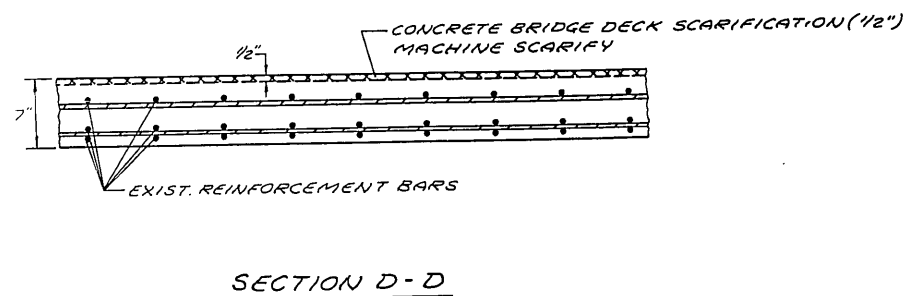
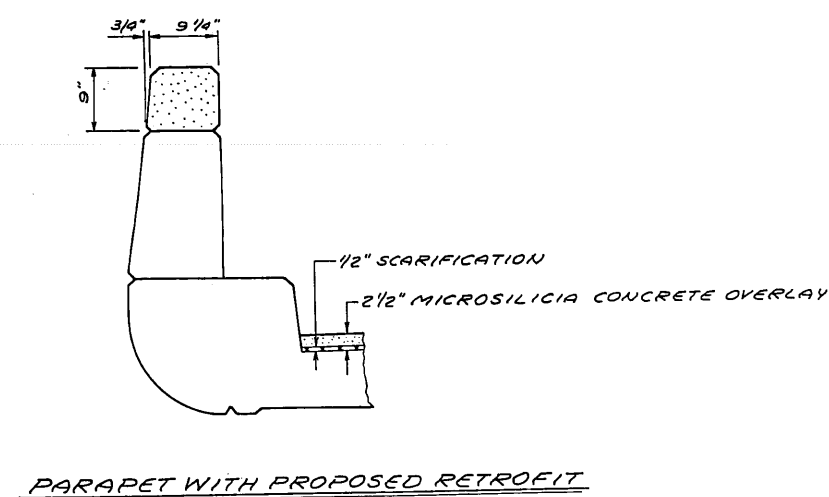
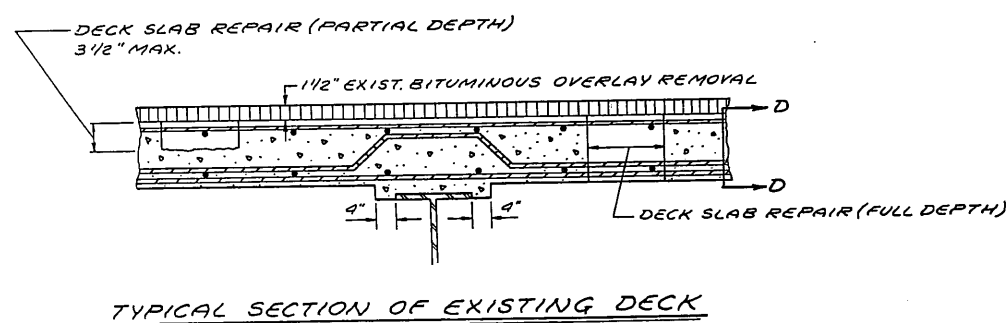
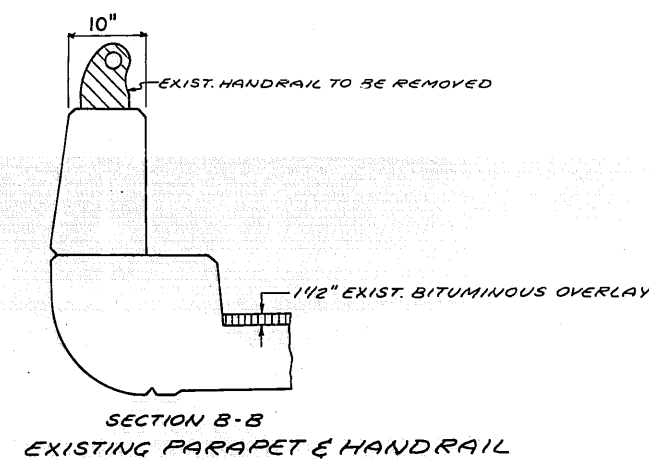

REVISIONS	
NAME	DATE

ILLINOIS DEPARTMENT OF TRANSPORTATION
IL. RTE. 53 @ INDUSTRIAL AVE. S.B.
BRIDGE REHABILITATION
STRUCTURE NO. 016-1120
DECK DETAILS

SCALE: VERT.
HORIZ.
DATE 10/23/90

DRAWN BY
CHECKED BY

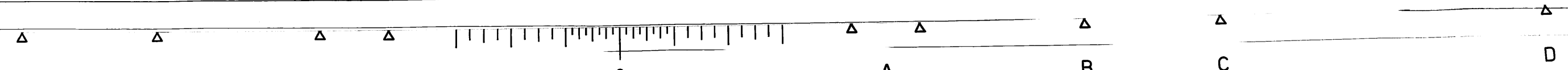

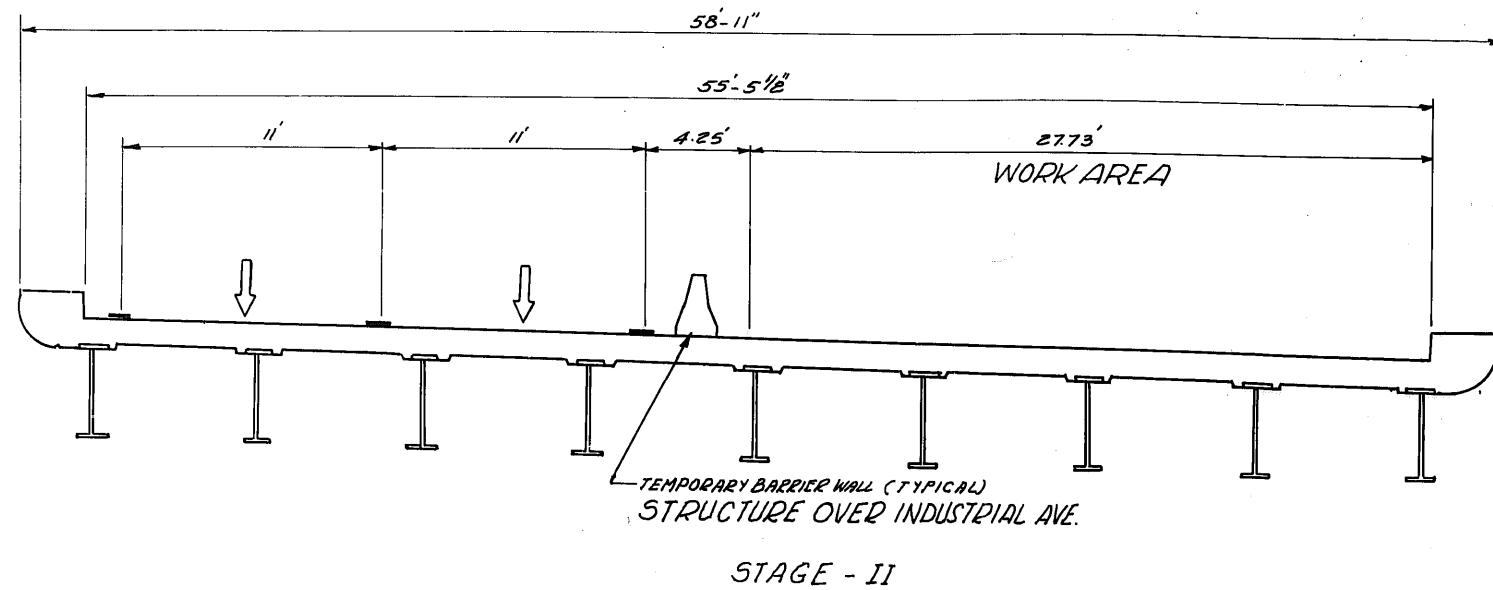

- STAGE II
- 1.) PLACE ALL TRAFFIC CONTROL AND REROUTE TRAFFIC TO OUTSIDE LANES
 - 2.) REMOVE EXISTING BRIDGE DECK BITUMINOUS OVERLAY 1 1/2"
 - 3.) SCARIFY BRIDGE DECK SLAB 1/2"
 - 4.) REMOVE EXISTING HANDRAIL AND REPLACE WITH A CONCRETE PARAPET RETROFIT
 - 5.) CONSTRUCT PARTIAL AND FULL DEPTH DECK SLAB REPAIRS
 - 6.) REMOVE EXISTING TRANSVERSE JOINTS
 - 7.) INSTALL PROPOSED PREFORMED JOINT SEAL OR NEOPRENE JOINTS
 - 8.) PLACE PROPOSED MICROSILICIA CONCRETE BRIDGE DECK OVERLAY 2 1/2"

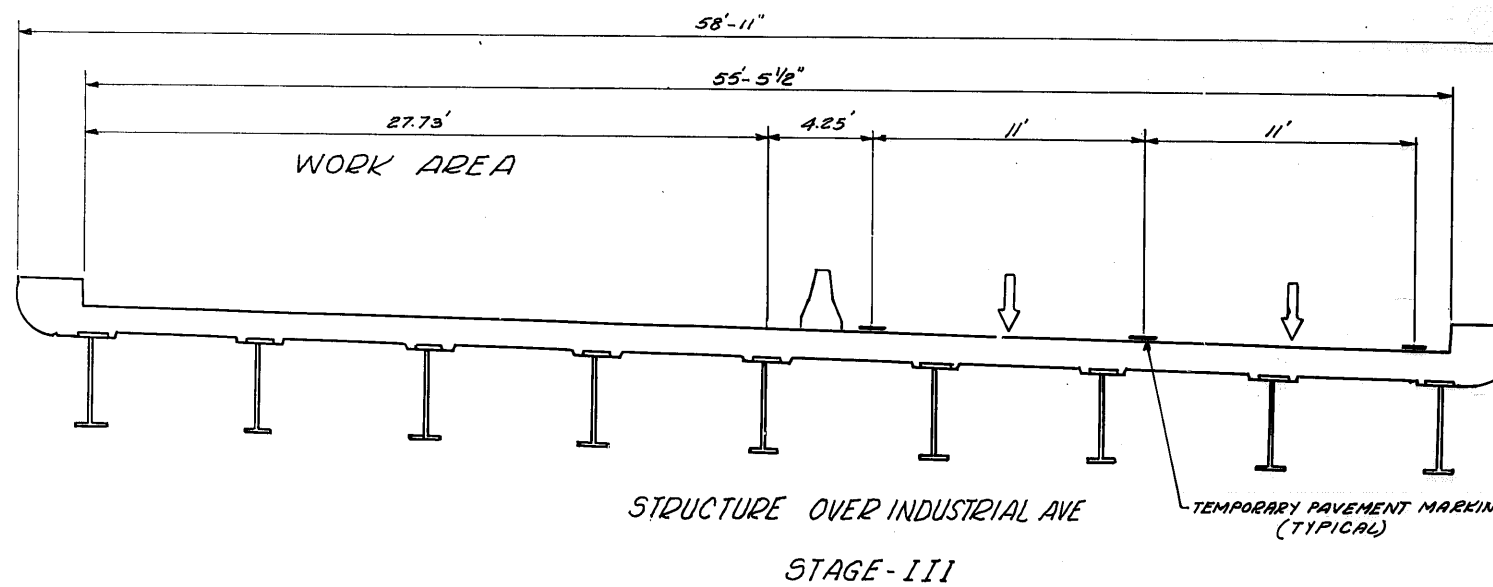

- STAGE III
- 1.) RELOCATE ALL TRAFFIC CONTROL AND REROUTE TRAFFIC TO INSIDE LANES
 - 2.) REMOVE EXISTING BRIDGE DECK BITUMINOUS OVERLAY 1 1/2"
 - 3.) SCARIFY BRIDGE DECK SLAB 1/2"
 - 4.) REMOVE EXISTING HANDRAIL AND REPLACE WITH A CONCRETE PARAPET RETROFIT.
 - 5.) CONSTRUCT PARTIAL AND FULL DEPTH DECK SLAB REPAIRS
 - 6.) REMOVE EXISTING TRANSVERSE JOINTS
 - 7.) INSTALL PROPOSED PREFORMED JOINT SEAL OR NEOPRENE JOINTS
 - 8.) PLACE PROPOSED MICROSILICIA CONCRETE BRIDGE DECK OVERLAY 2 1/2"

REVISIONS	
NAME	DATE

ILLINOIS DEPARTMENT OF TRANSPORTATION
 ILLINOIS ROUTE-53
 (SOUTHBOUND)
 TYPICAL STAGING CROSS SECTION
 STRUCTURE OVER INDUSTRIAL AVE.
 STRUCTURE NO. 016-1120

SCALE: VERT. _____
 HORIZ. _____

DATE _____ DRAWN BY: BGM
 CHECKED BY: RY

