

FOR INDEX OF SHEETS, SEE SHEET NO. 2

1. ILL. RTE. 53 (N.B.) OVER ILL. RTE. 62 SN-016-0378
INCLUDES ONE 4 SPAN CONTINUOUS R.C. SLAB STRUCTURE WITH STEEL GIRDERS ON CONCRETE PIERS AND ABUTMENTS AT STA. 119+77.27
2 SPANS AT 41'-3", 1 AT 38'-2" AND 1 AT 36'-8".
2. ILL. RTE. 53 (S.B.) OVER ILL. RTE. 62 SN-016-2133
INCLUDES ONE 4 SPAN CONTINUOUS R.C. SLAB STRUCTURE WITH STEEL GIRDERS ON CONCRETE PIERS AND ABUTMENTS AT STA. 119+77.27
2 SPANS AT 41'-3", 1 AT 38'-2" AND 1 AT 36'-8".
3. ILL. RTE. 53 OVER SALT CREEK SN-016-0377
INCLUDES ONE 63'-3" SPAN CONTINUOUS R.C. SLAB STRUCTURE WITH PRESTRESSED CONCRETE BEAMS ON CONCRETE ABUTMENTS AT STA. 142+20
4. ILL. RTE. 53 (N.B.) OVER KIRCHOFF RD. SN-016-0376
INCLUDES ONE 3 SPAN CONTINUOUS R.C. SLAB STRUCTURE WITH STEEL GIRDERS ON CONCRETE PIERS AND ABUTMENTS AT STA. 193+08.37
2 SPANS AT 42'-9" AND 1 AT 110'-3".
5. ILL. RTE. 53 (S.B.) OVER KIRCHOFF RD. SN-016-1121
INCLUDES ONE 3 SPAN CONTINUOUS R.C. SLAB STRUCTURE WITH STEEL GIRDERS ON CONCRETE PIERS AND ABUTMENTS AT STA. 193+08.37
2 SPANS AT 42'-9" AND 1 AT 110'-3".
6. ILL. RTE. 53 (N.B.) OVER INDUSTRIAL AVE. SN-016-0375
INCLUDES ONE 3 SPAN CONTINUOUS R.C. SLAB STRUCTURE WITH STEEL GIRDERS ON CONCRETE PIERS AND ABUTMENTS AT STA. 243+49.94
2 SPANS AT 45'-2" AND 1 AT 59'-2".
7. ILL. RTE. 53 (S.B.) OVER INDUSTRIAL AVE. SN-016-1120
INCLUDES ONE 3 SPAN CONTINUOUS R.C. SLAB STRUCTURE WITH STEEL GIRDERS ON CONCRETE PIERS AND ABUTMENTS AT STA. 243+49.94
2 SPANS AT 45'-2" AND 1 AT 59'-2".

STATE OF ILLINOIS
DEPARTMENT OF TRANSPORTATION
DIVISION OF HIGHWAYS
PLANS FOR PROPOSED
FEDERAL AID HIGHWAY

SCALES
PLAN
PROFILE HORIZ.
PROFILE VERT.
CROSS SECTIONS

F.A. 342 (ILL. RTE. 53)
SECTION 531(1&2)RS-1(89) & 1989-107BR
ILL. RTE. 62 TO U.S. RTE. 14
RESURFACING AND BRIDGE DECK REHABILITATION
COOK COUNTY
C-91-255-90

FAP RTE	SECTION	COUNTY	TOTAL SHEET NO.
342		COOK	271
PROJECT			1

531(1&2)RS-1(89) & 1989-107BR

D-91-475-89



DESIGN DESIGNATION
9630(10) TRUNK 5.5(B-20)

STATE OF ILLINOIS
DEPARTMENT OF TRANSPORTATION
DIVISION OF HIGHWAYS

SUBMITTED January 2, 1991 BY [Signature] DISTRICT ENGINEER

EXAMINED Jan 25, 1991 BY [Signature] CHIEF ENGINEER

PASSED Jan 25, 1991 BY [Signature] DIVISION OF PLANS AND CONTRACTS

APPROVED Jan 25, 1991 BY [Signature] CHIEF OF BUREAU

CAPITAL PROJECTS DIVISION

PRINTED BY AUTHORITY OF THE
STATE OF ILLINOIS

FOR J.U.L.I.E. INFORMATION CALL 1-800-892-0123

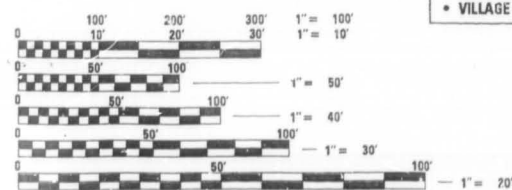

FULL SIZE PLANS HAVE BEEN PREPARED USING STANDARD ENGINEERING SCALES. REDUCED SIZED PLANS WILL NOT CONFORM TO STANDARD SCALES. IN MAKING MEASUREMENTS ON REDUCED PLANS, THE ABOVE SCALES MAY BE USED.

CONTRACT NO. 80797

PROJECT LOCATED IN:
• VILLAGE OF ROLLING MEADOWS
• VILLAGE OF ARLINGTON HEIGHTS

BEGINNING OF IMPROVEMENT
STA. 116+00

END OF IMPROVEMENT
STA. 267+02

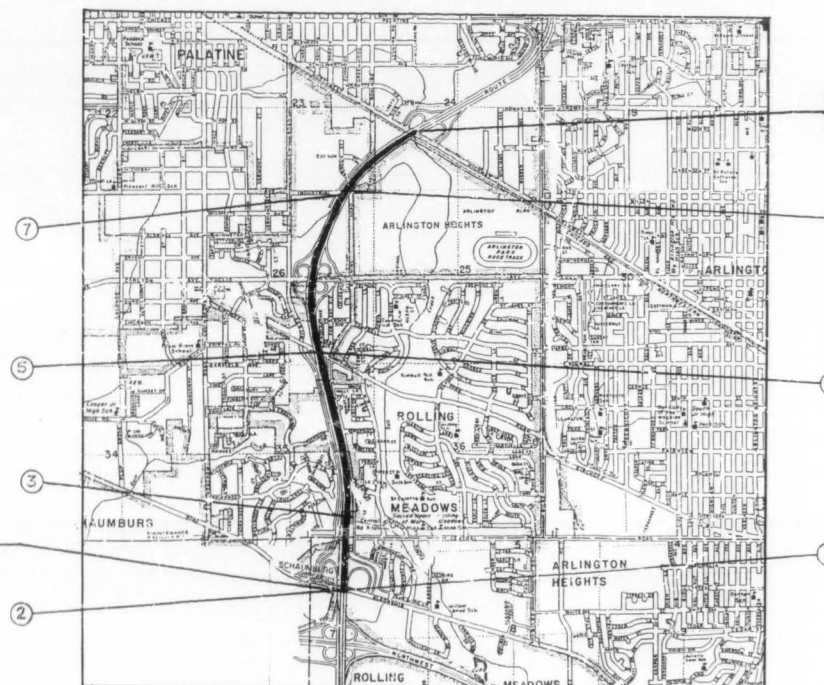

NET LENGTH OF IMPROVEMENT = 15,102 LIN. FT. = 2.860 MI.
GROSS LENGTH OF IMPROVEMENT = 15,102 LIN. FT. = 2.860 MI.

PLAN PREPARATION ENGINEER
L. SORENSON, J.M. DEYONG (708) 705-4432

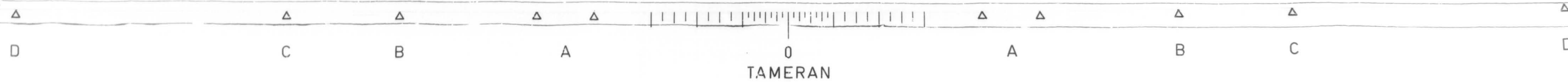

SECTION	COUNTY	TOTAL SHEETS	SHEET NO.
392	COOK	271	2
STA.	TO STA.		
FSD ROAD DIST NO. 1 ILLINOIS		TOD AID PROJECT	

*531(162)RS-1189)E1989-107 BR

INDEX OF SHEETS

SHEET NO.	DESCRIPTION		
1	TITLE SHEET	⊕ 158-179	SURVEILLANCE
2	INDEX OF SHEETS, STATE STANDARDS AND PLAN NOTES	180	LOG SYSTEM DETAIL
3-7	SUMMARY OF QUANTITIES	* 181-185	APPROACH SLAB AND SHOULDER PAVEMENT DETAILS
① 8-11	TYPICAL CROSS SECTIONS	186	BRIDGE APPROACH SHOULDER PAVEMENT
12-24	PLAN - MAINLINE	187-193	BRIDGE PLANS - ALGONQUIN ROAD (NB)
25-34	PLAN - RAMPS	△ ± 194-200	BRIDGE PLANS - ALGONQUIN ROAD (SB)
35-38	BARRIER WALL DETAILS	201-208	BRIDGE PLANS - SALT CREEK
39	IMPACT ATTENUATOR & CORRUGATED BITUMINOUS SHOULDER DETAILS	209-215	BRIDGE PLANS - KIRCHOFF ROAD (NB)
40	EUCLID AVENUE RECONSTRUCTION PROFILE	216-222	BRIDGE PLANS - KIRCHOFF ROAD (SB)
41-48	BARRIER WALL PROFILE	223-228	BRIDGE PLANS - INDUSTRIAL AVENUE (NB)
49-61	DRAINAGE AND UTILITIES - MAINLINE	229-234	BRIDGE PLANS - INDUSTRIAL AVENUE (SB)
62-66	DRAINAGE AND UTILITIES - RAMPS	235	NEOPRENE JOINT DETAIL
67-68	CATCH BASIN AND INLET DETAILS	236	RETROFIT CONCRETE PARAPET DETAIL
69-77	TYPICAL CROSS SECTIONS - STAGING	237	BAR SPLICER DETAIL
78-92	SUGGESTED STAGES OF CONSTRUCTION	238-241	CROSS SECTIONS - UNDER EUCLID AVENUE
93	TEMPORARY INFORMATIONAL SIGNING - FOR STAGING	242-244	CROSS SECTIONS - COLLECTOR DISTRIBUTOR MEDIAN (NB)
94	TEMPORARY CONCRETE BARRIER WITH IMPACT ATTENUATOR	245-247	CROSS SECTIONS - COLLECTOR DISTRIBUTOR (SB)
95-97	LANE CLOSURES - FREEWAY STANDARDS	248-262	CROSS SECTIONS - CENTERLINE MEDIAN
98	RAMP CLOSURES - DETAIL	263-264	CROSS SECTIONS - DITCH REGRADING
99	TEMPORARY PAVEMENT MARKING - LETTERS AND SYMBOLS	265-271	DISTRICT DETAILS
100	TRAFFIC CONTROL - SIDEROADS, INTERSECTIONS, AND DRIVEWAYS	⊕ INCLUDES 169A * INCLUDES 181A ± INCLUDES 199A, 199B	
101-106	SIGN TRUSS PLAN AND DETAILS		
107	TEMPORARY INFORMATION SIGNING - SIGN TRUSS REMOVAL		
108-121	PAVEMENT MARKING		
122-148	TRAFFIC SIGNING STRUCTURES		
149-157	ELECTRICAL PLAN AND DETAILS		

LIST OF STATE STANDARDS

STANDARD #	DESCRIPTION
2149-11	DELINEATORS
2213-4	FRAME AND LIDS, TYPE 1
2225-9	REINFORCEMENT FOR CONTINUOUSLY REINFORCED P.C.C. PAVEMENT
2228-4	METAL END SECTION FOR PIPE CULVERTS
2230-16	STEEL PLATE BEAM GUARDRAIL
2233-12	36' CONTINUOUSLY REINFORCED P.C.C. PAVEMENT
2237-11	B.A.M. SHOULDER DETAILS - ADJACENT TO RIGID PAVEMENT
2298-8	TYPICAL APPLICATION OF TRAFFIC CONTROL DEVICES
2299-11	DESIGN OF TRAFFIC CONTROL DEVICES
2300-3	FLAGMAN TRAFFIC CONTROL SIGN
2307-6	TYPICAL APPLICATION OF TRAFFIC CONTROL DEVICES SHORT-TIME OPERATION, DAY OR NIGHT
2308-5	TYPICAL APPLICATION OF TRAFFIC CONTROL DEVICES RURAL, DAY OR NIGHT, MOVING OPERATIONS
2314-5	TYPICAL APPLICATION OF TRAFFIC CONTROL DEVICES MULTILANE DIV. AND UNDIV., RURAL, DAY OR NIGHT
2316-12	TYPICAL APPLICATION OF TRAFFIC CONTROL DEVICES MULTILANE DIV. AND UNDIV., RURAL, OVER ONE DAY
2323-11	PAVEMENT JOINTS
2324-7	BRIDGE APPROACH SHOULDER PAVEMENT
2326-3	TRAFFIC BARRIER TERMINAL, TYPE 10
2327-11	SUB-SURFACE DRAINS
2333-3	CONCRETE BARRIER
2336-4	TRAFFIC BARRIER TERMINAL, TYPE 1 AND 1A
2337-2	TRAFFIC BARRIER TERMINAL, TYPE 2
2338-2	TRAFFIC BARRIER TERMINAL, TYPE 3 & 3A
2340-4	TRAFFIC BARRIER TERMINAL, TYPE 5 & 5A
2341-3	TRAFFIC BARRIER TERMINAL, TYPE 6
2360-4	BRIDGE APPROACH PAVEMENT (50 FT.)
2362-3	CONCRETE HEADWALL FOR PIPE DRAINS
2381	TEMPORARY EROSION CONTROL SYSTEMS
2383-1	TEMPORARY CONCRETE BARRIER
2385	FRAME AND GRATE, TYPE 20
2386	FRAME AND GRATE, TYPE 21
2387	FRAMES AND GRATES, TYPE 22
2419	TYPICAL APPLICATION OF TRAFFIC CONTROL DEVICES MULTILANE DIVIDED AND UNDIVIDED RURAL, DAY OR NIGHT OPERATIONS
2425-1	CLASS A PATCHES
2427-1	CLASS C AND D PATCHES
U-2	TYPICAL APPLICATION OF TRAFFIC CONTROL DEVICES
U-4	TYPICAL APPLICATION OF TRAFFIC CONTROL DEVICES
2429	CONCRETE SHOULDERS

PLAN NOTES

BEFORE STARTING ANY EXCAVATION, THE CONTRACTOR SHALL CALL "JULIE" AT 800-892-0123 OR "DIGGER" (CHICAGO UTILITY ALERT NETWORK), (312)774-7000 FOR FIELD LOCATIONS OF BURIED ELECTRIC, TELEPHONE AND GAS FACILITIES. (48 HOURS NOTIFICATION IS REQUIRED).

THE CONTRACTOR SHALL COORDINATE CONSTRUCTION ACTIVITIES WITH UTILITY COMPANIES AND THE CITY OF CHICAGO.

THE CONTRACTOR WILL NOT BE ALLOWED TO SET UP A YARD OR FIELD OFFICE ON STATE PROPERTY WITHOUT WRITTEN PERMISSION FROM THE DEPARTMENT.

THE REMOVAL OF GUARDRAIL TERMINAL SECTIONS SHALL BE INCLUDED IN THE UNIT PRICE PER LINEAL FOOT FOR STEEL PLATE BEAM GUARD RAIL REMOVAL.

BARRICADES: THE CONTRACTOR SHALL PROVIDE AND INSTALL TWO (2) WEIGHTED SAND BAGS ON EACH TYPE I OR TYPE II BARRICADE USED. (ONE (1) WEIGHTED SAND BAG ACROSS EACH BOTTOM RAIL).

WHEN ARTIFICIAL LIGHTING IS UTILIZED IN NIGHT OPERATIONS THE CONTRACTOR SHALL EXERCISE THE UTMOST PRECAUTIONS IN PREVENTING ADVERSE VISIBILITY TO THE MOTORING PUBLIC AND ADJOINING RESIDENTIAL AREAS.

① INCLUDES 10A

ILLINOIS DEPARTMENT OF TRANSPORTATION
INDEX OF SHEETS,
PLAN NOTES
AND
STATE STANDARDS

REVISIONS	
NAME	DATE

SCALE: VERT. DRAWN BY
HORIZ. CHECKED BY PV
DATE

Rev 2-6-91

Rev



TAMERAN

DARCOBY

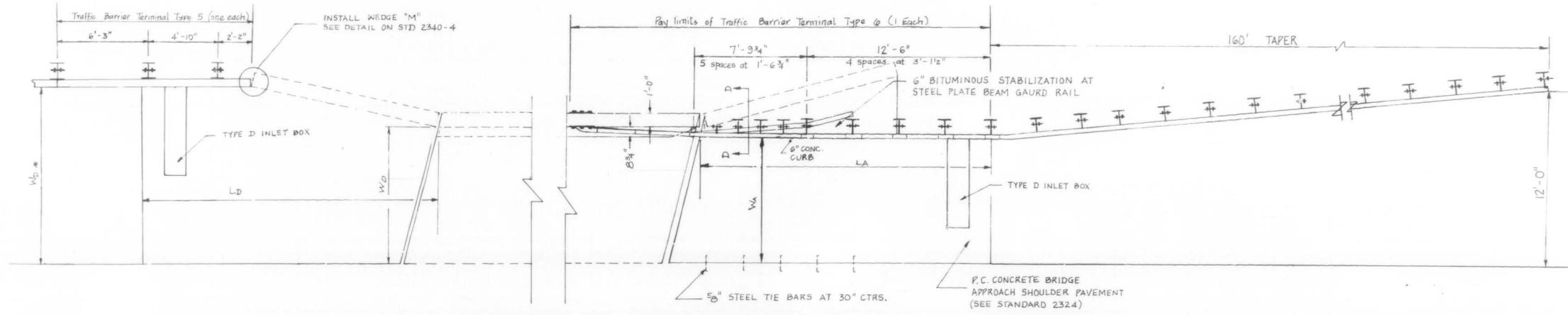

OUTSIDE SHOULDER APPROACH DETAIL (TYPE 5)

ANDERSON NB/SB NORTHWEST SB
 PALATINE SB SALT CREEK NB/SB

P.C. CONCRETE BRIDGE APPROACH SHOULDER PAVEMENT STANDARD 2324

NOTE:
 TYPE D INLET BOX IS NOT REQUIRED

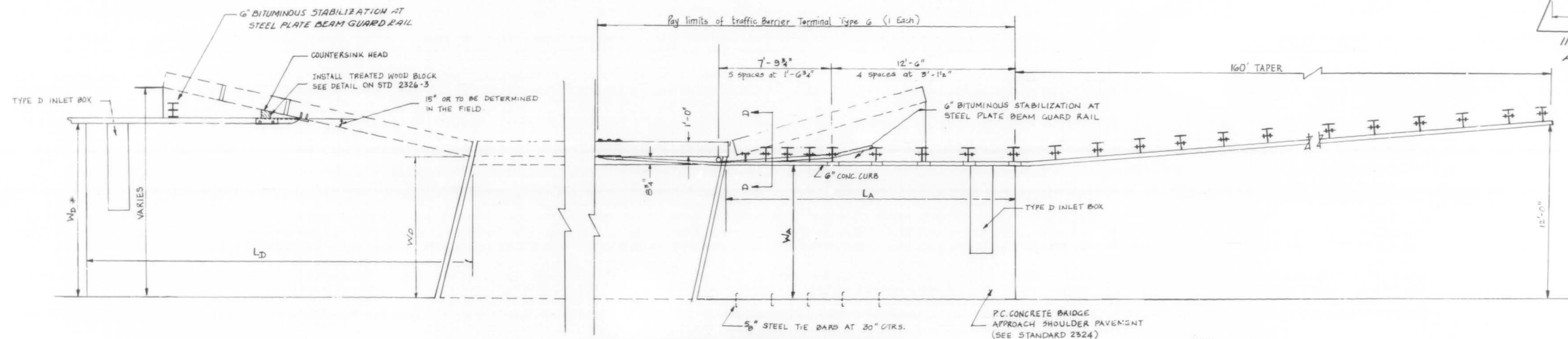
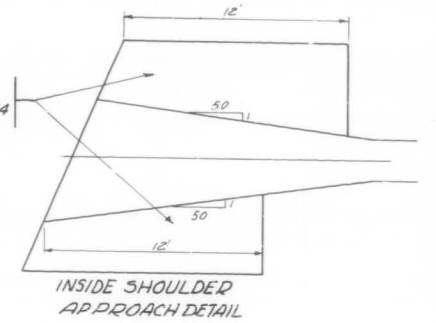

OUTSIDE SHOULDER APPROACH DETAIL (TYPE 10)

PALATINE NB KIRCHHOFF NB/SB
 NORTHWEST NB ALGONQUIN NB/SB
 INDUSTRIAL NB/SB

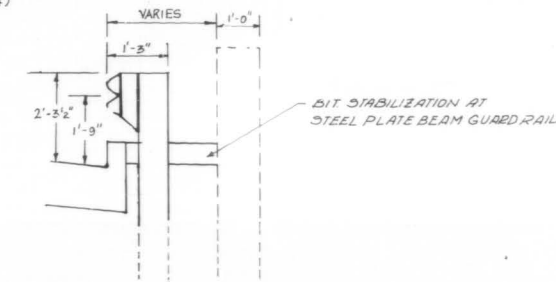

SECTION D-D

NORTHBOUND

	W _A	W _D	L _A	L _D	W _D #
ALGONQUIN RD.	9.3'	10.4'	19'-6 3/4"	15.0'	12.0'
SALT CREEK	9.3'	9.7'	19'-6 3/4"	12.1'	9.7'
KIRCHHOFF RD.	12.0'	12.8'	19'-6 3/4"	14.0'	12.8'
INDUSTRIAL AVE.	9.7'	11.1'	19'-6 3/4"	17.5'	12.0'
NORTHWEST HWY.	9.3'	10.75'	19'-6 3/4"	19.2'	12.0'
PALATINE RD.	8.3'	8.5'	19'-6 3/4"	19.1'	12.0'
ANDERSON	9.3'	10.3'	19'-6 3/4"	12.0'	10.3'

SOUTHBOUND

	W _A	W _D	L _A	L _D	W _D #
ALGONQUIN RD.	9.3'	10.4'	19'-6 3/4"	15.2'	12.0'
SALT CREEK	9.3'	9.9'	19'-6 3/4"	12.0'	9.9'
KIRCHHOFF RD.	12.0'	12.2'	19'-6 3/4"	14.0'	12.2'
INDUSTRIAL AVE.	9.7'	12.9'	19'-6 3/4"	14.0'	12.0'
NORTHWEST HWY.	9.3'	10.1'	19'-6 3/4"	19.5'	11.8'
PALATINE RD.	5.6'	5.6'	19'-6 3/4"	19.2'	8.5'
ANDERSON	9.3'	10.2'	19'-6 3/4"	12.0'	10.2'

REVISIONS	
NAME	DATE

ILLINOIS DEPARTMENT OF TRANSPORTATION
 ILLINOIS ROUTE-53

**PC CONCRETE BRIDGE
 APPROACH SHOULDER PAVT (SPECIAL)**

SCALE: VERT. DRAWN BY
 HORIZ. CHECKED BY
 DATE



EXISTING BRIDGE DESCRIPTION
 THE BRIDGE CONSIST OF A 3 SPAN CONTINUOUS WIDE FLANGE BEAM STRUCTURE WITH 2 SPANS AT 45'-2" AND 1 AT 59'-2" ON OPEN R.C. ABUTMENTS AND R.C. PIERS. THE 7" THICK CONCRETE DECK HAS A 2" THICK BITUMINOUS CONCRETE OVERLAY.

P.A.P. NO.	SECTION	COUNTY	TOTAL SHEETS	SHEET NO.
342	*	COOK	271	229
STA.	TO STA.			
FED. ROAD DIST. NO.	ILLINOIS	FED. AID PROJECT		

* 531 (1 & 2)RS-1189 & 1989-107BR
 SHEET 1 OF 6

INDEX OF SHEETS

- 1) PLAN AND ELEVATION
- 2) GENERAL NOTES AND SUMMARY OF QUANTITIES
- 3) DECK DETAILS
- 4) DELAMTECT AND BOTTOM DECK SURVEY
- 5) JOINT RECONSTRUCTION DETAIL
- 6) STAGING CROSS SECTION DETAIL

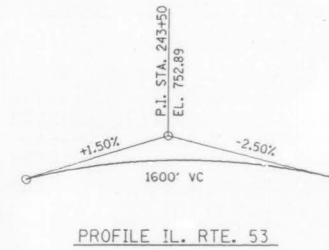
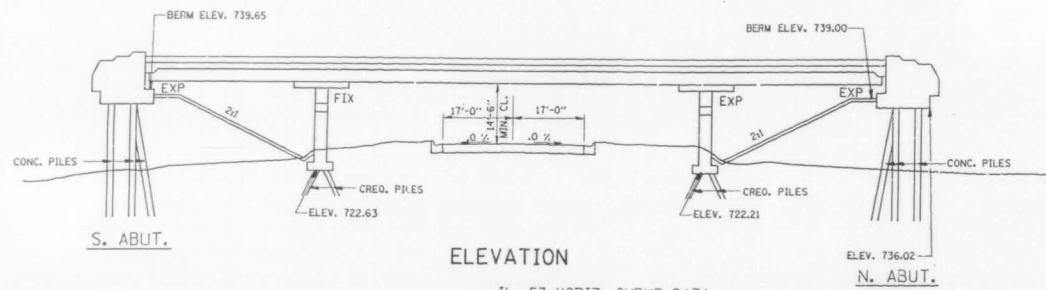

IL. 53 HORIZ. CURVE DATA
 P.I. STA= 236+37.28 E= 1677.02
 $\Delta = 77^\circ 11' 38''$ P.C. STA= 188+48.07
 $D = 0^\circ 57' 17.8''$ P.T. STA= 269+31.79
 $R = 6000'$
 $T = 4789.21'$
 $L = 8083.72'$

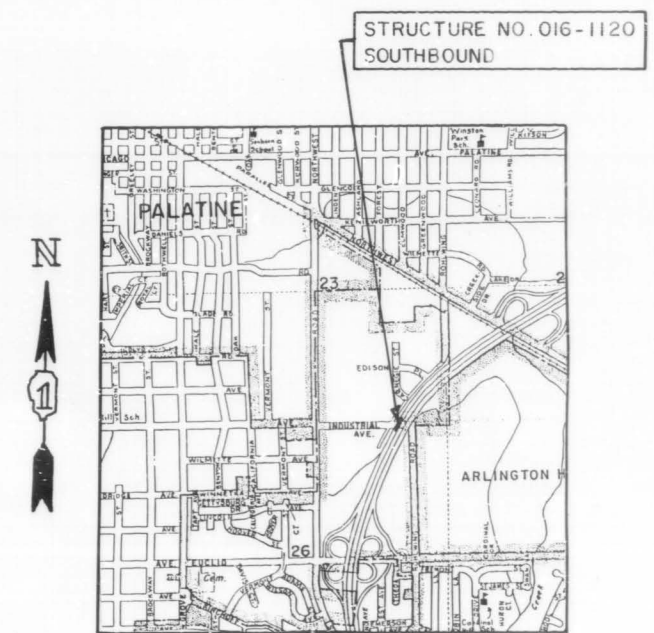
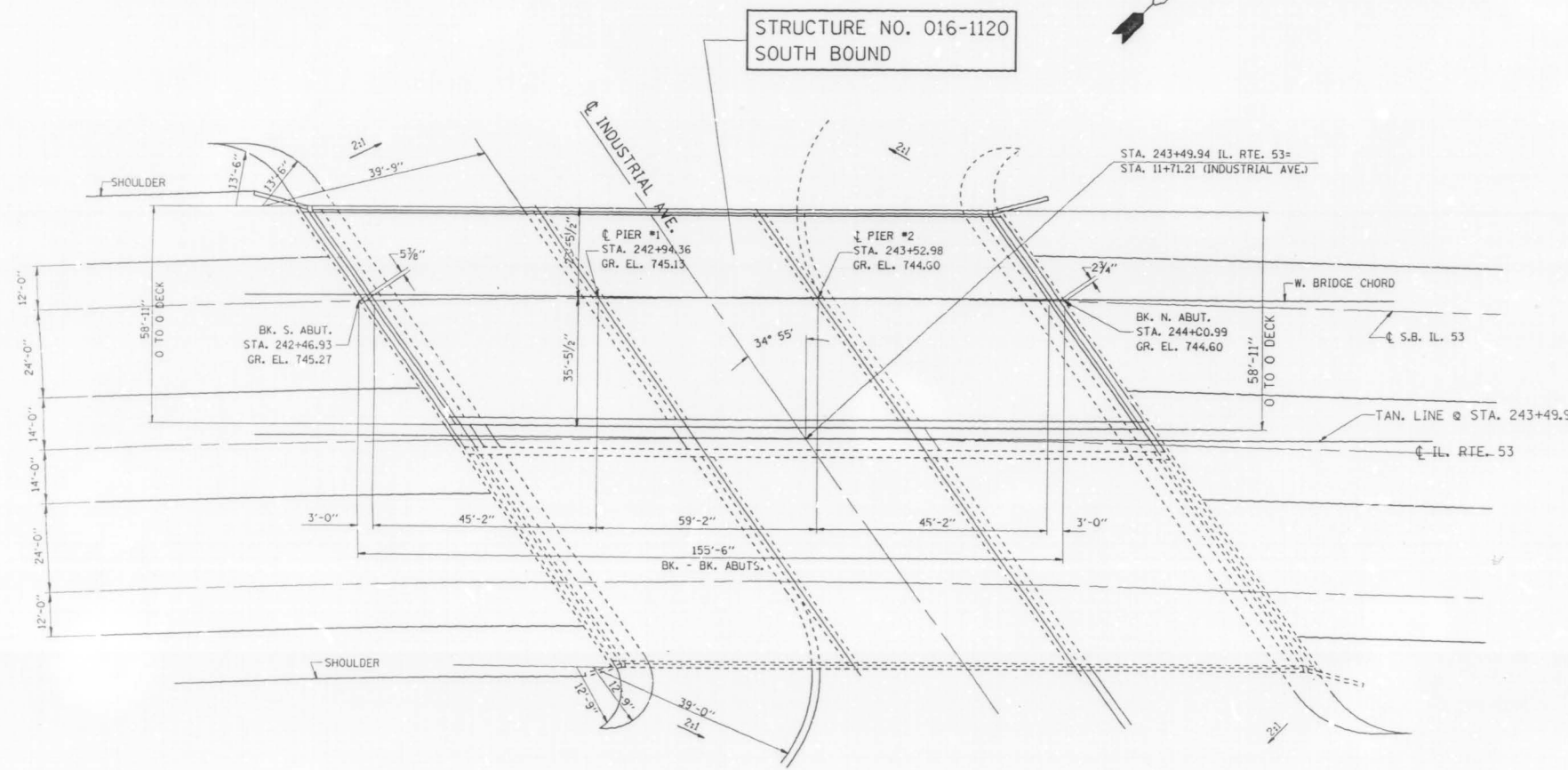

ILLINOIS DEPARTMENT OF TRANSPORTATION

IL. RTE. 53 @ INDUSTRIAL AVE. S.B.
 BRIDGE REHABILITATION
 STRUCTURE NO. 016-1120
 PLAN & ELEVATION

REVISIONS	
NAME	DATE

SCALE: VERT. NONE
 HORIZ. DATE 10/23/90

DRAWN BY
 CHECKED BY

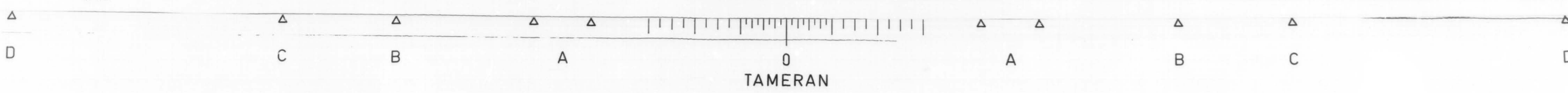

11-OCT-90 19:31:08 (CREATED)
 ZF6d110c403d11758992.dwg
 LEVELS = 35

VI--BR5

NOTES:

1. ~~The Zinc-silicate and vinyl paint system shall be used for shop and field painting of Structural Steel except where otherwise noted. The color of the vinyl finish coat shall be Munsell No. 7.5G 4/B.~~
2. All structural steel shall be AASHTO M 222 except expansion joint plates and attached bars which shall be AASHTO M 183.
- 2A. *Deck Repair Method D shall be used for this structure (See Spec Prov.)*
3. Expansion joint plates and attached bars shall be shop painted with the zinc-silicate primer.
4. ~~AASHTO M 222 structural steel shall not be painted except, that for a distance of three times the depth of the beams or girders (but not exceeding 10 feet) each way from deck joints, the AASHTO M 222 structural steel shall be cleaned and given one coat of the zinc-silicate primer and a dark maroon vinyl finish coat. The color of the finish coats shall be Munsell No. 2.5 R 3/4 reddish brown. Both coats may be applied in the shop with spot painting only in the field.~~
5. The structural steel bearing plates of the Elastomeric Bearing Assembly shall conform to the requirements of AASHTO M 223 Grade 50 (AASHTO M 222).
6. Reinforcement bars shall conform to the requirements of AASHTO M-31, M-42 or M-53 Grade 60.
7. Plan dimensions and details relative to existing structure have been taken from existing plans and are subject to nominal construction variations. It shall be the Contractor's responsibility to verify such dimensions and details in the field and make necessary approved adjustments prior to construction or ordering of materials. Such variations shall not be cause for additional compensation for a change in the scope of the work, however, the Contractor will be paid for the quantity actually furnished at the unit price bid for the work.
8. ~~All accessible end areas of steel beams, exposed top of steel beams, end diaphragms, and bearings designated by the Engineer for painting shall be cleaned by Method 1. The three coat lead and chromate free alkyd paint system shall be applied over all cleaned areas, except the exposed top of steel beams to be embedded in concrete shall receive only one coat of the primer of this system. The color of the final finish coat shall be INTERSTATE GREEN. This work will be paid for in accordance with Article 109.04 of the Standard Specifications.~~

TOTAL BILL OF MATERIALS



ITEM	UNIT	TOTAL
BITUMINOUS CONCRETE REMOVAL (DECK)	SQ. YD.	935
CONCRETE BRIDGE DECK SCARIFICATION, 1/2"	SQ. YD.	935
DECK SLAB REPAIR (PARTIAL DEPTH)	SQ. YD.	25
DECK SLAB REPAIR (FULL DEPTH)	SQ. YD.	30
CONCRETE REMOVAL, SPECIAL	CU. YD.	18.4
HANDRAIL REMOVAL	LIN. FT.	304
NEOPRENE JOINT, 2"	LIN. FT.	152
REINFORCEMENT BARS, EPOXY COATED	POUND	2866
CLASS X CONCRETE SUPERSTRUCTURE	CU. YD.	208
MICROSILICIA CONCRETE BRIDGE DECK OVERLAY 2 1/2"	SQ. YD.	935
PROTECTIVE COAT	SQ. YD.	570
PROTECTIVE SHIELD	SQ. YD.	365
CONCRETE PARAPET RETROFIT	LIN. FT.	304
FURNISHING AND ERECTING STRUCTURAL STEEL	POUND	0
SAWING PG. CONCRETE PAVEMENT, 3/4"	LIN. FT.	397

REVISIONS	
NAME	DATE

DEPARTMENT OF TRANSPORTATION
 IL RTE 53 @ INDUSTRIAL AVE.
 (SOUTHBOUND LANES)
 GENERAL NOTES
 AND
 BILL OF MATERIALS
 S.N. 016-1120
 DATE _____
 CHECKED BY R.V.



LEGEND

-  DECK SLAB REPAIR (PARTIAL DEPTH) SEE DELANTEC SHEET No. 4
-  DECK SLAB REPAIR (FULL DEPTH) SEE BOTTOM DECK SURVEY SHEET No. 4
-  CONCRETE TO BE REMOVED

REMOVE 2' OF PARAPET AND 2' OF WINGWALL, TYPICAL AT ALL FOUR LOCATIONS. DETAILS ARE AVAILABLE IN THE I.D.O.T. DISTRICT 1 BUREAU OF DESIGN AND WILL BE PROVIDED AT THE PRECONSTRUCTION MEETING. QUANTITIES ARE INCLUDED IN THE PLANS.

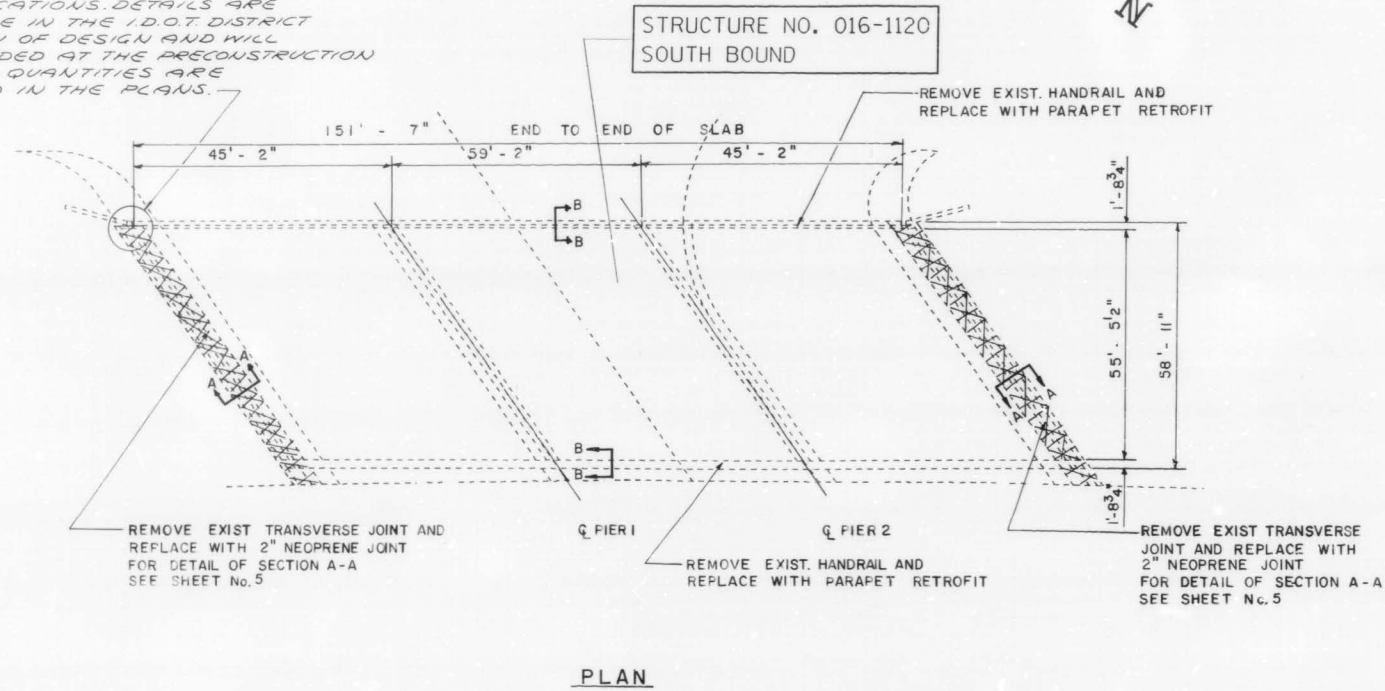

BILL OF MATERIALS			QUANTITIES
ITEM	UNIT	TOTAL	
BITUMINOUS CONCRETE REMOVAL (DECK)	SQ. YD.	935	
CONCRETE BRIDGE DECK SCARIFICATION, 1/2"	SQ. YD.	935	
DECK SLAB REPAIR (PARTIAL DEPTH)	SQ. YD.	11	
DECK SLAB REPAIR (FULL DEPTH)	SQ. YD.	15	
MICROSILICIA CONCRETE BRIDGE DECK OVERLAY, 2 1/2"	SQ. YD.	935	
PROTECTIVE COAT	SQ. YD.	395	
PROTECTIVE SHIELD	SQ. YD.	365	
PARAPET RETROFIT	LIN. FT.	304	
HANDRAIL REMOVAL	LIN. FT.	304	

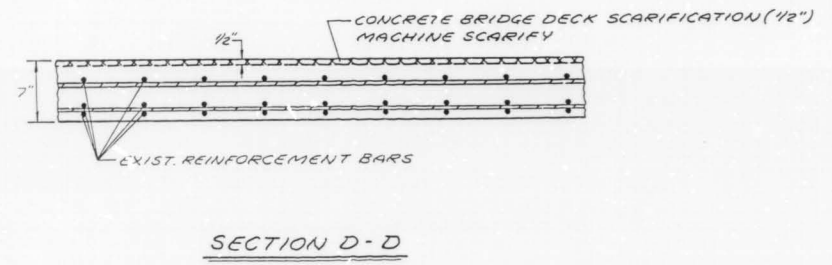
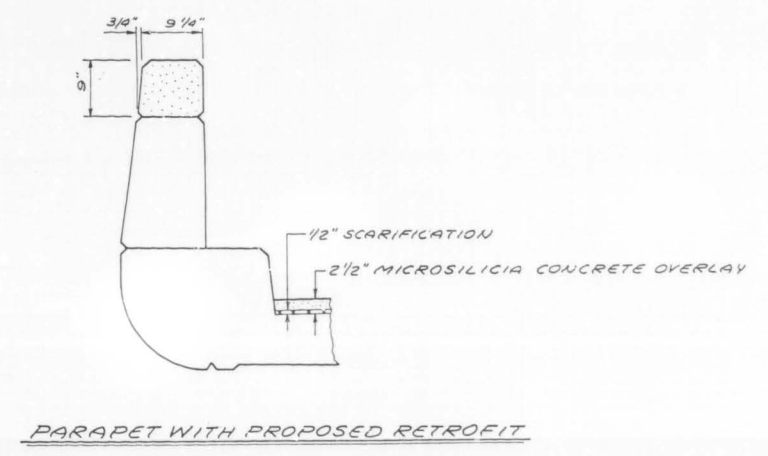
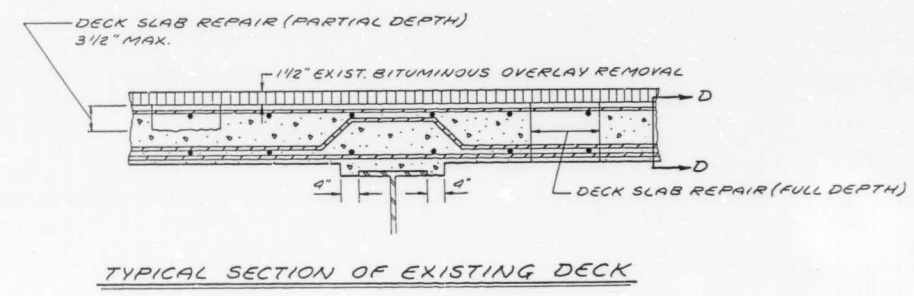
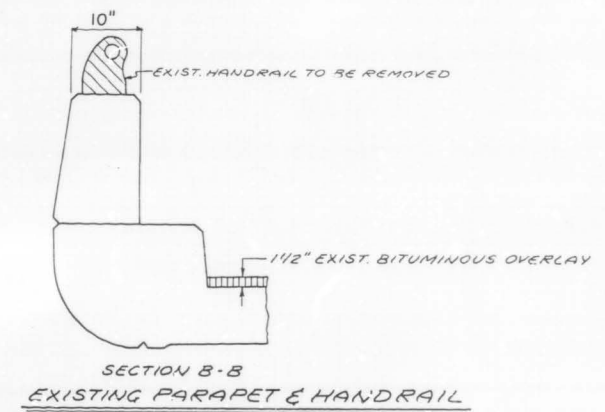

REVISIONS	
NAME	DATE

ILLINOIS DEPARTMENT OF TRANSPORTATION
 IL. RTE. 53 @ INDUSTRIAL AVE. S.B.
 BRIDGE REHABILITATION
 STRUCTURE NO. 016-1120
 DECK DETAILS

SCALE: VERT. _____
 HORIZ. _____
 DATE 10/23/90

DRAWN BY _____
 CHECKED BY _____



ROUTE	SECTION	COUNTY	TOTAL SHEETS	SHEET NO.
342	*	COOK	271	232
STA.		TO STA.		
FED. ROAD DIST. NO. 7		ILL. AID	FED. AID PROJECT	

* 531(1/2)RS-1(89) 1989-107BR
SHEET 4 OF 6

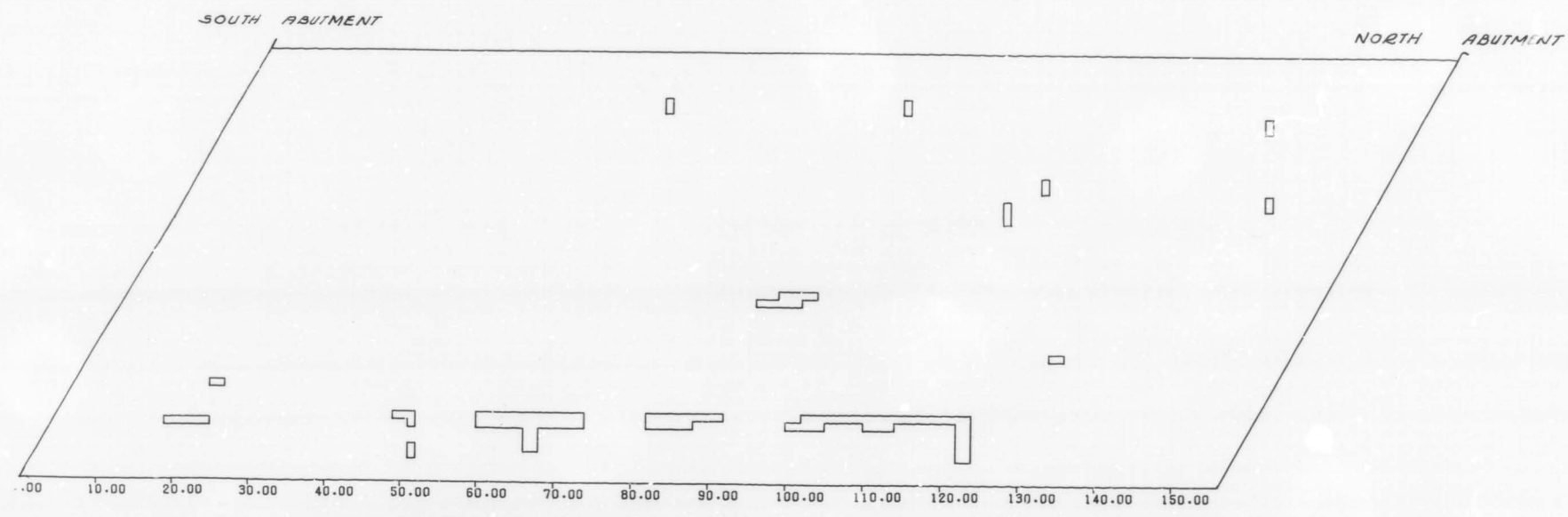

SCALE: HORIZONTAL 1" = 10'
VERTICAL 1" = 10'

BRIDGE: 016 1120
DATE: 6/11/90
OPERATOR: MATECHICK SKEW 54-35'
COMMENTS: 53SB/INDUSTRIAL

ROADWAY AREA: 935 SY
DELAMINATED AREA: 11 SY
% DELAMINATED: 1 %

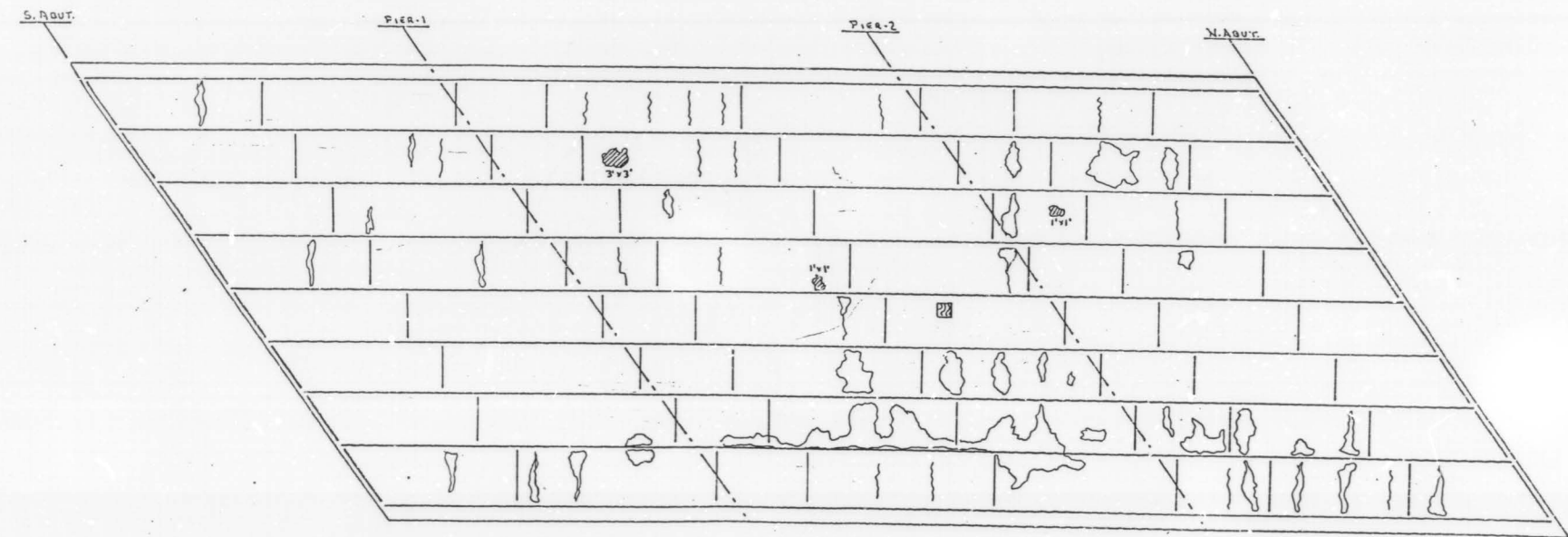

NOTE:
 SPALL AREA = 11 SQ. FT.
 WOOD FORM (1'-1")
 LEACHING AREA
 LEACHING CRACKS

BRIDGE: ILL 53 SB/INDUSTRIAL AVE
BRIDGE No. 016-1120 '215
BOTTOM DECK SURVEY
FIELD DATA NM DATE 3/6/90
DRAWN BY NM DATE 3/13/90

REVISIONS	
NAME	DATE

DEPARTMENT OF TRANSPORTATION
 ILL. RTE. 53 @ INDUSTRIAL AVE. S.B.
 BRIDGE REHABILITATION
 STRUCTURE NO. 016-1120
 DELAMTEC AND BOTTOM DECK SURVEY
 DATE
 CHECKED BY

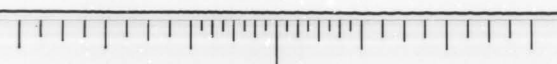

TAMERAN

△ D △ C △ B △ A △ 0 △ A △ B △ C △ D

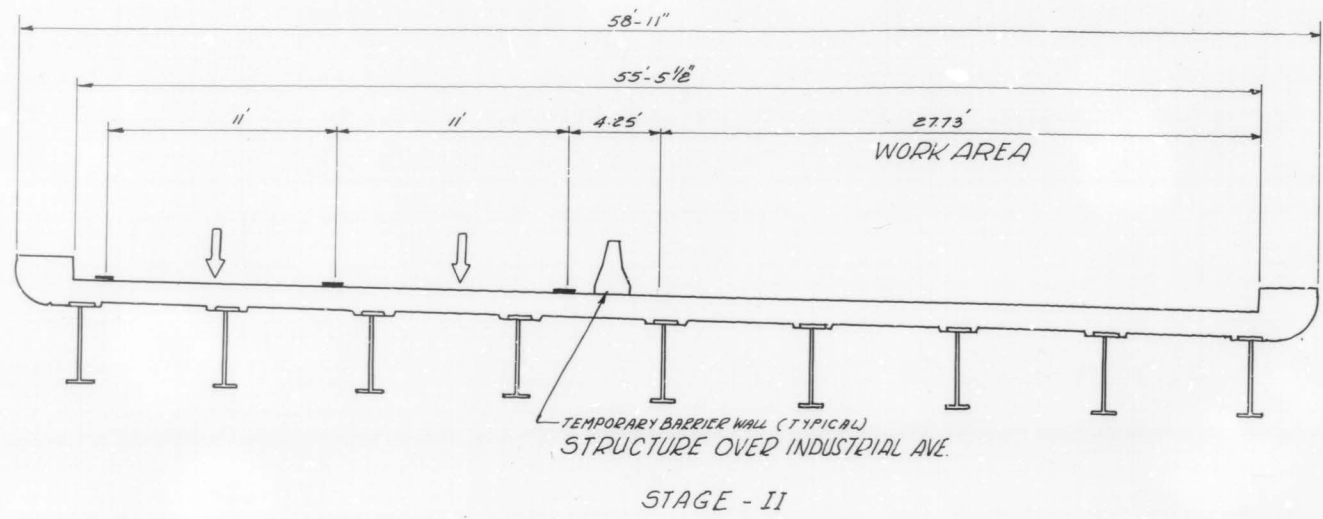

- STAGE II
- 1.) PLACE ALL TRAFFIC CONTROL AND REROUTE TRAFFIC TO OUTSIDE LANES
 - 2.) REMOVE EXISTING BRIDGE DECK BITUMINOUS OVERLAY 1 1/2"
 - 3.) SCARIFY BRIDGE DECK SLAB 1/2"
 - 4.) REMOVE EXISTING HANDRAIL AND REPLACE WITH A CONCRETE PARAPET RETROFIT
 - 5.) CONSTRUCT PARTIAL AND FULL DEPTH DECK SLAB REPAIRS
 - 6.) REMOVE EXISTING TRANSVERSE JOINTS
 - 7.) INSTALL PROPOSED PREFORMED JOINT SEAL OR NEOPRENE JOINTS
 - 8.) PLACE PROPOSED MICROSILICIA CONCRETE BRIDGE DECK OVERLAY 2 1/2"

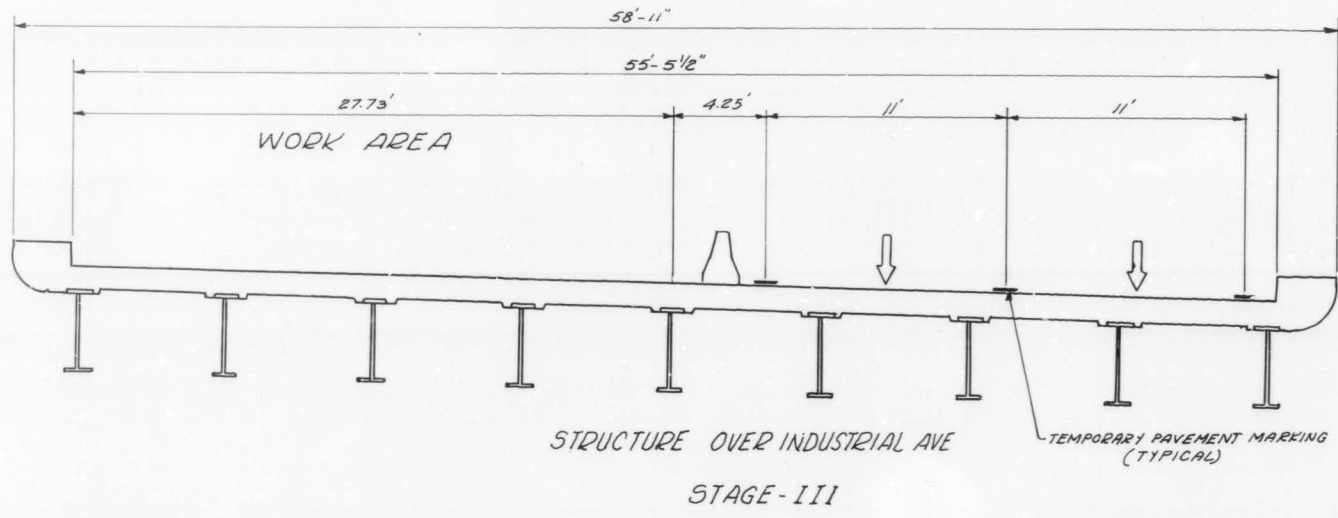

- STAGE III
- 1.) RELOCATE ALL TRAFFIC CONTROL AND REROUTE TRAFFIC TO INSIDE LANES
 - 2.) REMOVE EXISTING BRIDGE DECK BITUMINOUS OVERLAY 1 1/2"
 - 3.) SCARIFY BRIDGE DECK SLAB 1/2"
 - 4.) REMOVE EXISTING HANDRAIL AND REPLACE WITH A CONCRETE PARAPET RETROFIT.
 - 5.) CONSTRUCT PARTIAL AND FULL DEPTH DECK SLAB REPAIRS
 - 6.) REMOVE EXISTING TRANSVERSE JOINTS
 - 7.) INSTALL PROPOSED PREFORMED JOINT SEAL OR NEOPRENE JOINTS
 - 8.) PLACE PROPOSED MICROSILICIA CONCRETE BRIDGE DECK OVERLAY 2 1/2"

REVISIONS	
NAME	DATE

ILLINOIS DEPARTMENT OF TRANSPORTATION
ILLINOIS ROUTE-53
(SOUTHBOUND)
TYPICAL STAGING CROSS SECTION
STRUCTURE OVER INDUSTRIAL AVE.
STRUCTURE NO. 016-1120

SCALE: VERT. DRAWN BY: EGM
 HORIZ. CHECKED BY: RY
DATE

