

DATE	
BY	
SURVEYED	
PLOTTED	
ALIGNED	
CHECKED	
FILED	
NO.	
PLAN	
NOTE BOOK	
NO.	

DATE	
BY	
SURVEYED	
PLOTTED	
GRADES CHECKED	
STRUCTURE	
NOTATIONS CHECKED	
NO.	
PROFILE	
NOTE BOOK	
NO.	

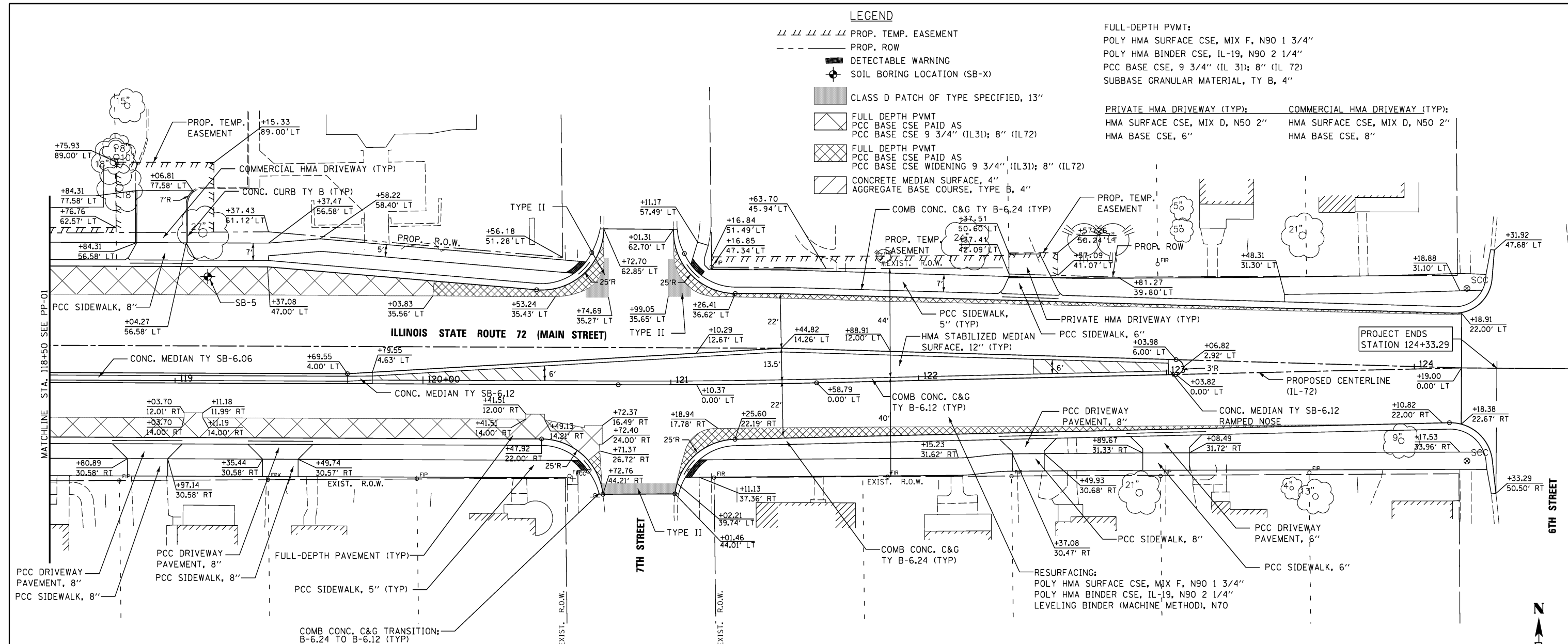

- LEGEND**
- PROP. TEMP. EASEMENT
 - - - PROP. ROW
 - ▬ DETECTABLE WARNING
 - ⊕ SOIL BORING LOCATION (SB-X)
 - CLASS D PATCH OF TYPE SPECIFIED, 13"
 - ▨ FULL DEPTH PVMT
PCC BASE CSE PAID AS
PCC BASE CSE 9 3/4" (IL31); 8" (IL72)
 - ▩ FULL DEPTH PVMT
PCC BASE CSE PAID AS
PCC BASE CSE WIDENING 9 3/4" (IL31); 8" (IL72)
 - ▧ CONCRETE MEDIAN SURFACE, 4"
AGGREGATE BASE COURSE, TYPE B, 4"
- FULL-DEPTH PVMT:**
 POLY HMA SURFACE CSE, MIX F, N90 1 3/4"
 POLY HMA BINDER CSE, IL-19, N90 2 1/4"
 PCC BASE CSE, 9 3/4" (IL 31); 8" (IL 72)
 SUBBASE GRANULAR MATERIAL, TY B, 4"
- PRIVATE HMA DRIVEWAY (TYP):**
 HMA SURFACE CSE, MIX D, N50 2"
 HMA BASE CSE, 6"
- COMMERCIAL HMA DRIVEWAY (TYP):**
 HMA SURFACE CSE, MIX D, N50 2"
 HMA BASE CSE, 8"

- NOTES**
- SEE CROSS SECTIONS FOR REVERSE CURB & GUTTER LOCATIONS.
 - SEE SHEETS 43 & 44 FOR MILLING AND LEVELING BINDER DEPTHS AND LOCATIONS.
 - SEE SHEET 55 FOR SOIL BORINGS AND PAVEMENT CORES.

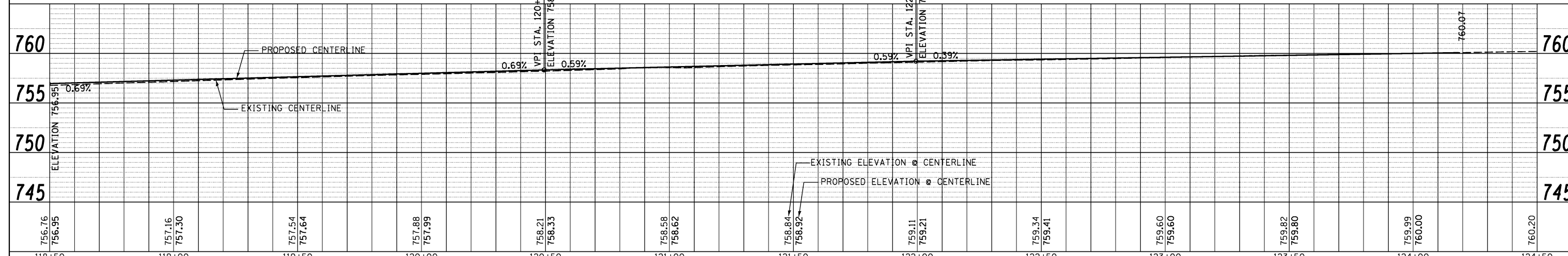

756.76	756.95	757.16	757.30	757.54	757.64	757.88	757.99	758.21	758.33	758.58	758.62	758.84	758.92	759.11	759.21	759.34	759.41	759.60	759.60	759.82	759.80	759.99	760.00	760.20
118+50		119+00		119+50		120+00		120+50		121+00		121+50		122+00		122+50		123+00		123+50		124+00		124+50



USER NAME = *USER*	DESIGNED <i>ESI</i>	REVISED -
CHECKED <i>GJS</i>	CHECKED <i>GJS</i>	REVISED -
PLOT SCALE = *SCALE*	DRAWN <i>ESI</i>	REVISED -
PLOT DATE = *DATE*	CHECKED <i>07/03/12</i>	REVISED -

**STATE OF ILLINOIS
DEPARTMENT OF TRANSPORTATION**

**PROPOSED ROADWAY PLAN AND PROFILE
ILLINOIS 72**

SCALE: 1" = 20' SHEET NO. 2 OF 6 SHEETS STA. 118+50 TO STA. 125+00

F.A.U. RTE.	SECTION	COUNTY	TOTAL SHEETS	SHEET NO.
3887	S-N	KANE	153	50
CONTRACT NO. 60A95			FED. ROAD DIST. NO. 1 ILLINOIS FED. AID PROJECT	