

PAVEMENT MARKING TAPE, TY III, 4", WHITE (TYP)

STORM SEWER LINES AND STRUCTURES AND PAVEMENT PATCHING SHALL BE INSTALLED UNDER DAILY LANE CLOSURE.

DRUM W/ STEADY BURN MONODIRECTIONAL LIGHT, AT 50' CENTERS (20' CENTERS IN TAPERS) PAVEMENT MARKING TAPE, TY III, 4", WHITE (TYP)

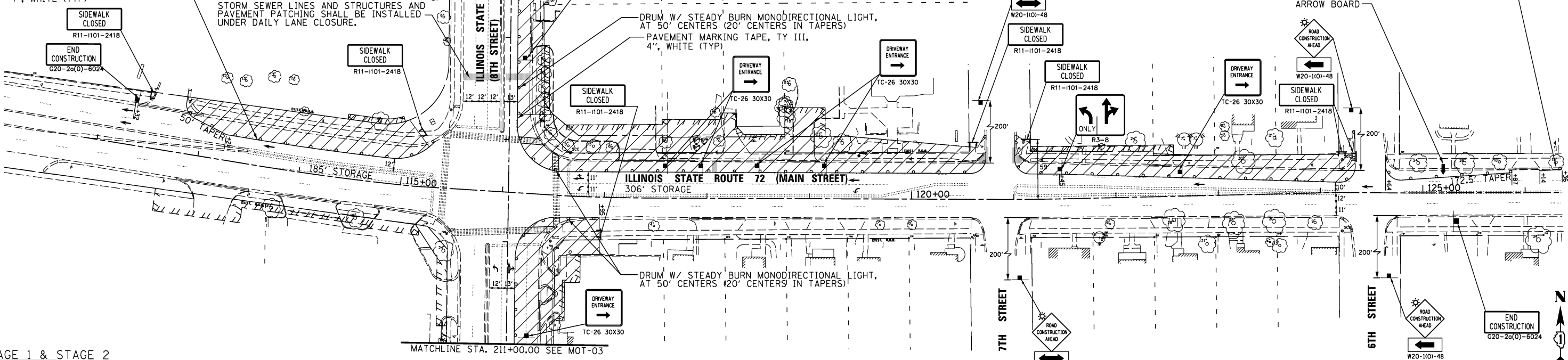

STAGE 1 & STAGE 2

LEGEND NOTES:

- WORK ZONE
- DIRECTION(S) OF TRAVEL
- 1. ADA COMPLIANT CROSSWALKS AT THE INTERSECTION OF IL 31 AND IL 72 SHALL REMAIN OPEN FOR PEDESTRIAN ACCESS. DURING STAGES 1 AND 2, A MINIMUM OF 1 E-W AND 1 N-S PATH SHALL REMAIN OPEN DURING CONSTRUCTION. CONTRACTOR SHALL DO SWITCH OVERS DURING OFF PEAK HOURS.
- 2. SEE DRIVEWAY ACCESS DETAIL ON MOT GENERAL NOTES FOR ALL DRIVEWAYS ALONG THE PROJECT WORK LIMITS. EACH DETAIL PROVIDED INDICATES THE APPLICABLE STAGE 1 AND STAGE 2 LAYOUT.
- 3. MAINTAIN DRIVEWAY ENTRANCE SIGNAGE LAYOUT FROM STAGE 1 TO STAGE 2.

STAGE 1 - IL 72

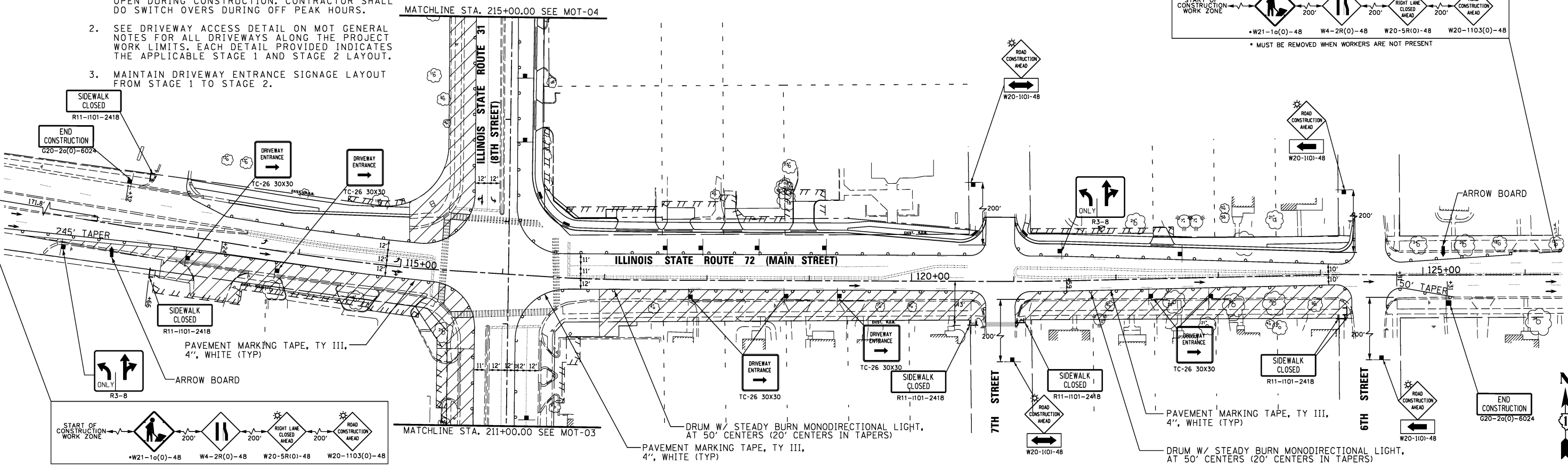

STAGE 2 - IL 72

STATE OF ILLINOIS  
DEPARTMENT OF TRANSPORTATION

SUGGESTED MAINTENANCE OF TRAFFIC  
ILLINOIS 72: STAGES 1 & 2

SCALE: 1" = 50' SHEET NO. 2 OF 7 SHEETS STA. TO STA. F.A.U. RTE. SECTION COUNTY TOTAL SHEETS SHEET NO. 3887 S-N KANE 153 57 CONTRACT NO. 60A95 FED. ROAD DIST. NO. 1 ILLINOIS FED. AID PROJECT



USER NAME = #USER#	DESIGNED <i>ESI</i>	REVISED -
PLOT SCALE = #SCALE#	DRAWN <i>ESI</i>	REVISED -
PLOT DATE = #DATE#	CHECKED <i>GJS</i>	REVISED -
	DATE <i>07/03/12</i>	REVISED -