

STAGE 3 - IL 31

STAGE 3

LEGEND

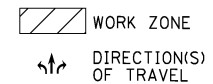

NOTES:

- ACCESS TO PROPERTIES SHALL BE MAINTAINED AT ALL TIMES. WHEN A DRIVEWAY MUST BE CLOSED TEMPORARILY FOR CONSTRUCTION OF THE APRON, PROPERTIES WITH MULTIPLE ENTRANCES SHALL HAVE ONLY ONE ENTRANCE CLOSED AT A TIME.
- SEE DRIVEWAY ACCESS DETAIL ON MOT GENERAL NOTES FOR ALL DRIVEWAYS ALONG THE PROJECT WORK LIMITS. EACH DETAIL PROVIDED INDICATES THE APPLICABLE STAGE 3 LAYOUT.



USER NAME = \$USER*	DESIGNED <i>ESI</i>	REVISED -
DRAWN <i>ESI</i>	REVISED -	
PLOT SCALE = \$SCALE*	CHECKED <i>GJS</i>	REVISED -
PLOT DATE = \$DATE*	DATE <i>07/03/12</i>	REVISED -

**STATE OF ILLINOIS
DEPARTMENT OF TRANSPORTATION**

**SUGGESTED MAINTENANCE OF TRAFFIC
IL 31: STAGE 3**

SCALE: 1" = 50' SHEET NO. 7 OF 7 SHEETS STA. TO STA.

F.A.U. RTE.	SECTION	COUNTY	TOTAL SHEETS	SHEET NO.
3887	S-N	KANE	153	62
CONTRACT NO. 60A95				
FED. ROAD DIST. NO. 1 ILLINOIS FED. AID PROJECT				