

DATE	
BY	
PLAN	SURVEYED
	PLOTTED
	GRADES CHECKED
	STRUCTURE NOTATIONS OK'D
	NO.

DATE	
BY	
PROFILE	SURVEYED
	PLOTTED
	GRADES CHECKED
	STRUCTURE NOTATIONS OK'D
	NO.

ST-10 STA: 119+20.16; 47.0 LT 4' CB TY A W/TY 24 F&G RIM 756.95 IE 753.68 (12" S)	ST-11 STA: 119+20.36; 39.2 LT 4' MH TY A W/TY 1 F, CL RIM 756.59 IE 753.59 (12" N) IE 752.90 (24" W,E)	ST-12 STA: 120+52.43; 38.6 LT EXIST. MH (RECON) W/TY 24 F&G EXIST. RIM 758.79 NEW RIM 757.98 IE 753.59 (24" W,E)	ST-13 STA: 120+71.22; 54.6 LT 4' CB TY A W/TY 24 F&G RIM 758.42 IE 753.97 (12" S)	ST-14 STA: 120+70.17; 39.7 LT 4' MH TY A W/TY 1 F, CL RIM 758.09 IE 753.67 (12" N) IE 753.67 (24" W,E)	ST-15a STA: 121+02.33; 54.7 LT 2' IN TY A W/TY 24 F&G RIM 757.91 IE 753.97 (12" S)	ST-15b STA: 121+03.57; 40.1 LT 4' MH TY A W/TY 1 F, CL RIM 758.26 IE 753.67 (12" N) IE 753.84 (24" W,E)	ST-16 STA: 122+17.81; 39.0 LT 4' MH TY A W/TY 1 F, CL RIM 759.27 IE 754.92 (12" S) IE 754.42 (24" W,E)	ST-17 STA: 122+17.74; 32.5 LT 4' CB TY A W/TY 24 F&G RIM 758.94 IE 755.02 (12" NW,S)	ST-18 STA: 122+17.77; 20.1 RT 4' MH TY A W/TY 1 F, CL RIM 758.88 IE 755.14 (12" E) IE 755.39 (12" N) IE 754.94 (12" W) IE 755.39 (12" S)	ST-19 STA: 122+18.18; 28.5 RT 2' IN TY A W/TY 8 F&G RIM 758.24 IE 755.57 (12" N)	ST-20 STA: 121+01.91; 41.4 RT 2' IN TY A W/TY 11 F&G RIM 757.66 IE 754.66 (12" W)	ST-21 STA: 120+72.34; 41.6 RT 4' CB TY A W/TY 11 F&G RIM 757.56 IE 754.06 (12" N, E)	ST-22 STA: 120+67.88; 21.0 RT 4' MH TY A W/TY 1 F, CL RIM 758.01 IE 753.95 (10" E) IE 754.29 (8" N) IE 753.95 (12" S,W)	ST-23a STA: 120+45.26; 22.0 RT 4' CB TY A W/TY 24 F&G RIM 757.86 IE 753.91 (12" N)	ST-23b STA: 120+45.26; 16.5 RT 4' MH TY A W/TY 1 F&CL RIM 757.97 IE 753.77 (12" S,W,E)	ST-24a STA: 119+07.44; 22.0 RT 4' CB TY A W/TY 24 F&G RIM 756.91 IE 752.83 (12" N)	ST-24b STA: 119+07.44; 16.5 RT 4' MH TY A W/TY 1 F&CL RIM 757.02 IE 752.69 (12" S,W,E)
--	--	--	--	--	---	---	--	---	--	---	--	---	--	---	---	---	---

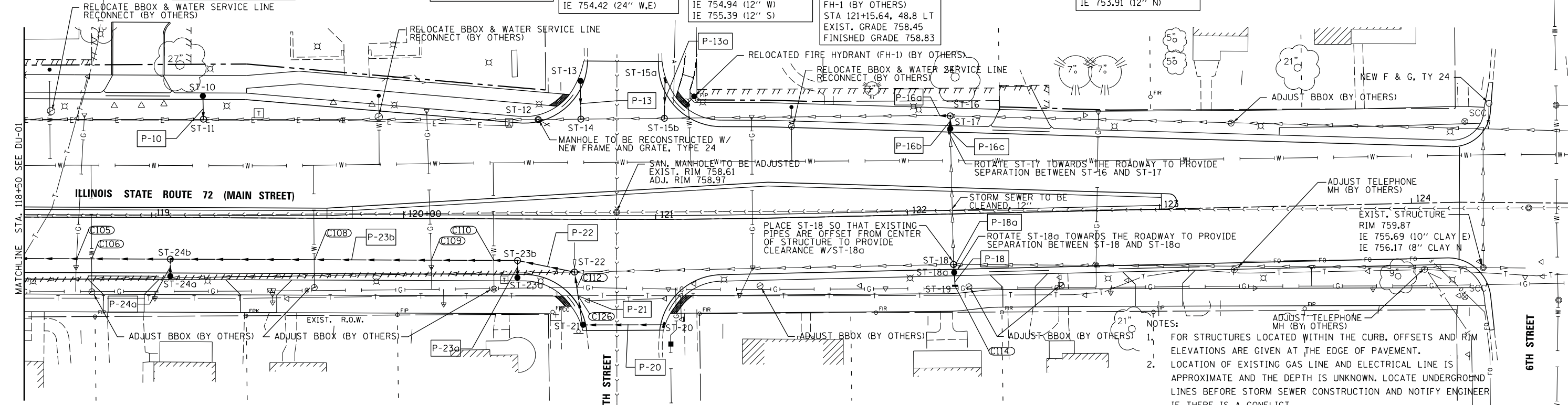

P-10 9 LF - 12" RCP TYPE 2 @ 1.00%	P-16a 7 LF - 24" RCP TYPE 2 @ 0.36%	P-18 6 LF - 12" RCP TYPE 2 @ 2.00%	P-21 22 LF - 12" RCP TYPE 2 @ 0.50%	P-23b 138 LF - 12" RCP TYPE 2 @ 0.78%
P-13 15 LF - 12" RCP TYPE 2 @ 2.00%	P-16b 5 LF - 12" WMOP TYPE 2 @ 2.00%	P-18a 3 LF - 12" WMOP TYPE 2 @ 2.00%	P-22 23 LF - 12" RCP TYPE 2 @ 0.78%	P-24a 7 LF - 12" RCP TYPE 2 @ 2.00%
P-13a 15 LF - 12" RCP TYPE 2 @ 2.00%	P-16c 3 LF - 12" RCP TYPE 2 @ 0.68%	P-20 31 LF - 12" RCP TYPE 2 @ 1.94%	P-23a 7 LF - 12" RCP TYPE 2 @ 2.00%	

C105 12" ST IE 752.40 GAS LINE DEPTH IS UNKNOWN	C109 12" ST IE 753.50 GAS LINE DEPTH IS UNKNOWN	C114 ST-19: 2' IN GAS: 2" STEEL DEPTH IS UNKNOWN
C106 12" ST IE 752.45 WM T/P 750.02 (EST.)	C110 12" ST IE 753.70 WM T/P 751.23 (EST.)	C126 12" ST IE 754.00 TELEPHONE LINE DEPTH IS UNKNOWN
C108 12" ST IE 753.14 WM T/P 750.69 (EST.)	C112 12" ST IE 753.98 GAS: 2" STEEL T/P 754.90	

- NOTES:
- FOR STRUCTURES LOCATED WITHIN THE CURB, OFFSETS AND RIM ELEVATIONS ARE GIVEN AT THE EDGE OF PAVEMENT.
  - LOCATION OF EXISTING GAS LINE AND ELECTRICAL LINE IS APPROXIMATE AND THE DEPTH IS UNKNOWN. LOCATE UNDERGROUND LINES BEFORE STORM SEWER CONSTRUCTION AND NOTIFY ENGINEER IF THERE IS A CONFLICT.
  - IN CASES WHERE WATERMAIN LINE INFORMATION WAS NOT AVAILABLE, THE SLOPE FOR THE TOP OF PIPE ELEVATION IS ASSUMED AT 0% AND CROSSING INFORMATION IS NOTED AS '(EST.)'. CONTRACTOR SHALL LOCATE POTENTIAL CONFLICTS AND NOTIFY THE ENGINEER PRIOR TO INSTALLING STORM SEWER LINES.
  - IN CASES WHERE SANITARY SEWER INVERT ELEVATIONS WERE NOT AVAILABLE, CONTRACTOR SHALL LOCATE POTENTIAL CONFLICTS AND NOTIFY THE ENGINEER PRIOR TO INSTALLING STORM SEWER LINES.
  - SEE THE STREET LIGHTING PLAN SHEETS FOR LIGHT POLE REMOVAL AND RELOCATION.
  - SEE TRAFFIC SIGNAL PLAN SHEETS FOR REMOVALS RELATED TO TRAFFIC SIGNAL EQUIPMENT.

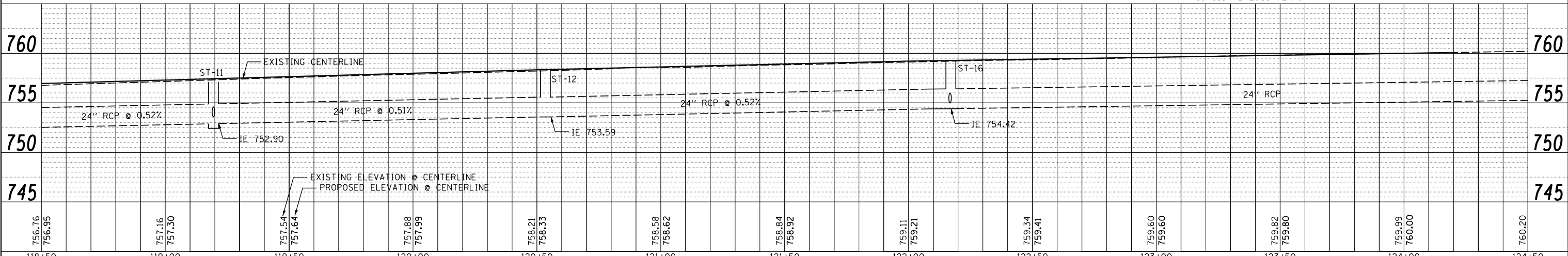

118+50	119+00	119+50	120+00	120+50	121+00	121+50	122+00	122+50	123+00	123+50	124+00	124+50
756.76 756.95	757.16 757.30	757.54 757.64	757.88 757.99	758.21 758.33	758.58 758.62	758.84 758.92	759.11 759.21	759.34 759.41	759.60 759.60	759.82 759.80	759.99 760.00	760.20



USER NAME: *USER*	DESIGNED: <i>ESI</i>	REVISED: - 08/01/12
PLOT SCALE: *SCALE*	CHECKED: <i>GJS</i>	REVISED: - 08/29/12
PLOT DATE: *DATE*	DRAWN: <i>ESI</i>	REVISED: -
	CHECKED: 07/03/12	REVISED: -

STATE OF ILLINOIS  
DEPARTMENT OF TRANSPORTATION

PROPOSED DRAINAGE AND UTILITY PLAN		F.A.U. R.T.E. 3887	SECTION S-N	COUNTY KANE	TOTAL SHEETS 153	SHEET NO. 80
SCALE: 1" = 20'	SHEET NO. 2 OF 6 SHEETS	STA. 118+50	TO STA. 125+00		CONTRACT NO. 60A95	
FED. ROAD DIST. NO. 1 ILLINOIS FED. AID PROJECT						