

ALIGNMENT DATA

100	N 855395.72 E 19057.63
101	N 856737.73 E 19065.83
102	N 857063.70 E 19072.82
103	N 857323.60 E 19074.41
104	N 857937.62 E 19090.16

BM #200 3900+14, 79 RT
 SQUARE "□" CUT IN WEST FACE OF HIGH TENSION TOWER BASE, EAST SIDE OF IL ROUTE 59 (*664 S IL RTE 59)
 ELEV. 698.76

BM #202 3915+54, 81 RT
 SQUARE "□" CUT IN WEST FACE OF HIGH TENSION TOWER BASE, EAST SIDE OF IL ROUTE 59 AT SOUTH ENTRANCE TO CARSON FURNITURE GALLERY / DSW SHOES
 ELEV. 701.90

BM #204 3927+28, 83 RT
 SQUARE "□" CUT IN WEST FACE OF LIGHT POLE BASE, IN PARKING LOT, 50' NORTH OF NORTHWEST CORNER OF CHILI'S RESTAURANT
 ELEV. 707.09

BM #201 3905+18, 79 RT
 SQUARE "□" CUT IN WEST FACE OF HIGH TENSION TOWER BASE, EAST SIDE OF IL ROUTE 59 (*604 IL RTE 59)
 ELEV. 696.82

BM #203 3923+70, 50.6 LT
 SQUARE "□" CUT IN EAST FACE OF HIGH TENSION TOWER BASE, WEST SIDE OF IL ROUTE 59, 150'± SOUTH OF ENTRANCE TO MEIJER FOODS
 ELEV. 711.96

BM #206 3942+03, 51.8 LT
 SQUARE "□" CUT IN SOUTHEAST CORNER OF HIGH TENSION TOWER BASE, WEST SIDE OF IL ROUTE 59, IN FRONT OF SWEET TOMATOES RESTAURANT
 ELEV. 713.74

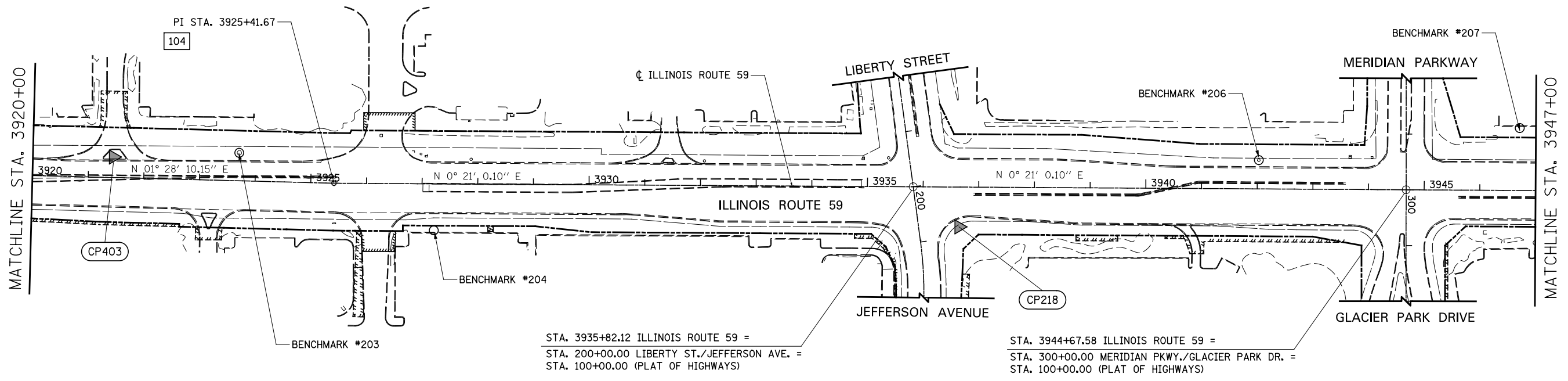
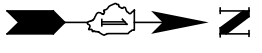

STA. 3935+82.12 ILLINOIS ROUTE 59 =
 STA. 200+00.00 LIBERTY ST./JEFFERSON AVE. =
 STA. 100+00.00 (PLAT OF HIGHWAYS)

STA. 3944+67.58 ILLINOIS ROUTE 59 =
 STA. 300+00.00 MERIDIAN PKWY./GLACIER PARK DR. =
 STA. 100+00.00 (PLAT OF HIGHWAYS)

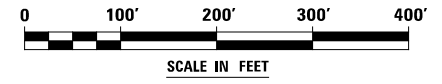

FILE NAME =	USER NAME = *USER*	DESIGNED <i>NAV</i>	REVISED
*FILE#		DRAWN <i>KES</i>	REVISED
	PLOT SCALE = *SCALE*	CHECKED <i>PJO</i>	REVISED
	PLOT DATE = *DATE*	DATE <i>05-11-12</i>	REVISED

**STATE OF ILLINOIS
 DEPARTMENT OF TRANSPORTATION**

ALIGNMENT, BENCHMARKS, AND TIES

SCALE: AS SHOWN SHEET NO. 1 OF 6 SHEETS STA. 3893+00 TO STA. 3947+00

F.A.P. RTE.	SECTION	COUNTY	TOTAL SHEETS	SHEET NO.
338	2011-036-I	DUPAGE	234	17
CONTRACT NO. 60P42			ILLINOIS FED. AID PROJECT	