

STA. 3935+82.12 ILLINOIS ROUTE 59 =  
 STA. 200+00.00 LIBERTY ST./JEFFERSON AVE. =  
 STA. 100+00.00 (PLAT OF HIGHWAYS)

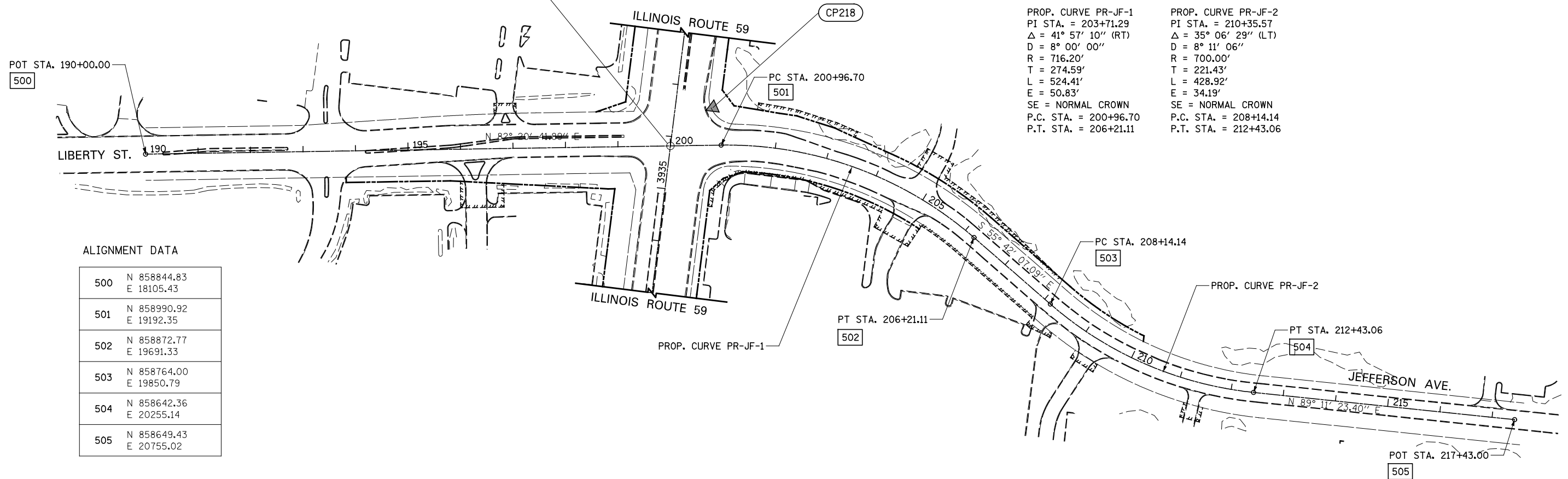

PROP. CURVE PR-JF-1  
 PI STA. = 203+71.29  
 $\Delta$  = 41° 57' 10" (RT)  
 D = 8° 00' 00"  
 R = 716.20'  
 T = 274.59'  
 L = 524.41'  
 E = 50.83'  
 SE = NORMAL CROWN  
 P.C. STA. = 200+96.70  
 P.T. STA. = 206+21.11

PROP. CURVE PR-JF-2  
 PI STA. = 210+35.57  
 $\Delta$  = 35° 06' 29" (LT)  
 D = 8° 11' 06"  
 R = 700.00'  
 T = 221.43'  
 L = 428.92'  
 E = 34.19'  
 SE = NORMAL CROWN  
 P.C. STA. = 208+14.14  
 P.T. STA. = 212+43.06

ALIGNMENT DATA

500	N 858844.83 E 18105.43
501	N 858990.92 E 19192.35
502	N 858872.77 E 19691.33
503	N 858764.00 E 19850.79
504	N 858642.36 E 20255.14
505	N 858649.43 E 20755.02

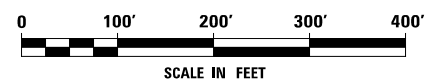

FILE NAME =	USER NAME = *USER*	DESIGNED <i>NAV</i>	REVISED
*FILEL*		DRAWN <i>KES</i>	REVISED
	PLOT SCALE = *SCALE*	CHECKED <i>PJO</i>	REVISED
	PLOT DATE = *DATE*	DATE <i>05-11-12</i>	REVISED

STATE OF ILLINOIS  
 DEPARTMENT OF TRANSPORTATION

ALIGNMENT, BENCHMARKS, AND TIES

SCALE: AS SHOWN SHEET NO. 4 OF 6 SHEETS STA. 190+00 TO STA. 217+43

F.A.P. RTE.	SECTION	COUNTY	TOTAL SHEETS	SHEET NO.
338	2011-036-I	DUPAGE	234	20
CONTRACT NO. 60P42				
ILLINOIS FED. AID PROJECT				