

[100] STA 3913+72.0, 72.8 RT  
 MANHOLE TYPE A 4' DIA.  
 TYPE 1 FRAME, CLOSED LID  
 RIM EL 698.20  
 INV EL 691.17 (W) 12"  
 INV EL 691.17 (S) 12"  
 [101] STA 3913+72.0, 62.3 RT  
 MANHOLE TYPE A 4' DIA.  
 TYPE 1 FRAME, CLOSED LID  
 RIM EL 697.75  
 INV EL 691.18 (N) 12"  
 INV EL 691.18 (E) 12"  
 [102] STA 3915+23.6, 60.6 RT  
 MANHOLE TYPE A 4' DIA.  
 TYPE 1 FRAME, CLOSED LID  
 RIM EL 699.20  
 INV EL 691.43 (W) 12"  
 INV EL 691.43 (S) 12"  
 (101) 7' - 12" SS CL B TY 1 @ 0.17%  
 (102) 147' - 12" SS CL B TY 1 @ 0.17%  
 STORM SEWER REMOVAL - 12"  
 STA 3913+72.0 TO 3915+26.0 - 166'

PLAN	SURVEYED	DATE
	PLOTTED	
	GRADES CHECKED	
	STRUCTURE NOTED	
	NOTATIS CHKD	
	NO.	

PROFILE	SURVEYED	DATE
	PLOTTED	
	GRADES CHECKED	
	STRUCTURE NOTED	
	NOTATIS CHKD	
	NO.	

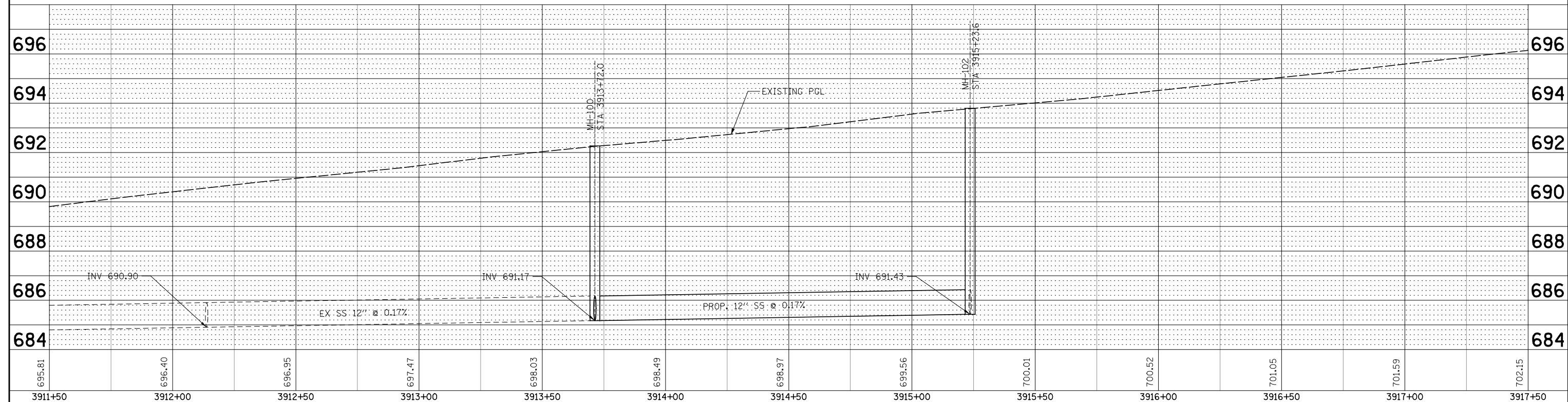
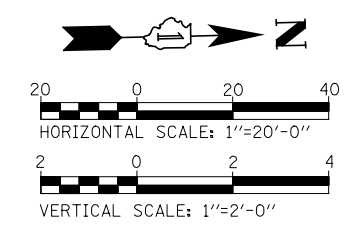
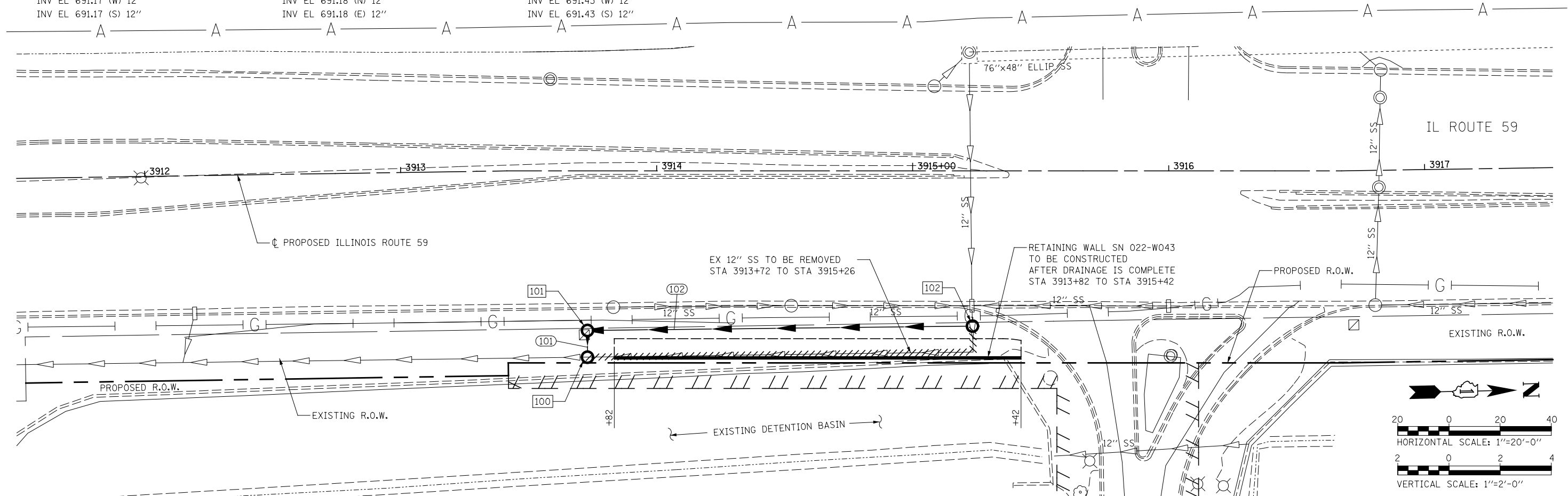

FILE NAME =	USER NAME = *USER*	DESIGNED NAV	REVISED 06-04-12	<b>STATE OF ILLINOIS</b> <b>DEPARTMENT OF TRANSPORTATION</b>	<b>DRAINAGE PLAN / PROFILE - SN 022-W043</b>	F.A.P. RTE.	SECTION	COUNTY	TOTAL SHEETS	SHEET NO.	
*FILEL*	PLOT SCALE = *SCALE*	DRAWN KES	REVISED			338	2011-036-1	DUPAGE	234	38	
	PLOT DATE = *DATE*	CHECKED PJO	REVISED			CONTRACT NO. 60P42					
		DATE 05-11-12	REVISED			FED. ROAD DIST. NO. ILLINOIS FED. AID PROJECT					