

REMOVING MANHOLES	MANHOLES TO BE RECONSTRUCTED	STORM SEWER REMOVAL - 72"	REMOVING CATCH BASIN TO MAINTAIN FLOW
4020+63.2, 55.0 RT 4021+37.0, 55.0 RT	4019+54, 41.9 RT 4019+68, 49.7 RT 4021+09, 41.4 RT 4021+62, 46.8 RT	STA 4020+52.0 TO 4020+62.0 - 16' STA 4020+65.7 TO 4021+34.5 - 69' STA 4021+36.0 TO 4021+36.0 - 19'	4019+99, 57.0 RT

PLAN	SURVEYED	DATE
	PLOTTED	BY
	GRADES CHECKED	
	STRUCTURE NOTED	
	FILE NAME	
	NO.	

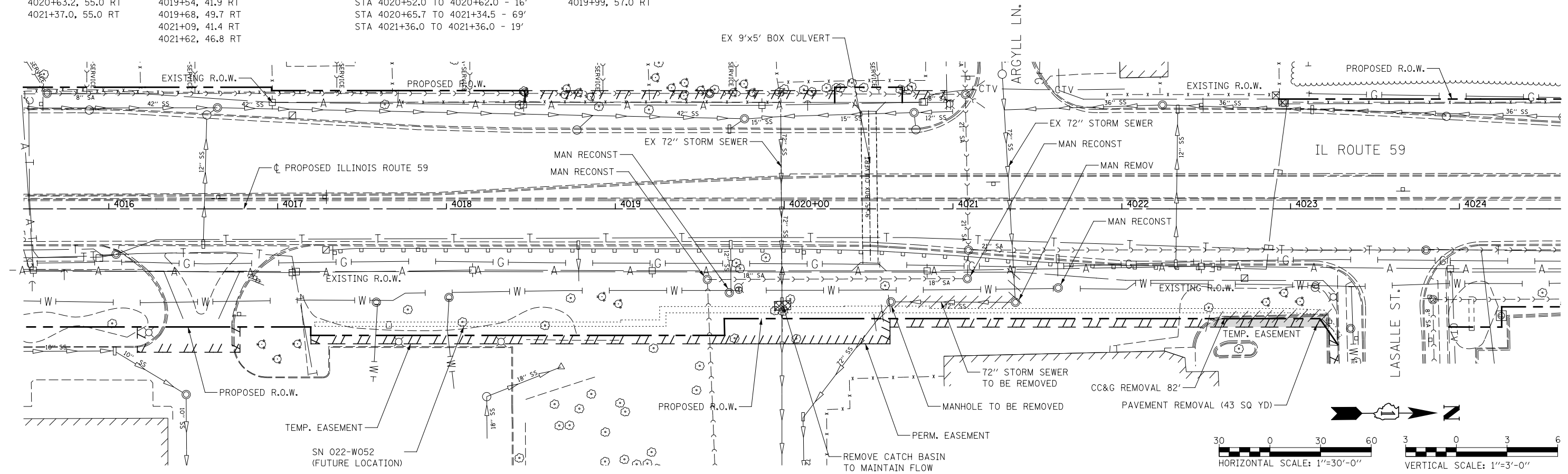

PROFILE	SURVEYED	DATE
	PLOTTED	BY
	GRADES CHECKED	
	STRUCTURE NOTED	
	FILE NAME	
	NO.	

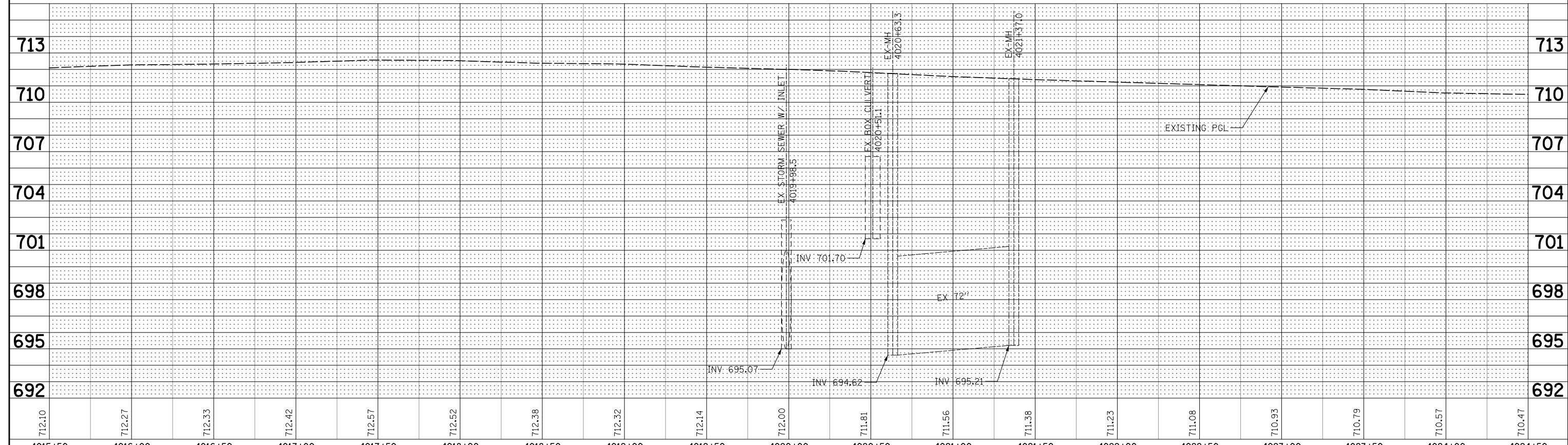

FILE NAME =	USER NAME = #USER#	DESIGNED NAV	REVISED	F.A.P. RTE.	SECTION	COUNTY	TOTAL SHEETS	SHEET NO.
*FILE#		DRAWN KES	REVISED	338	2011-036-1	DUPAGE	234	125
	PLOT SCALE = #SCALE#	CHECKED PJO	REVISED	CONTRACT NO. 60P42				
	PLOT DATE = #DATE#	DATE 05-11-12	REVISED	SCALE: AS SHOWN SHEET NO. 1 OF 1 SHEETS STA. 4015+50 TO STA. 4024+50				

**STATE OF ILLINOIS
DEPARTMENT OF TRANSPORTATION**

DRAINAGE REMOVAL PLAN / PROFILE - SN 022-W052

FED. ROAD DIST. NO.	ILLINOIS	FED. AID PROJECT
---------------------	----------	------------------