

F.A. RTE. 338/IL 59	SECTION 2011-036	COUNTY DUPAGE	TOTAL SHEETS 0	SHEET NO. 3
------------------------	---------------------	------------------	-------------------	----------------

STA.	TO STA.
FED. ROAD DIST. NO.	ILLINOIS CONTRACT 60P42

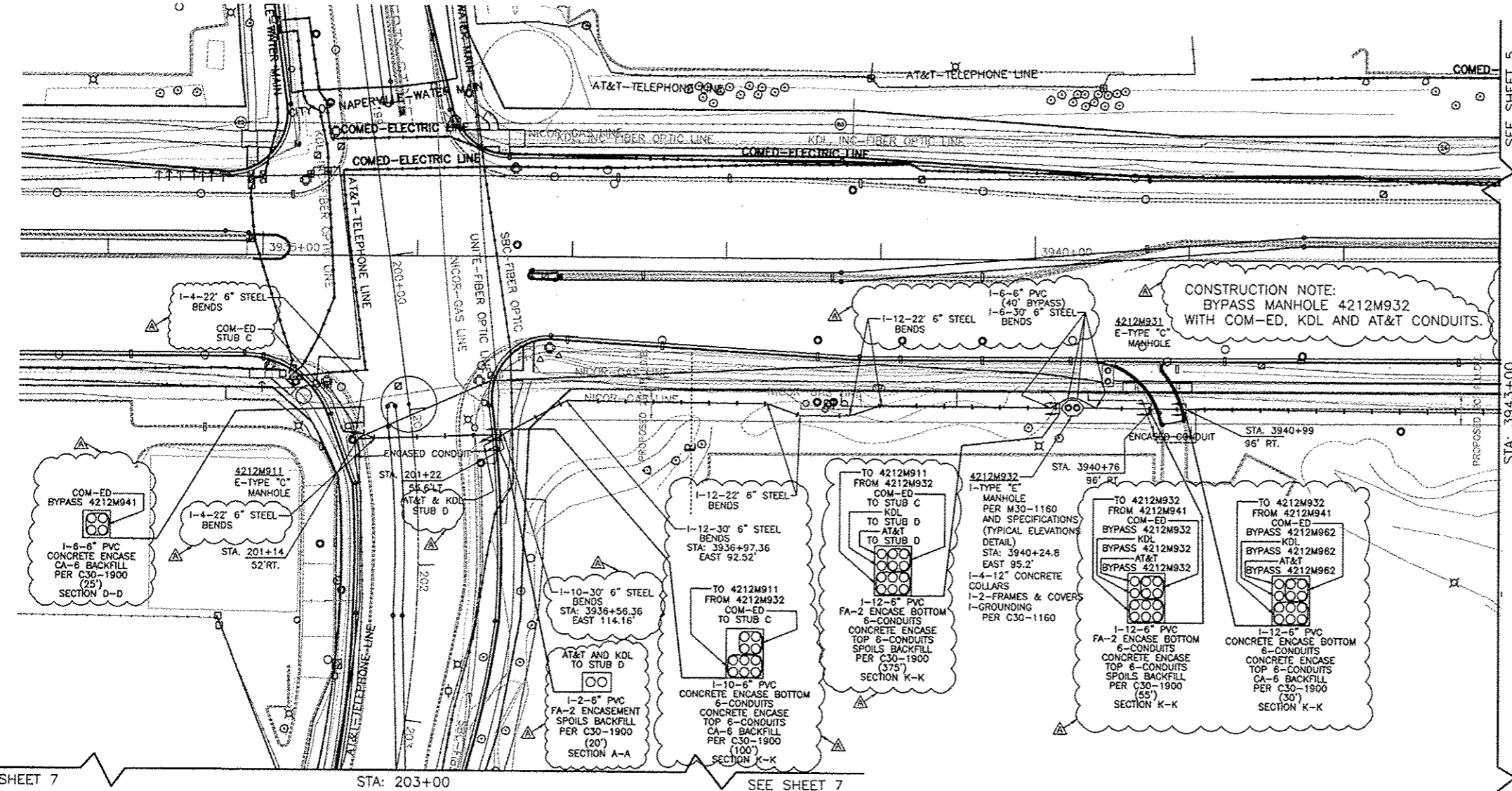

LEGEND

- EXISTING UNDERGROUND**
- E-SW. VAULT
 - E-SW. MOD.
 - △ E-TRANSFORMER
 - E-TYPE "A" MANHOLE
 - E-TYPE "C" MANHOLE
 - E-TYPE "C" DOUBLE OPENING MANHOLE
 - E-TYPE "D" MANHOLE
 - E-TYPE "E" MANHOLE
 - E-CONDUIT
- OVERHEAD**
- E-DISTRIBUTION/TRANSMISSION POLE
- INSTALL UNDERGROUND**
- I-SW. VAULT
 - △ I-TRANSFORMER VAULT
 - I-TYPE "A" MANHOLE
 - I-TYPE "E" DOUBLE OPENING MANHOLE
 - I-TYPE "G" DOUBLE OPENING MANHOLE
 - I-TYPE "G" SINGLE OPENING MANHOLE
 - I-CONDUIT
- ABANDON UNDERGROUND**
- A-CONDUIT

CALL JULIE 48 HRS. PRIOR TO CONSTRUCTION
1-800-892-0123 OR CALL 811

- NOTES:**
- THE PROJECT ENGINEER FOR THIS JOB IS BRIAN CHAMBERLAIN AT (630)420-6853.
 - THE PROJECT COORDINATOR FOR THIS PROJECT IS PAUL MICHALOWSKI AT (630)305-5227.
 - CONTRACTOR IS RESPONSIBLE FOR MANHOLE PHOTOS TAKEN OF ALL CLEARLY MARKED CABLE AND ALL WALLS OF MANHOLES. PHOTOS WILL BE GIVEN TO THE GIS GROUP WITH THE AS-BUILTS.

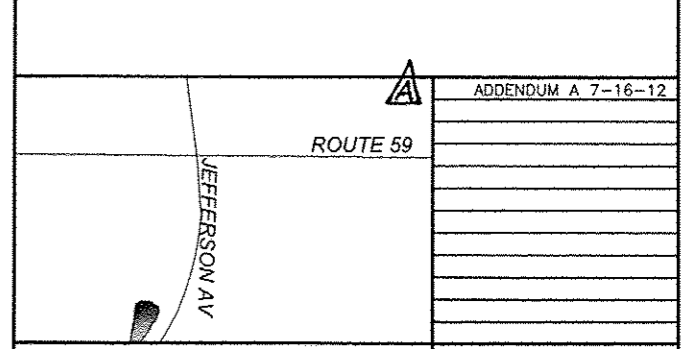

PROJECT TITLE ROUTE 59 ROAD IMPROVEMENTS			
PROJECT DESCRIPTION TO RELOCATE AND INSTALL NEW DUCTBANK AND 34KV FEEDERS			
OWNER BCC	DRAWING DATE 5-11-12	DATE # 4211,4212,4223	SCALE 1 = 40
DESIGNED BY DL	CHECKED BY PSM	DATE N/A	PROJECT # EU-12
DATE 050648001C6.DWG	APPROVED BY	DATE 6 OF 63	WORK REQUEST # 60468