

F.A. RTE. 338/IL 59	SECTION -2011-036-1-	COUNTY DUPAGE	TOTAL SHEETS 0	SHEET NO. 3
STA.		TO STA.		
FED. ROAD DIST. NO.	ILLINOIS	CONTRACT 60P42		

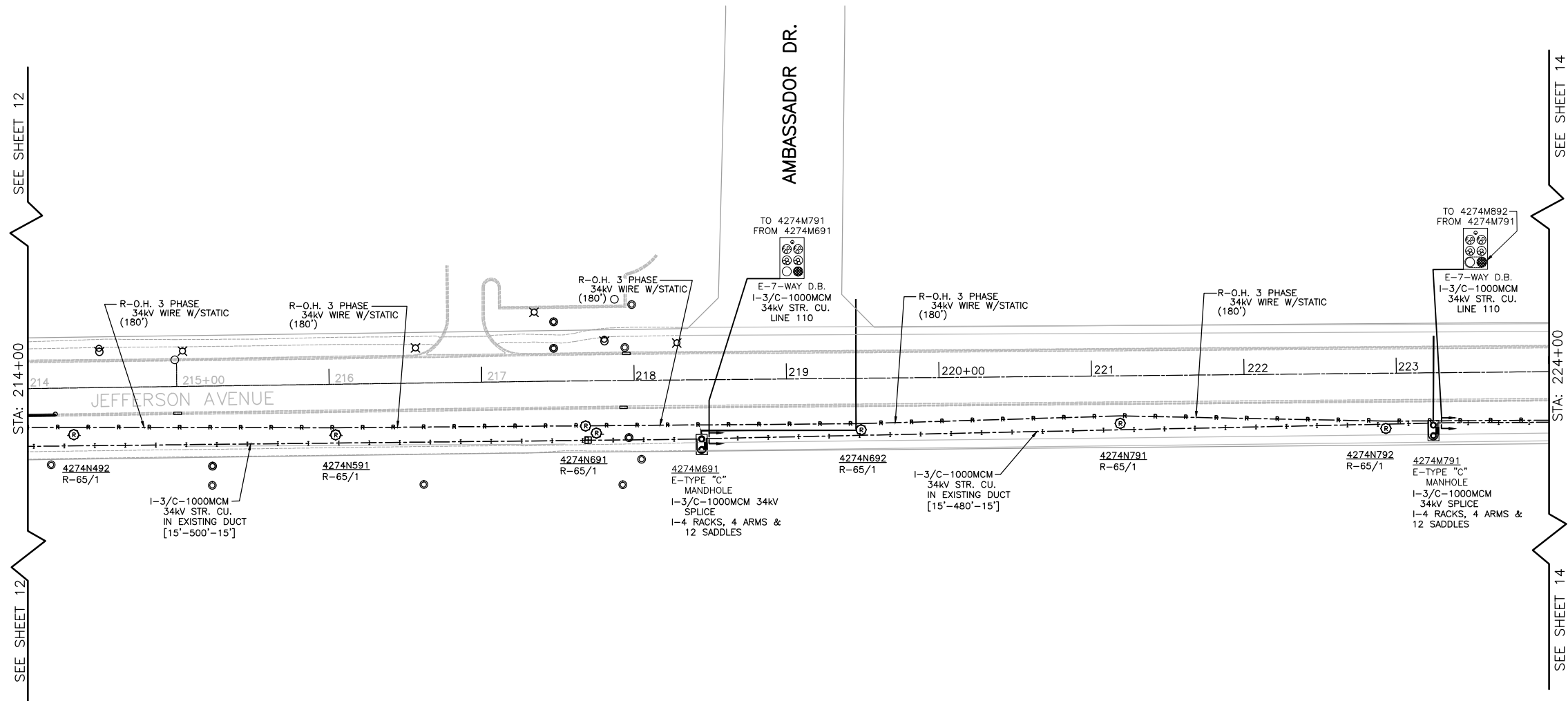

**LEGEND**

- EXISTING UNDERGROUND**
- E-SW. VAULT
  - E-SW. MOD.
  - E-TRANSFORMER
  - E-TYPE "A" MANHOLE
  - E-TYPE "C" MANHOLE
  - E-TYPE "C" DOUBLE OPENING MANHOLE
  - E-TYPE "D" MANHOLE
  - E-TYPE "E" MANHOLE
  - E-CONDUIT
  - E-TYPE "E" DOUBLE OPENING MANHOLE
  - E-TYPE "G" DOUBLE OPENING MANHOLE
- OVERHEAD**
- E-DISTRIBUTION/TRANSMISSION POLE
  - E-3/C-1000MCM 34KV STR. CU. W/JKT.
- INSTALL UNDERGROUND**
- I-3/C-1000MCM 34KV STR. CU. W/JKT.
  - I-SPLICE PER MFR. OR SPECS. PER C30-0460
- REMOVE OVERHEAD**
- R-DISTRIBUTION/TRANSMISSION POLE 65/1 THRU 65/3 POLES
  - R-3/C-1000MCM 34KV STR. CU. W/JKT.
  - R-O.H. 3 PHASE 34KV WIRE W/STATIC

**CALL JULIE 48 HRS. PRIOR TO CONSTRUCTION**  
1 - 800 - 892 - 0123 OR CALL 811

- NOTES:**
1. THE PROJECT ENGINEER FOR THIS JOB IS BRIAN CHAMBERLAIN AT (630)420-6853.
  2. THE PROJECT COORDINATOR FOR THIS PROJECT IS PAUL MICHALOWSKI AT (630)305-5227.
  3. CONTRACTOR IS RESPONSIBLE FOR MANHOLE PHOTOS TAKEN OF ALL CLEARLY MARKED CABLE AND ALL WALLS OF MANHOLES. PHOTOS WILL BE GIVEN TO THE GIS GROUP WITH THE AS-BUILTS.

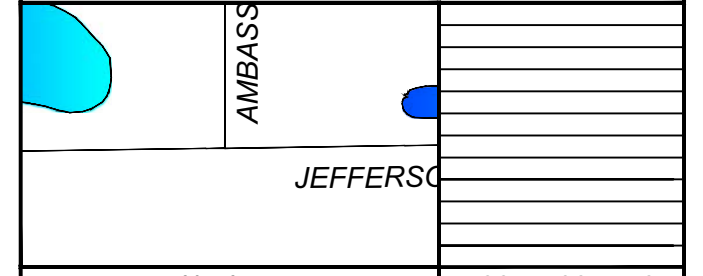

PROJECT TITLE <b>ROUTE 59 ROAD IMPROVEMENTS</b>		DESIGN REVISION DATES	
PROJECT DESCRIPTION <b>TO RELOCATE AND INSTALL NEW DUCTBANK AND 34KV FEEDERS</b>			
ENGINEER BCC	DRAFTING DATE 5-11-12	MAP # 4211.4212.4223	SCALE 1 = 40
DESIGN BY DL	DRAWN BY PSM	PERMIT AGREEMENT # N/A	PROJECT # EU-12
CHECKED BY	APPROVED BY	CAD FILE 0060648001C13.DWG	SHEET # 13 OF 63

Naperville Department of Public Utilities  
Electric Division

